

WHILST EVERY EFFORT HAS BEEN MADE TO ENSURE ACCURATE MEASUREMENTS DUE TO THE NATURE OF THE BUILDING IT IS NOT POSSIBLE IN ALL AREAS. ALL MEASUREMENTS ARE TO BE CHECKED ONSITE BY CONTRACTOR BEFORE WORK COMMENCES.

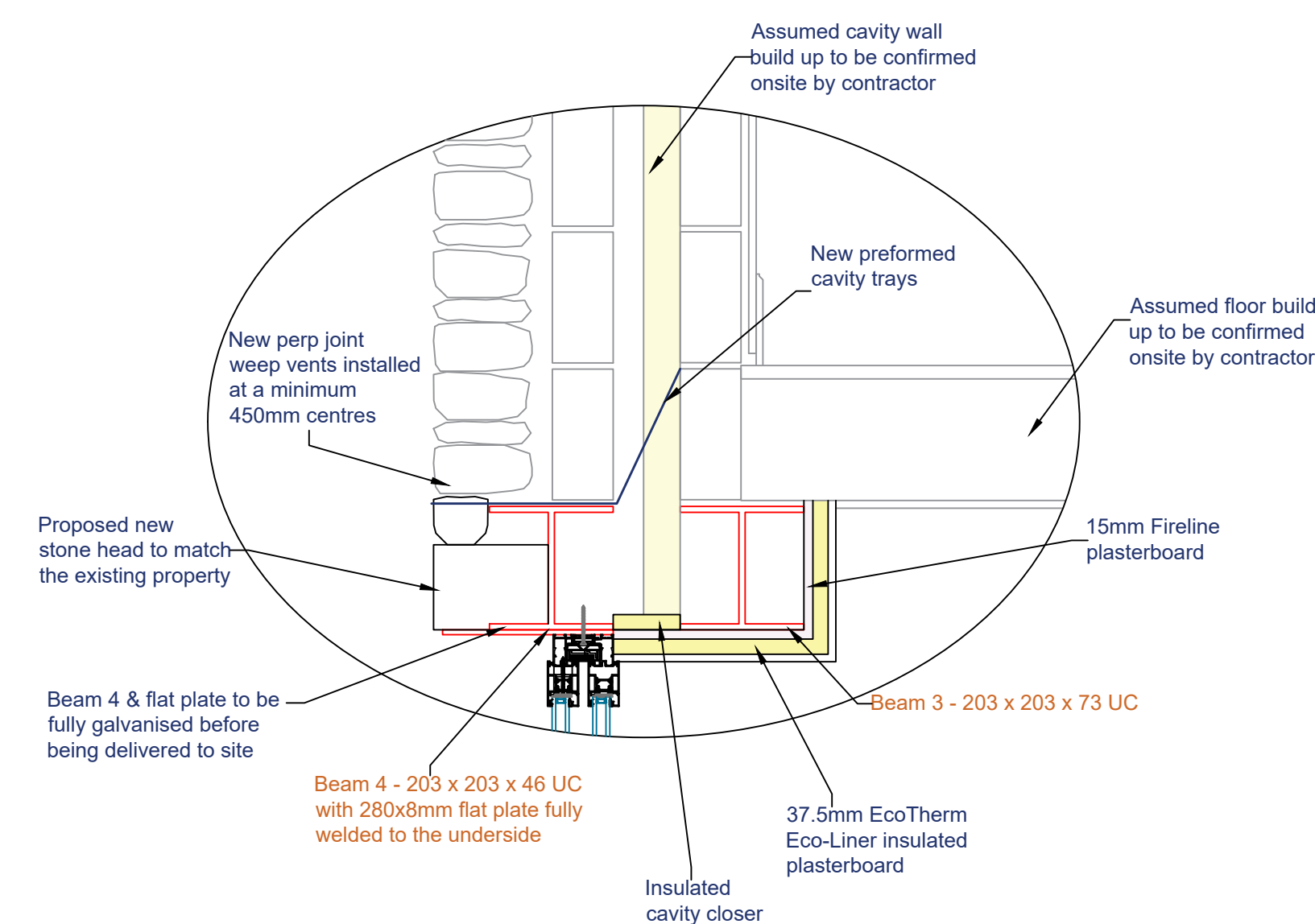

Proposed windows/doors to be
finished in RAL 000 65 00
Mortar grey



Proposed Steel Detail
Scale (1 : 10)

-	-			-	
Revision			Date		
<div style="text-align: center;"> <p>HOLDEN <i>Lancashire</i> LIMITED</p> </div>					
83 Blackburn Road, Rialton, BB1 4ER			Mob: 07738162386 Email: james@holdentlancs.com Web: www.holdentlancs.com		
<u>Drawing Title:</u>					
Proposed Bi-fold doors and internal alterations					
<u>Site Location:</u>					
Pear Tree Cottage, Clitheroe, BB3 3HR					
<u>Drawing Status:</u>					
Proposed Plan					
<u>Date:</u>		<u>Drawn by:</u>			
13/05/2024		JHolden			
<u>Scale:</u>		<u>Ref</u>		<u>Revision</u>	
1:50/1:100 @ A1		002		-	
<u>Client:</u>					
Mr & Mrs Hudson					