

# Demolition management plan

## Demolition

Due care and attention will be taken during the demolition process with all contractors wearing appropriate PPE. The existing materials will be reused where possible, the material that cannot be used will be removed from site during site working hours, but not within school drop off and pick up hours. Any asbestos found during the demolition process will be removed and disposed of by a specialist contractor. The demolition of the existing structure will take place during site working hours to minimise disruption / noise to local residents, with advanced warning given if heavy duty machinery is to be used.

## Site Compound

Proposed location shown on adjacent site plan. The compound will be used for storage of plant and materials as well as parking for site operatives and visitors. All operatives and visitors will be required to undergo a full site induction before accessing the site. The HSE file will be kept in site in the site office.

## Neighbour Liaison

Information will be available to local interested parties, with residents close to the site informed when demolition of the existing structure will be taking place.

## Wheel Washing Facilities

Hose available to wash vehicle wheels on site.

## Site Working Hours

Monday - **Friday 07.30 - 17.30**  
 Saturday **08.00 - 13.00**  
 Sunday / Bank Holiday **Closed**

## Site Contact Details

Site manager to be confirmed once contractor appointed. The contact details will be placed on public display at the entrance to the site as well as the public right of way that borders the site.

## Tree Protection Measures

Any trees in close proximity to the proposed development are to be protected by temporary Heras fencing to BS5837 (see Figure 1.1).

## General Notes

These plans have been prepared for submission to the local authority for town & county planning and/or building regulation purposes only and do not constitute full working drawings. Do not scale from this drawing.

Information noted on these plans or accompanying documents/details is not exhaustive, and the contractor to check with client as to any additional work not specifically noted or implied.

© Rural Solutions Limited

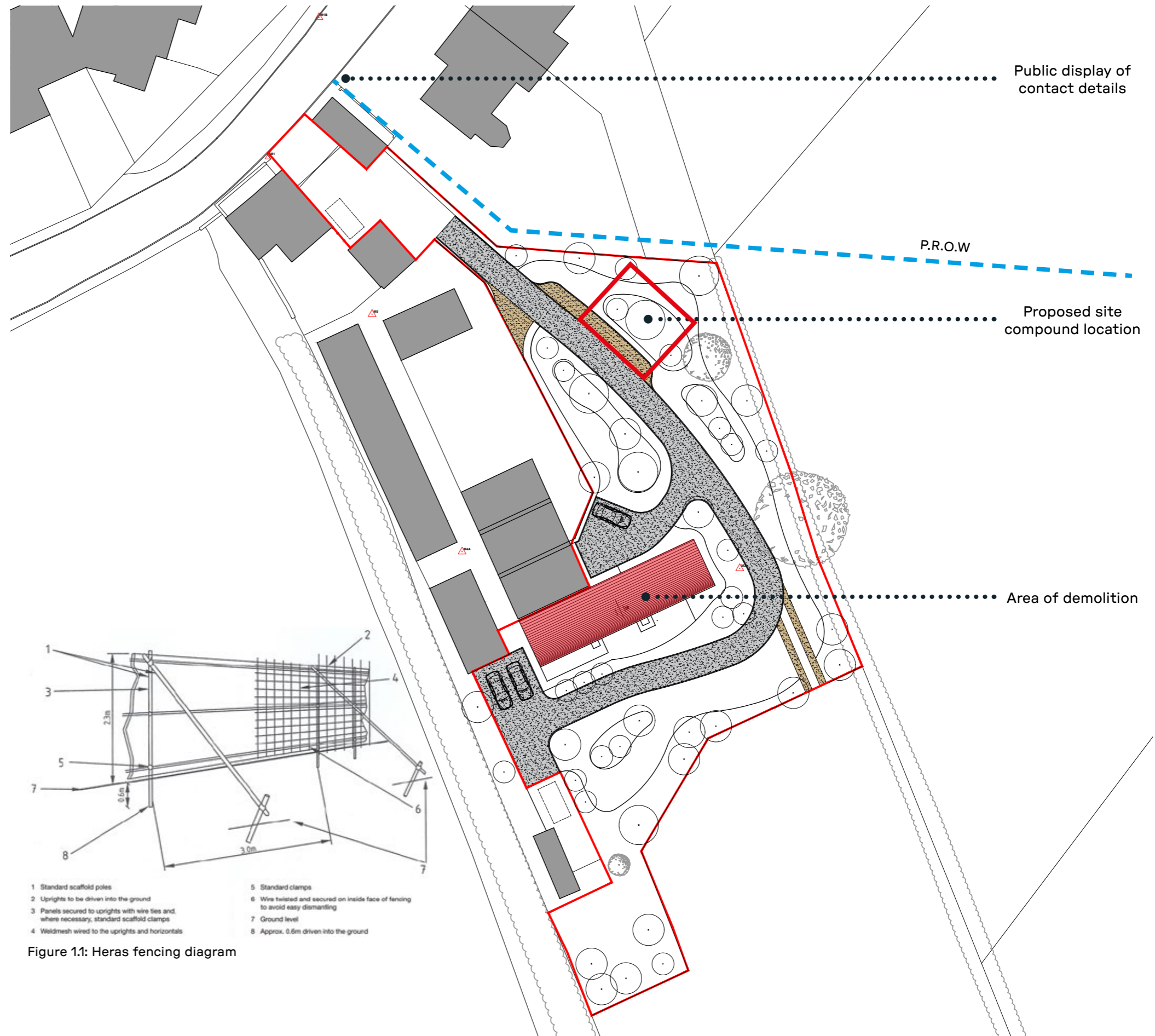

- 1 Standard scaffold poles
- 2 Uprights to be driven into the ground
- 3 Panels secured to uprights with wire ties and, where necessary, standard scaffold clamps
- 4 Weldmesh wired to the uprights and horizontals
- 5 Standard clamps
- 6 Wire twisted and secured on inside face of fencing to avoid easy dismantling
- 7 Ground level
- 8 Approx. 0.6m driven into the ground

Figure 1.1: Heras fencing diagram

drawn LD	checked -
scale N/A	date 02.04.24
number <b>DOC_16</b>	revision <b>00</b>
status DISCHARGE OF CONDITIONS	

client Mr Ashley Rostron
project Light Industrial Site Waddington
title Condition no. 16 Demolition Management Plan

**Rural Solutions**

Canalside House  
Brewery Lane  
Skipton  
BD23 1DR

T: 01756 797501  
E: info@ruralsolutions.co.uk  
W: ruralsolutions.co.uk