

EBV-P FLASHING

APPLICATION

Universal flashing for panel sheet with prefabricated (system) joints.



Installation in roof pitches: 15-90°



Window installation depth: V (0)

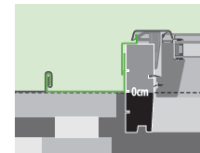

ELEMENTS OF FLASHING STRUCTURE

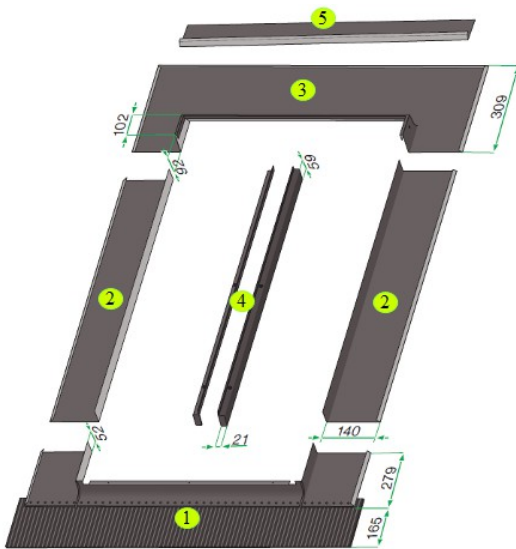

1 – Bottom element of the flashing with elastic lead apron

2 – Side gutter right – left,

3 – Top element of the flashing

4 – Profile covering sides of the frame right – left

5 – Drainage gutter with aluminium strips to fix the flashing

COMPATIBILITY WITH WINDOWS

Flashing type	Window type													
	FT_	FP_	PT_	PP_	FD_	FY_	FE_	FG_	BD_	BV_	BX_	FS_	FWP	FW_
EBV-P														

SIZE LIMITS

Window size	Window width [cm]										
	46	48	55	66	78	94	114	134			
60	*	*	31	32	33	34	35	36			
70	*	*	A1	*	*	*	*	*			
78	46	47	01	22	23	24	25	26			
98	48	49	02	03	05	15	20	12			
118	*	*	16	04	06	08	10	18			
140	*	*	AM	14	07	09	11	17			
160	*	*	AN	BN	13	80	50	FN			
180			AP	BP	40	41	EP	FP			
186					CA	DA					
206			AB	BB	CB	DB					
235					CC	DC					
255					CD	DD					

Sizes possible to manufacture
 Possible in non standard version
 Sizes not available

COMBINATIONS

Horizontal combinations are realized through appropriate modules: KBV-1-P, KBV-2-P and KBV-3-P

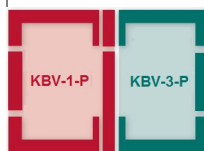

B2/1

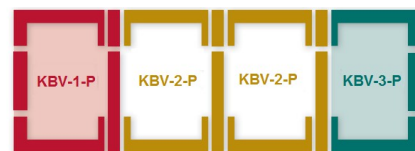

B4/1



B1/2

Vertical combinations available as EBV-P flashing and KDV-B module

Block combinations are realized through appropriate modules: KBV-1-P, KBV-2-P, KBV-3-P and KBV-4, KXV-5, KBV-6

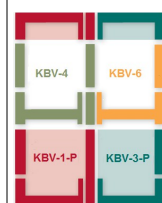

B2/2

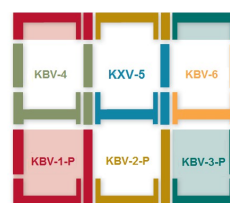

B3/2

MATERIAL

Aluminium sheet: AW-1050A

Lacquer: modified polyester in RAL 7022

Sheet thickness: 0,5 - 0,6mm

Apron:

- lead: made of lead sheet (Pb 99.94Cu) thickness 0.6mm, grooved, shortening factor 0.8

OPTIONS

Flashing in RAL colours

Flashing in copper

Flashing in titanium-zinc:
 - Rhenizink sheet in "bare rolled", "patinaPRO gray-blue" and "patinaPRO grafite"
 - VMZINC sheet in the Anthra-Zinc and Quartz-Zinc versions