

EXISTING SITE PLAN
SCALE 1,200 A2

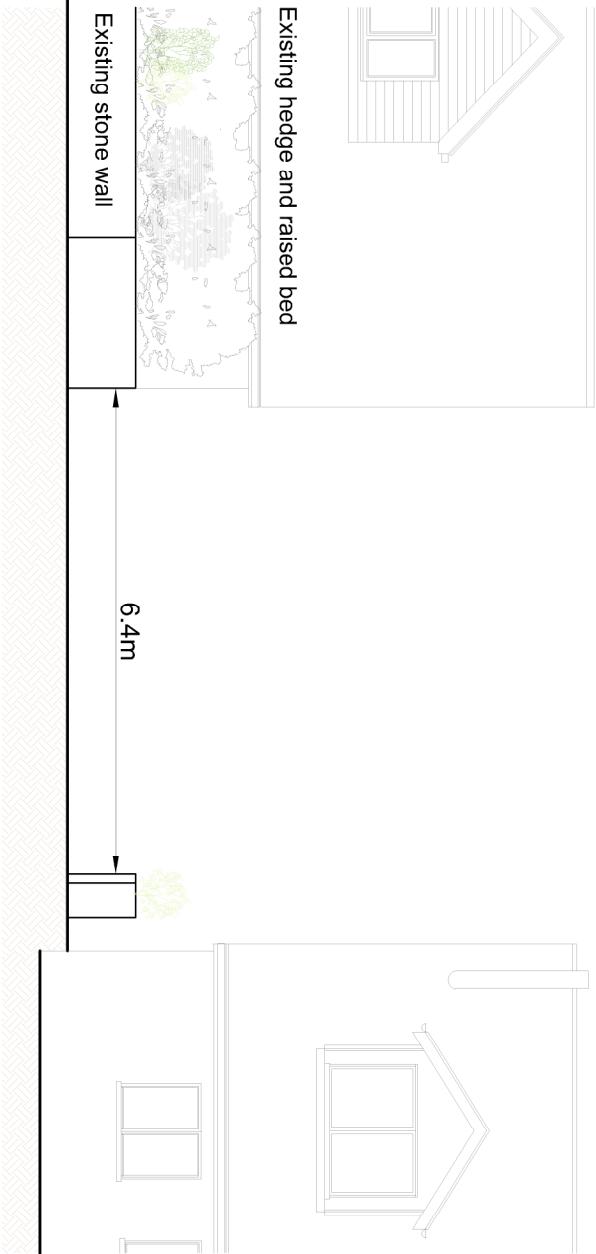

PROPOSED ENTRANCE
SCALE 1,100 A2

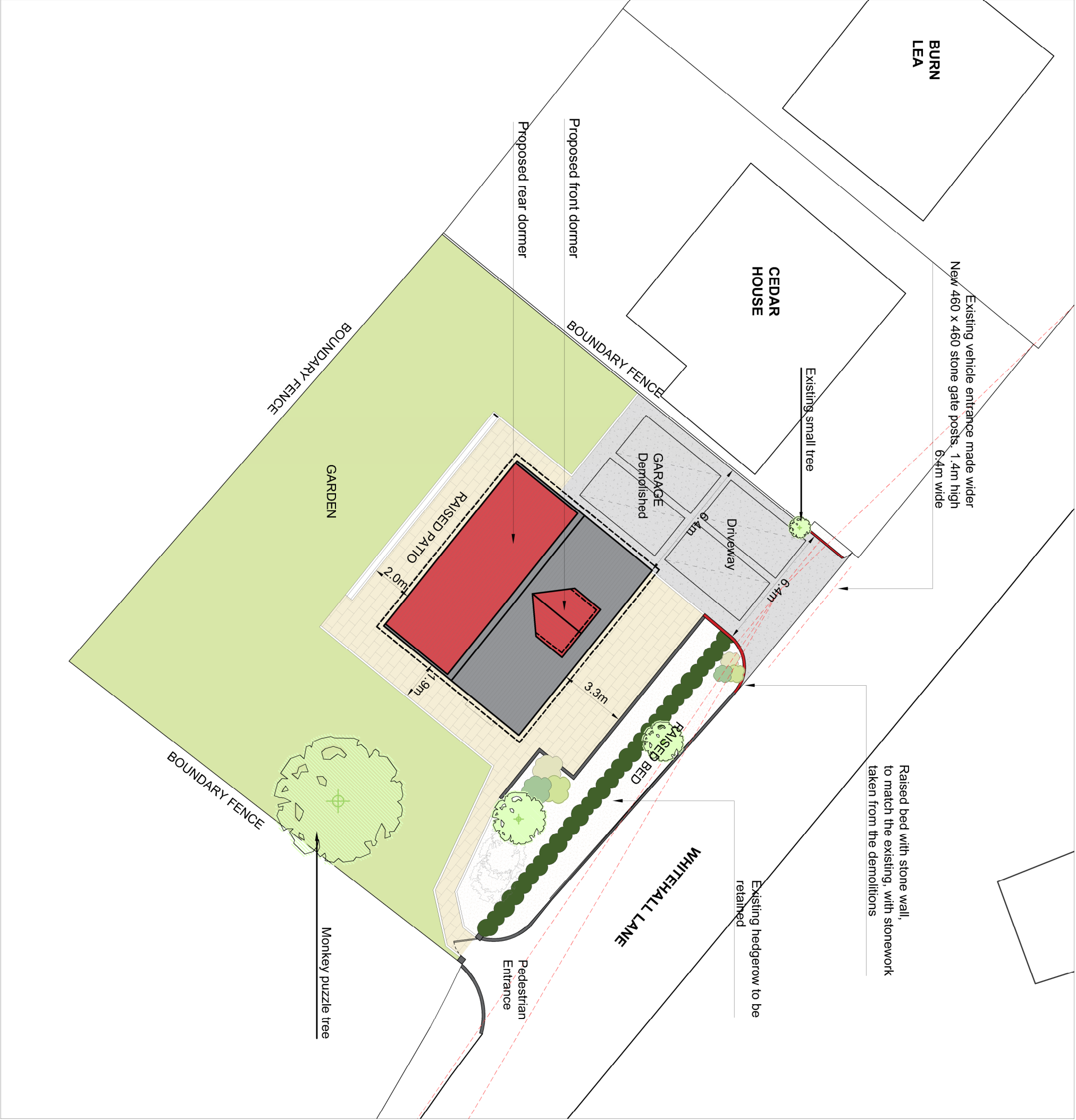

PROPOSED SITE PLAN
SCALE 1,200 A2

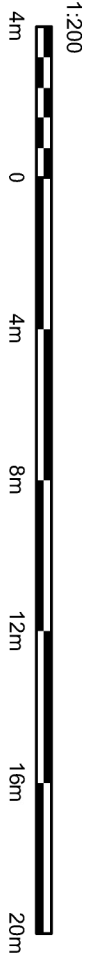

**SUBJECT TO PLANNING APPROVAL FROM
RIBBLE VALLEY BOROUGH COUNCIL**

Four Winds, Whitehall Lane, Gindleton, BB7 4RL	12 08 2024
Proposed extensions and alterations	0123
EXISTING + PROPOSED SITE PLANS	PL .00 .02a