

2
EXISTING WEST
1 : 50

5
AS BUILT WEST
1 : 50

3
PROPOSED WEST
1 : 50

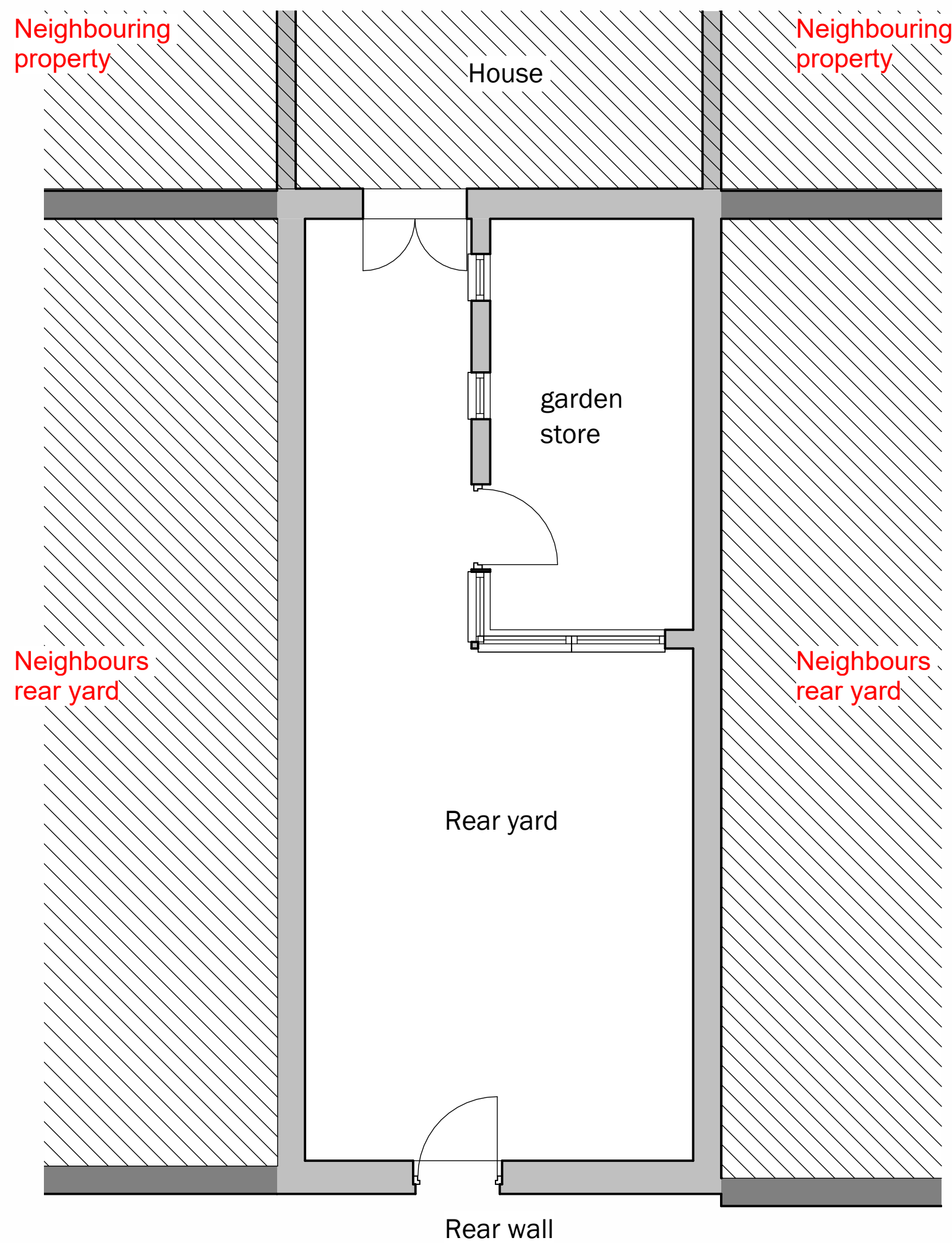
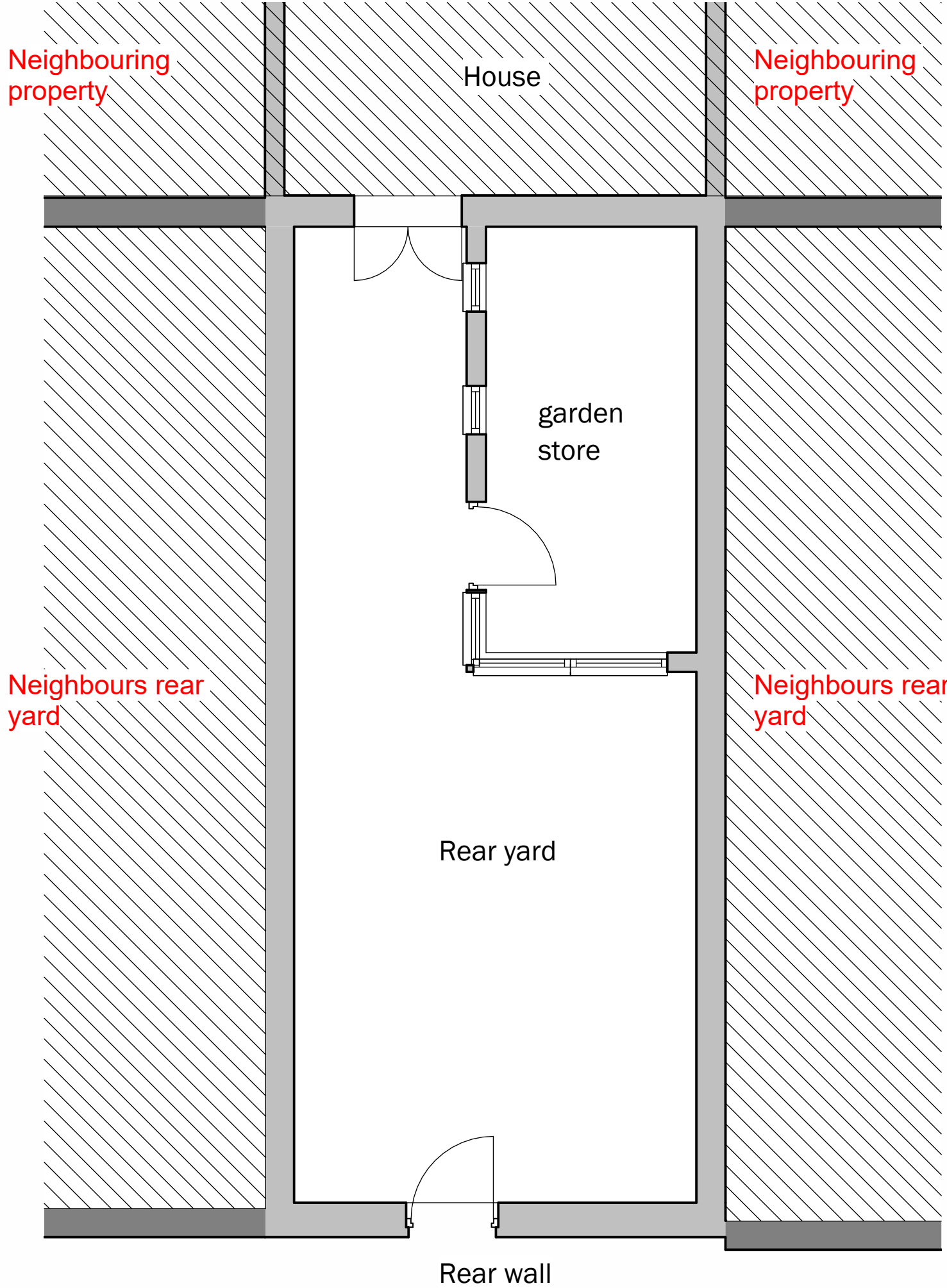
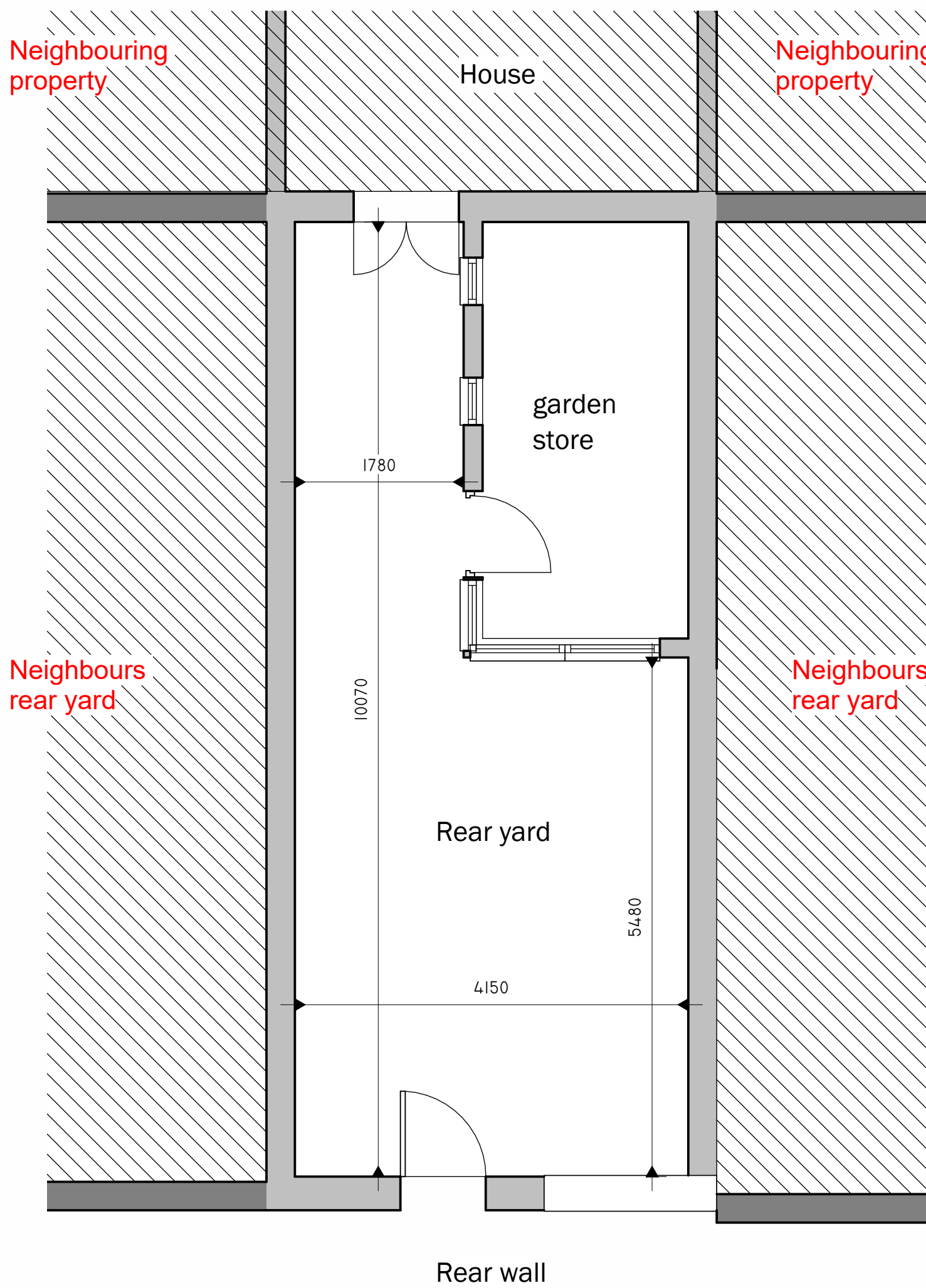

1
EXISTING GROUND FLOOR
1 : 50

6
AS BUILT GROUND FLOOR
1 : 50

4
PROPOSED GROUND FLOOR
1 : 50

Peter Hitchen
Architects

Marathon House
The Sidings Business Park
Whalley, BB7 9SE

01254 823 885

www.peterhitchenarchitects.co.uk

NOTES:

The as built plan & elevation shows the current works up to the date of enforcement correspondence. The Proposed shows the works as completed.

No.	Description	Date

CLIENT:

Caroline Davies

PROJECT:

Proposed boundary wall works at 61 Salthill Road, Clitheroe, Lancashire, BB7 1PE

SHEET:

Existing & Proposed floor plans and elevations

Project number

PHA/946

Date

09/09/2024

Drawn by

AW

Checked by

PH

A2.1

Scale

1 : 50

Sheet size

A1