

TREE PROTECTION PLAN

PRODUCED IN SUPPORT OF PLANNING APPLICATION REF: 3/2024/0766

FOR

PROPOSED CONVERSION OF EXISTING BARN TO ONE NEW DWELLING WITH ASSOCIATED PARKING AND AMENITY SPACE

AT

OLD VICARAGE FARM, TALBOT BRIDGE ROAD, BASHALL EAVES CLITHEROE, BB7 3DB

This tree protection plan has been produced at the request of the RVBC tree / countryside officer to describe the measures which are to be implemented in order to protect a single tree located adjacent to the application site. The tree is not located within the extents of the red edge of the application site but is on land within the ownership of the applicant.

The radial root protection area (RPA) for the tree has been calculated as being twelve times the stem diameter and represents the area where protection of the tree roots during development works is essential to the tree's future health and survival. In this instance, the affected tree will require an RPA with an 8m diameter. In order to prevent harm to the tree appropriate protective fencing will be installed and will be in accordance with BS5837: 2012. Examples of which have been shown later in this document.

PROTECTIVE FENCING

- Once erected all protective fencing will be regarded as sacrosanct and will remain in place until the completion of the construction phase. It shall not be removed, relocated or breached at any time without consultation with the local authority tree / countryside officer.
- Protective fencing will be constructed of robust barriers fit for the purpose of excluding construction traffic from root protection areas. Details of appropriate fencing types are included in Appendix 5.
- Signs will be affixed to every third panel stating 'Tree Protection Area Keep Out.'
- All fencing will be securely affixed to avoid movement of fencing during the construction phase.
- For the sections marked on Appendix 4 fences will be constructed of site fencing of 'Heras' type which must be securely braced with additional measures to prevent movement of the fence during construction.

MITIGATION MEASURES

- Protective fencing installed to prevent mechanical damage to trees adjacent to the development.
- Once installed tree protection must remain in place and be observed at all times.
- No fires within 10m of the crown of any retained trees.

- Soil levels in rooting areas to be retained with minimal level changes, no greater increases than 300mm from existing levels.
- No cement mixing/washout to take place within 15m of any retained trees.
- No chemicals, bitumen etc. to be stored within 10m of any retained trees.
- Any spillage of fuel, chemicals or contaminated water occurring within 2m of the root protection areas to be reported.

EXAMPLES OF PROTECTIVE FENCING

Figure 2 Default specification for protective barrier

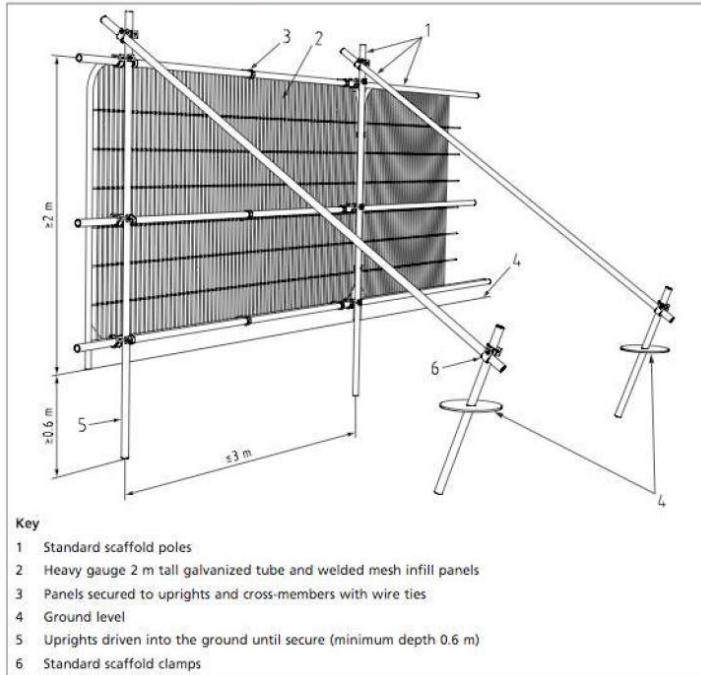
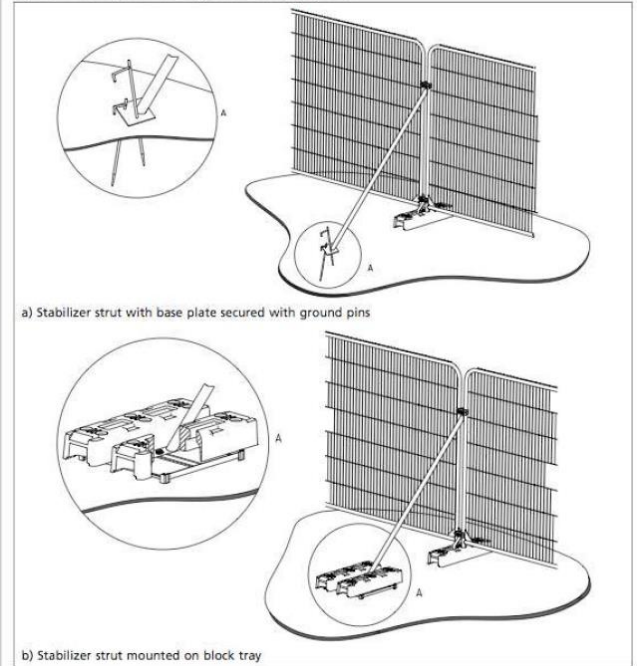

Figure 3 Examples of above-ground stabilizing systems



EXAMPLE OF SIGNING TO BE INSTALLED TO PROTECTIVE FENCING

