

GENERAL NOTES

These plans have been prepared for submission to the Local Authority for Town & Country Planning and/or Building Regulation purposes only and do not constitute full working drawings.

Information noted on the plans or accompanying documents / details is not exhaustive, and contractor to check with client as to any additional work not specifically noted or implied.

© Rural Solutions Limited

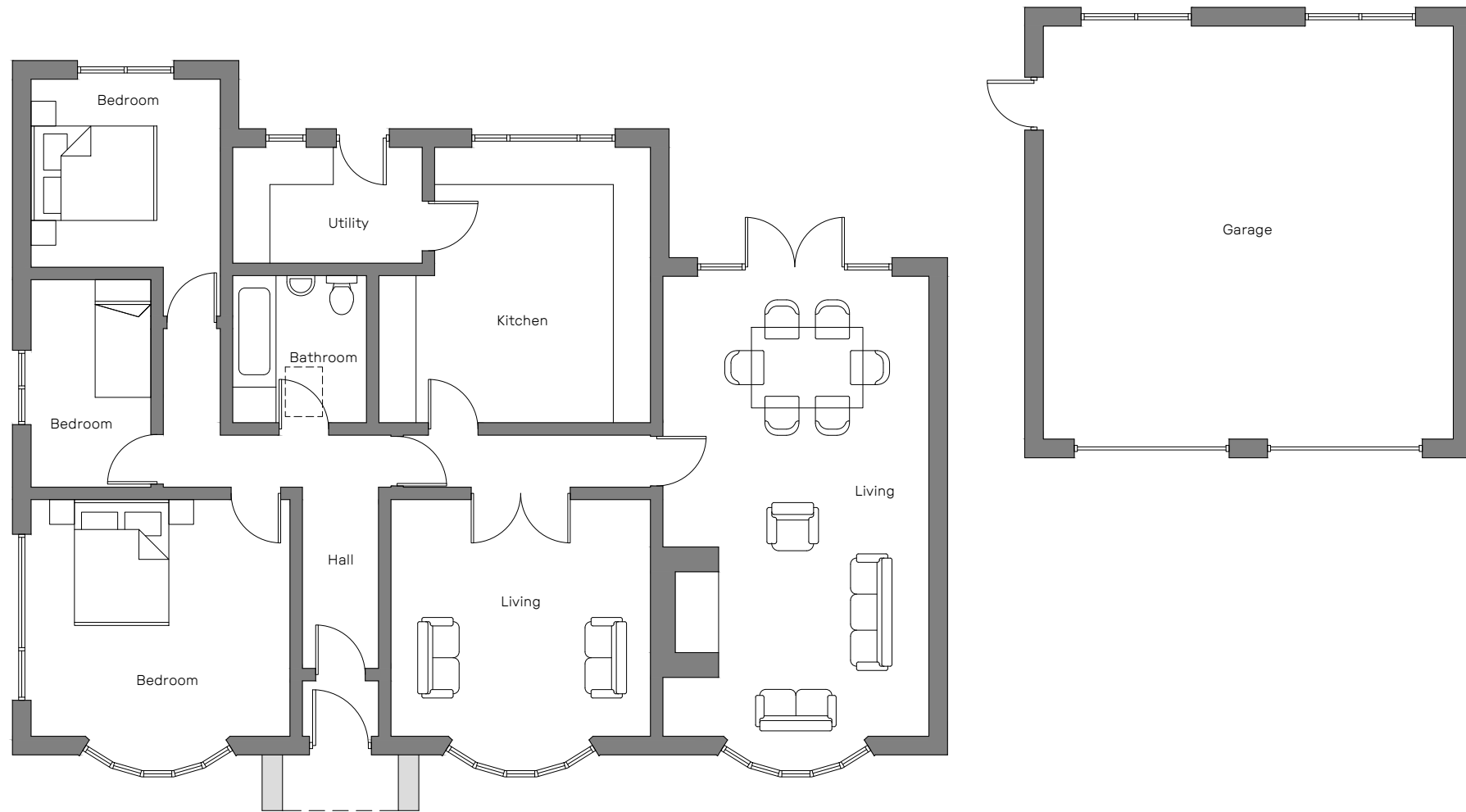

Woodfield Plan As Existing
1:100 @ A3

revisions



Canalside House,
Brewery Lane,
Skipton,
North Yorkshire,
BD23 1DR

tel: 01756 797501
e-mail: info@ruralsolutions.co.uk
web: www.ruralsolutions.co.uk

client

Mr Brett Warburton

project

Woodfield
Ribchester Road, Dinckley

title

Existing Floor Plan

drawn

RW

scale

1:100 @ A3

number

4350-001

status

Planning

checked

JS

date

20.12.24

revision

-