



# **Elite Ecology**

Passionate about Ecology

## **Moor Hey House, Knowle Green**



## **Bird Box Plan**

**November 2024**



01782 308418



admin@eliteecology.co.uk

[www.eliteecology.co.uk](http://www.eliteecology.co.uk)

[www.facebook.com/eliteecology](https://www.facebook.com/eliteecology)

[www.twitter.com/eliteecology](https://www.twitter.com/eliteecology)



The New Barn, Suites 2/3, Shellow Lane,  
Gawsworth, Cheshire, CW12 2FQ



**Document Control****Document Properties**

<b>Organisation</b>	Elite Ecology
<b>Prepared For</b>	████████████████████
<b>Author</b>	M ██████████
<b>Approved (1<sup>st</sup> Checker)</b>	██████████████
<b>Approved (2<sup>nd</sup> Checker)</b>	██████████████
<b>Title</b>	Moor Hey House, Knowle Green Bird Box Plan

**Version History**

<b>Date</b>	<b>Version</b>	<b>Status</b>	<b>Description/Changes</b>
15/11/2024	V1	Draft	First Draft
15/11/2024	V1	Final Report	Proof Read

**Contents**

<b>1. Introduction .....</b>	<b>3</b>
1.1 Report Rationale .....	3
1.2 Site Description.....	3
1.3 Proposal .....	3
<b>2. Recommendations .....</b>	<b>5</b>
2.1 Birds .....	5
<b>3. References.....</b>	<b>8</b>
<b>4. Appendices.....</b>	<b>9</b>
Appendix A: Site Plans .....	10
<b>5. Notice to Readers: Conditions of this Report.....</b>	<b>12</b>

## **1. Introduction**

### **1.1 Report Rationale**

This report has been prepared at the request of Ms. Laura Depla (proprietor). It relates to the proposed development site located at Moor Hey House, Stoneygate Lane, Knowle Green, PR3 2XE (OS Grid Reference: SD 64333 38501).

This report is to address condition 7 of the planning approval which states:

7. No development, including any site preparation, demolition, scrub/hedgerow clearance or tree works/removal shall commence or be undertaken on site until details of the provisions of artificial bird nesting boxes have been submitted to, and approved in writing by the Local Planning Authority. The details shall be submitted on a dwelling/ building dependent bird species development site plan and include details of the numbers of artificial bird nesting boxes and their type. The details shall also identify the actual wall and roof elevations, or specific trees, into which the above provisions shall be incorporated.

The artificial bird boxes shall be installed in accordance with the agreed details before the development is first brought into use and retained thereafter unless otherwise agreed in writing by the Local Planning Authority.

Reason: In the interest of biodiversity and to enhance nesting opportunities for species of conservation concern and to reduce the impact of development.

### **1.2 Site Description**

The site is located in a rural setting near the settlement of Knowle Green, Lancashire. The habitats on site include amenity garden space, as well as some ornamental shrub planting. A number of trees are also located on site and directly adjacent. The building of interest measures approximately 120m<sup>2</sup>.

The wider landscape features further habitats. These come in the form of broad-leaved semi-natural woodland, hard standing ground, pastureland, heathland, hedgerows, scattered trees, and standing water. The habitats that are present in and around the site contain all the elements that are critical in bird life cycles.

### **1.3 Proposal**

Current proposals are to undergo a single storey extension to side, alterations to fenestration, new detached garage subsequent to demolition of existing lean-to extension and detached garages.



**Figure 1:** An aerial map showing the location of the site Moor Hey House, Knowle Green (yellow star) in relation to some of the local landscape.

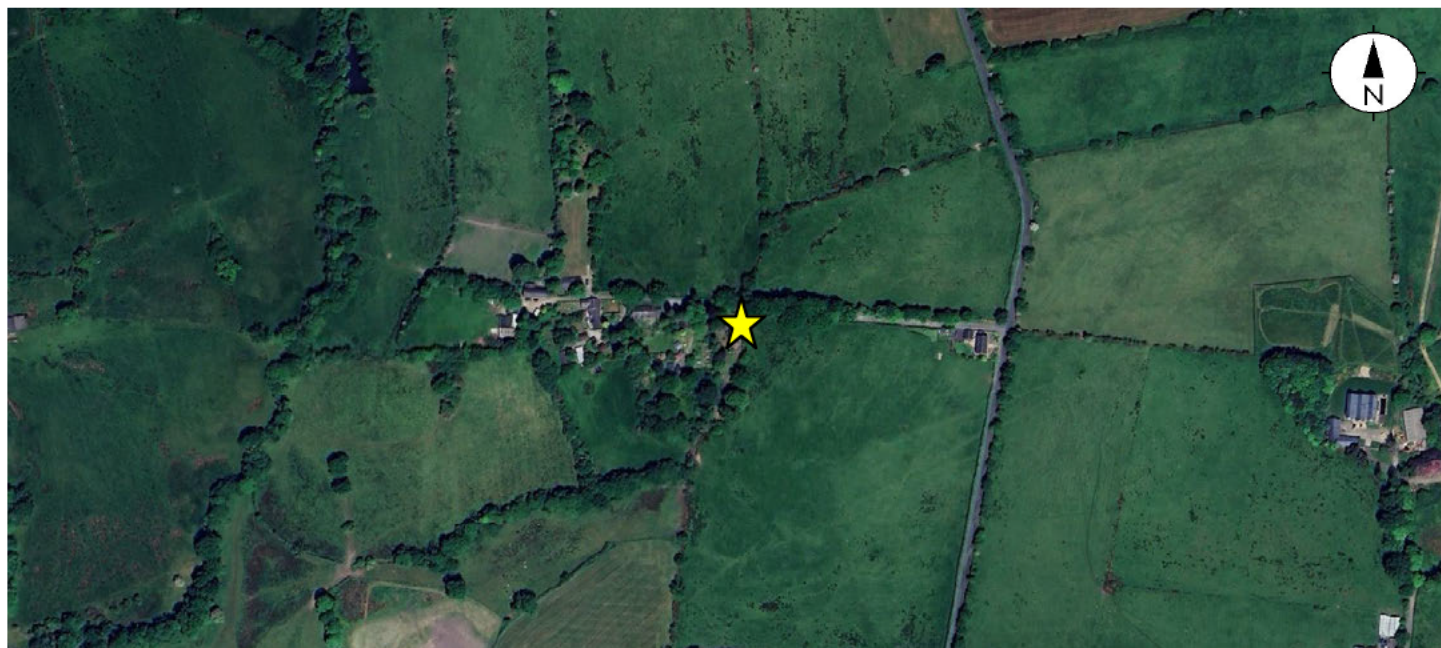

**Figure 2:** An OS map obtained from Bing showing the location of Moor Hey House, Knowle Green (yellow star).



## **2. Recommendations**

---

### **2.1 Birds**

The development site should be enhanced for birds by installing a variety of bird boxes on site. The development should incorporate a minimum of the following:

- One Apex Bird Box.
- Two Swift Nest Boxes
- Two Robin and Wren nest boxes
- One Sparrow Terrace Nest Box

Boxes can be purchased by emailing [admin@eliteecology.co.uk](mailto:admin@eliteecology.co.uk).

The Apex Bird Box, Sparrow Terrace Nest Box, and two Swift Nest Boxes will be placed on the north-eastern elevation, thus avoiding strong sunlight and the wettest winds. The two robin and wren nest boxes will be installed facing north-east sheltered from the prevailing wind and rain within the cover of overhanging vegetation.

#### **Advice for putting up nest boxes**

- **Not too close to another nest box:** Nest boxes of the same type should not be sited too close together as this may promote aggressive behaviour between neighbours.
- **Shelter the box from weather:** The front of the nest box should be angled vertically or slightly downwards to prevent rain from entering the nest box. Make sure it is sheltered from prevailing wind, rain, and strong sunlight.
- **Height from the ground should be three metres:** Small-hole boxes are best placed 1-3m above ground on tree trunks, but avoid sites where foliage obscures the entrance hole. If there are no trees in your garden, the next best option is to place the box on the side of a shed or wall.
- **Open-fronted nest boxes should be hidden from view:** Attach it to a wall or fence that has shrubs and creepers growing against it.
- **Make sure cats cannot get into the box:** Ensure that it is not easily accessible to predators (cats and squirrels).
- **Consider a metal plate around hole to deter squirrels:** This preventive measure that can be used to deter squirrels from gaining access. These plates are available commercially and can be purchased from any good garden centre or bird care company at very little cost.
- **Keep nest box away from bird feeders:** As high levels of activity of visiting birds could disturb nesting pairs.
- **Use galvanized or stainless-steel screws or nails that will not rust:** If fixing boxes to trees, galvanised wire can be used to tie the box to the trunk or hang it from a branch. Make sure to regularly inspect these fittings to ensure the box remains securely attached.
- **Traditionally, nest boxes for small birds are put up in the spring:** Pairs begin to prospect in the latter half of February, so a box put up at the end of the winter stands a good chance of attracting nesting birds. However, it is never too early or late to put up a nest box, as some birds will use them to roost in during the winter months.

## Bird Box Plan

**Figure 3:** Annotated site plan illustrating the location of the two RSPB Robin and wren diamond nest boxes (as shown by the yellow shapes).

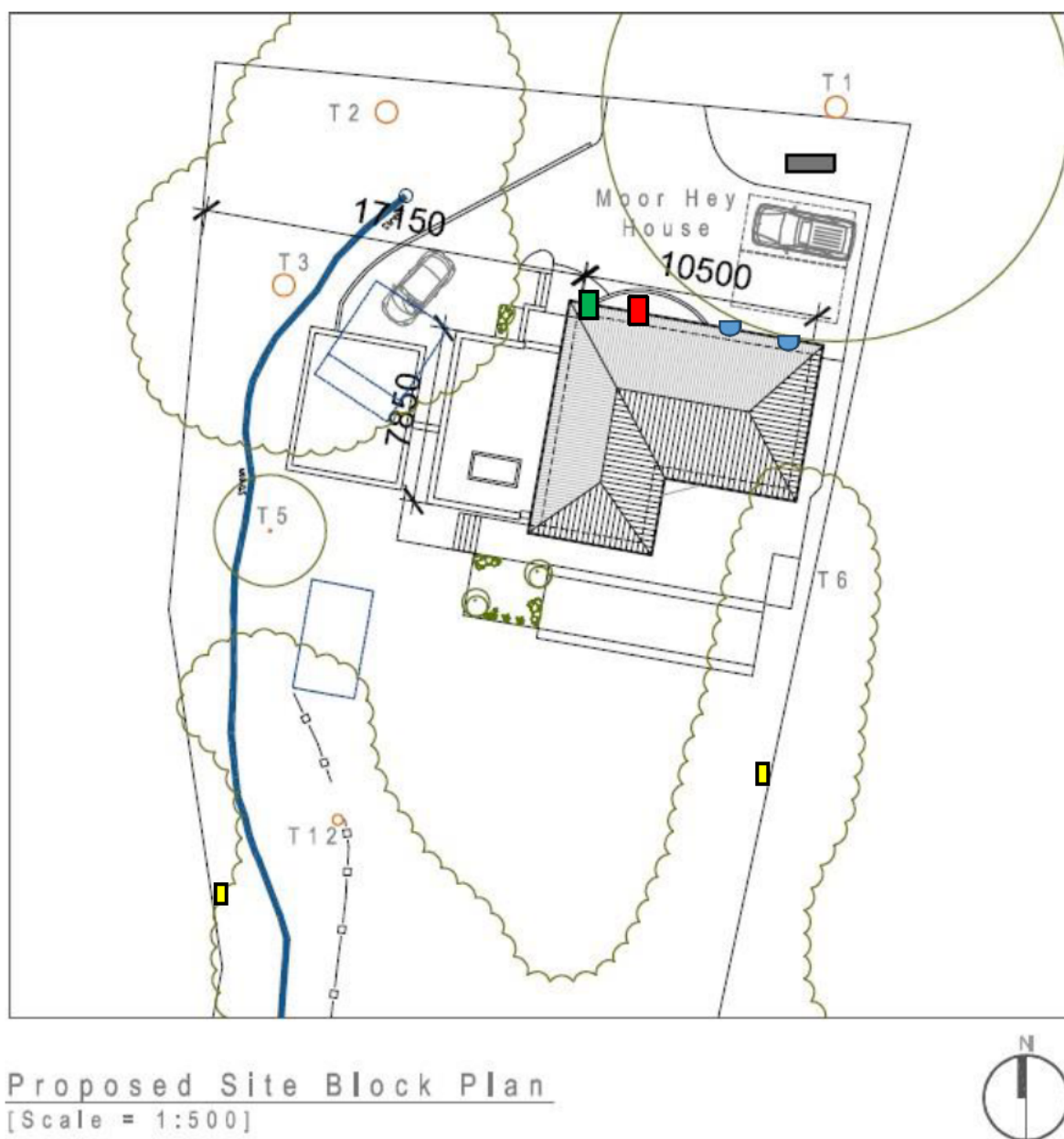

## Bird Box Plan

**Figure 4:** Plans of the north-eastern elevation, illustrating the location of the two swift nest boxes (blue shapes), the one Sparrow Terrace Nest Box (green shape) and the one Apex Bird Box (red shape).





### **3. References**

---

Bickmore, C. J. (2002). Hedgerow Survey Handbook. London: DEFRA

Biodiversity 2020: A strategy for England's wildlife and ecosystem services (2011).

Blakesley, D. & Buckley, P. (2010). Woodland creation for wildlife and people in a changing climate.

Defra (2007a) Securing a Healthy Natural Environment: an action plan for embedding an ecosystems approach. PB12853. Defra London.

Defra (2007b) An Introductory Guide to Valuing Ecosystems Services. PB12852. Defra London.

Dietz, C., von Helversen, O. & Nill, D. (2009) Bats of Britain, Europe and Northwest Africa. London: A. C. Black.

Gunnell, K., Grant, G. and Williams, C. (2012) Landscape and urban design for bats and biodiversity. Bat Conservation Trust.

Gunnell, K., Murphy, B. and Williams, C. (2013) Design for Biodiversity: A Technical Guide for New and Existing Buildings. Bat Conservation Trust.

Institute of Ecology and Environmental Management, Professional Guidance Series.

Kirby, P. (2013). Habitat Management for Invertebrates. Exeter: Pelagic Publishing.

The natural choice: securing the value of nature (2011) (Natural Environment White Paper).

#### **4. Appendices**

---

##### **Appendix A: Site Plans**

## Bird Box Plan

## Appendix A: Site Plans

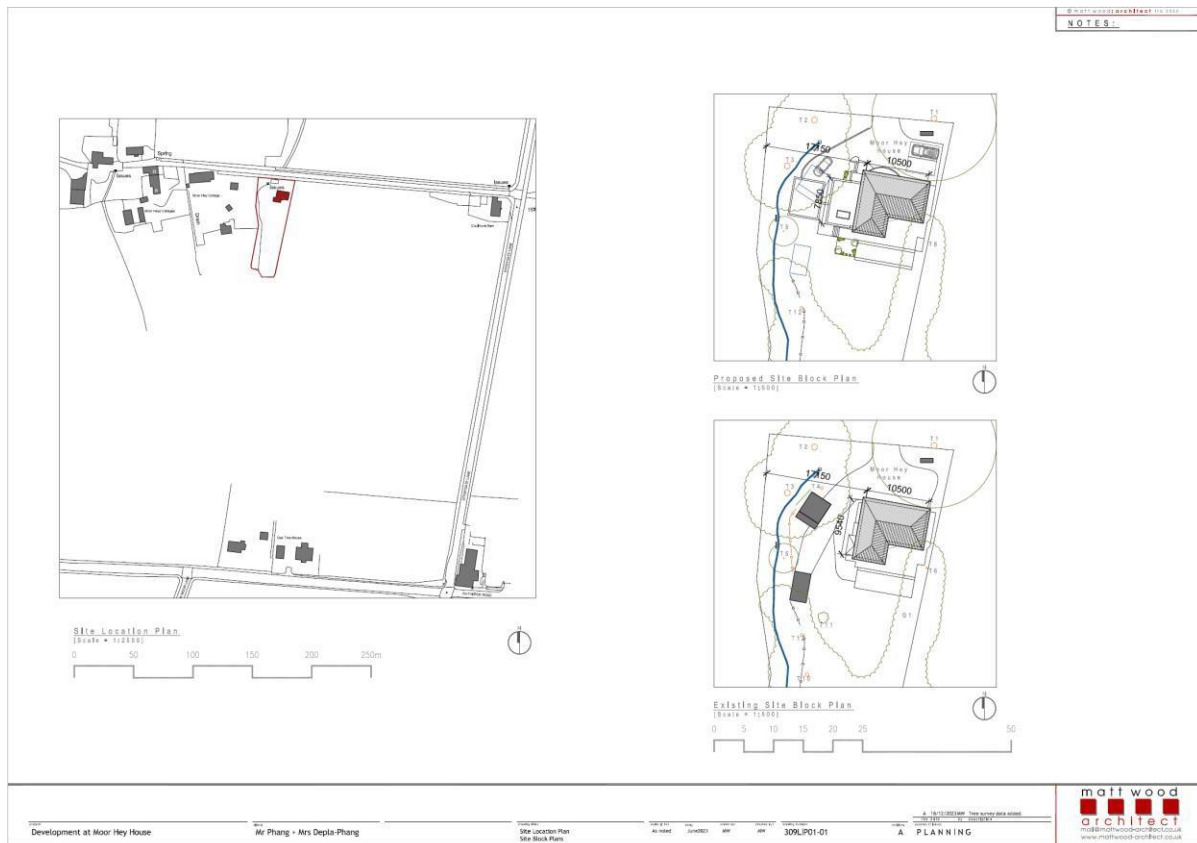

Bird Box Plan



---

## 5. Notice to Readers: Conditions of this Report

---

All reports are certified products and cannot be shown, copied, or distributed to third parties without the written permission of Elite Ecology. No liability is accepted for the contents of the report, other than to that of the client(s). If any part of this report is altered without the written permission of Elite Ecology, then the whole report becomes invalid.

Elite Ecology agrees to supply ecological consulting services and advice of a preliminary or thorough nature as advised or commissioned. Upon commissioning Elite Ecology to undertake the work, the client(s) grant access to the site upon the agreed date. If no site access is available upon this date, Elite Ecology holds the right to charge the client(s) for lost staffing time and additional travel costs.

Elite Ecology undertake all site surveys with reasonable skill, care, and diligence, within the terms of the contract that has been agreed with the client and abiding by the Elite Ecology Terms and Conditions. The actions of the surveyors on site, and during the production of the report, were undertaken in accordance with the Code of Professional Conduct for the Chartered Institute of Ecology and Environmental Management.

The latest good practice guidelines put in place by Natural England or the relevant statutory conservation bodies have been followed by the surveyors on site. If those methodologies fail to identify a protected species during the survey efforts, no responsibility can be attributed to Elite Ecology. If any of these guidelines are adapted between the date(s) of the surveys being undertaken and the submission of this report, then Elite Ecology takes no responsibility for this.

Should any equipment be damaged or lost on site at the fault of the client(s), then Elite Ecology withholds the right to charge 100% above the current market value for that exact product or the nearest similar product.

The survey results purport the current status of the site and its potential for protected species utilisation at the time of surveying. It should not be viewed as a complete list of the possible flora and fauna species that could be using the site at different times of the year.

Elite Ecology has been provided with full payment for this report and thus the product has been released to the client(s) for the purpose of their planning application. If any part of the report is lost or altered without the written permission of Elite Ecology, then the entire report becomes invalid. Due to the potential for continual change within the natural world, this report is valid for **2 years only** from the date of the last survey visit. If this report is submitted after the 2 year deadline, then a further updated inspection will be required to ascertain whether the site remains in the same condition as it was when initially inspected.

No reliance should be made on any such comments in relation to the structural integrity of the features located on the surveyed site. All information within the report is based solely on evidence that has been found on site during the service provided. No individual opinion or inference will be made other than that of the suitably qualified ecologist appointed to the project.