

Writtenstone Farm Writtenstone Lane



Re-roof and re-point listed house and front garden wall

Rainwater Goods Spec

Jan 2025



Figure 1 Existing gutters and downpipes to West Elevation (East Elevation is uPVC)

New cast iron gutters to replace existing uPVC on the East Elevations to match those on the West. Existing cast iron on the West Elevation to be removed, stripped and repaired and repainted in black and refitted in the same location with the same brackets using zinc plated steel fixings.

New/replacement components including gutters and downspouts to be by Hargreaves Foundry Water Lane Halifax HX3 9HG 01422 330607 [Premier Rainwater BS460](#)

All goods to be from their Premier Range (BS 460) Downpipes will be from the XR range at 75mm dia. whilst gutters will be from the XHR range 125mm dia.

Gutter brackets will be rise and fall XHR5043. Downpipe brackets will have eared spigots XR3050SE.

Standard half round gutter profile and round downpipes in 2pk polyurethane high gloss black finish with single piece sockets cast centrifugally.

Existing goods are to be stripped and primed using Hargreaves RAL7024 dark grey primer and finished with Hargreaves Premier Extra in black Gloss paint finish

PREMIER PAINT



PREMIER PAINT

For a detailed guide to our paint finishes please visit www.hargreavesfoundry.co.uk

A good paint finish is vital to the performance and longevity of a Cast Iron rainwater and soil drainage system. Primers and finished coatings protect the underlying substrate by providing a barrier between the Cast Iron and corroding elements. Hargreaves Foundry Drainage offer the following paint finishes, all of which are carried out by paint specialists in factory conditions.

PREMIER PRIMED

The main functions of primers are to;

- Provide a surface that subsequent coats of paint can easily adhere to
- Provide short term protection to the surface until it can be top coated

At Hargreaves the primer paints used are RAL 7024 dark grey in colour and have been specifically formulated to create a barrier to corrosion. The primers can be overcoated with Epoxy, Polyurethane or Acrylic paints.

Products are coated internally and externally. The primer coated supplied products are classed as a transit coating and provide short term protection during delivery and undercover storage.

PREMIER EXTRA

Hargreaves Premier Extra is an exterior coating, high solids, black gloss paint. Black is our standard painted product and available off the shelf on a 3 to 5-day delivery. High solids gloss paints offer

greater durability than paints with a lower solids content.

RAL COLOURS

This bespoke painting service is available on our Premier Rainwater and Traditional Express systems. We can supply any RAL or BS colour reference, we are also able to offer a colour matching service taken from an existing sample.

All RAL coloured products are delivered with a matching tin of touch up paint to make good on any exposure of bare iron as a result of transit and or installation damage.

Due to the bespoke paint requirements, these products are not available on our standard 3 to 5-day delivery. Additional charge applicable.

COASTAL AREAS

Coastal regions are difficult to define, however for the purpose of this document and Hargreaves guidelines, they are described as those areas within 5km of the coast.

The conditions in these areas are more aggressive than those experienced in many other areas. It is therefore very important that any paint chips or impact / installation damage is rectified straight away. Failure to rectify damage at an early stage, will lead to corrosion of the product progressing at an increased rate above what would be seen at an inland location.

To combat this aggressive environment, the overall coating thickness on the Premier Coastal products is much greater. This increased coating thickness forms a longer-lasting barrier between the environment and the substrate thus delaying the onset of corrosion.

It is imperative that a robust maintenance regime is put in place to ensure that no salt or other contaminants are able to build up on the surface of the coating. Irrespective of the volume and quality of coating applied, regular maintenance and repainting will be required to ensure your Cast Iron products can continue to combat the harsh environments that coastal conditions present.

When using our Premier Rainwater, LCC Soil or Traditional Express systems in coastal areas, we advise speaking to us regarding our Coastal paint options. These are designed to provide increased protection levels for these product systems beyond that of the standard paint finish.

Due to the bespoke paint requirements, these products are not available on our standard 3 to 5-day delivery. Additional charge applicable.

TRADITIONAL LCC SOIL

Traditional LCC Soil (BS416) is coated in a bitumen paint. The main components of Bitumen paint are naphtha (petroleum) based.

In the past Bitumen was the main choice for traditional soil drainage due to its resistance to moisture and good coverage of uneven surfaces. Normally this type of finish can't be over painted with other paint types, because not only will harder materials used for over coating tend to crack or craze, but there is also the possibility that the Bitumen will bleed through. We cannot, therefore, recommend overpainting as a viable option.

If the colour is important to your project, we can recommend our Traditional Express (TX) system, (see page 73).



Our ex stock pipes are available off the shelf in sizes 65mm (2.5 inch), 75mm (3 inch) 100mm (4 inch) 150mm (6 inch). In addition to the pipes there is a full range of standard fittings. Cast Iron rainwater pipes have been serving buildings effectively for centuries and continue to offer value for money and reliability.

BS 460 RAINWATER PIPES EX STOCK



ROUND RAINWATER PIPES & FITTINGS

8-9

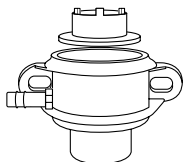
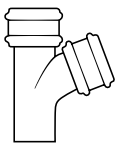
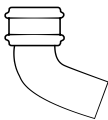
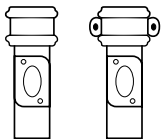
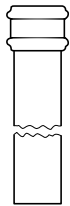
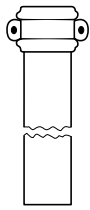

EARED PIPES								
	Premier (Primed)				Premier Extra (Black)			
Description	65mm [2.5"]	75mm [3"]	100mm [4"]	150mm [6"]	65mm [2.5"]	75mm [3"]	100mm [4"]	150mm [6"]
1829mm [6FT] Eared	R2501E £140.32	R3001E £140.32	R4001E £188.32	R6001E £364.40	XR2501E £172.07	XR3001E £172.07	XR4001E £230.97	XR6001E £437.23
1219mm [4FT] Eared	R2504E £125.76	R3004E £125.76	R4004E £157.09	R6004E £332.34	XR2504E £154.24	XR3004E £154.24	XR4004E £192.68	XR6004E £398.80
914mm [3FT] Eared	R2503E £114.60	R3003E £114.60	R4003E £142.05	R6003E £314.12	XR2503E £140.53	XR3003E £140.53	XR4003E £174.24	XR6003E £376.86
610mm [2FT] Eared	R2502E £114.60	R3002E £114.60	R4002E £142.05	R6002E £314.12	XR2502E £140.53	XR3002E £140.53	XR4002E £174.24	XR6002E £376.86
1829mm [6FT] Double Socket Eared	R2501DE £182.52	R3001DE £182.52	R4001DE £244.97	R6001DE £437.23	XR2501DE £228.11	XR3001DE £228.10	XR4001DE £293.95	XR6001DE £524.66
PLAIN PIPES								
	Premier (Primed)				Premier Extra (Black)			
Description	65mm [2.5"]	75mm [3"]	100mm [4"]	150mm [6"]	65mm [2.5"]	75mm [3"]	100mm [4"]	150mm [6"]
1829mm [6FT] Plain	R2501 £131.41	R3001 £131.41	R4001 £179.27	R6001 £355.15	XR2501 £161.16	XR3001 £161.16	XR4001 £219.87	XR6001 £426.40
1219mm [4FT] Plain	R2504 £115.51	R3004 £115.51	R4004 £147.17	R6004 £322.33	XR2504 £141.65	XR3004 £141.65	XR4004 £180.50	XR6004 £386.77
914mm [3FT] Plain	R2503 £103.24	R3003 £103.24	R4003 £130.36	R6003 £294.02	XR2503 £126.62	XR3003 £126.62	XR4003 £159.90	XR6003 £352.77
610mm [2FT] Plain	R2502 £103.24	R3002 £103.24	R4002 £130.36	R6002 £294.02	XR2502 £126.62	XR3002 £126.62	XR4002 £159.90	XR6002 £352.77
1829mm [6FT] Double Socket Plain	R2501D £170.71	R3001D £170.71	R4001D £233.05	R6001D £426.40	XR2501D £213.39	XR3001D £213.39	XR4001D £279.69	XR6001D £511.69
ACCESS PIPES								
	Premier (Primed)				Premier Extra (Black)			
Description	65mm [2.5"]	75mm [3"]	100mm [4"]	150mm [6"]	65mm [2.5"]	75mm [3"]	100mm [4"]	150mm [6"]
Oval Door Eared	R2510E £151.24	R3010E £151.24	R4010E £231.93	R6010E £589.24	XR2510E £171.20	XR3010E £171.20	XR4010E £262.56	XR6010E £648.14
Oval Door Plain	R2510 £109.87	R3010 £109.87	R4010 £214.49	R6010 £545.27	XR2510 £124.38	XR3010 £124.38	XR4010 £242.81	XR6010 £584.48
BENDS								
	Premier (Primed)				Premier Extra (Black)			
Description	65mm [2.5"]	75mm [3"]	100mm [4"]	150mm [6"]	65mm [2.5"]	75mm [3"]	100mm [4"]	150mm [6"]
92.5°	R2520 £41.48	R3020 £50.43	R4020 £71.32	R6020 £345.37	XR2520 £46.98	XR3020 £57.09	XR4020 £80.75	XR6020 £379.86
112.5°	R2521 £41.48	R3021 £50.43	R4021 £71.32	R6021 £345.37	XR2521 £46.98	XR3021 £57.09	XR4021 £80.75	XR6021 £379.86
135°	R2522 £41.48	R3022 £50.43	R4022 £71.32	R6022 £345.37	XR2522 £46.98	XR3022 £57.09	XR4022 £80.75	XR6022 £379.86
BRANCHES								
	Premier (Primed)				Premier Extra (Black)			
Description	65mm [2.5"]	75mm [3"]	100mm [4"]	150mm [6"]	65mm [2.5"]	75mm [3"]	100mm [4"]	150mm [6"]
92.5°	R2530 £80.13	R3030 £88.24	R4030 £104.77	R6030 £357.42	XR2530 £90.72	XR3030 £99.89	XR4030 £118.61	XR6030 £393.10
112.5°	R2531 £80.13	R3031 £88.24	R4031 £104.77	R6031 £357.42	XR2531 £90.72	XR3031 £99.89	XR4031 £118.61	XR6031 £393.10
135°	R2532 £80.13	R3032 £88.24	R4032 £104.77	R6032 £357.42	XR2532 £90.72	XR3032 £99.89	XR4032 £118.61	XR6032 £393.10
LOOSE SOCKETS								
	Premier (Primed)				Premier Extra (Black)			
Description	65mm [2.5"]	75mm [3"]	100mm [4"]	150mm [6"]	65mm [2.5"]	75mm [3"]	100mm [4"]	150mm [6"]
With Spigot Eared	R2550SE £27.80	R3050SE £27.63	R4050SE £37.74	R6050SE £152.88	XR2550SE £33.90	XR3050SE £33.90	XR4050SE £46.29	XR6050SE £168.16
With Spigot Plain	R2550S £24.82	R3050S £24.82	R4050S £36.36	R6050S £143.24	XR2550S £30.42	XR3050S £30.42	XR4050S £44.59	XR6050S £157.49
DIVERTER KITS								
	Premier (Primed)				Premier Extra (Black)			
Description	65mm [2.5"]	75mm [3"]	100mm [4"]	150mm [6"]	65mm [2.5"]	75mm [3"]	100mm [4"]	150mm [6"]
Left Hand Eared [as shown]	R2550DLE £89.52	R3050DLE £89.52	R4050DLE £102.45		XR2550DLE £98.47	XR3050DLE £98.47	XR4050DLE £122.97	
Right Hand Eared	R2550DRE £89.52	R3050DRE £89.52	R4050DRE £102.45		XR2550DRE £98.47	XR3050DRE £98.47	XR4050DRE £122.97	
Plain	R2550D £86.66	R3050D £86.66	R4050D £101.05		XR2550D £94.99	XR3050D £94.99	XR4050D £121.24	

Ears can be fitted to any item on request – POA.

OFFSETS

Description	Premier [Primed]				Premier Extra [Black]			
	65mm [2.5"]	75mm [3"]	100mm [4"]	150mm [6"]	65mm [2.5"]	75mm [3"]	100mm [4"]	150mm [6"]
75mm [3"] Projection	R2540 £63.50	R3040 £63.50	R4040 £119.78	R6040 £376.90	XR2540 £71.89	XR3040 £71.89	XR4040 £135.63	XR6040 £414.63
115mm [4.5"] Projection	R2541 £63.50	R3041 £63.50	R4041 £119.78	R6041 £376.90	XR2541 £71.89	XR3041 £71.89	XR4041 £135.63	XR6041 £414.63
150mm [6"] Projection	R2542 £63.50	R3042 £63.50	R4042 £119.78	R6042 £376.90	XR2542 £71.89	XR3042 £71.89	XR4042 £135.63	XR6042 £414.63
230mm [9"] Projection	R2543 £73.83	R3043 £73.83	R4043 £145.10	R6043 £428.28	XR2543 £83.59	XR3043 £83.59	XR4043 £164.25	XR6043 £471.10
305mm [12"] Projection	R2544 £86.58	R3044 £86.58	R4044 £145.10	R6044 £489.07	XR2544 £97.99	XR3044 £97.99	XR4044 £164.25	XR6044 £546.72
380mm [15"] Projection	R2545 £172.65	R3045 £172.65	R4045 £235.80	R6045 £675.65	XR2545 £195.45	XR3045 £195.45	XR4045 £266.95	XR6045 £743.26
457mm [18"] Projection	R2546 £202.26	R3046 £202.26	R4046 £286.52	R6046 £776.46	XR2546 £228.95	XR3046 £228.95	XR4046 £324.37	XR6046 £854.17
533mm [21"] Projection	R2547 £252.47	R3047 £252.47	R4047 £380.96	R6047 £793.03	XR2547 £285.80	XR3047 £285.80	XR4047 £419.05	XR6047 £872.36
610mm [24"] Projection	R2548 £252.47	R3048 £252.47	R4048 £380.96	R6048 £793.04	XR2548 £285.80	XR3048 £285.80	XR4048 £419.05	XR6048 £872.36

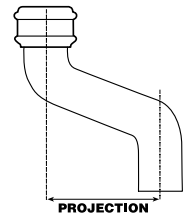

SHOES

Description	Premier [Primed]				Premier Extra [Black]			
	65mm [2.5"]	75mm [3"]	100mm [4"]	150mm [6"]	65mm [2.5"]	75mm [3"]	100mm [4"]	150mm [6"]
Eared	R2551E £67.82	R3051E £67.82	R4051E £88.24	R6051E £306.05	XR2551E £76.80	XR3051E £76.80	XR4051E £99.89	XR6051E £336.64
Plain	R2551 £58.78	R3051 £58.78	R4051 £79.15	R6051 £297.26	XR2551 £66.56	XR3051 £66.56	XR4051 £89.63	XR6051 £326.92
Anti-Splash Eared	R2552E £125.12	R3052E £125.12	R4052E £169.45	R6052E £535.52	XR2552E £141.63	XR3052E £141.63	XR4052E £191.83	XR6052E £624.50
Anti-Splash Plain	R2552 £113.44	R3052 £113.44	R4052 £158.50	R6052 £531.08	XR2552 £128.44	XR3052 £128.44	XR4052 £179.43	XR6052 £619.23

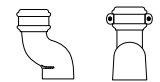
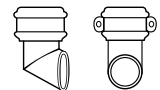

HOLDFAST

Description	Premier [Primed]				Premier Extra [Black]			
	65mm [2.5"]	75mm [3"]	100mm [4"]	150mm [6"]	65mm [2.5"]	75mm [3"]	100mm [4"]	150mm [6"]
Steel Holdfast	R2555 £11.48	R3055 £11.48	R4055 £12.93	R6055 £21.30	XR2555 £12.65	XR3055 £12.65	XR4055 £14.13	XR6055 £23.39



PIPE BRACKET

Description	Zinc Plated				Premier Extra [Black]			
	65mm [2.5"]	75mm [3"]	100mm [4"]	150mm [6"]	65mm [2.5"]	75mm [3"]	100mm [4"]	150mm [6"]
"Screw to Wall Supplied with Rubber Gasket"	R2561G £24.12	R3061G £24.12	R4061G £24.85	R6061G £34.14	XR2561G £27.29	XR3061G £27.29	XR4061G £28.16	XR6061G £37.33

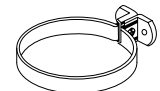

SPACER PLATE

Description	Premier [Primed]				Premier Extra [Black]			
	65mm [2.5"]	75mm [3"]	100mm [4"]	150mm [6"]	65mm [2.5"]	75mm [3"]	100mm [4"]	150mm [6"]
30mm Projection	R2570 £15.59	R3070 £15.59	R4070 £16.15	R6070 £35.02	XR2570 £19.50	XR3070 £19.50	XR4070 £20.19	XR6070 £43.77

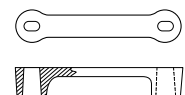

BOBBINS

Description	
Wooden 30mm Projection	R0001 £2.63
Metal 13mm Projection	R0002 £7.35

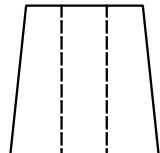

PIPE NAILS

Description	
75mm [3"] to Suit all Pipe Sizes	R0003 £0.89
100mm [4"] to Suit all Pipe Sizes	R0004 £0.98

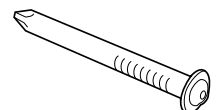

Ears can be fitted to any item on request – POA.



Products can be supplied in any RAL or BS colour.
We can also colour match from customer supplied samples.
Price on application.

We offer eight different gutter profiles as ex stock. These products are all tried and tested and are the most popular choices for traditional gutters. As ex stock items they are available 'off the shelf' on our standard 3 to 5 day delivery or less on our enhanced delivery service. Also available is a full range of brackets and sundries for installation.

RAINWATER GUTTERS EX STOCK



PLAIN HALF ROUND GUTTERS & FITTINGS	11
BEADED HALF ROUND GUTTERS & FITTINGS	12
PLAIN DEEP HALF ROUND GUTTERS & FITTINGS	13
BOX GUTTERS & FITTINGS	14

OG GUTTERS & FITTINGS	15
NOTTS OG GUTTERS & FITTINGS	16
G46 MOULDED GUTTERS & FITTINGS	17
H16 MOULDED GUTTERS & FITTINGS	18

PLAIN HALF ROUND GUTTER								
	Premier [Primed]				Premier Extra [Black]			
Description	100mm [4"]	115mm [4.5"]	125mm [5"]	150mm [6"]	100mm [4"]	115mm [4.5"]	125mm [5"]	150mm [6"]
1829mm [6FT] with external joint	HR4001 £71.47	HR4501 £74.42	HR5001 £86.99	HR6001 £148.28	XHR4001 £88.42	XHR4501 £91.99	XHR5001 £107.47	XHR6001 £163.78
ANGLES								
	Premier [Primed]				Premier Extra [Black]			
Description	100mm [4"]	115mm [4.5"]	125mm [5"]	150mm [6"]	100mm [4"]	115mm [4.5"]	125mm [5"]	150mm [6"]
Square [90°] Left Hand	HR4010 £29.72	HR4510 £31.67	HR5010 £36.96	HR6010 £62.51	XHR4010 £36.44	XHR4510 £38.82	XHR5010 £45.32	XHR6010 £73.75
Square [90°] Right Hand	HR4011 £29.72	HR4511 £31.67	HR5011 £36.96	HR6011 £62.51	XHR4011 £36.44	XHR4511 £38.82	XHR5011 £45.32	XHR6011 £73.75
Obtuse [135°] Left Hand	HR4012 £29.72	HR4512 £31.67	HR5012 £36.96	HR6012 £62.51	XHR4012 £36.44	XHR4512 £38.82	XHR5012 £45.32	XHR6012 £73.75
Obtuse [135°] Right Hand	HR4013 £29.72	HR4513 £31.67	HR5013 £36.96	HR6013 £62.51	XHR4013 £36.44	XHR4513 £38.82	XHR5013 £45.32	XHR6013 £73.75
OUTLETS								
	Premier [Primed]				Premier Extra [Black]			
Description	100mm [4"]	115mm [4.5"]	125mm [5"]	150mm [6"]	100mm [4"]	115mm [4.5"]	125mm [5"]	150mm [6"]
A=65mm [2.5"], B=75mm [3"], C= 100mm [4"]								
Nozzle [Centre Drop]	HR4020A £29.72	HR4520A £31.67	HR5020A £36.96	HR6020B £62.51	XHR4020A £36.44	XHR4520A £38.82	XHR5020A £45.32	XHR6020B £73.75
	HR4020B £29.72	HR4520B £31.67	HR5020B £36.96	HR6020C £62.51	XHR4020B £36.44	XHR4520B £38.82	XHR5020B £45.32	XHR6020C £73.75
Dropend External	HR4021A £29.72	HR4521A £31.67	HR5021A £36.96	HR6021B £62.51	XHR4021A £36.44	XHR4521A £38.82	XHR5021A £45.32	XHR6021B £73.75
	HR4021B £29.72	HR4521B £31.67	HR5021B £36.96	HR6021C £62.51	XHR4021B £36.44	XHR4521B £38.82	XHR5021B £45.32	XHR6021C £73.75
Dropend Internal	HR4022A £29.72	HR4522A £31.67	HR5022A £36.96	HR6022B £62.51	XHR4022A £36.44	XHR4522A £38.82	XHR5022A £45.32	XHR6022B £73.75
	HR4022B £29.72	HR4522B £31.67	HR5022B £36.96	HR6022C £62.51	XHR4022B £36.44	XHR4522B £38.82	XHR5022B £45.32	XHR6022C £73.75
STOPENDS								
	Premier [Primed]				Premier Extra [Black]			
Description	100mm [4"]	115mm [4.5"]	125mm [5"]	150mm [6"]	100mm [4"]	115mm [4.5"]	125mm [5"]	150mm [6"]
External [for spigot]	HR4030 £10.05	HR4530 £12.35	HR5030 £13.05	HR6030 £17.28	XHR4030 £12.33	XHR4530 £15.15	XHR5030 £15.97	XHR6030 £21.21
Internal [for socket]	HR4031 £10.05	HR4531 £12.35	HR5031 £13.05	HR6031 £17.28	XHR4031 £12.33	XHR4531 £15.15	XHR5031 £15.97	XHR6031 £21.21
UNION CLIP								
	Premier [Primed]				Premier Extra [Black]			
Description	100mm [4"]	115mm [4.5"]	125mm [5"]	150mm [6"]	100mm [4"]	115mm [4.5"]	125mm [5"]	150mm [6"]
Union Clip	HR4035 £19.70	HR4535 £23.93	HR5035 £27.66	HR6035 £31.07	XHR4035 £24.16	XHR4535 £29.34	XHR5035 £33.91	XHR6035 £38.09
FASCIA BRACKET								
	Premier [Primed]				Premier Extra [Black]			
Description	100mm [4"]	115mm [4.5"]	125mm [5"]	150mm [6"]	100mm [4"]	115mm [4.5"]	125mm [5"]	150mm [6"]
Fascia Bracket	HR4040 £8.28	HR4540 £8.28	HR5040 £8.96	HR6040 £10.24	XHR4040 £10.15	XHR4540 £10.15	XHR5040 £10.97	XHR6040 £12.55
STEEL BRACKETS								
	Galvanised				Premier Extra [Black]			
Description	100mm [4"]	115mm [4.5"]	125mm [5"]	150mm [6"]	100mm [4"]	115mm [4.5"]	125mm [5"]	150mm [6"]
Top Fixing Rafter Bracket	HR4041 £7.44	HR4541 £7.89	HR5041 £8.37	HR6041 £9.71	XHR4041 £9.13	XHR4541 £9.68	XHR5041 £10.25	XHR6041 £11.93
Side Fixing Rafter Bracket	HR4042 £7.89	HR4542 £8.37	HR5042 £8.90	HR6042 £10.10	XHR4042 £9.68	XHR4542 £10.25	XHR5042 £10.94	XHR6042 £12.39
Rise and Fall Bracket	HR4043 £17.28	HR4543 £17.28	HR5043 £17.69	HR6043 £18.24	XHR4043 £21.63	XHR4543 £21.63	XHR5043 £22.11	XHR6043 £22.80
Square Bar Drive in Bracket	HR4044S £13.28	HR4544S £13.28	HR5044S £13.28	HR6044S £17.69				

Please see page 20 for sundries.



Products can be supplied in any RAL or BS colour.
We can also colour match from customer supplied samples.
Price on application.



Left hand

Right hand

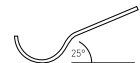
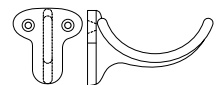
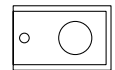
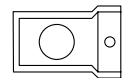
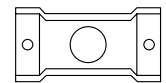
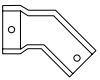
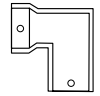

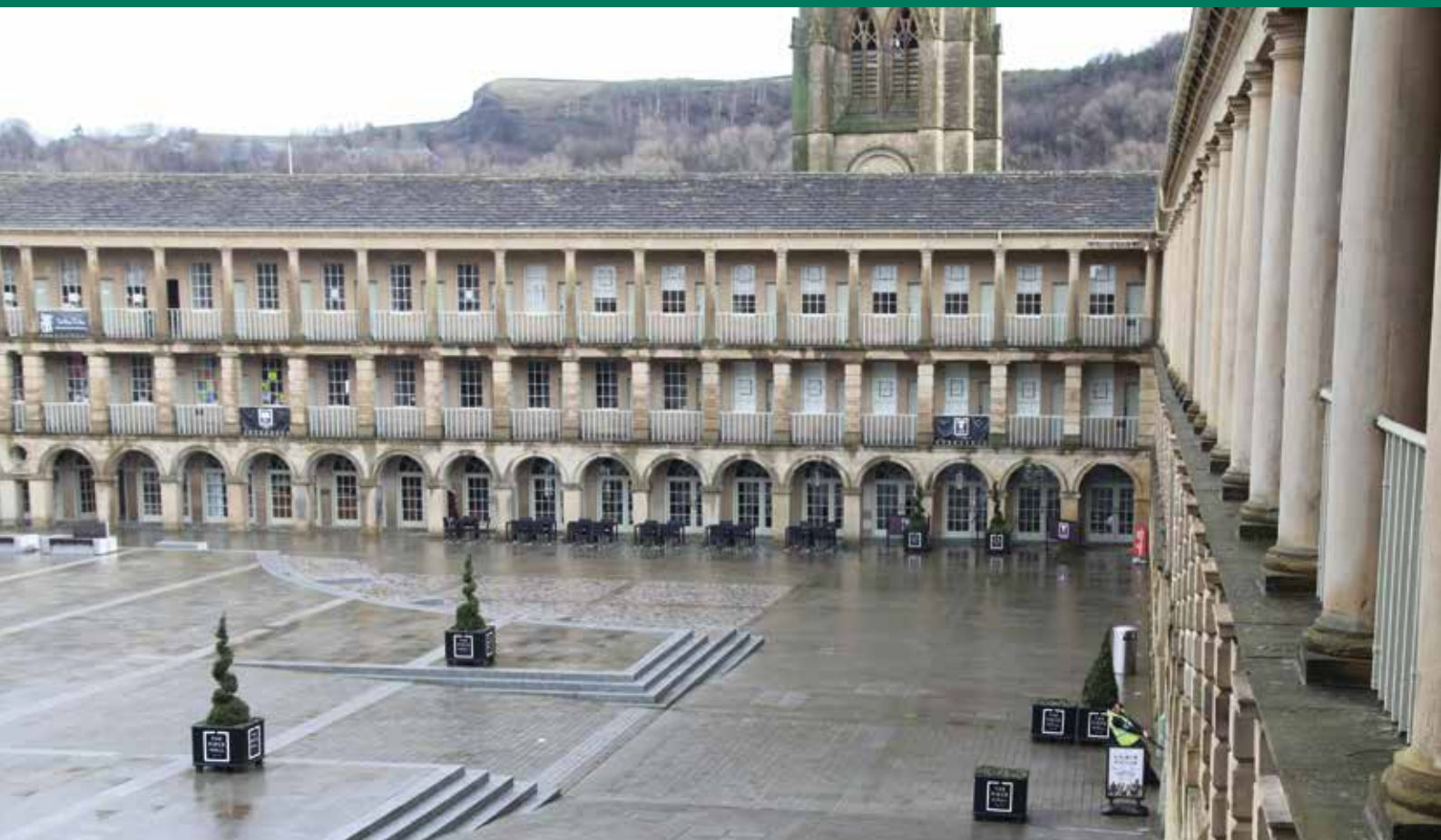

RAINWATER SUNDRIES & FIXINGS



RAINWATER SUNDRIES

20

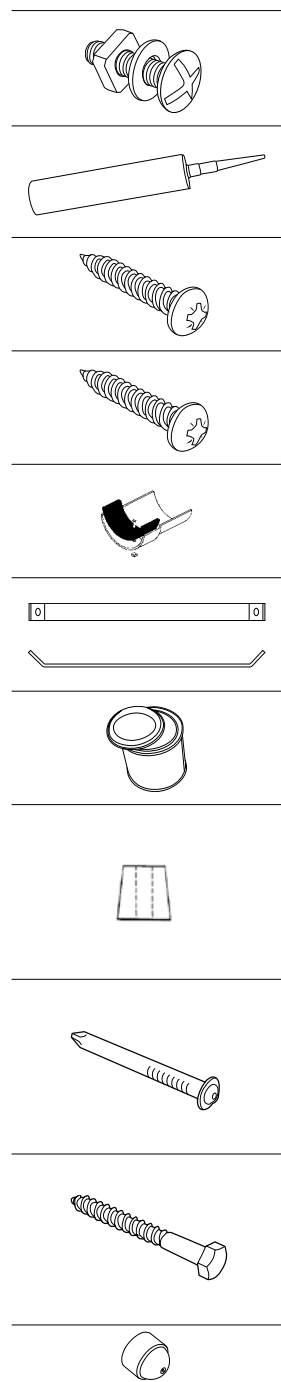

GUTTER BOLT, NUT & WASHER	
Description	
M6 x 25mm Bolt, Nut & Washer [Zinc Plated]	HR0001 £0.63
SILICONE SEALANT	
Description	
300ml Cartridge of Silicone Sealant	HR0002 £19.18
GUTTER FIXING SCREW	
Description	
16g x 30mm Mushroom Head Screw [Zinc Plated]	HR0003A* £1.12
BRACKET SCREW	
Description	
No. 10 x 1.25" Round Head Pozi Screw [Zinc Plated]	HR0004 £0.15
GUTTER JOINTING KIT	
Description	For use with Plain and Beaded Half Round only
10 Rubber Gaskets, Bolts, Nuts & Washers	HR0006 £31.74
UNDERSTAY	
Description	
Galvanised Understay for use with Rise and Fall Brackets	HR0007 £6.53
TOUCH UP PAINT	
Description	
250ml Black Gloss Finish	XP0007 £19.17
BOBBINS	
Description	
Wooden 30mm Projection	R0001 £2.63
Metal 13mm Projection	R0002 £7.35
PIPE NAILS	
Description	
75mm [3"] to Suit all Pipe Sizes	R0003 £0.89
100mm [4"] to Suit all Pipe Sizes	R0004 £0.98
COACH SCREWS	
Description	
M8 x 70mm Coach Screw [Zinc Plated]	R0005 £0.68
M8 x 100mm Coach Screw [Zinc Plated]	R0006 £0.89
M8 Black Plastic Coach Screw Caps	R0007 £0.68

Installation instructions available on request. *Possible alternative supplied.