

Construction management plan

Construction

High quality materials and workmanship will be provided to create a building that meets or better current Building Regulations and has a high standard of air-tightness and insulation.

Demolition

Due care and attention will be taken during the demolition process with a full method statement prepared. The existing materials will be reused where possible to reduce the carbon footprint, with local suppliers and labour also preferable.

Site Compound

Propose location shown on adjacent site plan. The compound will be used for storage of plant and materials as well as parking for site operatives and visitors.

Temporary Construction Access

No temporary construction access will be required.

Wheel Washing Facilities

Hose available to wash vehicle wheels on site.

Site Working Hours

Monday - **Friday 07.30 - 17.30**
 Saturday **08.00 - 13.00**
 Sunday / Bank Holiday **Closed**

Site Contact Details

Site manager to be confirmed once contractor appointed.

Tree Protection Measures

Any trees in close proximity to the proposed development are to be protected by temporary Heras fencing to BS5837 (see Figure 1.1).

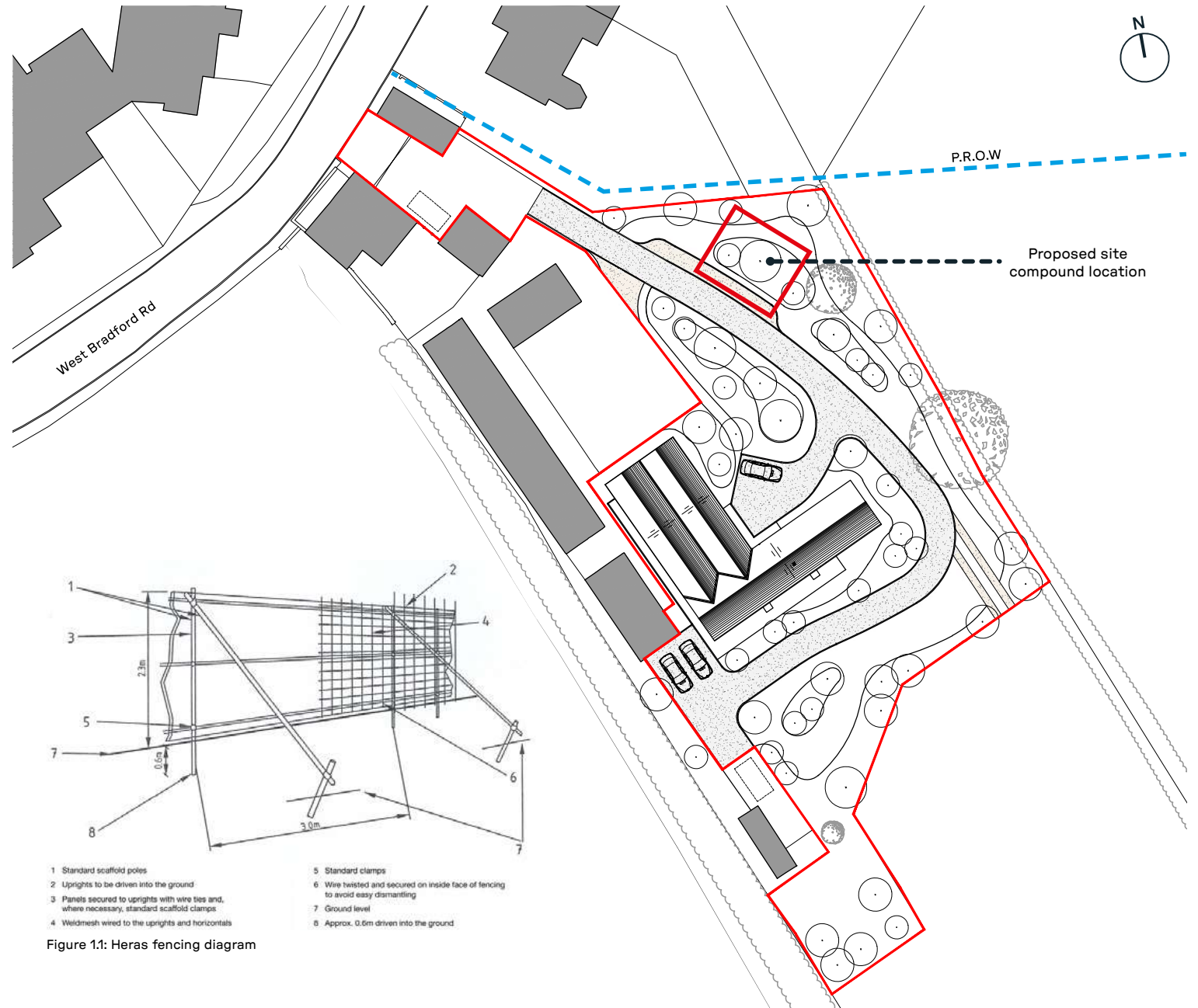

- 1 Standard scaffold poles
- 2 Uprights to be driven into the ground
- 3 Panels secured to uprights with wire ties and, where necessary, standard scaffold clamps
- 4 Weldmesh wired to the uprights and horizontals
- 5 Standard clamps
- 6 Wire twisted and secured on inside face of fencing to avoid easy dismantling
- 7 Ground level
- 8 Approx. 0.6m driven into the ground

Figure 1.1: Heras fencing diagram