

Planning Application Number:	TBC			
Development Location:	Hazel-Mere, Longridge Road, Hurst Green, Lancashire, BB7 9QP			
Development Description:	Proposed replacement dwelling			
Strategy Prepared By:	Charlie Ramsden			
Date Prepared:	10/09/2024			
Waste Type	Refuse Non-recyclable	Garden Waste	Paper & Cardboard	Glass, Cans & Plastic Bottles
Container Type	Wheeled Bin	Wheeled Bin	Wheeled Bin	Wheeled Bin
Capacity (ltr)	240 x1	240 x1	240 x1	240 x1

Notes:

1. Notes

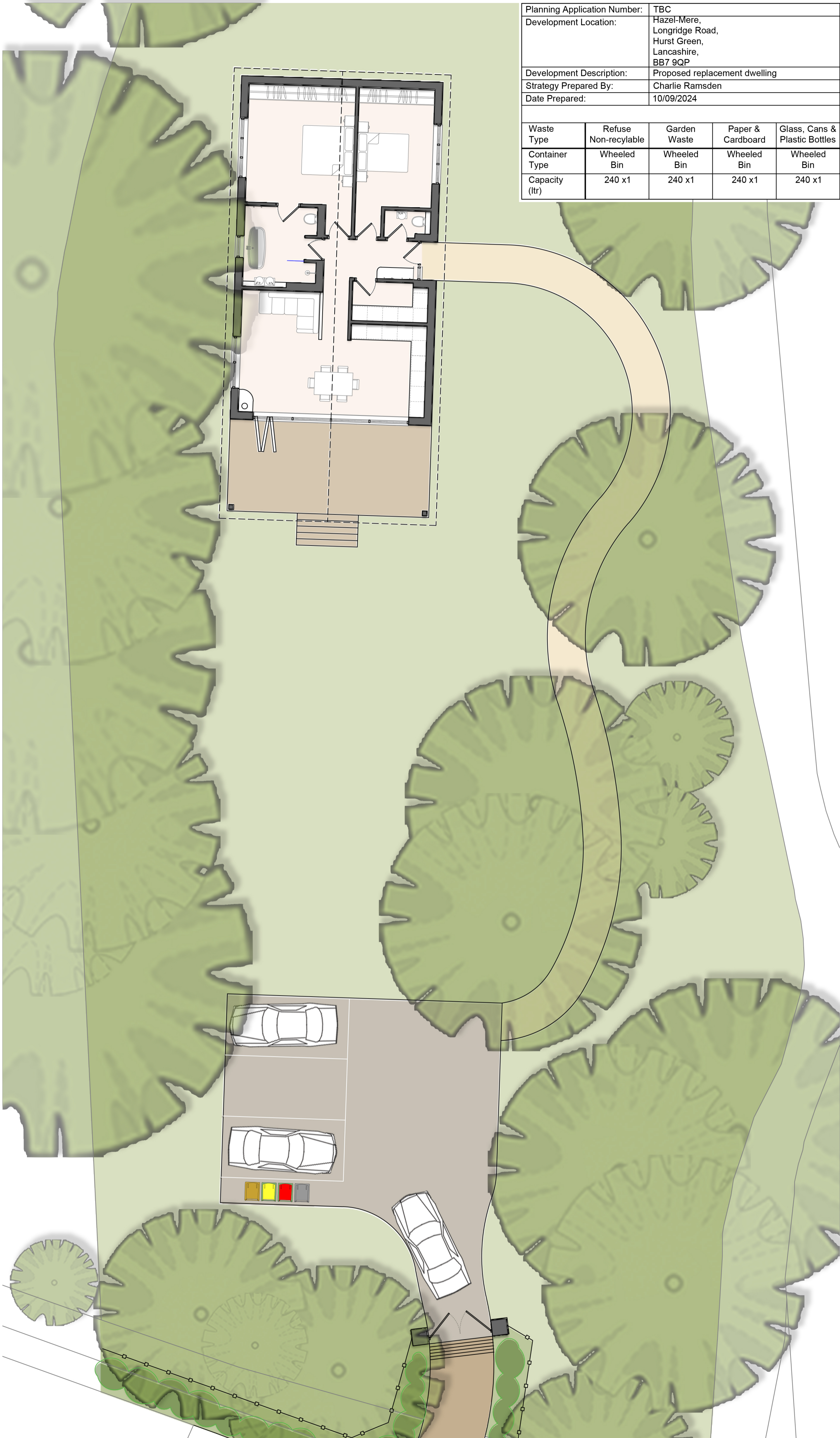

REV: DESCRIPTION: BY: DATE:
© All works copyright of Black Barn Architecture
 This drawing has been produced for Mr Hull for in relation to Longridge Road and prepared solely for the status indicated. It is not for use by any other person or for any other purpose.
 STATUS:

Stage 3 - Spatial Coordination



SITE:
 Longridge Road
 Hurst Green
 Lancashire
 BB7 9QP

CLIENT:
 Mr Hull

JOB TITLE:
 Hazel-Mere

DRAWING TITLE:
 Proposed Refuse Plan

DATE: 10/09/24	DRAWN: CR	CHECKED: MS	PAPER SIZE: A2 (420x594mm)
JOB NO: BBA_232	DRAWING NO: P03	REVISION: -	

PROPOSED REFUSE PLAN
 SCALE 1:100

