

# Northcote Road, Langho

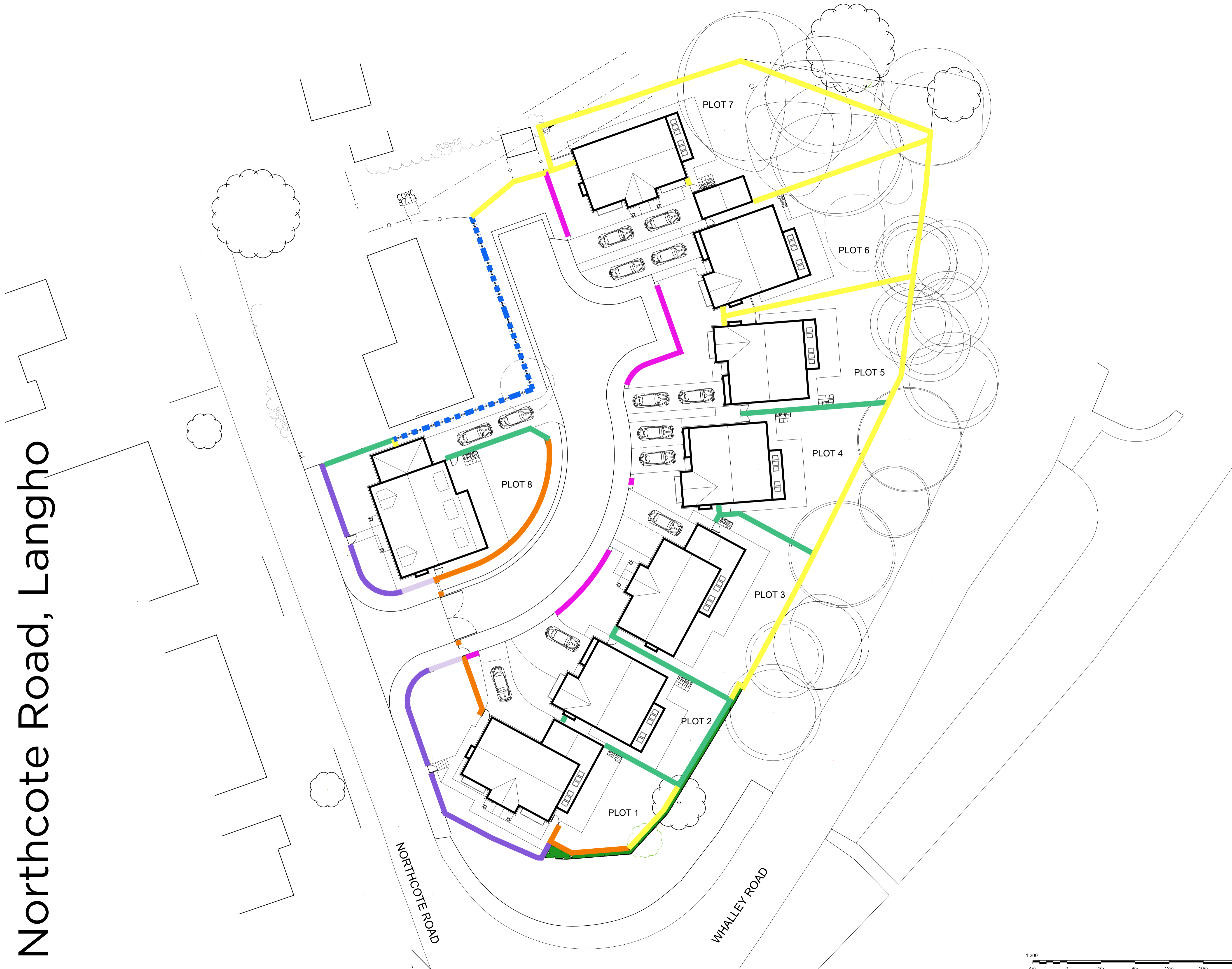

- The Copyright of this drawing belongs to MP&S Planning & Design Ltd. and shall not be used or reproduced in any form without its express permission.
- Only scale for 'Town and Country Planning Act 1990' services. For construction purposes, work to figured dimensions only. All dimensions to be checked with MP&S and on site prior to the execution of any work.
- For the avoidance of doubt all dimensions are measured to wall structure and not the finishes unless otherwise stated.
- Where any discrepancy is found to exist within or between drawings and/or documents it should be reported to the architect immediately.
- MP&S Planning & Design Ltd. shall not be liable for any use of drawings and documents for any purpose other than for which the same were prepared by or on behalf of MP&S Planning & Design Ltd.

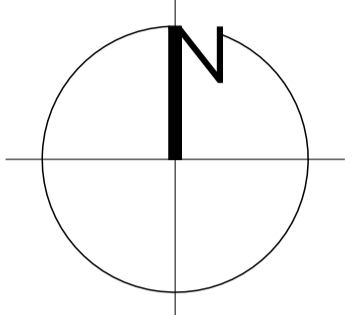

**NOTE:**  
Layout to be read in conjunction with the boundary treatment details. Refer to DEP's General Arrangements Plan for rear garden retaining walls and location of retaining structures.

**BOUNDARY TREATMENTS**

- Denotes 1.8m high screen stone wall & piers, to match development facing.
- Denotes 1.8m high timber screen fence erected on top of gravel board.
- Denotes 1.8m high timber screen fence.
- Denotes 1.8m high timber screen fence on top of gravel board.
- Denotes tapered stone wall up to entrance piers.
- Denotes 1.1m high stone wall and piers.
- Denotes 0.9m high Cheshire Estate railing & stone piers with hedge behind.
- Denotes hedge planting.
- Denotes access gates to private properties.

Rev	Date	Revision	Initial
B	23.01.25	Layout updated to reflect latest site layout REV. D.	SLR
A	11.11.24	Layout updated to reflect latest site layout REV. C.	CW

+ Client  
**ALDERLEY GROUP**

+ Drawing Title  
**BOUNDARY TREATMENT LAYOUT**

+ Project  
Proposed Residential Development, Northcote Road, Langho

Job No	24075	Drp No	04	Drawn	SLR	Rev	B
Scale	1:200 @ A1	Date	AUGUST 2024	Stage	FOR PLANNING		

mp&s planning & design ltd  
Office G9, The Classrooms  
Stanley Square  
Sale, M33 7ZZ

t: 0161 772 1999  
e: info@mpsdesign.co.uk  
www.mpsdesign.co.uk

