



# ARBORICULTURAL IMPLICATIONS ASSESSMENT

PROPOSED DEVELOPMENT

AT

KEMPLE DOWN  
BIRDY BROW  
CHAIGLEY  
CLITHEROE  
BB7 3LR

Author: C. Salisbury  
Date: 11 December 2024  
Ref: TRE/KDBBCC/Rev B



**Mulberry**

Adamson House, Towers Business Park, Wilmslow Road, Didsbury, M20 2YY

T 0161 955 3628

F 0161 955 4201

E [info@mulberrytmc.co.uk](mailto:info@mulberrytmc.co.uk)

[www.mulberrytmc.co.uk](http://www.mulberrytmc.co.uk)

## 1.0 Introduction

- 1.1 Mulberry Tree Management were instructed by D Dennis, to carry out an arboricultural survey of trees at their site at Kemple Down, Birdy Brow, Chaigley, Clitheroe.
- 1.2 This report details the arboricultural implications of developing the site, including:
  - a survey of the trees on and near the development which may impact the proposal from ground level, noting their location, species and all relevant parameters, i.e. stem diameter, height, crown spread, condition etc;
  - providing advice on the removal, retention and management of trees;
  - assessment of the potential effects of the proposal on retained trees and vice versa;
  - assessment of the requirement for tree protection for the duration of the works;
  - mitigation for any loss;
  - preparation of a tree schedule;
  - and report on the above matters.
- 1.3 The survey was carried out on 01 July 2024 by means of inspection from ground level by an experienced and qualified arboriculturalist. The inspection can be restricted in cases where trees were Ivy clad or surrounded by vegetation.
- 1.4 Under *BS5837: 2012 Trees in Relation to Construction - Recommendations*, the assessment of trees is made objectively. The tree categorisation method identifies the quality and value of the existing tree stock, allowing informed decisions to be made concerning development design layout.
- 1.5 The following documents have been made available by the client:
  - Drawing- EX.01 site.dwg
  - Drawing- 2361PL04 Site.dwg
- 1.6 The supplied drawing included some tree positions plotted. Any dimensions regarding tree positions and protective fencing must be checked on site.
- 1.7 Weather conditions during the survey were dry and still.
- 1.8 The survey was carried out noting the conditions of the trees at the time of inspection. As trees are part of the natural environment, conditions can naturally change; therefore the contents of this report are valid for one year only. After this period, re-inspection may be necessary.

## **2.0 Survey Methodology**

- 2.1 The trees were surveyed (prefixed T, or G for group) and recorded in the tree schedule in appendix one. Where groups are recorded, average height and diameter at breast height (DBH) of the trees in the group are reported. Where access to the base of any trees was limited, stem size was estimated.
- 2.2 All the trees were assessed using: a grading A to C (retention) and U (removal); condition and age class as defined in appendix two.
- 2.3 Where appropriate, canopy spread for each tree was recorded at four cardinal points in order to reproduce an accurate representation of the crown shape of the tree on the tree plan in appendix three.
- 2.4 The survey included all trees within the proposal area and trees near to the proposal.

## **3.0 Development Proposals**

- 3.1 Due to the proposed development and its associated infrastructure there are a number of locations where the proposals are in close proximity to the trees surveyed. The Site Layout Plan within appendix three identifies the trees in relation to the proposed development.
- 3.2 In order to fully assess the impact of the proposals an Impact Table has been created detailing each tree, which shows the proximity of the associated works to the tree.
- 3.3 This can then be assessed in accordance with BS 5837:2012 to determine whether the development will have a detrimental impact on the health of each tree. Once this has been determined remedial measures can be detailed to reduce the impact the proposals will have on the treescape.

### 3.4 Impact Table:-

Tree No.	Root Protection Area identified in Table 2 of BS 5837:2012	Distance to Proposed Hard Standing (m)	Distance to Proposed Development (m)	Can the Tree/s be Successfully Retained
T1	109m <sup>2</sup>	N/A	N/A	Yes
T2	113m <sup>2</sup>	N/A	N/A	Yes
T3	5m <sup>2</sup>	N/A	N/A	Yes
G1	297m <sup>2</sup>	2.20	14.00	Yes as outlined in section 5.0
G2	452m <sup>2</sup>	1.60	7.00	Retain 1 tree/Remove 1 tree as outlined in section 5.0
G3	49m <sup>2</sup>	7.40	3.10	Yes with the loss of 1 tree
G4	Not Assessed as the Trees Require Removal Due to their Condition			

## 4.0 Impact Assessment

4.1 To assess the implications of the Impact Table each tree can be categorised in the following way: -

	Trees to be retained		Trees to be removed	
	With No Impact	With detailed construction	Due to Condition	Due to Development
Tree No.	T1, T2, T3, G3 & G4	G1 & G2(1 tree)	N/A	G2(1 tree) & G3(1 tree)

## 5.0 Mitigation Proposals

### 5.1 Proposed Driveway

5.1.1 The impact table below shows the proposed car parking having a minor encroachment into the root protection area of G1 & G2. It is felt that due to the species, condition and limited extent of encroachment the proposal will not have a detrimental impact on the safe useful life expectancy of these trees.

5.1.2 If ground levels remain the same, the detrimental effects the driveway would have on this tree would be: -

- Compaction, resulting in oxygen depletion, caused from creating the access way.
- The loss of a permeable surface.

- 5.1.3 It is now possible with the use of a cellular confinement system to be able to create road surfaces very close to trees without having a detrimental effect.
- 5.1.4 A cellular confinement system provides a load transfer mattress which prevents direct loads on tree roots and reduces the bearing pressure on subsoil's by stabilising aggregate surfaces against rutting under wheel loads.
- 5.1.5 Section 7.4.2.3 of BS 5837:2012 advises that new permanent hard surfacing should not exceed 20% of any existing unsurfaced ground within the RPA. The table below details the amount of new surface proposed within the RPA of each tree.

Tree No	Total Area m2 of RPA	Total m2 of New Hard Surfacing within the RPA	Percentage of Hard Surfacing within the RPA
G1	297	2.30	0.80%
G2	452	29.80	6.60%

- 5.1.6 As you can see from the table the proposed hard surfacing does not exceed 20% for each of the RPA's. It is therefore felt that the proposed driveway will not have a detrimental impact upon the existing trees.

## **5.2 Existing Site Constraints in Relation to G2**

- 5.2.1 The site has a number of site constraints which are identified by the plotting the root protection area of the group as a polygon rather than a circle. These constraints allow the development to be implemented without having a detrimental impact upon the existing trees.

## **6.0 Conclusions and Arboricultural Recommendations**

- 6.1 The tree categorisation method identifies the quality and value of the existing tree stock but it is not meant to be interpreted rigidly and is presented in order to form a balanced judgement on tree retention and removal.
- 6.2 A precautionary method of working near trees is detailed in the accompanying Arboricultural Method Statement.
- 6.3 Following site development, regular (annual or biannual) inspections of all retained trees should be undertaken by a qualified Arboricultural Consultant.
- 6.4 It is considered that in following the advice in this document, any negative factors affecting trees on the site will be minimised.

# **Appendix One**

## **Tree Survey Schedule**

## TREE SURVEY SCHEDULE

Arboricultural Data Sheet:					Date of Survey: 01/07/24				Surveyor: C. Salisbury				
Tree No.	Species	DBH (mm)	Height (m)	Age	Crown Spread (m)				Crown clearance	Condition rating	Comments and preliminary management recommendations	Estimated remaining contribution	Tree quality category rating
					N	E	S	W					
T1	Cherry	490	6.20	FM	4.0	5.0	3.0	4.0	2.50	C	A previously reduced individual specimen in decline	10-20	C2
T2	Willow	500	10.40	EM	3.5	5.5	5.0	5.0	0.00	B/C	An individual specimen displaying early signs of decline within its canopy	20-40	C2
T3	Conifer	100	3.80	SM	1.0	1.0	1.0	1.0	1.00	B	An individual ornamental specimen adjacent to the highway	20-40	C2
G1	Holly & Sycamore	810<	13.60	EM/M	-	-	-	-	1.50	B/C	An ivy-clad linear belt adjacent to the highway. The Holly are displaying signs of decline	60-80	A2
G2	1 x Pine & 1 x Conifer	1000<	26.40	M/F M	-	-	-	-	9.50	B/C	A dominant group adjacent to a highway. The Pine is displaying signs of decline	40-60	A2
G3	Apple, Pear & Cherry	330<	6.60	EM/M	-	-	-	-	1.50	B/C	An ornamental group situated in the property grounds	20-40	C2
G4	Hazel & Ash	160 avg	6.20	SM	-	-	-	-	1.50	C	A poor-quality group in decline	0-10	U

# **Appendix Two**

## **Tree Survey Key**



Trees for removal				
Category and definition		Criteria		
Category U Those in such a condition that any existing value would be lost within 10 years and which should, in the current context, be removed for reasons of sound arboricultural management		Trees that have a serious, irremediable, structural defect, such that their early loss is expected due to collapse, including those that will become unviable after removal of other R category trees (i.e. where, for whatever reason, the loss of companion shelter cannot be mitigated by pruning) Trees that are dead or are showing signs of significant, immediate, and irreversible overall decline Trees infected with pathogens of significance to the health and/or safety of other trees nearby (e.g. Dutch elm disease), or very low quality trees suppressing adjacent trees of better quality <b>Note</b> – Habitat reinstatement may be appropriate (e.g. R category tree used as a bat roost: installation of bat box in nearby tree).		
Trees to be considered for retention				
Category and definition		Criteria - Subcategories		
		1 Arboriculture values	2 Landscape values	3 Conservation values
Category A <b>Those of high quality and value:</b> in such a condition as to be able to make a substantial contribution (a minimum 40 years is suggested)		Trees that are particularly good examples of their species, especially if rare or unusual, or essential components of groups, or of formal or semi-formal arboriculture features (e.g. the dominant and/or principal trees within an avenue)	Trees, groups or woodlands which provide a definite screening or softening effect to the locality in relation to views into or out of the site, or those of particular visual importance (e.g. avenues or other arboricultural features assessed as groups)	Trees, groups or woodlands of significant conservation, historical, commemorative or other value (e.g. veteran trees or wood pasture)
Category B <b>Those of moderate quality and value:</b> those in such a condition as to make a significant contribution (a minimum of 20 years is suggested)		Trees that might be included in the high category, but are downgraded because of impaired condition (e.g. presence of remediable defects including unsympathetic past management and minor storm damage)	Trees present in numbers, usually as groups or woodlands, such that they form distinct landscape features, thereby attracting a higher collective rating than they might as individuals but which are not, individually, essential components of formal or semi-formal arboriculture features (e.g. trees of moderate quality within avenue that includes better, A category specimens), or trees situated mainly internally to the site, therefore individually having little impact on the wider locality	Trees with clearly identifiable conservation or other cultural benefits
Category C <b>Those of low quality and value:</b> currently in adequate condition to remain until new planting could be established (a minimum of 10 years is suggested), or young trees with a stem diameter below 150 mm		Trees not qualifying in higher categories	Trees present in groups or woodlands, but without this conferring on them significantly greater landscape value, and/or trees offering low or only temporary screening benefit	Trees with very limited conservation or other cultural benefits
		<b>Note</b> - Whilst C category trees will usually not be retained where they would impose a significant constraint on development, young trees with a stem diameter of less than 150 mm should be considered for relocation		

### Age Class

Y	Young	Trees that have not yet established
SM	Semi-Mature	Established trees up to 1/3 of expected height and crown
EM	Early mature	Between 1/3 and 2/3 expected height and crown
M	Mature	Between 2/3 and full expected height and crown
FM	Fully Mature	Full expected height and crown
OM	Over-Mature	Crown beginning to break up and decrease in size
S	Senescent	Crown in advanced stage of break-up





### Condition

A	Good
B	Fair
C	Poor
D	Dead

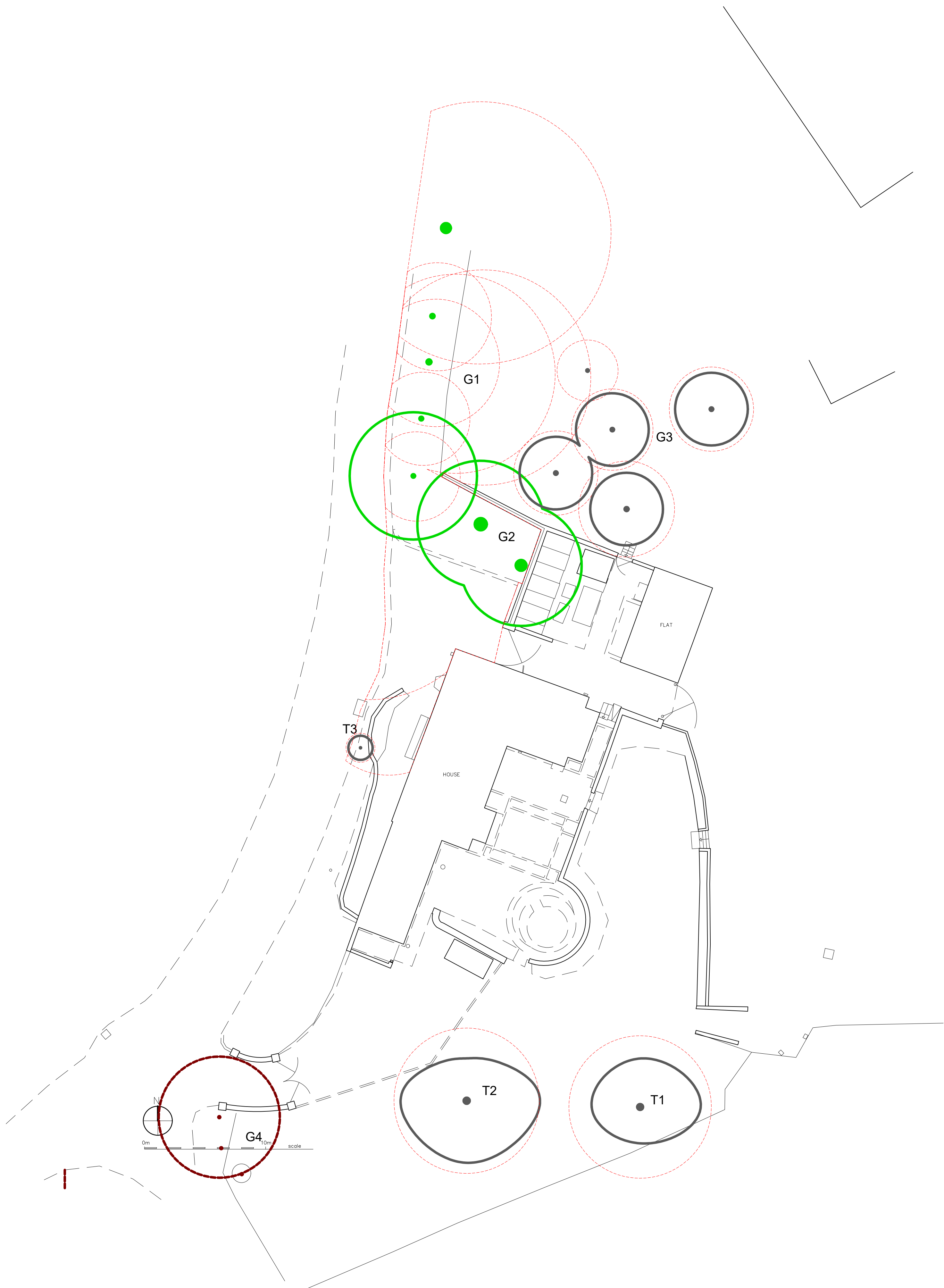
# **Appendix Three**

## **Plans**



-  Category A Trees
-  Category B Trees
-  Category C Trees
-  Category U Trees
-  Root protection area

Mulberry TMC  
 Adamson House  
 Towers Business Park  
 Wilmslow Road  
 Didsbury  
 M20 2YY

Tel: 0161 955 3628  
 Email: info@mulberrytmc.co.uk



Site Address:  
 Kemple Down  
 Birdy Brow  
 Clitheroe





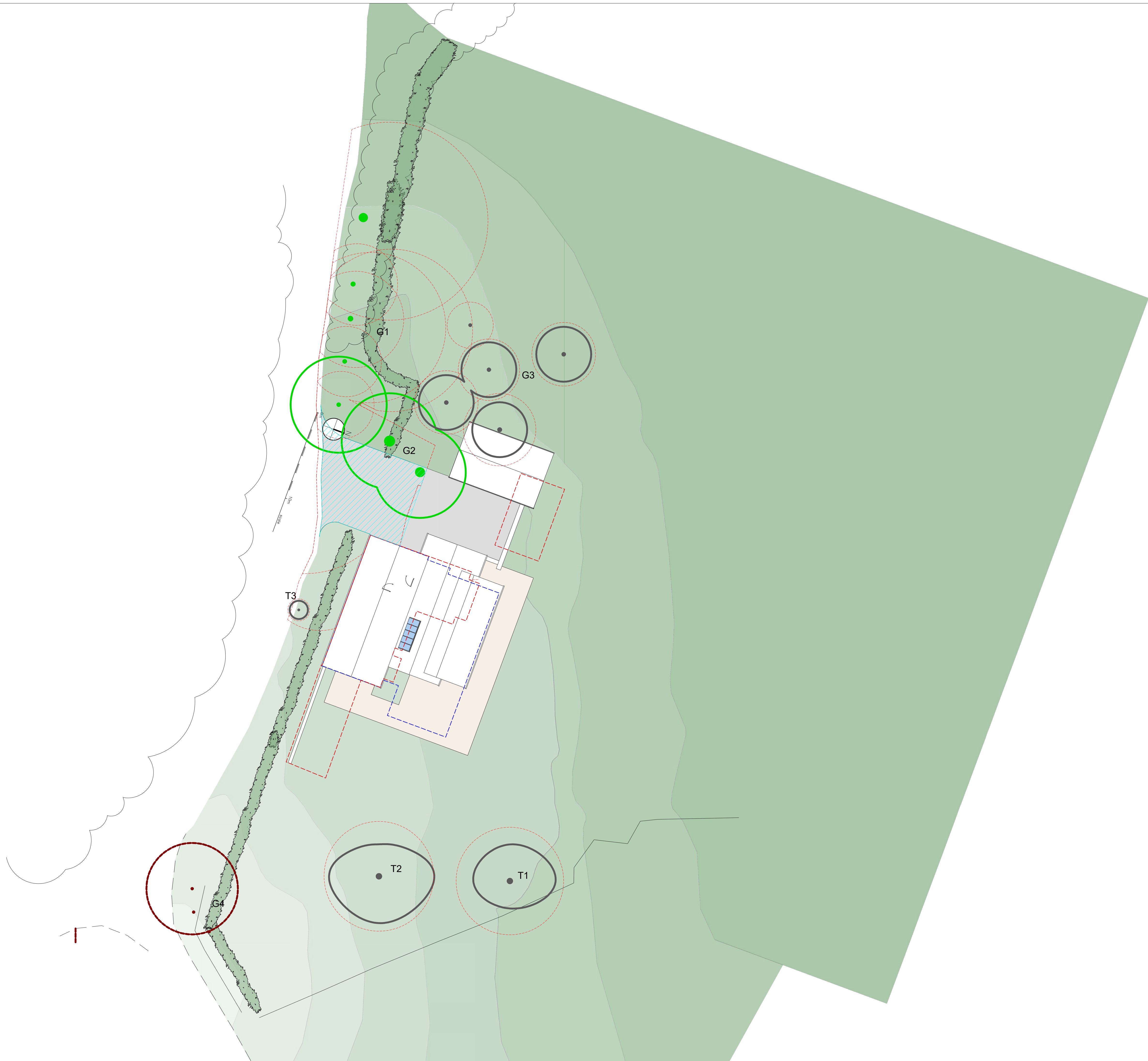

Drawing Title:  
 BS5837 Plan

Drawing No:  
 KDBBC/BS/01

Date: 31/07/2024 Scale: 1:200@A1 Drawn by: CJ

Note: Dimensions are not to be scaled from this drawing.  
 All written measurements are to be checked on site by the contractor. Copyright Mulberry TMC.  
 Note: All rights described in Chapter IV of the Copyright Design & Patents Act 1988 have generally been asserted.



-  Category A Trees
-  Category B Trees
-  Category C Trees
-  Category U Trees
-  Root protection area
-  Special Measures

Mulberry TMC  
Adamson House  
Towers Business Park  
Wilmslow Road  
Didsbury  
M20 2YY

Tel: 0161 955 3628  
Email: info@mulberrytmc.co.uk



Site Address:  
Kemple Down  
Birdy Brow  
Clitheroe

Drawing Title:  
AIS Plan

Drawing No:  
KDBBC/AIS/01 Rev B

Date: 06/12/2024 Scale: 1:200@A1 Drawn by: CJ

Note: Dimensions are not to be scaled from this drawing.  
All written measurements are to be checked on site by the contractor. Copyright Mulberry TMC.  
Note: All rights described in Chapter IV of the Copyright Design & Patents Act 1988 have generally been asserted.

## **Appendix Four**

### **Construction of Special Surface**

## METHODOLOGY FOR THE CONSTRUCTION OF DRIVEWAY

The following methodology supports the drawing indicating the construction of the proposed driveway. The methodology is prepared on the basis of the sequence of operations necessary to complete the construction of the driveway with the minimum damage to the trees proposed for retention.

- Surface layer to be scraped off. This can be done either by hand or by very small machinery.
- Erect protective fencing to the edge of the construction area.
- Spread a sub grade material over the length of the driveway to fill any small ruts.
- Construct edging using treated timber if required.
- Lay geotextile mat over smoothed area.
- Extend the Geoweb perforated tree root protection system over the area of the driveway with sufficient overlap such that kerbs can be constructed on top of the Geoweb.
- Fill the voids within the Geoweb with reduced fines Type 1 material working into the site over the top of the Geoweb.
- Lay kerbs and surface over the Geoweb such that the construction binds itself together.
- Construct finished surface as required in line with guidance illustrations below.

## GEOWEB BASED CONSTRUCTION – (INDICATIVE ONLY)

Depth of confinement system variable according to use- refer to manufacturer

### Tarmac Surface

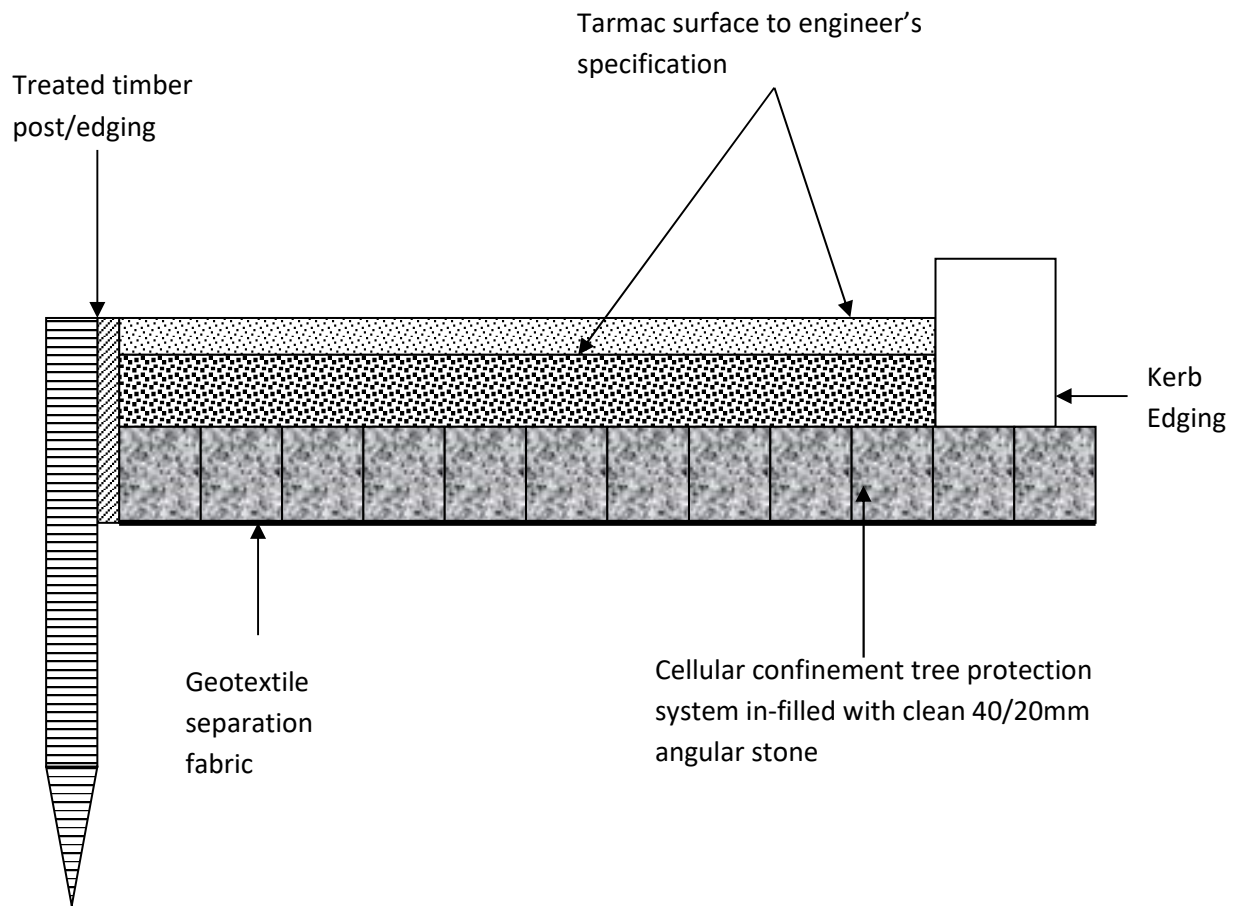

## Block Paved Surface

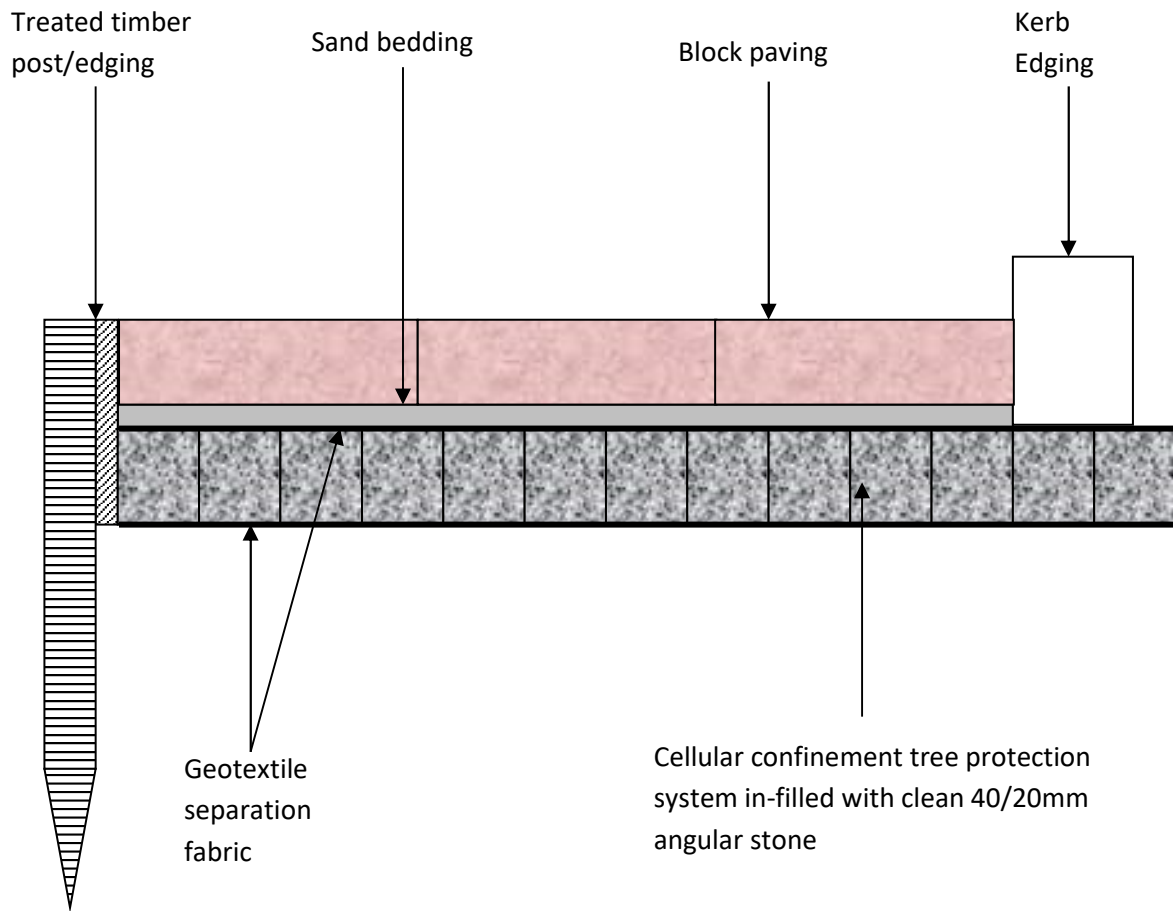



## Gravel Surface

