



APPLICATION 3/2025/0489
PROPOSED CAR PARK
UNCOVERED STRUCTURE

7295. REVISION (02) Sept 2025

0.2 | Revision History

Revision	Details	Prepared By	Checked By	Date
Rev 01	Issued to Planning	JL	KC	2025 09 23
Rev 02	Reference to reducing red line removed	JL	KC	2025 09 24

1.0 | Introduction

1.2 | Investigations

The following narrative has been provided by Brimstone UXO surveyors and details their investigation works to date. It is noted that investigations are currently on pause while a Rat infestation is cleared.

“On Tuesday 16th September we deployed two EOD engineers to site, along with an excavator rig and operator. We made good progress and were unable to unearth the top of the structure (please see attached images). Our engineers were able to look inside through the top of the structure and it was established that it was infested with rats. Some boxes of what appear to be ammunition could also be seen and will be investigated in due course. Everyone on-site was made aware.

On Wednesday 17th September we re-deployed to site and progress continued steadily. It was agreed we would unearth the structure whilst The client arranged for a pest controller to come and fumigate the structure. On Thursday 18th September progress continued steadily until it was brought to everyone’s attention that a large cable was underground, in very close proximity to the structure. We liaised with the foreman on-site and they kindly arranged for an operative with a CAT scanner to attend site the following day.

On Friday 19th September, the operative scanned for the cable and we excavated the remaining areas accordingly. This left the structure exposed (please see attached images). On the same day, it was agreed that we would de-mobilise from site, until the pest controller had been booked in. We are waiting on confirmation of dates and we will re-deploy then.”



1.0 | Introduction

1.3 | Uncovered Structure

Following the uncovering of the structure, Brimstone have advised the following;

"...based on it's general size and shape, we believe it to be a Type 24 pillbox. There is an enlarged, forward embrasure, suggesting it's been adapted for use with a heavier machine gun and wider arc of fire."

Subsequent investigation by the Client Heritage team have uncovered a historical photograph, date unknown, which appears to show employees with the structure before it's burial.

The client has also advised that the structure can be seen in the background of the below photo of a Halifax Plane which is believed to be taken circa 1943.



1.0 | Introduction

1.4 | Mitigation Measures

To address the discovery of this Structure, the car park scheme has now been reduced to avoid this area.

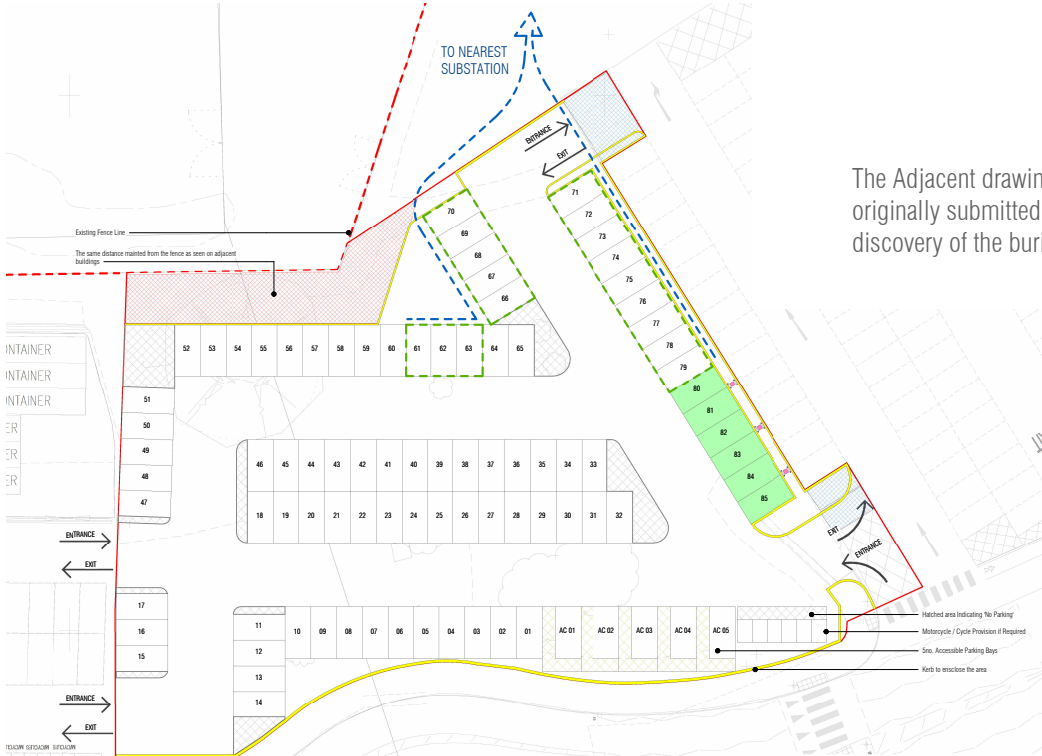

The Adjacent drawing shows the originally submitted scheme, pre discovery of the buried structure.

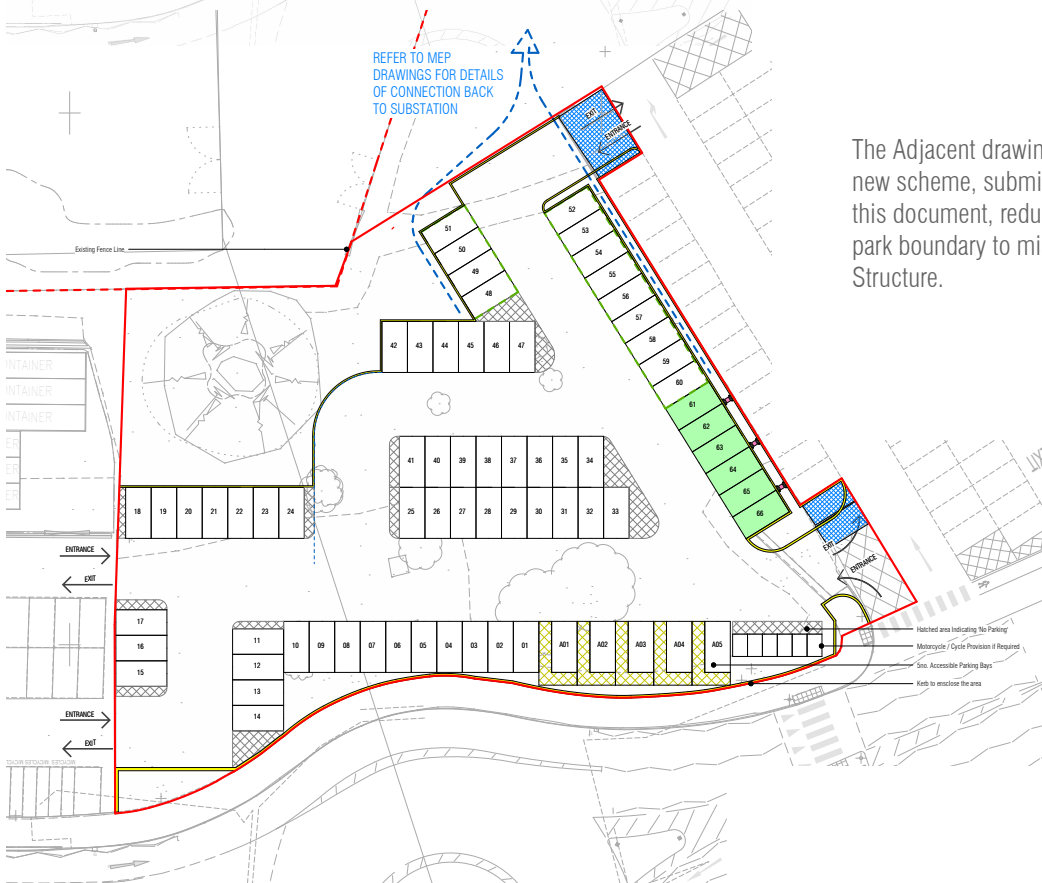

The Adjacent drawing shows the new scheme, submitted alongside this document, reducing the car park boundary to miss the Structure.

1.0 | Introduction

1.5 | Next Steps

The reduced car park site plan is submitted along side this document to be adopted into the planning application, superseding the previous drawing '25 0489 Proposed Car Park Site Plan' :

- *OSE-WMA-XX-XX-DR-A-00-020-D2-P01-Proposed Car park Site Plan (Planning) - Reduced*

As this is a reduced scheme with reduced impact on the site we hope that this can be considered within current decision time frames.

We request that Ribble Valley Council review and comment on this document, advising on the councils position with regards to the discovered structure, and any protections or mitigation that may exist already or arise from this application.

Upland House
Spring Lane
Samblesbury
PR5 0UX

01772 877 455
north@wilsonmason.co.uk

12 Albemarle Way
Clerkenwell
London
EC1V 4JB

020 7637 1501
london@wilsonmason.co.uk

www.wilsonmason.co.uk

WILSON MASON
architecture and interior design