

# ROOF SPACE ANALYSIS – PHOTO EVIDENCE

**Alston House, Land adjacent to Beech House, Alston, Lancashire  
Proposed 2No. Holiday lets.**

This document has been prepared to present photographic evidence of the recently constructed holiday lets at Alston House, on land adjacent to Beech House. The images offer a clear visual record of key roof junctions and detailing, demonstrating that there are no points of ingress or egress for wildlife. All images are taken from a survey conducted in December 2024.

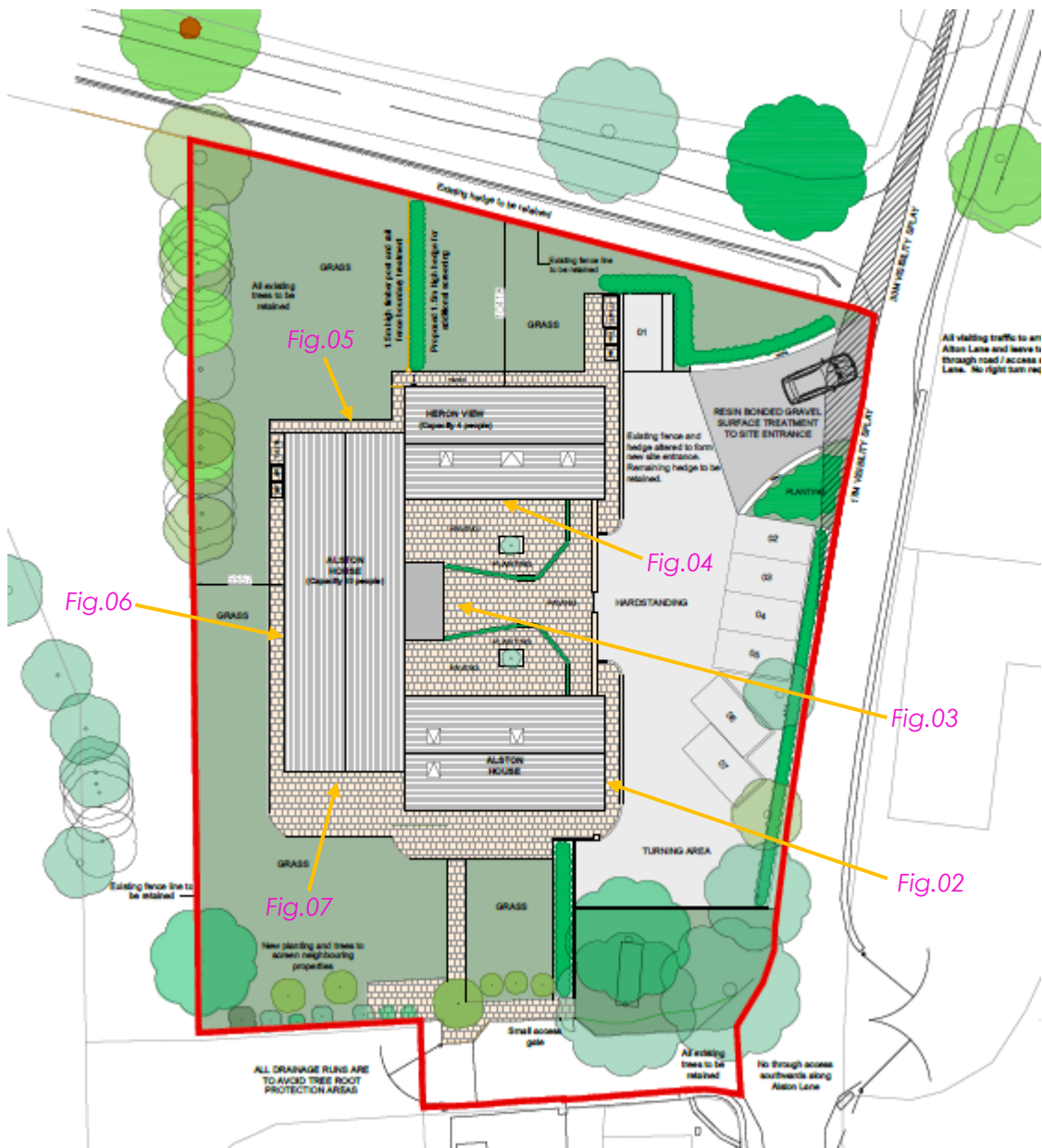

Figure 01 – Site Plan showing orientation of the images.



*Figure 02 – Shows the mortar bedded verge and eave of the adjoining section of Alston house (Hatched window to be removed).*



*Figure 03– Depicts the eaves detail to Alston House main roof.*



*Figure 04– Depicts the eaves detail to Heron View.*



*Figure 05– Shows the mortar bedded eave to North elevation of Alston House main roof (Hatched window to be removed).*



*Figure 06– Depicts the eaves detail to Heron View main roof.*

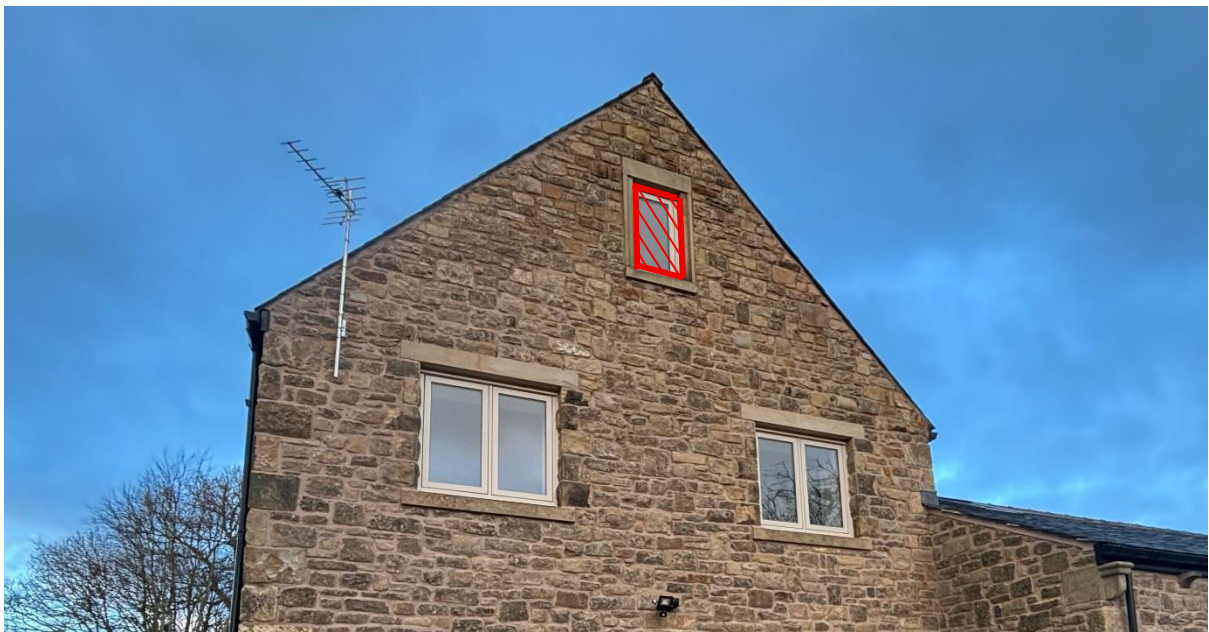

*Figure 07– Shows the mortar bedded eave to the South elevation of Alston House main roof (Hatched window to be removed).*