

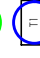





**KEY**

**TREE SURVEY**

-  Retention Category A trees and groups of high quality
-  Retention Category B trees and groups of moderate quality
-  Retention Category C trees and groups of low quality
-  Category U trees and groups of poor quality
-  Root Protection Areas. Calculated in line with BS5837:2012 to show a circular RPA which does not take into consideration site conditions



**DEP LANDSCAPE ARCHITECTURE LTD**  
 2, COMMERCIAL STREET, MANCHESTER,  
 M13 2JA  
 T: 0161 274 1978  
 F: 0161 274 1979  
 W: www.dep.co.uk

**Client:** Oaktree developments  
**Project:** Northcote Road, Langthorpe

**Drawings:** Development Layout Plan

**Scale:** 1/500@A3

**Job number:** 4986  
**Drawn:** PM  
**Date:** 06.05.22

**Revision:** 02  
**Revision:** 06.05.22 A

**Copyright DEP Landscape Architecture Ltd**  
 All rights and dimensions to be checked on site by contractor prior to construction. The information shown on this drawing is for information only and does not constitute a contract. It is the responsibility of the contractor to ensure that all information shown on this drawing is accurate and up to date. It is the contractor's responsibility to ensure that the information shown on this drawing is in accordance with current British Standards and Codes of Practice.  
 © Copyright to DEP Landscape Architecture Limited. The information shown on this drawing shall not be reproduced or copied in any form without prior written consent from DEP Landscape Architecture Limited.

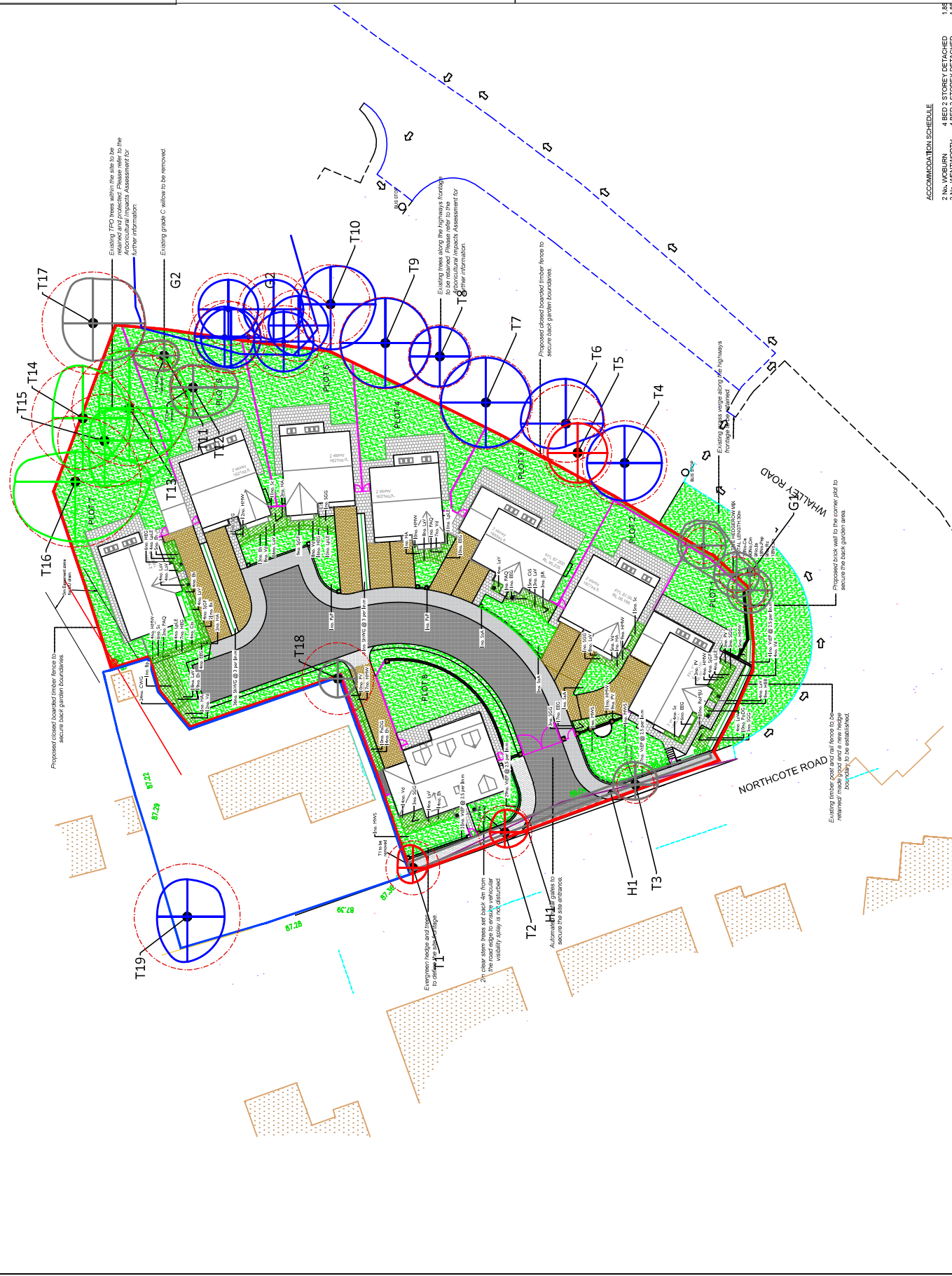





**ACCOMMODATION SCHEDULE**  
 2 No. WOLURN  
 4 BED 2 STOREY DETACHED  
 2 No. WENTWORTH  
 4 BED 2 STOREY DETACHED

1:85  
 1:85

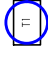
# KEY

## TREE SURVEY

-  Retention Category A trees and groups of high quality
-  Retention Category B trees and groups of moderate quality
-  Retention Category C trees and groups of low quality
-  Category U1 trees and groups of poor quality
-  Root Protection Areas. Calculated. In line with BS5837:2012 to show a circular RPA which does not take into consideration site conditions
-  Tree Protection Fencing



**DEP LANDSCAPE ARCHITECTURE LTD**  
 2, COMMERCIAL STREET, MANCHESTER,  
 M13 2JA  
 T: 0161 274 1978  
 F: 0161 274 1979  
 W: www.dep.co.uk

**Client:** Oaktree developments  
**Project:** Northcote Road, Langthorpe

**Description:** Tree Protection Plan

**Scale:** 1/500@A3

**Drawn:** PM  
**Date:** 09.05.22 A  
**Job number:** 4986\_03  
**Revision:**

**Copyright DEP Landscape Architecture Ltd**

All brief and dimensions to be checked on site by contractor prior to construction. The contractor shall be responsible for ensuring that the root in construction with all works relating to the project and all information derived accordingly, any anomalies to be reported to the client. Do not scale from this drawing. This drawing is for information only and is not to be used for construction in accordance with current British Standards and Codes of Practice.

© Copyright to DEP Landscape Architecture Limited. The information shown on this drawing shall not be reproduced or copied in any form without prior written consent from DEP Landscape Architecture Limited.

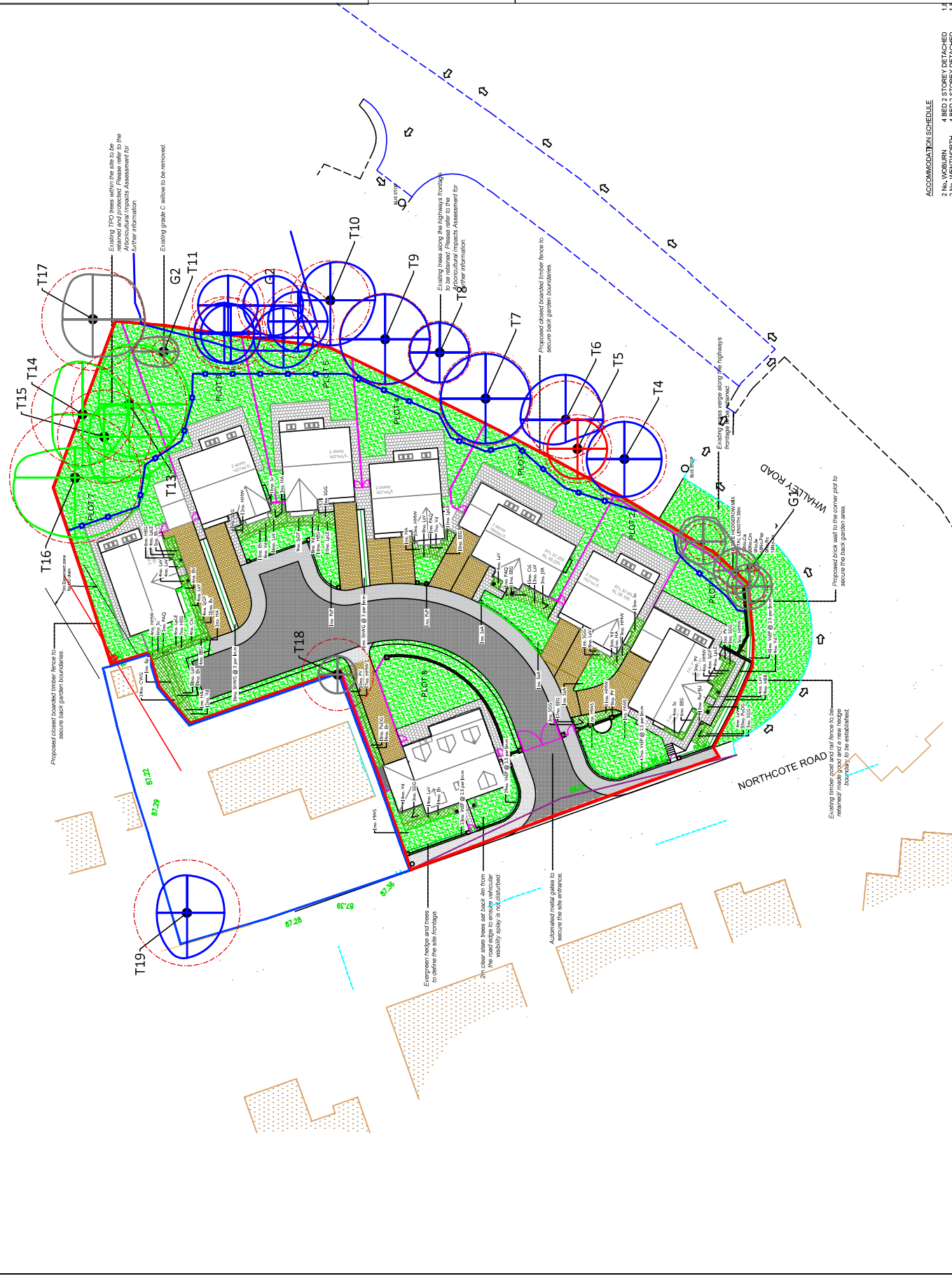

**ACCOMMODATION SCHEDULE**  
 2 No. WOBURN 4 BED 2 STOREY DETACHED  
 2 No. WENTWORTH 4 BED 2 STOREY DETACHED

1:8  
 1:8