

All dimensions are to be checked on site, any discrepancies are to be reported to the Architect before work commences.

This drawing is to be read in conjunction with all relevant consultants and specialist drawings / documents, any discrepancies are to be reported to the Architect before the affected work commences.

All structural components shown are indicative only. Details / calculations of structural members are to be provided by the Structural Engineer.

This drawing is copyright.

| | | |
|---|---|------------|
| A | First Issue | 28/05/2025 |
| B | Amendments following client's comments on 28/05/2025 | 29/05/2025 |
| C | Planning application submission | 30/07/2025 |
| D | Amendments following Highway's comments on 15/10/2025 | 15/10/2025 |

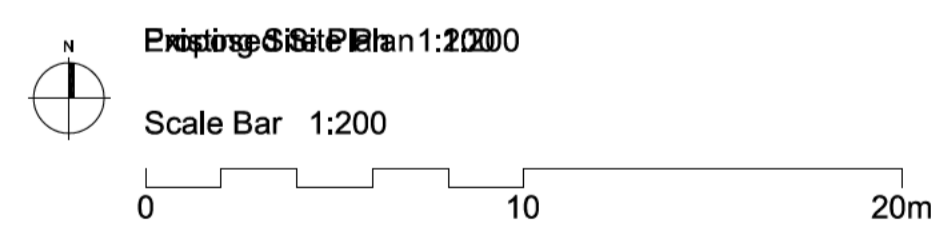
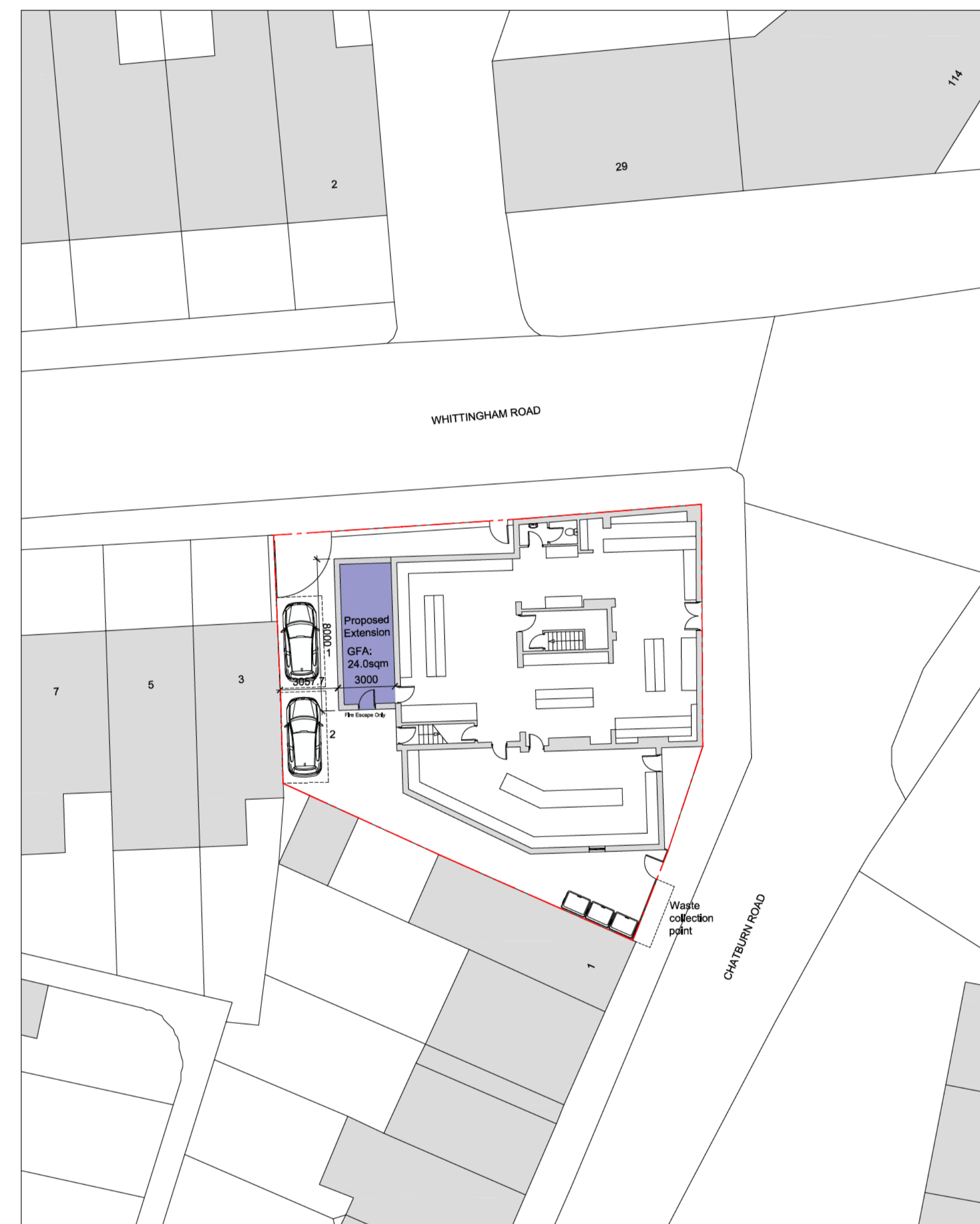
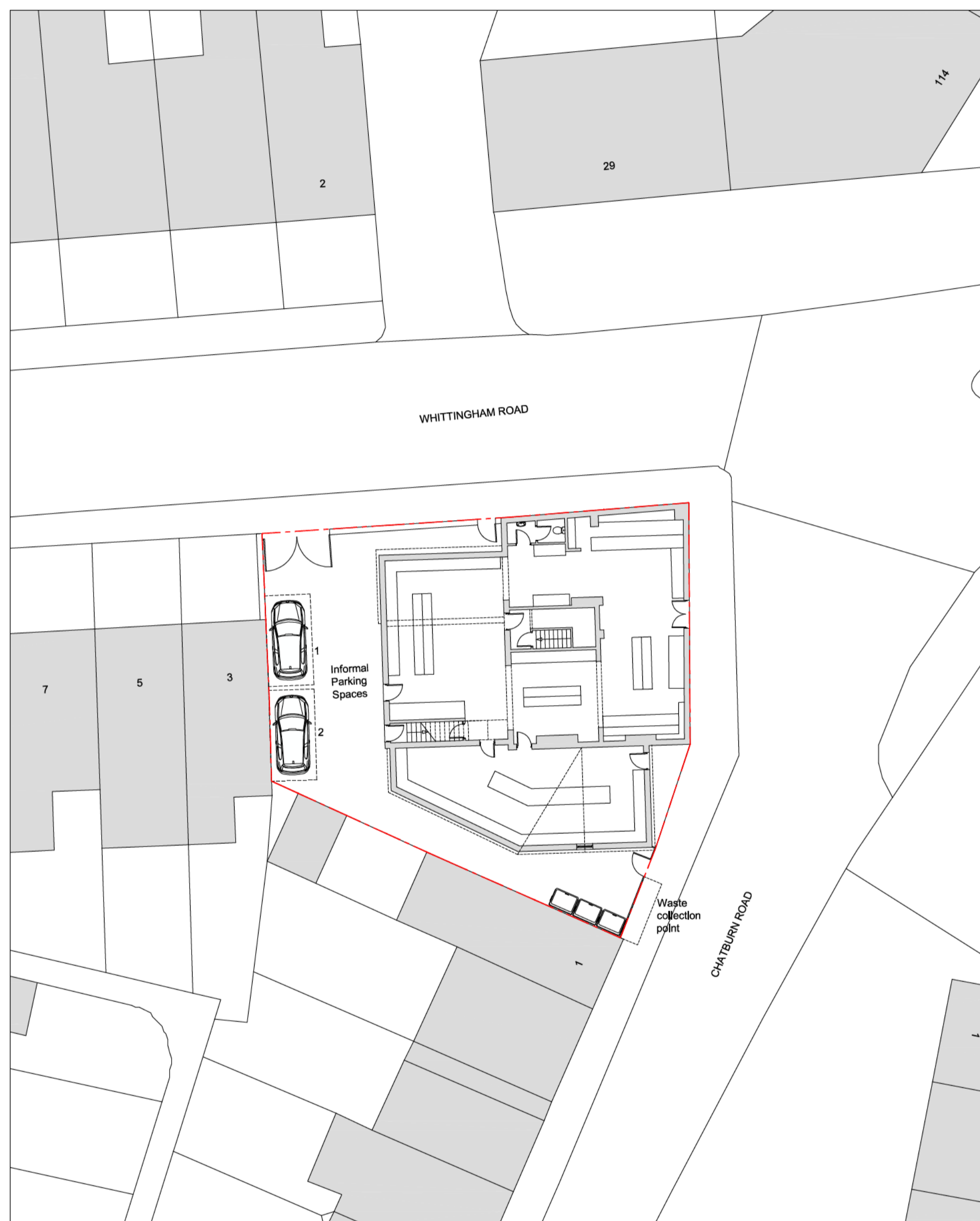

T+A Tang & Associates Ltd
Chartered Architects

Tel : 0161 877 8587 10/F, 1 City Approach, Albert Street,
Eccles, Manchester, M30 0SG, UK

Client:
HB Investments (NW) Ltd

Project:
1 Whittingham Road, Longridge, Preston
PR3 2AA

Drawing Title:
Existing & Proposed Site Plans

Scale: 1:200 @ A1 Date: May 2025

Drawing No: 9916/102 Revision: D