

IMPORTANT
 © This drawing is copyright and remains the property of this practice
 Do not scale this drawing
 All dimensions to be checked on site
 Positions of existing services to be confirmed prior to proceeding

REVISION STATUS
 S Information issued for feasibility or scheme design
 T Information issued for tender purposes only
 C Information issued for Construction
 NB: Only those drawings containing a C revision to be used for construction

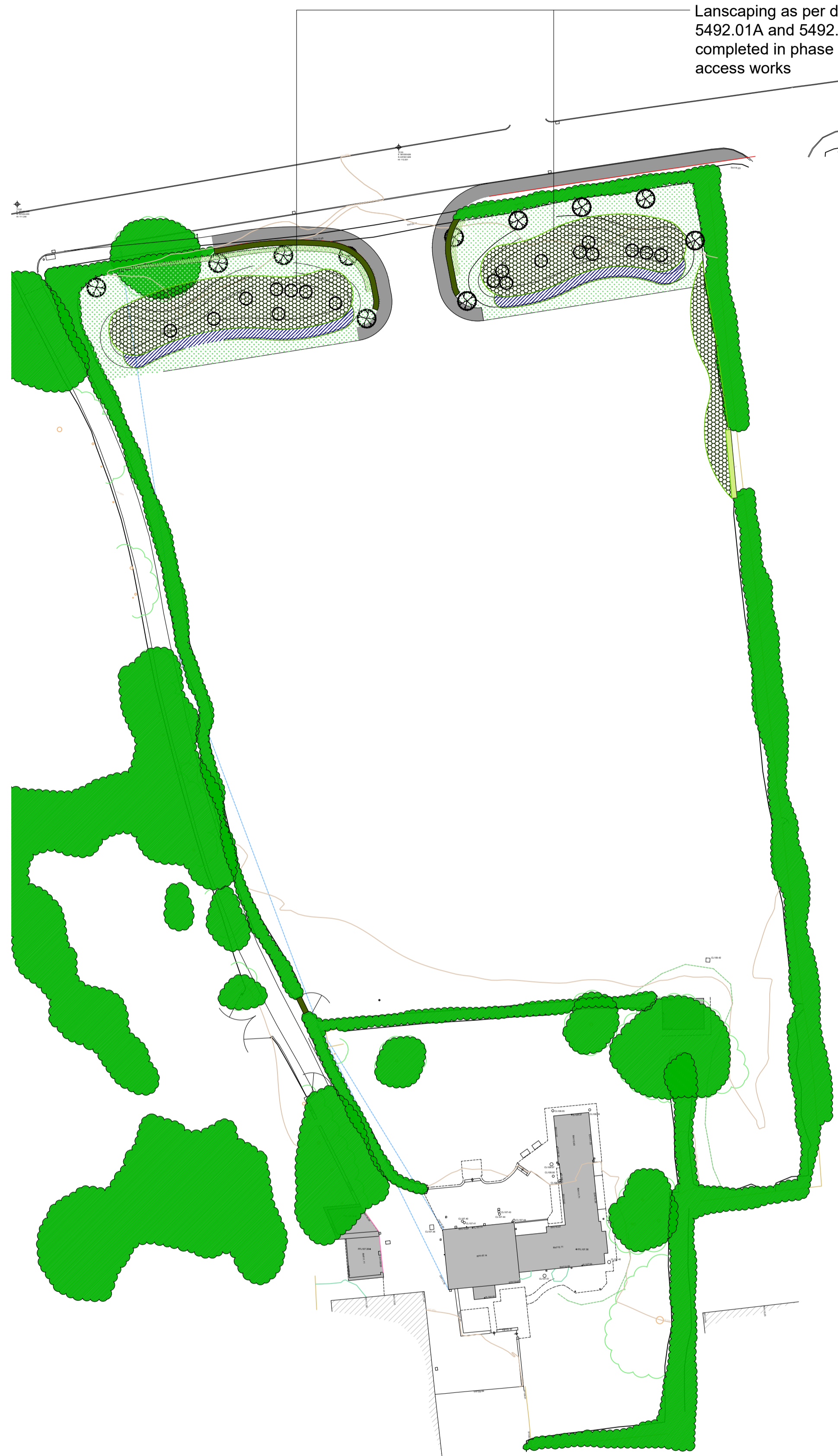

Phase 1 - Landscape Works & Site Entrance



Phase 2 - Construction of Buildings and Hardlandscaping



Phase 3 - Remainder of Soft Landscape Works

NOTES

Remainder of soft andscaping works to be completed within phase 3

Remainder of soft andscaping works to be completed within phase 3

Lanscaping as per drawings 5492.01A and 5492.02 to be completed in phase 1 with site access works

Buildings and hardlandscaping to be completed within phase 2

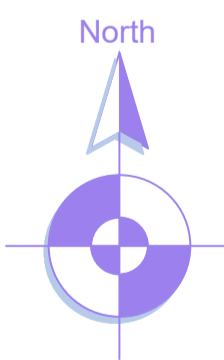

C1	12.0525	Updated for Section 73 application
REVISION	DATE	DESCRIPTION

CLIENT
 Ribbles Valley Property Ltd

PROJECT
 Proposed Development of Land at Higher College Farm, Longridge, PR3 2YY

DRAWING TITLE
 Site Phasing Plan

SCALE	DATE	DRAWN	CHECKED
1:500 @ A1	Oct '24	PRH	

DRG NO.	REVISION
EAD_203_14	C1

Evolve Architectural Design Ltd
 2 St Matthews School House
 Stanhill Lane
 Oswaldtwistle
 Accrington
 Lancashire BB5 4PZ
 T 01254 469702
 M 07957 592102
 E paul@evolvead.co.uk
 www.evolvead.co.uk

