

Drawn: JI	Date: 08/ 25	Title: CRANE WOOD FARM BARN	Drawing No: 137CW-02-01	Revision: C
Scale: 1/50 @ A3				
GROUND FLOOR AS PROPOSED				

James Innerdale Architect . 5 Gildersbank . Clapham . Lancaster . LA2 8EG . t: 07743100941 . e: jamesinnerdale@yahoo.co.uk

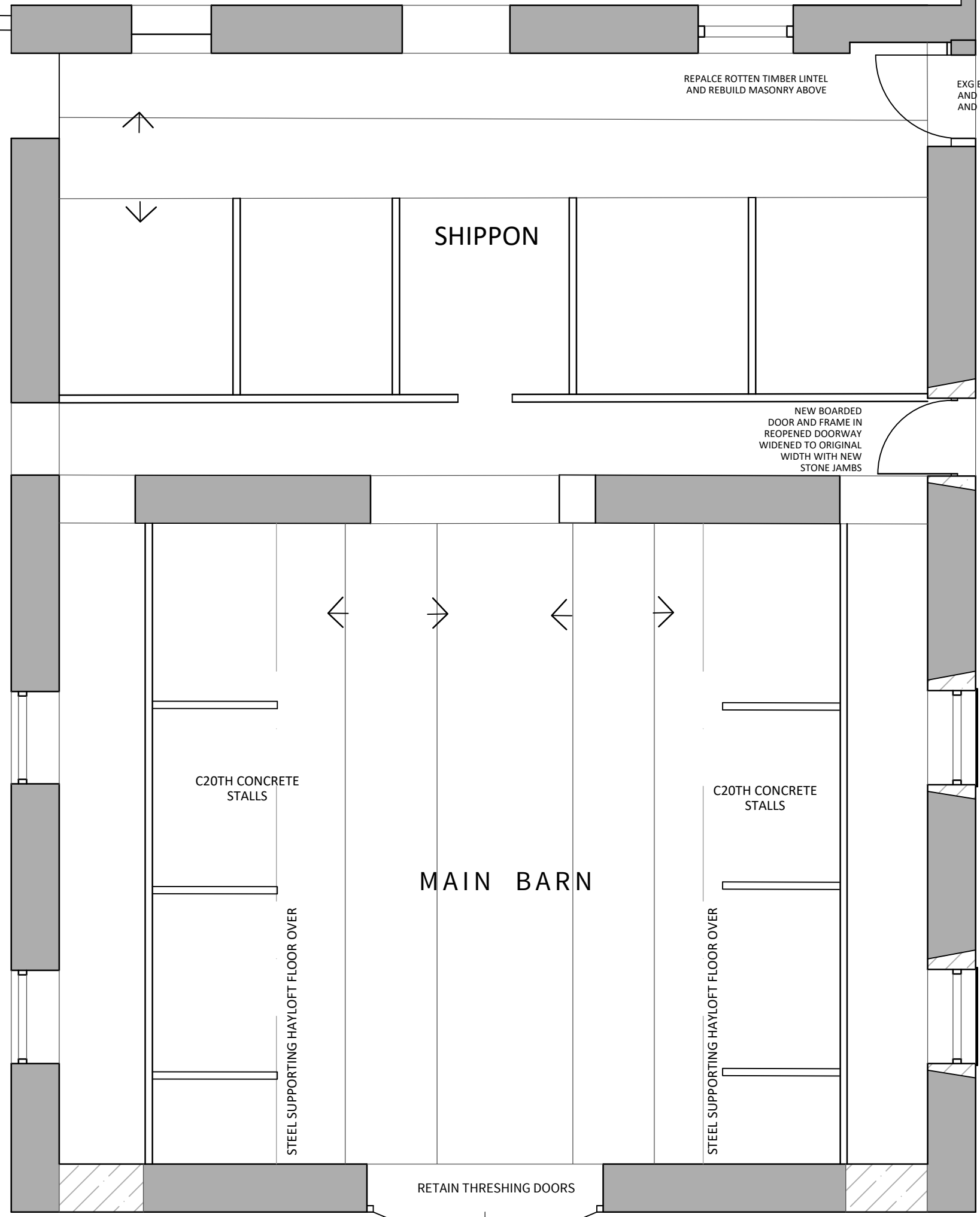

C20TH LEANTO NOT INCLUDED IN THE PROPOSALS



SHIPPON

MAIN BARN

C20TH CONCRETE STALLS

C20TH CONCRETE STALLS

STEEL SUPPORTING HAYLOFT FLOOR OVER

STEEL SUPPORTING HAYLOFT FLOOR OVER

RETAIN THRESHING DOORS

BLOCKED DOORWAY

BLOCKED DOORWAY

REPALCE ROTTEN TIMBER LINTEL AND REBUILD MASONRY ABOVE

EXG BOARDED DOOR AND FRAME REPAIRED AND RETAINED

NEW BOARDED DOOR AND FRAME IN REOPENED DOORWAY WIDENED TO ORIGINAL WIDTH WITH NEW STONE JAMBS

NEW STONE HEAD, CILL AND REVEALS TO OPENING

SHUTTER TO EXTERNAL FACE

NEW STONE HEAD, CILL AND REVEALS TO OPENING

SHUTTER TO EXTERNAL FACE