

NOTES:

1: The Contractor, Sub Contractor or specialist supplier are responsible for confirming site dimensions prior to fabrication 2: Any dimensional discrepancies are to be reported to the Architect immediately

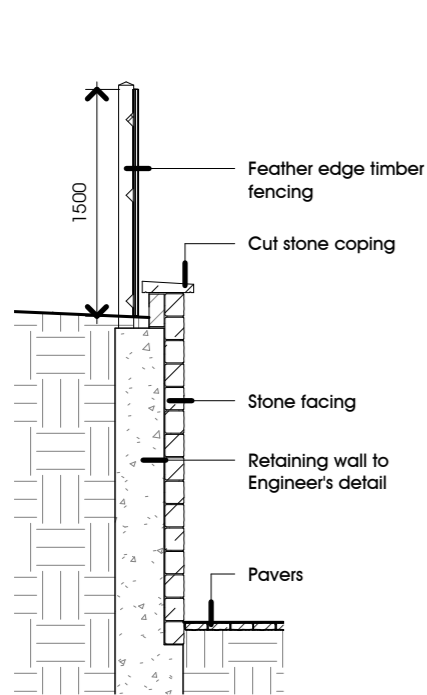

Section

1 : 50

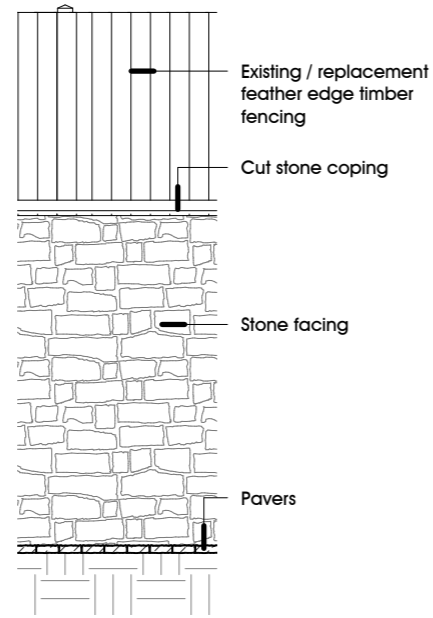

Elevation

1 : 50

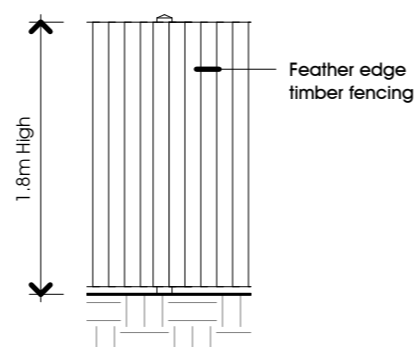

Fencing A

1 : 50

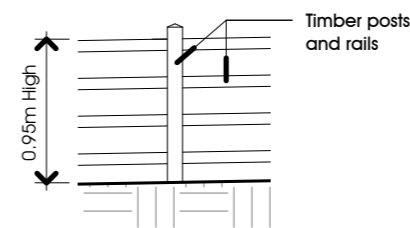

Fencing B

1 : 50

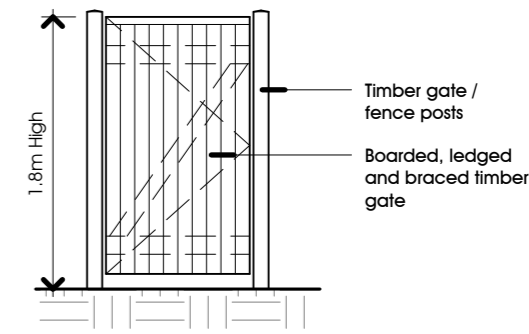

Typical Gate Elevation

1 : 50

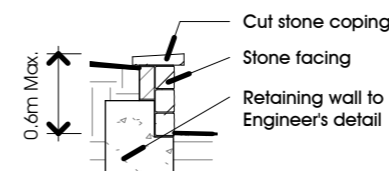

Section

1 : 50



Elevation

1 : 50

Retaining Wall 'A'

Boundary Treatment 'A'

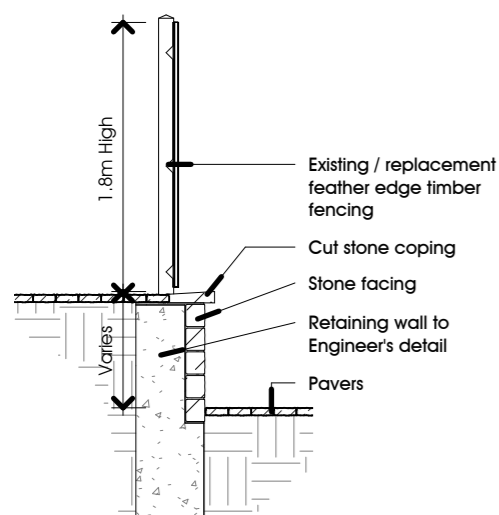

Section

1 : 50

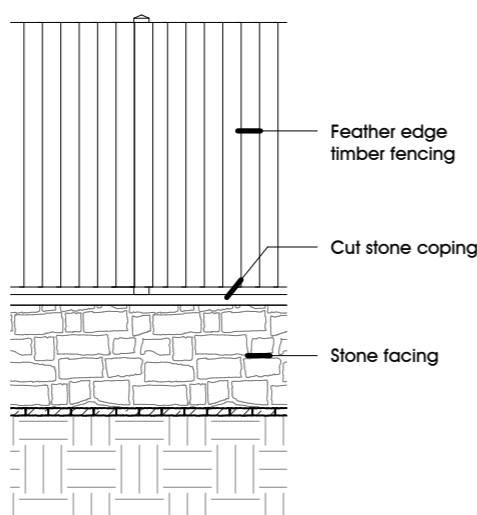

Elevation

1 : 50

Boundary Treatment 'B'

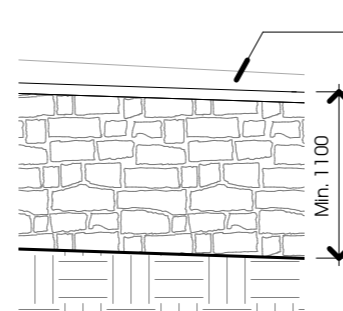

Elevation

1 : 50

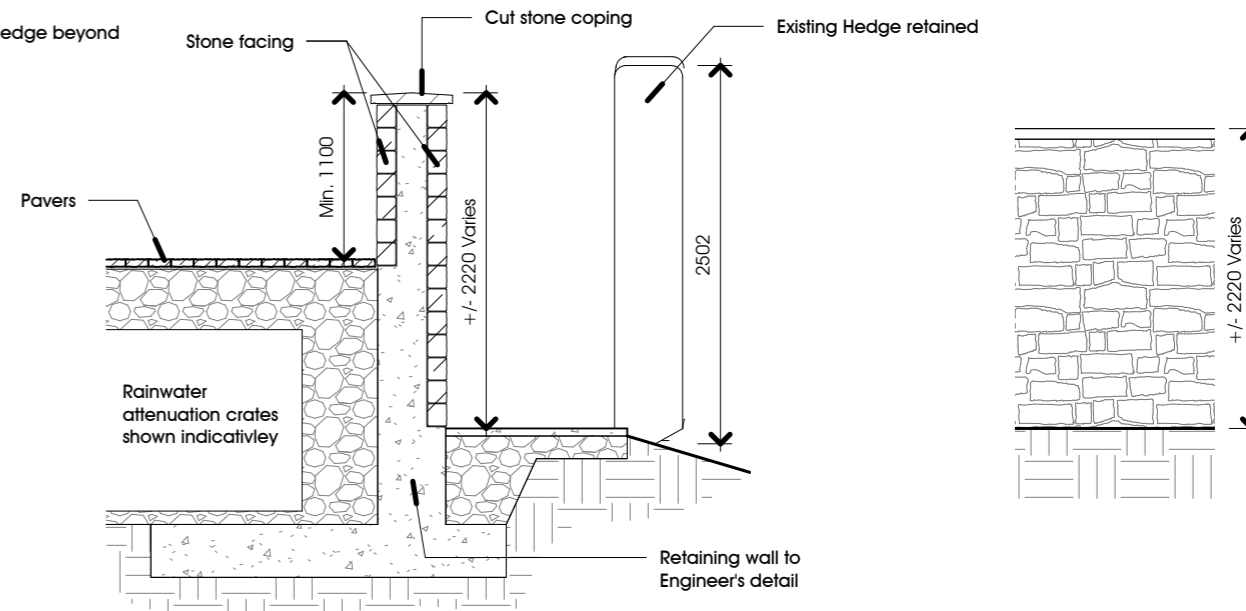

Section

1 : 50

Elevation Towards Darwen Close

1 : 50

Retaining Wall 'B'

A 01-04-26 Retaining Wall 'B' added

8 No. Proposed Dwellings

NGJ Holdings Ltd

Land to the rear of: The Dog Inn,
Market Place, Longridge. PR3 3RR

Discharge of Condition 14
Planning Application
Boundary Treatments

DATE July 2025

JOB NO 3443
DRAWING NO 021
REVISION A
SCALE 1 : 50 @ A3

PGB
ARCHITECTURAL
SERVICES LTD