

Drawing Numbering Key

This drawing is copyright and owned by Wilson Mason Architects and may not be reproduced or used unless accepted in writing.

DO NOT SCALE this drawing (printed or electronic version). Principal Contractor and Contractors must check all dimensions from site. This drawing is to be read in conjunction with all other Architects drawings and information and all other consultants and specialists' drawings and information.

All BIM elements other than Architecture, have been imported from the relevant consultant's BIM model, reference should be made to the individual consultant's drawings for their specific elements of work.

Discrepancies and / or ambiguities within this drawing, between it and information given elsewhere, must be reported immediately to Wilson Mason for clarification before proceeding.

All works are to be carried out in accordance with the latest CDM Safety Standards, Building Regulations, British Standards and Industry regulatory codes of practice and guidance unless specifically directed otherwise.

The Principal Contractor and Contractors are to ensure all works are carried out in accordance with current manufacturers specific requirements.

Responsibility for the reproduction of this drawing in paper form, or if issued in electronic format, lies with the recipient to check that all information has been replicated in full and is correct when compared to the original paper or electronic image. Graphical representations of coordinated equipment on this drawing are approximations only. Please refer to the Specifications and / or Details for actual sizes and / or specific contractor construction information.

This original document is issued for the purpose indicated below and contains information of confidential nature. Further copies and circulation will be strictly in accordance with the confidentiality agreement under the contract.

This Drawing Should be Printed in Colour

Second Floor GIFA - 2342m²
 Total Building GIFA - 7026m²

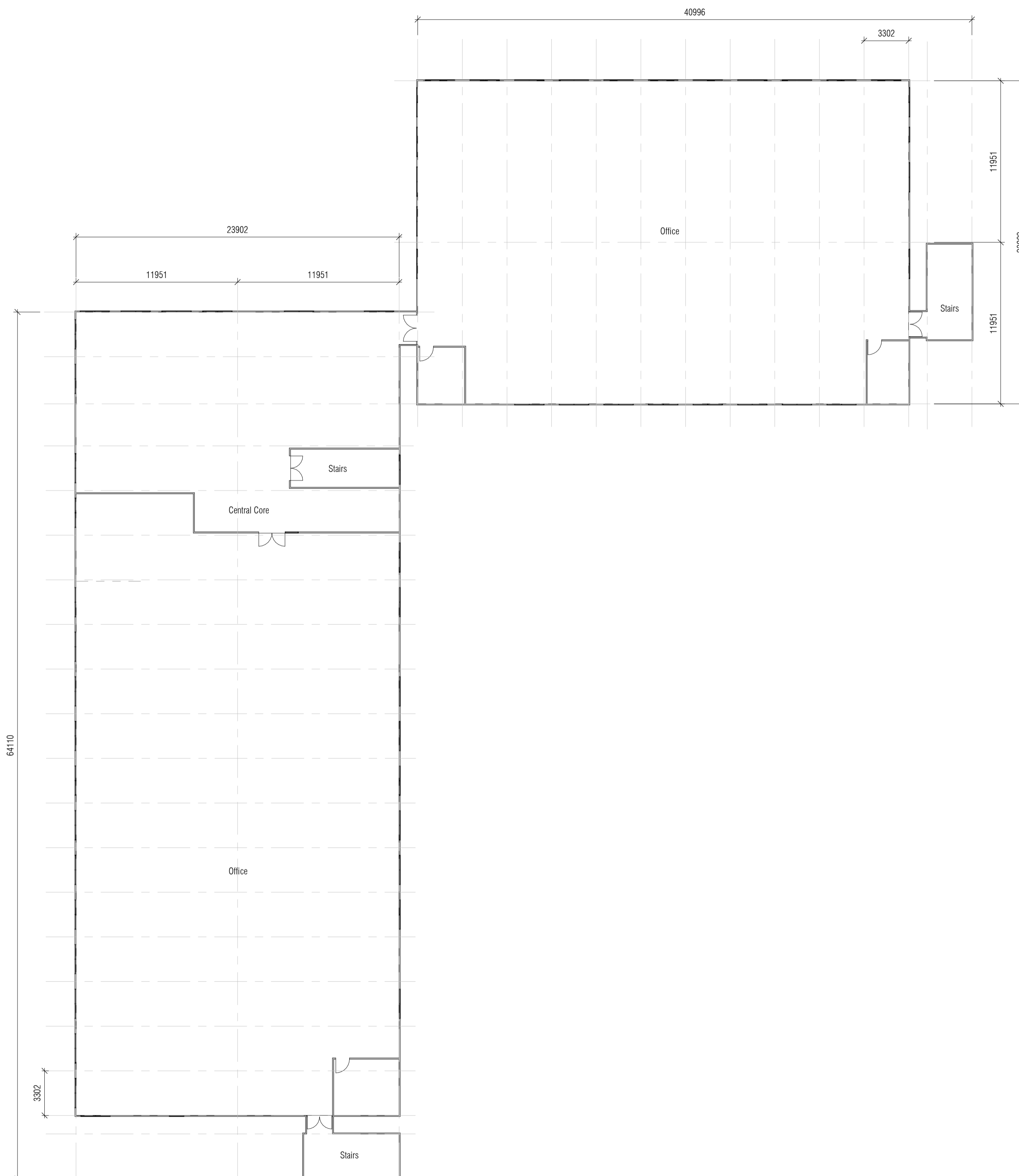

1 General Arrangement Second Floor Plan
 1: 200

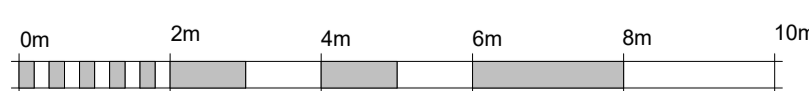

VISUAL SCALE 1:100 @ A1

PO2	Issued for Planning Submission	17.10.2025	TP	JP
PO1	Issued for Client Sign Off RIBA Stage 2	08.10.2025	TP	JP
Rev	Description	Date	Drawn	Checked

Client: **BAE SYSTEMS**

Project: Samsbury Modular Office

Title: General Arrangement Second Floor Plan - Planning

Project no:	7348	Scale:	1 : 200 @A1	Drawn by:	TP	Checked by:	JP	Date:	08.09.2025
Drawing no:	CEB-WMA-XX-01-DR-A-10-502	Status:	SO	Rev:	PO2				

WILSON MASON
 architecture and interior design

North: Spring Lane, Upland House, Samsbury, Lancashire, PR5 0UX
 Tel: 01752 877455
 E: north@wilsonmason.co.uk

London: 12 Albemarle Way, London, EC1V 4JB
 Tel: 020 7637 1501
 E: london@wilsonmason.co.uk

W: www.wilsonmason.co.uk.