

NOTES

THIS IS NOT A CONSTRUCTION DRAWING AND IS FOR INDICATIVE PURPOSES ONLY.
THE DRAWING WILL BE SUBJECT TO CHANGE FOLLOWING LOCAL AUTHORITY REVIEW AND CONFIRMATION OF PUBLIC HIGHWAY AND THIRD PARTY LAND BOUNDARIES.

LOCAL AUTHORITY: LANCASHIRE COUNTY COUNCIL

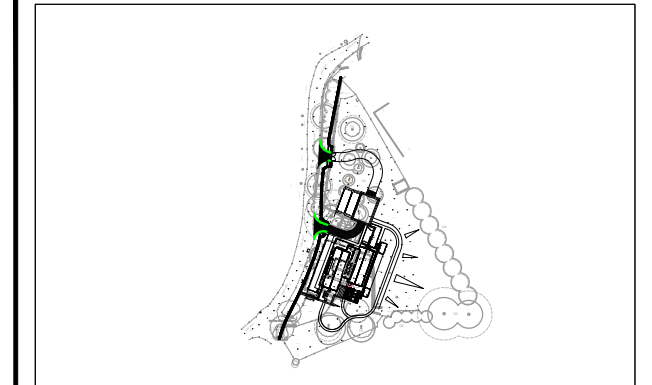

SITE LAYOUT (NTS)

REV	DETAILS	DRAWN	CHECKED	DATE
C	SITE LAYOUT REVISED SITE LAYOUT REVISED MINOR AMENDMENTS	LB	MR	NOV 2025
B		LB	MR	NOV 2025
A		LB	MR	NOV 2025

CLIENT:
DAVID DENNIS

PROJECT:
**KEMPLE DOWN, BIRDY BROW,
CHAIGLEY, CLITHEROE**

DRAWING TITLE:
PROPOSED SITE ACCESS

SCALES:
1:500 @ A3

DRAWN: **LB** CHECKED: **MR** DATE: **NOV 2025**

Eddisons
340 Deansgate
Manchester
M3 4LY
Email: info@crofts.co.uk
Tel: 0161 837 7380
Web: www.eddisons.com/services/transport-planning

DRAWING NUMBER: **5017-F02** REVISION: **C**



2.4x59M VISIBILITY SPLAY

VEGETATION TO BE TRIMMED BACK TO ADOPTED HIGHWAY EXTENT

R4.5m

ENTRANCE ONLY ACCESS

EXIT ONLY

VEGETATION TO BE TRIMMED BACK TO ADOPTED HIGHWAY EXTENT

2.4x65M VISIBILITY SPLAY

C:\Users\Leon.Blythe\OneDrive - Begbies Traynor Group\Desktop\GA Work\5017-F02 Rev B.dwg