

Accrington Road

21000

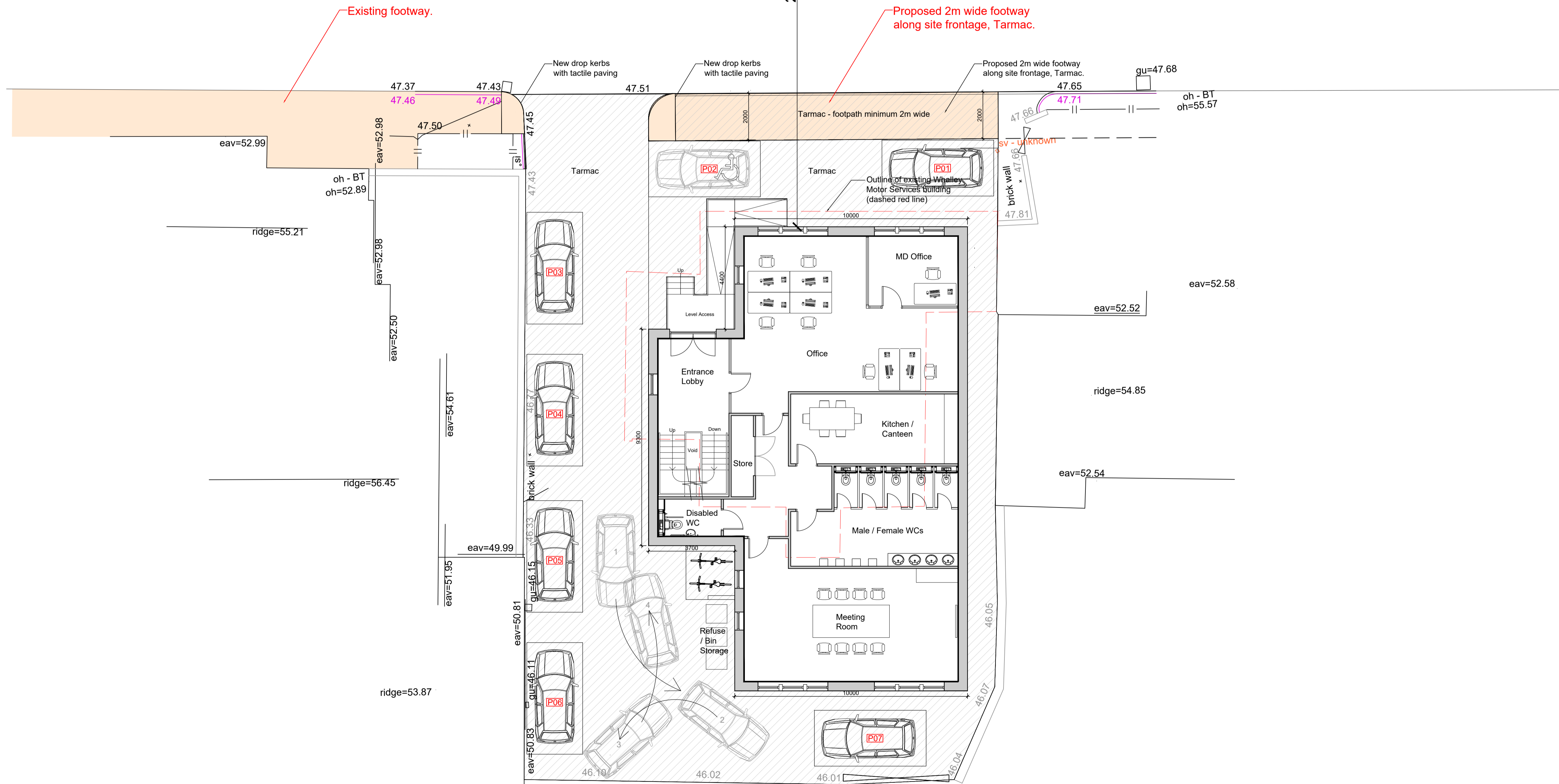

Proposed Site Plan
1:100 Scale

Rev D. 2m wide footway annotated, 7no. parking spaces provided and annotated. 18.05.2026 Craig Harrison
 Rev C. 2m wide footway added as per previous planning ref 3/2019/0831. 13.10.2025 Craig Harrison
 Rev B. Updated for Planning App. 13.10.2025 Craig Harrison

Client
 Mr Daniel McGowan

Job Title
 Redevelopment of former Whalley Motor Services site into new offices at:
 18 Accrington Road
 Whalley
 BB7 9TD

Drawing Title
 Proposed Site Plan

Scale
 1:100 @ A1

Date
 June 2025

Drawn
 Craig Harrison



7261 -003D