

notes

This document is copyright © of Jackson-Crane Architecture. It shall be read in conjunction with all other associated project information including models, specifications, schedules and related consultants documents. Do not scale from documents. All dimensions to be checked on site. Immediately report any discrepancies, errors or omissions on this document to the Originator. If in doubt: ASK.

project north

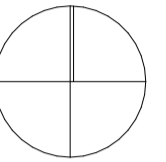

Potential area for small car parking area for visitors to view roman road

Course of the roman road. to be verified on site by Roman Road Association

Location of natural spring. Water to be redirected to the house for irrigation of crops.

Location of a previously identified stone wall pen.



design intent for bin enclosure. Sedum roof or similar.

revisions

Rev	Description	Date	Initials

status Work In Progress

client Mr Neil Richards

project Higher Road, Longridge, Preston, PR3 2YX

drawing title Site Plan as Proposed

revision

drawn by DJC

approved by DJC

paper size A1

project number 20-002

scale 1:500

drawing no:

01003

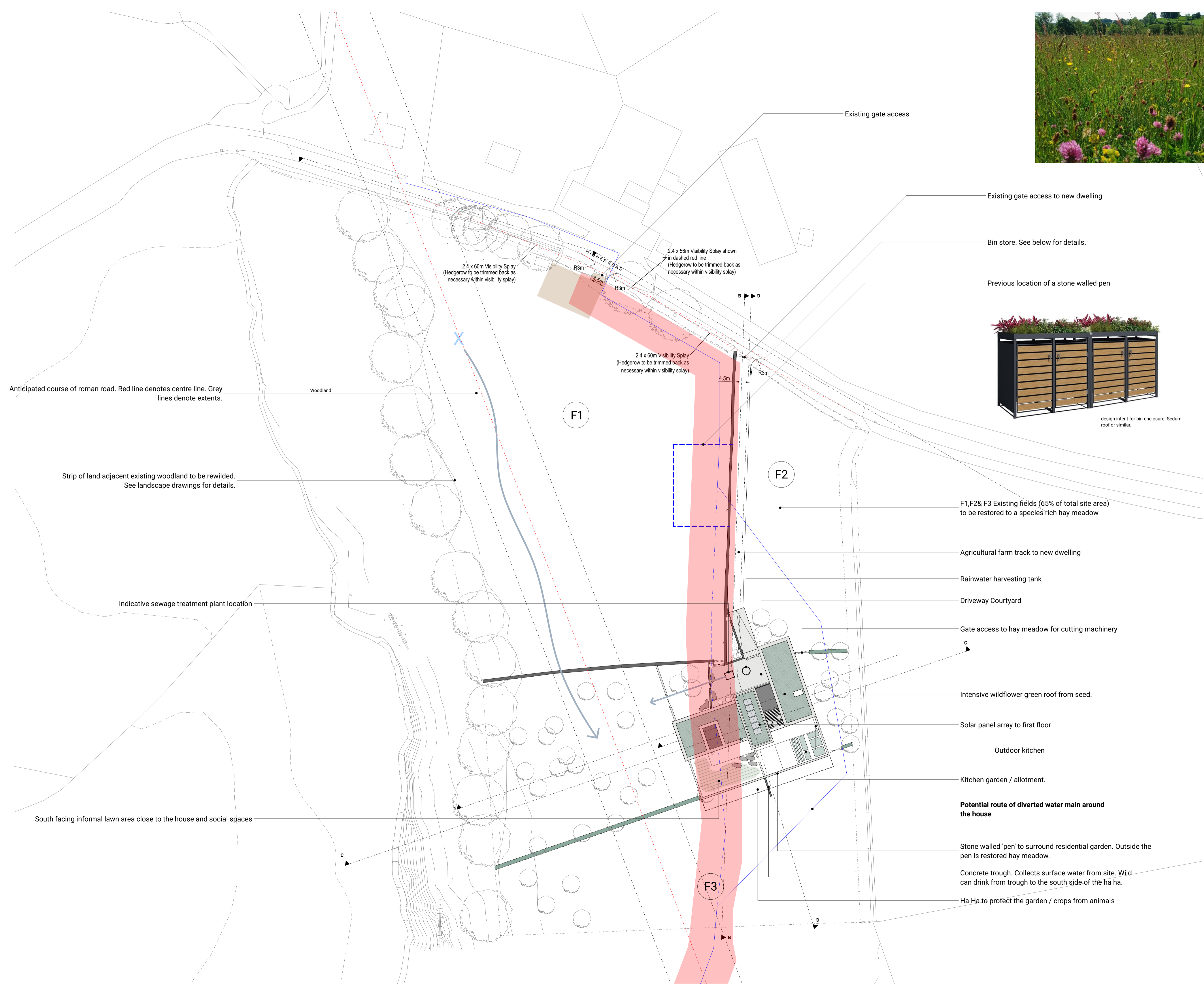

Existing gate access

Existing gate access to new dwelling

Bin store. See below for details.

Previous location of a stone walled pen

2.4 x 60m Visibility Splay (Hedgerow to be trimmed back as necessary within visibility splay)

2.4 x 56m Visibility Splay shown in dashed red line (Hedgerow to be trimmed back as necessary within visibility splay)

2.4 x 60m Visibility Splay (Hedgerow to be trimmed back as necessary within visibility splay)

Anticipated course of roman road. Red line denotes centre line. Grey lines denote extents.

Strip of land adjacent existing woodland to be rewilded. See landscape drawings for details.

Indicative sewage treatment plant location

South facing informal lawn area close to the house and social spaces

F1, F2 & F3 Existing fields (65% of total site area) to be restored to a species rich hay meadow

Agricultural farm track to new dwelling

Rainwater harvesting tank

Driveway Courtyard

Gate access to hay meadow for cutting machinery

Intensive wildflower green roof from seed.

Solar panel array to first floor

Outdoor kitchen

Kitchen garden / allotment.

Potential route of diverted water main around the house

Stone walled 'pen' to surround residential garden. Outside the pen is restored hay meadow.

Concrete trough. Collects surface water from site. Wild can drink from trough to the south side of the ha ha.

Ha Ha to protect the garden / crops from animals