

ANY ALTERATION OR DEVIATION MUST BE CONFIRMED WITH THE ARCHITECT/ENGINEER/LPA/LABC PRIOR TO ANY WORKS BEING CARRIED OUT. IT IS THE CONTRACTORS SOLE RESPONSIBILITY TO CONFIRM ALL SITE MEASUREMENTS PRIOR TO ANY ORDERING OR COMMENCEMENT AS NO RESPONSIBILITY IS ACCEPTED OR IMPLIED BY THE ARCHITECT/ENGINEER ETC.

THE DRAWINGS AND INFORMATION HEREIN IS AND REMAINS SOLELY THE PROPERTY OF THE ARCHITECT/DESIGNER ANY UNAUTHORISED USE/COPYING/SHARING/PUBLICATION/SUBMISSION ETC WILL NOT BE PERMITTED UNDER COPYRIGHT LAW/INTELLECTUAL PROPERTY. THIS USE ALSO EXTENDS TO THAT OF THE LPA/LABC AND CHECKS MUST BE MADE TO SATISFY THE SOURCE OF THE DOCUMENT PRIOR TO USE.

CLIENT
MR B PROCTOR

ISSUE

PROJECT NO.
01/01/01/BREG

PROJECT
PROPOSED DORMER & INFILL EXTENSION TO REPLACE EXISTING AT 10 CLITHEROE ROAD, WHALLEY.

DRAWN BY
SJ

DESCRIPTION
PROPOSED GENERAL SECTION
1:50

PAPER SIZE A3

A10

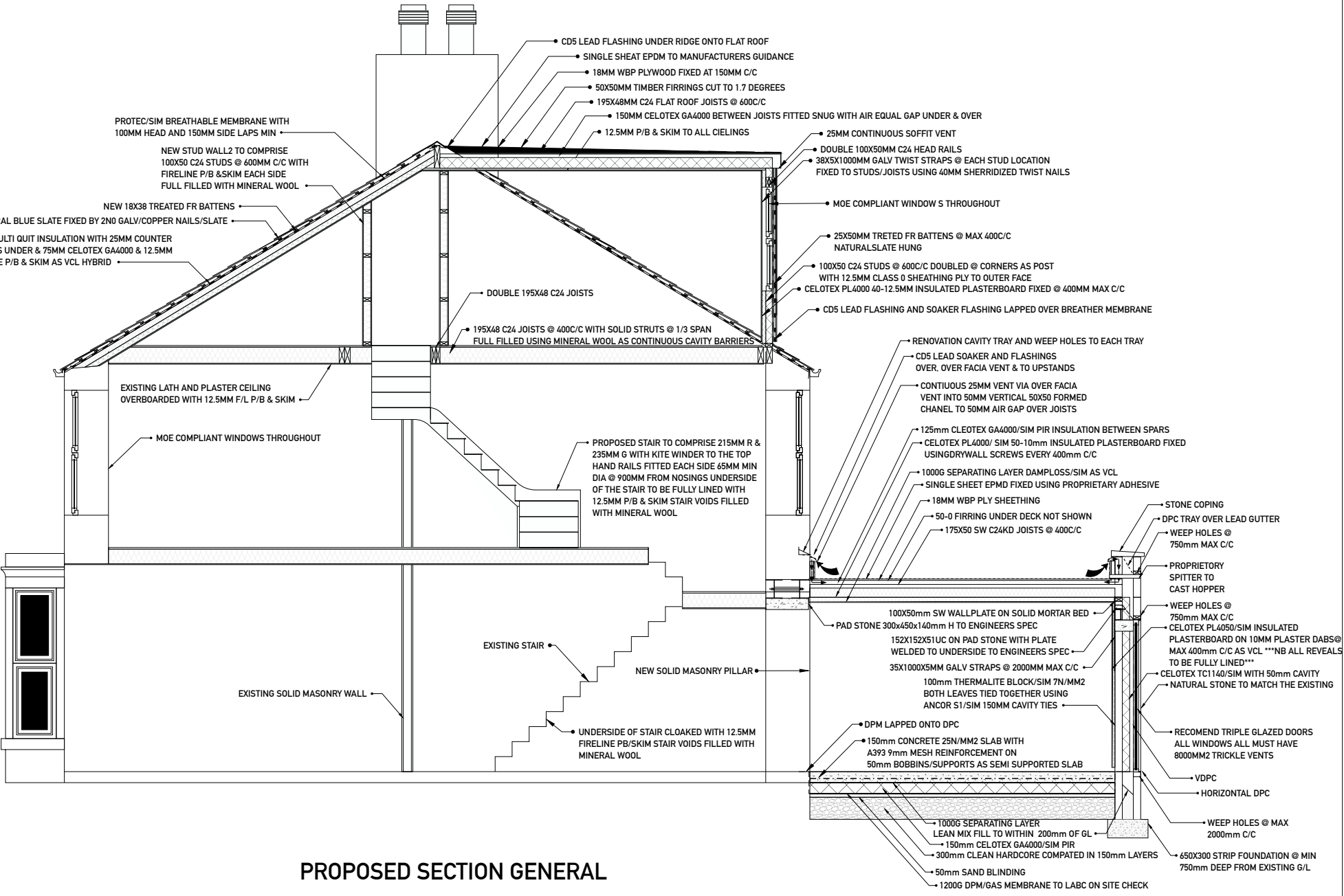

PROPOSED SECTION GENERAL

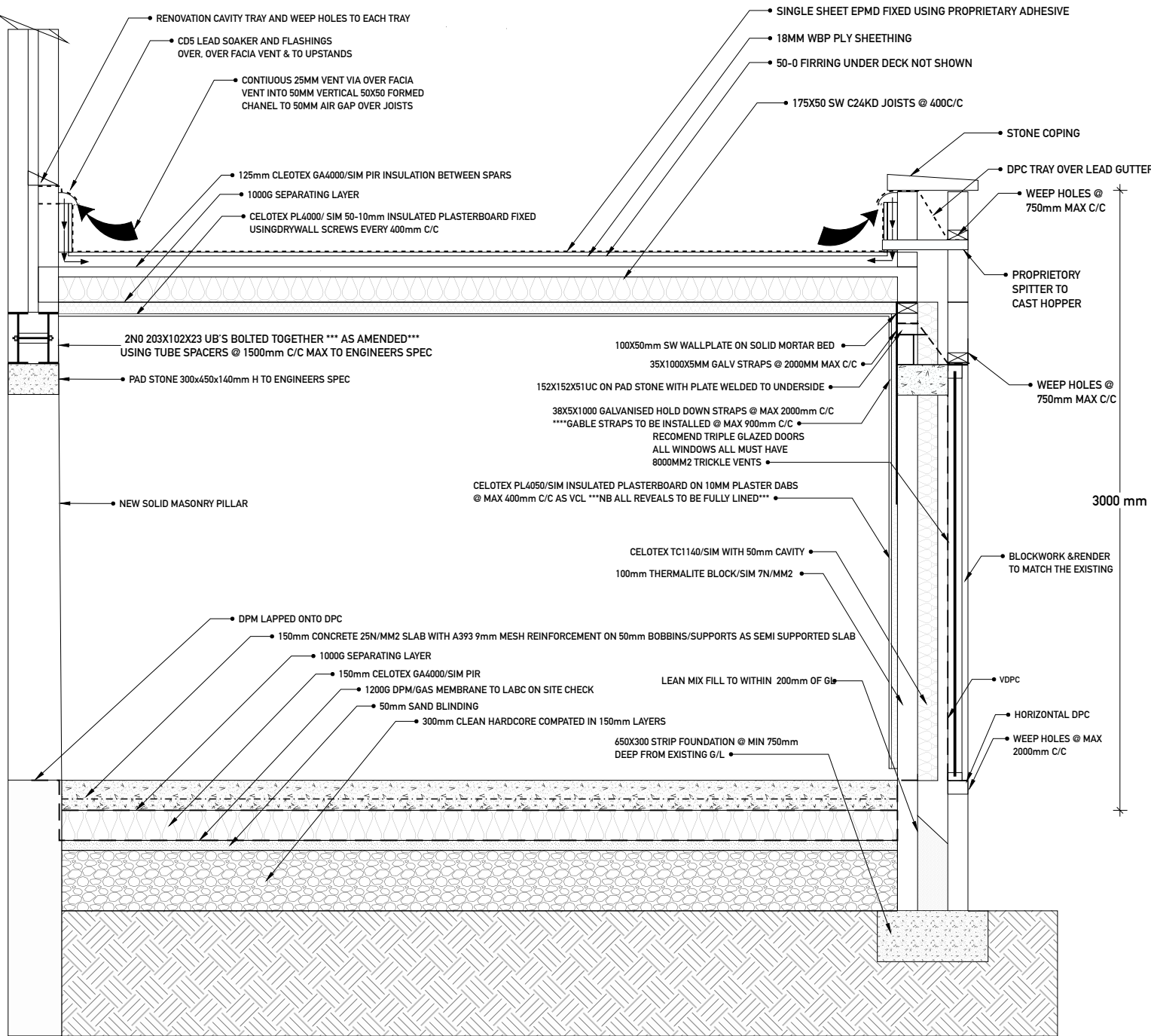

FOUNDATIONS:- TO BE 750MM WIDE AND MIN 300MM THICK SOLID CONCRETE TO ST4 25N/MM2 MINIMUM THE INVERT OF WHICH TO BE AT THE SAME DEPTH AS THE EXISTING HOUSE FOUNDATIONS.
 IT IS RECOMMENDED THAT A MIN DEPTH OF 750MM BE ACHIEVED ALL FOUNDATIONS TO BE TO THE FULL SATISFACTION OF LABC INSPECTOR.
 THE FOUNDATION WALLS TO COMPRISE OF 350MM THICK SOLID MASONRY TO WITHIN 200MM OF THE GROUND LEVEL WITH BRICK/BLOCKWORK TO DPC LEVEL AND WEEP-HOLES POSITIONED @ 2000MM MAX C/C BELOW DPC LEVEL.
 FLOOR:- TO COMPRISE OF 150MM A MESH REINFORCED SOLID CONCRETE TO ST4 25N/MM2 WITH THE MESH SUPPORTED ON 50MM BOBBINS, ON 1000G SEPARATING LAYER OF POLYTHENE, ON 150MM CELLOTEX/SIM PIR INSULATION WITH ALL JOINTS TAPED WITH AN UPSTAND OF 150MM TO THE PERIMETER. 1200G**** VISQUEEN DPC LAPPED ONTO DPC, ON 50MM WELL COMPACTED Z2 SAND BLINDING ON 300MM MIN WELL COMPACTED CLEAN AND FREE FROM TERIOUS MATTER MOTI HARDCORE COMPACTED IN 150MM LAYERS.
 ****GAS MEMBRANE CHECK AND GROUND VENTING IT MAY BE A REQUIREMENT OF LABC THAT A GAS MEMBRANE BE FITTED WITH GROUND VENTING OF THE EXISTING PROPERTY LABC TO CONFIRM ON SITE****
 WALLS:- ALL WALLS TO COMPRISE OF 100MM NOM NATURAL STONE, 100MM KINGSPAN WITH 50MM CAVITY & 100MM 7N THERMALITE BLOCK WITH BOTH LEAVES TIED TOGETHER WITH ANCON S1 S/S TIES AT 750MM HORIZONTAL & 450MM VERTICAL SPACINGS WITH ADDITIONAL TIES AT OPENINGS AT 1 TIE PER BLOCK 225MM COURSE AND WHERE THE NEW WORK AND EXISTING ABUTE ****ALL ABUTTING MASONRY TO BE FULLY TOOTHED AND CAVITIES CONTINUOUS WITH THE EXISTING PROPERTY****KINGSPAN K8 OR SIMILAR 50-12.5 INSULATION TO PLASTERBOARD COMPOSITE ON 10MM PLASTER DABS @ 400C/C AS VCL TO ALL INNER FACES, THE PARAPET TO BE CAPPED BY STONE TAPERED COPING WITH DPC TRAY UNDER WEEP HOLES @ 750mm C/C OVER FACIA VENTS FITTED TO THE INNER ROOF PERIMETER TO FULLY VENT THE AIR SPACE AT CEILING JOIST LEVEL.
 1ST FLOOR CONSTRUCTION:- TO COMPRISE OF 195X47 SW C24KD JOISTS @ 400MM C/C TO TAYLOR MAXWELL SPAN TABLES WITH SOLID STRUTS @ 1/3 SPAN, IT IS RECOMMENDED THAT ROCKWOOL/SIM INSULATION ON SUPPORT MESH BE PROVIDED BETWEEN THE JOISTS TO IMPROVE BOTH THERMAL AND SOUND TRANSMISSION, BELOW WHICH A 1000G SEPARATING LAYER TO BE PROVIDED AS VCL WITH 12.5MM PLASTER BOARD AND SKIM ALL JOINTS TAPED, ABOVE THE JOISTS THERE WILL BE 22MM T&G FLOORING MOISTURE RESISTANT WITH ALL JOINTS GLUED.
 ROOF:- THE ROOF CONSTRUCTION TO COMPRISE OF 225X75X2N0 RAFTERS SUPPORTING THE DORMER CHEEKS, 195X47 FLAT ROOF JOISTS ON 100X50SW WALLPLATE BEDDED ON MORTAR BEDDING WITH ALL JOINS HALF LAPPED THE WALL PLATE WILL BE HELD BY 5X38X1000MM CRANKED BAT/LAT STRAPS AT MAX 2000MM C/C ***ALL CONERS AND ABUTMENTS TO HAVE STRAPS TO EACH MASONRY WALL/LEG. BELOW THE FLAT ROOF DORMER JOISTS 1000G SEPARATING LAYER AS VCL WITH 12.5MM PLASTERBOARD AND SKIM ALL JOINTS TAPED.
 ROOF INSULATION EXISTING ROOF TO HAVE 65MM MULTI QUILT WITH 50MM CELOTEX UNDER WITH 12.5MM FIRELINE P/B & SKIM.
 DORMER ROOF TO HAVE 150MM CELOTEX GA4000 WITH PL4000 50-12.5MM INSULATED PLASTERBOARD & SKIM.
 FLAT ROOF TO HAVE AS ABOVE THE LANTERN MUST HAVE A MIN U VALUE OF 1W/M2K
 ROOF COVERING:- THE ROOF COVERING TO COMPRISE OF PROTEC/SIM BREATHABLE MEMBRANE WITH 100MM HEAD AND 200MM SIDE LAPS FIXED WITH 10MM GALV STAPLES @ 400MM C/C OVER THE SPARS, WITH 18X50MM SW TANILISED BATTENS LAID TO THE CORRECT TILE GAUGE WITH A MIN LENGTH OF 1200MM OR 3 SPAR SPAN WHICHEVER IS THE GREATER, FIXED BY 70MM 6.5G GALVANISED NAILS AT 2 PER SPAR ALL JOINTS TO BE MITRED, WITH NATURAL SLATE OVER FIXED AT 2 NAIL PER SLATE ON EACH COURSE TO THE RECOMMENDATIONS OF THE MANUFACTURER. SLATE VENTS MUST BE INSTALLED AT 2000MM C/C HORIZONTALLY AT MID SPAN, THE RIDGE TO COMPRISE OF KLOBER/SIM VENTED DRY FIX RIDGE SYSTEM WITH MARLEY MODERN/SIM RIDGE TILES HIP BONETS MUST BE USED AT THE JUNCTION BETWEEN RIDGE AND HIP.
 WINDOWS AND DOORS:- TO BE UPVC D6 UNTIS TO BS6262 WITH A D6 UNIT OF 4-20-4 OF FLOAT GLASS OUTER, KRYPTON/ARGON FILLED CAVITY, LOW COATED TO THE INNER PANE. ANY GLAZING BELOW 800MM FROM FFL OF ADJACENT TO A DOOR MUST BE TOUGHENED GLASS.
 ROOF LINE:- THE ROOFLINE TO COMPRISE OF UPVC FACIAS AND CONTINUOUSLY VENTED SOFFITS CLAER VENTILATION FROM THE SOFFIT TO THE ROOF VOID MUST BE MAINTAINED, 110MM GUTTERS TO BE PROVIDED SUPPORTED BY PROPRIETARY CLIPS AT MAX 750MM C/C TERMINATING INTO 78MM DOWNPIPES TERMINATING INTO THE EXISTING GULLIES. ***N.B*** NO ALTERATIONS REQUIRED FOR THE DRAINAGE PROVISION AT THIS TIME.
 ELECTRICAL GAS WATER VENTILATION:-
 ALL ELECTRICAL WORK TO COMPLY WITH AND BE DESIGNED INSTALLED & COMMISSIONED BY A COMPETENT PERSON UNDER THE COMPETENT PERSON SCHEME TO PT P OF THE REGULATIONS.
 ALL GAS INSTALLATIONS TO COMPLY FULLY WITH GAS SAFE REGS
 ALL WATER INSTALLATIONS TO COMPLY WITH WRAS REGS FULLY AND PROVIDE WHOLESOME HOT AND COLD WATER WITH FLOW RESTRICTORS ALL OUTLETS AND TEMP RESTRICTORS TO HOT OUTLET SET AT 38 DEGREES MAX TEMP.
 PASSIVE AND BACKGROUND VENTILATION TO BE PROVIDED BY 8000MM2 TRICKLE VENTS TO ALL WINDOWS AND MECHANICAL VENTILATION TO AL W.C/ BATHROOMS/EN-SUITES OF 15L/SEC FOCUSED OR 30L/SEC IN ROOM VENTILATION.
 INTERLINKED SMOKE AND HEAT PROTECTION TO BE INSTALLED THROUGHOUT WITH BATTERY BACKUP TO BS5839.



ARCHTECH DESIGN SOLUTIONS LTD
 MR STEVEN JACKSON
 14 HAITLAND PLACE, ROSSENDALE
 0772185853
 archtech_design@icloud.com

ANY ALTERATION OR DEVIATION MUST BE CONFIRMED WITH THE ARCHITECT/ENGINEER/LPA/LABC PRIOR TO ANY WORKS BEING CARRIED OUT. IT IS THE CONTRACTORS SOLE RESPONSIBILITY TO CONFIRM ALL SITE MEASUREMENTS PRIOR TO ANY ORDERING OR COMMENCEMENT AS NO RESPONSIBILITY IS ACCEPTED OR IMPLIED BY THE ARCHITECT/ENGINEER ETC.

THE DRAWINGS AND INFORMATION HEREIN IS AND REMAINS SOLELY THE PROPERTY OF THE ARCHITECT/DESIGNER ANY UNAUTHORISED USE/ COPYING/SHARING/ PUBLICATION/SUBMISSION ETC WILL NOT BE PERMITTED UNDER COPYRIGHT LAW/ INTELLECTUAL PROPERTY. THIS USE ALSO EXTENDS TO THAT OF THE LPA/LABC AND CHECKS MUST BE MADE TO SATISFY THE SOURCE OF THE DOCUMENT PRIOR TO USE.

CLIENT
 MR B PROCTOR

ISSUE

PROJECT NO.
 02/01/01/BREG

PROJECT
 PROPOSED DORMER & INFILL EXTENSION TO REPLACE EXISTING. AT 10 CLITHEROE ROAD, WHALLEY.

DRAWN BY
 SJ

DESCRIPTION
 PROPOSED GENERAL SECTION
 1:20

PAPER SIZE A3

A11

NTS
PROPOSED SIDE ELEVATION GENERAL SECTION