

- Notes:
1. Do not scale from this drawing
 2. This drawing is copyright and may not be copied or given to a third party without written authority from Ashley Helme Associates Ltd
 3. Subject to detailed design
 4. Based upon digitised OS plan and topographical survey

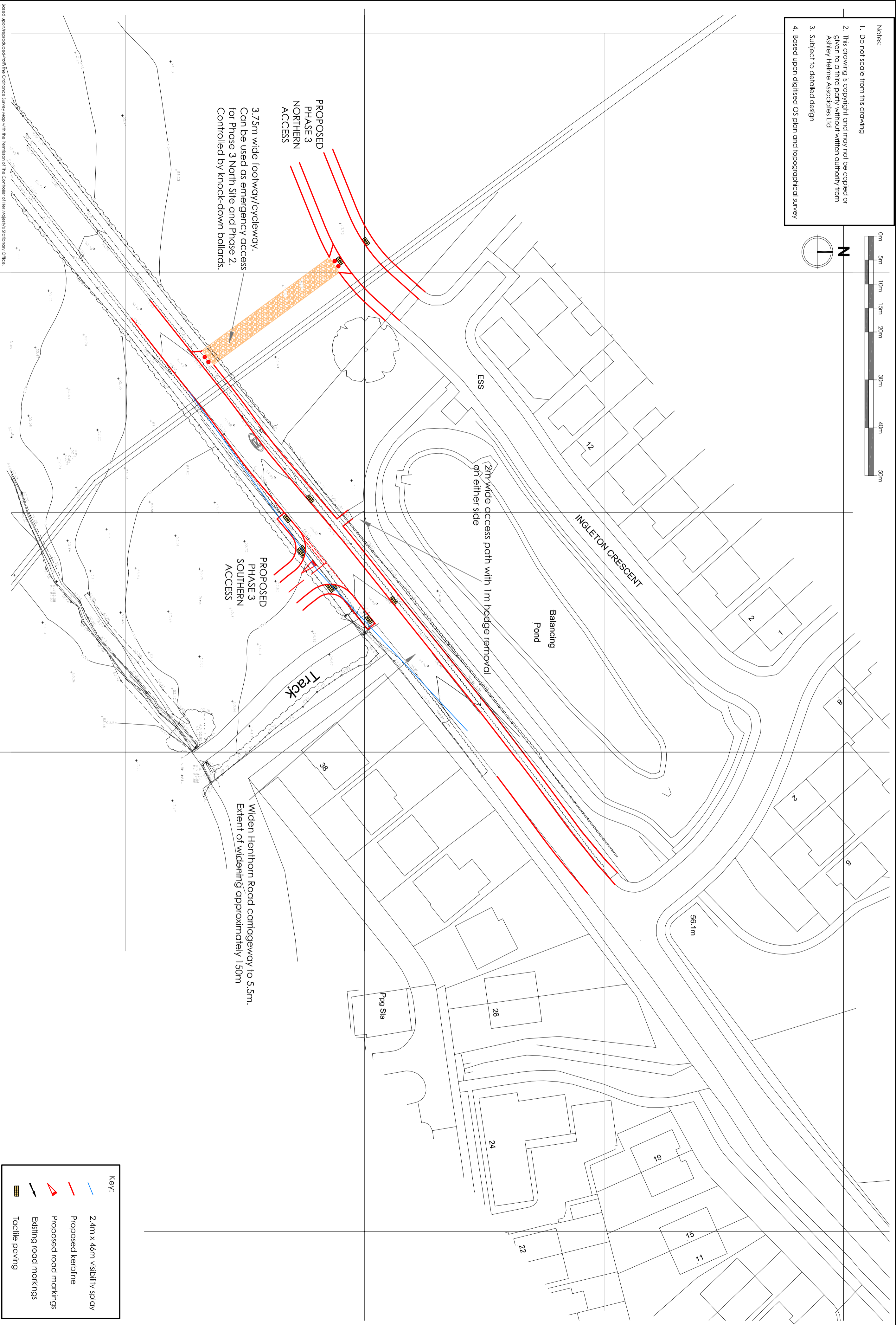
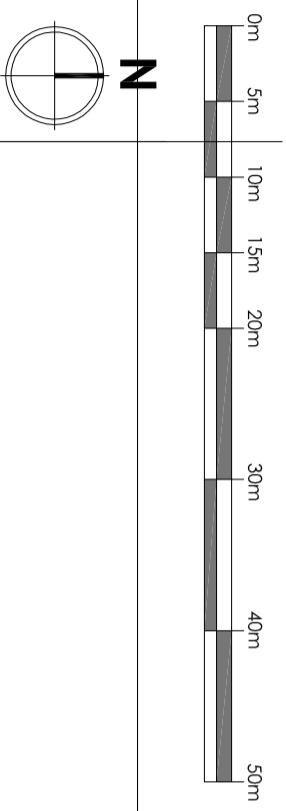

3.75m wide footway/cycleway.
Can be used as emergency access for Phase 3 North Site and Phase 2. Controlled by knock-down bollards.

2m wide access path with 1m hedge removal on either side

PROPOSED PHASE 3 SOUTHERN ACCESS

Track

Widen Henthorn Road carriageway to 5.5m. Extent of widening approximately 150m.

Key:	
	2.4m x 46m visibility splay
	Proposed kerfline
	Proposed road markings
	Existing road markings
	Tactile paving

Project
HENTHORN ROAD, CLITHEROE
 Client
GLADMAN DEVELOPMENTS

Title
PROPOSED ACCESS ARRANGEMENTS

Dwg No	Rev
1677/01	F
Date	Scale
NOVEMBER 2025	1:500@A2



Telephone 0161 972 0522
 Website www.ashleyhelme.co.uk
 Address 76 Wodway Road, Salford, Manchester, M33 7RE

Based upon digitised OS plan and topographical survey. All rights reserved. © Ashley Helme Associates Ltd. 76 Wodway Road, Salford, Manchester, M33 7RE. Licence No. AL00015126