

Stanton Andrews do not accept liability for any loss or degradation of information held in the drawing resulting from the translation from the original file format to any other file format or from the recipient's reading of it in any other programme or on an earlier version of the programme. Stanton Andrews accepts no liability for use of this drawing by parties other than the party for whom it was prepared or for purposes other than those for which it was prepared.

DWG issues - when this drawing is issued in DWG format it is an uncontrolled version and is provided to enable the recipient to prepare its own documents/drawings for which it is solely responsible. It is based on background information current at the time of issue. Stanton Andrews accepts no liability for any alterations to, additions to or discrepancies arising out of changes to such background information which occur after it has been issued by Stanton Andrews.

This drawing must be printed in colour. If this text is not RED the drawing must be reprinted.

Do not scale, use figured dimensions only. All dimensions to be checked on site. This drawing should be printed and read at the original size, as stated in title block. Stanton Andrews accept no responsibility for errors that occur as a result of reviewing this drawing at any other size. Stanton Andrews to be notified of any discrepancies before proceeding.

Drawing is to be read in conjunction with all relevant consultants and specialists drawings. 'As existing' drawings based on information provided by others - no measured survey of the property has been undertaken by the architect. This drawing is subject to copyright.

revision	date	note
A	jan 2026	issued for planning
B	feb 2026	Amended following LA input

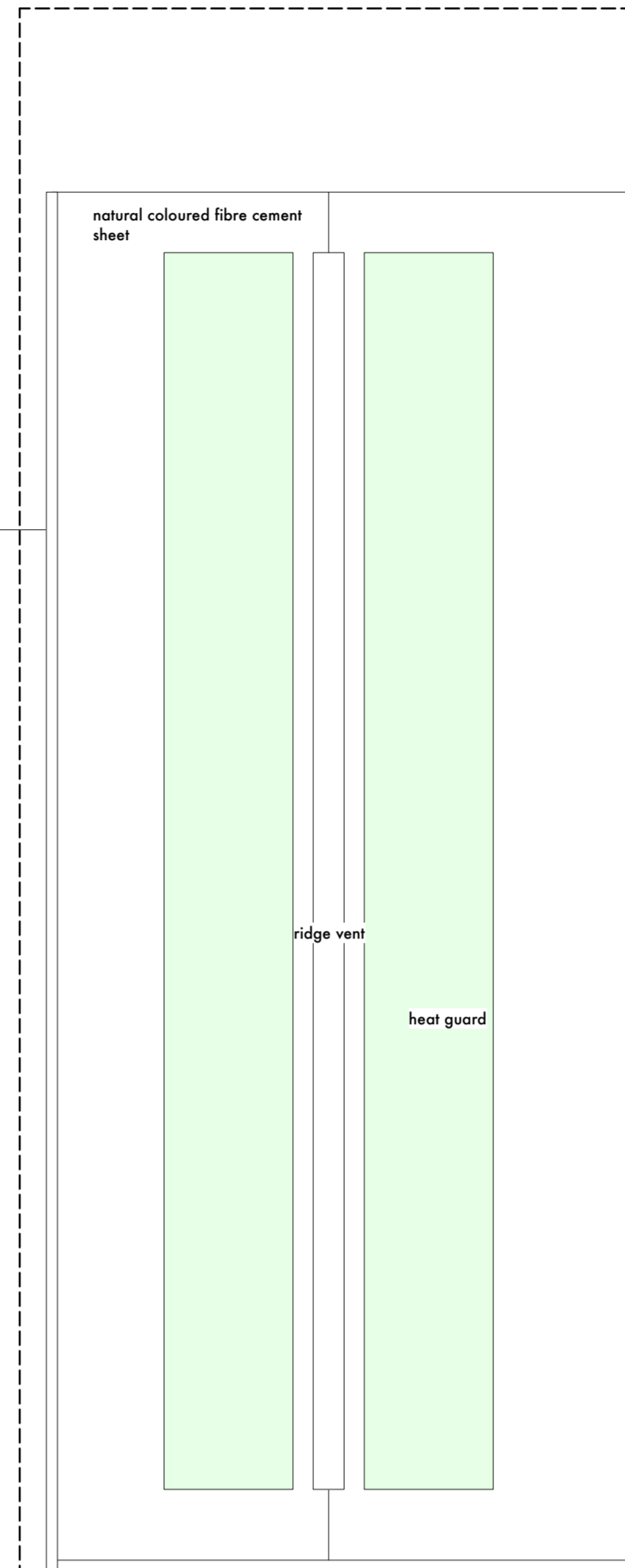
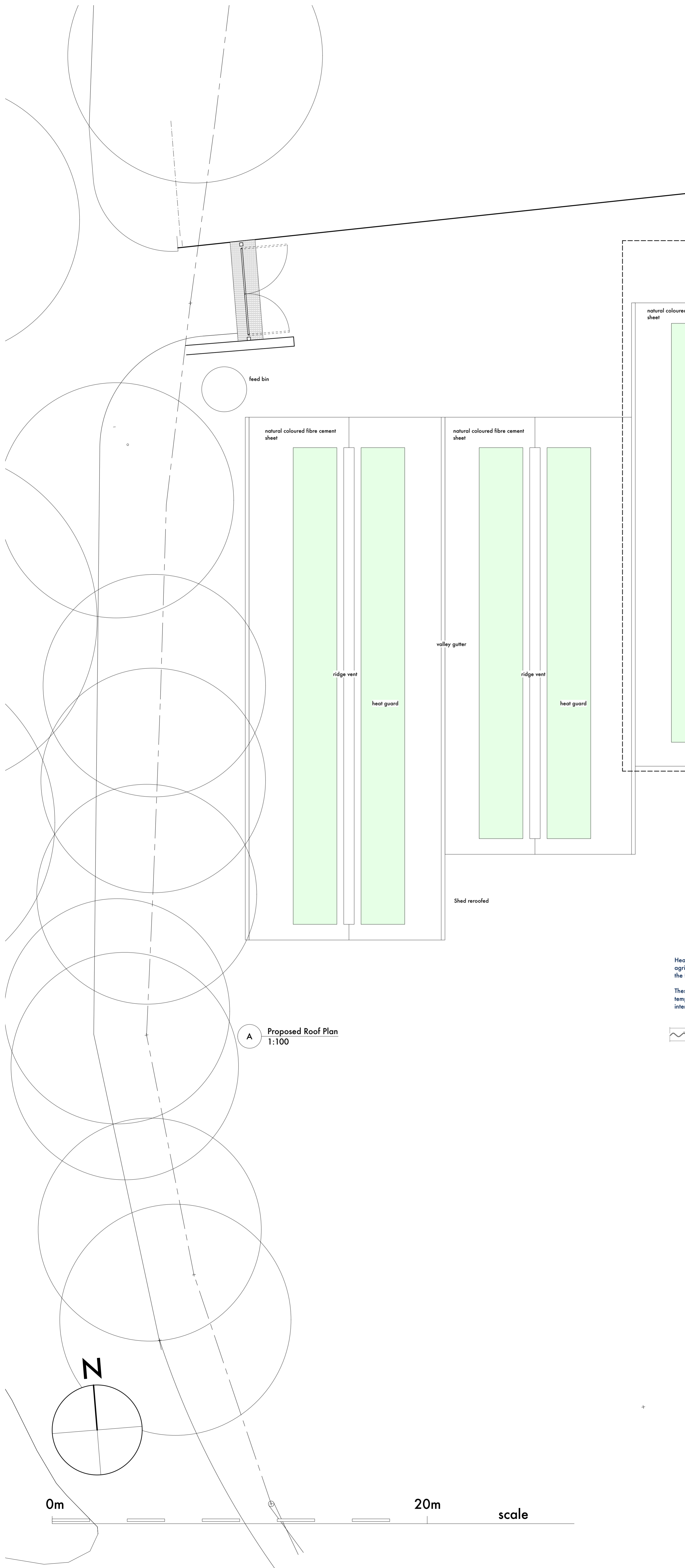

Second shed consented as part of approval 3/2005/0598 - not built

Heatguard Polycarbonate Roof Sheets offer an innovative and durable solution for agricultural roofs. The sheet reflective pigment repels harmful infrared rays from penetrating the farm building whilst allowing daylight to enter.

These features ensure that building brightness is maximised while maintaining a stable temperature at all times. Heatguard, available in a Big 6 profile, features a triple-wall interior providing stability and added insulation.

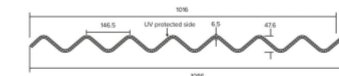

A Proposed Roof Plan 1:100

**SA** stanton andrews architects

44 york street clitheroe BB7 2DL  
t. 01200 444490 e. mail@stantonandrews.co.uk w. stantonandrews.co.uk



project  
Cow Ark Farm

project number  
06.04

drawing number

name  
Proposed Roof Plan

PL2

scale  
1 to 100 @ A1

date  
Jan 2026

stage  
planning

revision  
B

0m 20m scale