

Note:
 The survey is plotted on a plane local Grid. Orientation to National Grid.
 All levels relate to Ordnance Datum, achieved using the OS National GPS Network.

Survey Control Markers established for Mapping purposes only and should not be used for Construction without the written approval of Survey Operations Ltd.

Areas within bold, dashed line surveyed November 2025 added to Survey Operations drawing number 251231.

SURVEY STATIONS			
Name	Easting	Northing	Height
JD1	374739.25	440613.14	100.99
JD2	374760.18	440550.21	101.53
JD3	374765.01	440631.61	101.47
ML1	374605.01	440702.89	94.28
ML2	374620.11	440565.83	97.01
ML3	374641.58	440573.43	93.04
ML4	374633.06	440595.32	91.51
ML5	374787.75	440698.52	101.86
ML6	374742.92	440738.43	99.64



Smith Street, Skelmersdale, Lancs. WN8 8LN
 Tel: 01695 725662 Fax: 01695 51816
 Email: mail@survops.co.uk - www.survops.co.uk

Client
Appleshwaite Ltd

Drawing Title
**Topographical Survey of Land at:
 Land at Higher Standen School Field
 Clitheroe**

Scale(s)	1:500	Surveyor	ML
Date	NOV 25	Drawn	PM
Job Number	25K075	Checked	SO

Sheet Size & Drg Number & Revision
A1 25K075/001

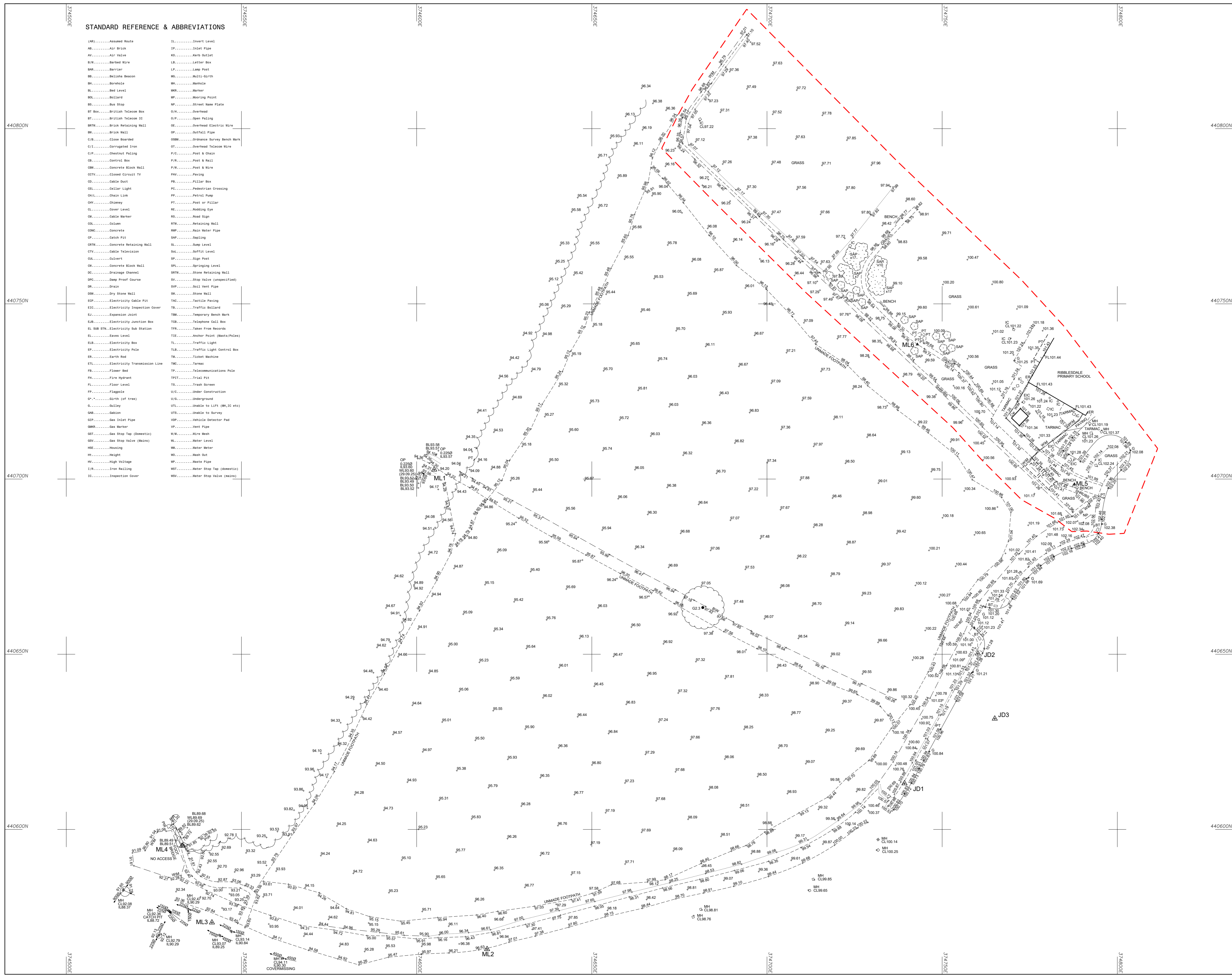

STANDARD REFERENCE & ABBREVIATIONS

- | | |
|--|------------------------------------|
| (AR).....Assumed Route | IL.....Invert Level |
| AB.....Air Brick | IP.....Inlet Pipe |
| AV.....Air Valve | KO.....Kerb Outlet |
| B/B.....Barbed Wire | LB.....Letter Box |
| BM.....Barrier | LP.....Lamp Post |
| BB.....Bellish Beacon | MB.....Multi-Birth |
| BK.....Borehole | MM.....Manhole |
| BL.....Bed Level | MM.....Marker |
| BO.....Bollard | MP.....Mooring Post |
| BS.....Bus Stop | NP.....Street Name Plate |
| BT Box.....British Telecom Box | OV.....Overpass |
| BT.....British Telecom IC | OP.....Open Paving |
| BRTM.....Brick Retaining Wall | OE.....Overhead Electric Wire |
| BW.....Brick Wall | OP.....Outfall Pipe |
| C/B.....Close Boarded | OSM.....Ordnance Survey Bench Mark |
| C/I.....Corrugated Iron | OT.....Overhead Telecom Wire |
| C/P.....Chestrut Paving | P/C.....Post & Chain |
| CB.....Control Box | P/B.....Post & Wall |
| CBM.....Concrete Block Wall | P/W.....Post & Wire |
| CCM.....Concrete Block Wall | P/W.....Paving |
| CCTV.....Closed Circuit TV | PB.....Pillar Box |
| CD.....Cable Duct | PC.....Pedestrian Crossing |
| CL.....Cellar Light | PP.....Petrol Pump |
| CLL.....Chain Link | PT.....Post or Pillar |
| CM.....Chimney | RE.....Revolving Eye |
| CL.....Cover Level | RS.....Road Sign |
| CM.....Cable Marker | R/W.....Retaining Wall |
| CO.....Cotsum | R/W.....Rain Water Pipe |
| COMC.....Concrete | SAP.....Sapping |
| CP.....Catch Pit | SL.....Sump Level |
| CRW.....Concrete Retaining Wall | SK.....Soffit Level |
| CTV.....Cable Television | SP.....Sign Post |
| DA.....Gully | SP.....Springing Level |
| DM.....Dry Stone Wall | SRM.....Stone Retaining Wall |
| ECM.....Electricity Cable Pit | SS.....Step (wide unconnected) |
| ESD.....Electricity Inspection Cover | SWP.....Soil Vent Pipe |
| EJ.....Expansion Joint | SW.....Stone Wall |
| EJB.....Electricity Junction Box | TAC.....Tactile Paving |
| EL Sub Stn.....Electricity Sub Station | TB.....Traffic Bollard |
| EL.....Eaves Level | TBM.....Temporary Bench Mark |
| ELB.....Electricity Box | TGB.....Telephone Gull Box |
| EP.....Electricity Pole | TIR.....Trench Bars |
| ER.....Earth Rod | TL.....Traffic Light (Start/Stop) |
| ETL.....Electricity Transmission Line | TL.....Traffic Light Control Box |
| FB.....Fiber Rod | TM.....Ticket Machine |
| FM.....Fire Man | TMC.....Tarmac |
| FL.....Floor Level | TP.....Telecommunications Pole |
| FP.....Flagpole | TPIT.....Trial Pit |
| G.....Girth (of tree) | U/C.....Under Construction |
| G.....Gully | UB.....Underground |
| GA.....Gable | UL.....Unable to Lift (MH, IC etc) |
| GIP.....Gas Inlet Pipe | UB.....Unable to Survey |
| GMR.....Gas Meter | VDP.....Vehicle Detector Pad |
| GS.....Gas Stop Tap (domestic) | VP.....Vent Pipe |
| GS.....Gas Stop Valve (main) | W/M.....Wire Mesh |
| HS.....Housing | WL.....Water Level |
| HT.....Height | WM.....Water Meter |
| HV.....High Voltage | WO.....Wash Out |
| I/M.....Iron Railing | WP.....Waste Pipe |
| IC.....Inspection Cover | WST.....Water Stop Tap (domestic) |
| | WV.....Water Stop Valve (main) |