

finished stone above doorset, main tramb

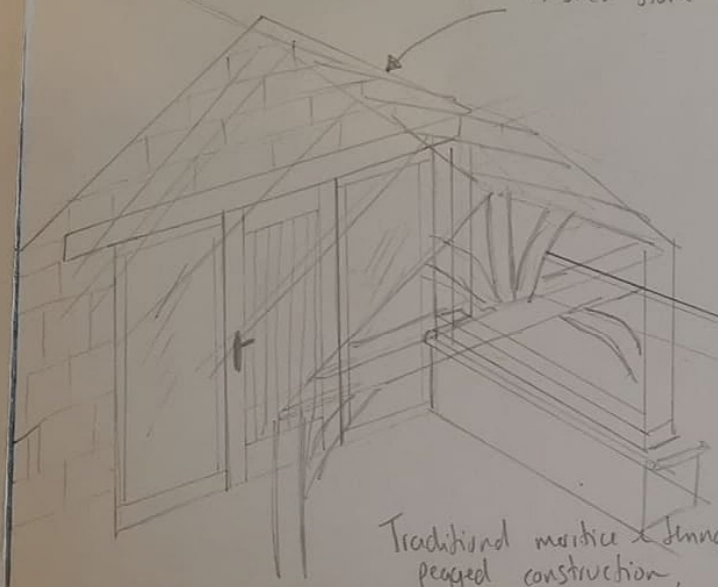

Hatched area of dead space
not vaulted on underside

Oak truss

Tongue and groove
boarding visible
from underside

Traditional mortice & tenon
pegged construction

6x6" oak posts
with intermediate
smaller posts

Roof over hang

Random stone 2ft
approx dwarf wall capped
with dressed/sandblasted
stone topper. Robert

Stop chamfer detail
throughout

