

# Tree Protection Plan

## Hand Dig Zone

Excavation within the area marked in orange as a 'hand dig zone' shall be carried out using hand-held tools only, taking care to minimise any root damage. There must be no mechanical excavation within the hand dig zone.

Any roots encountered during the hand dig shall be neatly pruned back to the edge of the excavation, making a clean cut with a sharp tool, such as handsaw or bypass secateurs, so that the wound area is as small as possible.

## No Dig Zone

There must be no excavation within the area marked as a 'no dig zone', other than for landscaping operations, which must be carried out using hand-held tools only, taking care not to damage or sever any roots >25mm in diameter (thumb-width).

## General Tree Protection Requirements

- The existing loose stone surface within the RPAs of trees T2 and T4 shall be retained during the construction works to serve as ground protection
- Oil, fuel, chemicals, cement or any other material with potential to cause damage to trees shall not be poured, mixed, washed or discharged within RPAs
- Soil levels within RPAs shall not be raised or lowered
- Services and drainage shall not be installed within the no dig zone, unless authorised in advance by the Local Planning Authority
- Fires shall not be lit within 10m of any tree crown or RPA

Tree Survey Schedule Summary			
ID	Species	Cat.	Recommendation
T1	Ash	C	Retain
T2	Sycamore	B	Retain
T3	Sycamore	B	Retain
T4	Sycamore	B	Retain
T5	Beech	B	Retain
T6	Cypress	C	Retain

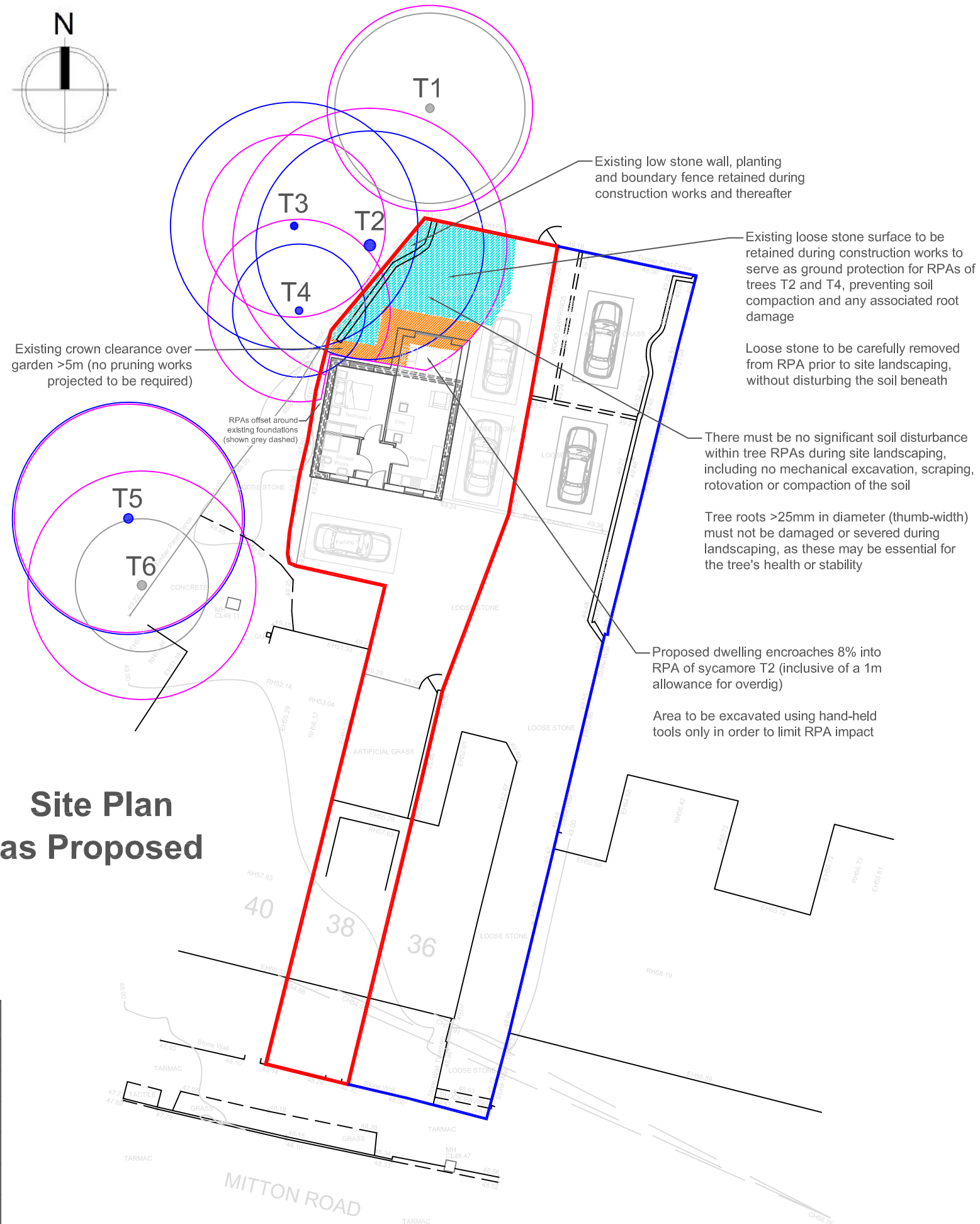

### BS5837 Tree retention categories:

- Category A High quality tree
- Category B Moderate quality tree
- Category C Low quality tree
- Category U Unsuitable for retention
- Root protection areas (RPAs)

### Tree protection measures:

- Hand dig zone
- No dig zone

**Site:**  
38 Mitton Road  
Whalley  
BB7 9RX

**Client:**  
Eddie Smith

**Date:** March 2026  
**Scale:** 1:500 at A3  
**Drawing:** LTC414-TPP  
**Drawn by:** JK



Halton Mill, Mill Lane, Halton, LA2 6ND  
info@lakelandtreeconsultancy.co.uk  
01524 874124