

DO NOT SCALE OFF THIS DRAWING

GENERAL NOTES

- THIS DRAWING TO READ IN CONJUNCTION WITH ALL RELEVANT STRUCTURAL AND ARCHITECTURAL DRAWINGS AND SPECIFICATIONS.
- ALL DIMENSIONS TO BE CHECKED ON SITE BY THE CONTRACTOR/ FABRICATOR PRIOR TO COMMENCEMENT OF WORKS.
- ALL DIMENSIONS ARE IN MILLIMETRES UNLESS STATED OTHERWISE.
- ALL WORKS TO BE CARRIED OUT IN STRICT ACCORDANCE WITH THE ENGINEER'S SPECIFICATIONS, RELEVANT BRITISH STANDARDS AND WHERE APPLICABLE LOCAL AUTHORITIES REQUIREMENTS.

**KEY**

- PROPOSED FOUL SEWER
- PROPOSED SW SEWER
- PROPOSED FOUL RISING MAIN
- PROPOSED SW RISING MAIN
- EXG. FOUL SEWER
- EXG. SW SEWER
- PRIVATE SW SEWER
- PRIVATE FOUL SEWER
- SEWER EASEMENTS

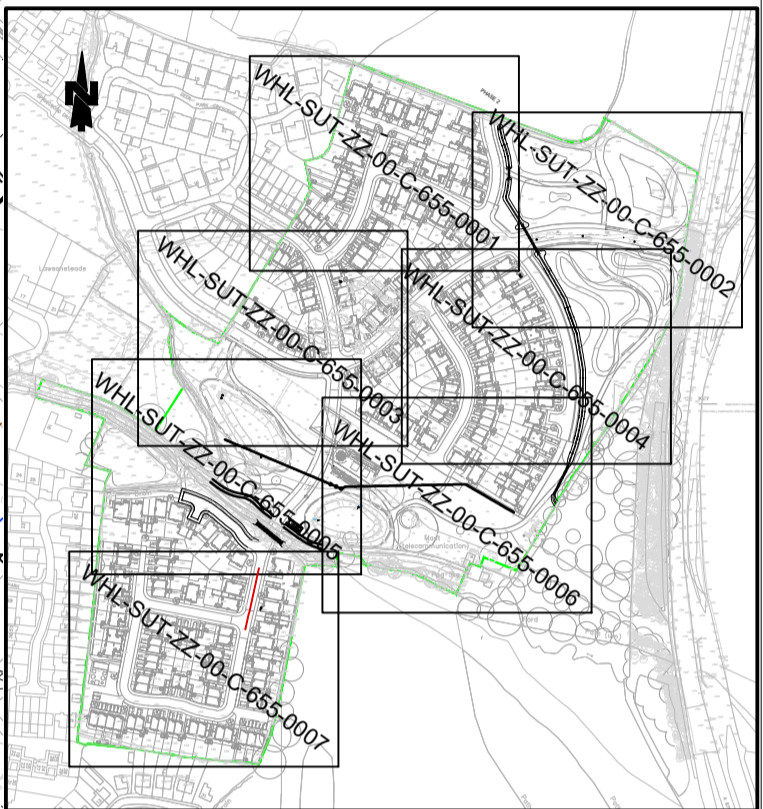

Rev	Description	Date	By	Chkd
W12	NETWORK 2 S20 TO S21 AMENDED	06.11.22	MG	SB
W11	NETWORK 2 S20 TO S23 AMENDED	28.11.22	MG	SB
W10	S18 CL AMENDED	22.11.22	MG	SB
W9	S19 TO S20 PIPE MATERIAL AMENDED	26.09.22	MG	SB
W8	FOUL RISING MAIN AMENDED	05.09.22	MG	SB
W7	F20 LOWERED ADJACENT PLOT 86	30.11.21	MG	SB
W6	AQUEDUCT CROSSING LOCATION AMENDED	07.09.21	MG	SB
W5	S13 NETWORK 1, S17 NETWORK 2 AMENDED	07.07.21	MG	SB
W4	DRAINAGE AMENDED DOWNSTREAM OF S13, F17	27.04.21	MG	SB
W3	F21 & F22 INVERT LEVELS AMENDED	27.04.21	MG	SB
W2	F21 & F22 INVERT LEVELS AMENDED	27.04.21	MG	SB
W1	CONSTRUCTION ISSUE	21.04.21	MG	SB
P5	AMENDED TO UIJ COMMENTS	15.01.21	MG	SB
P4	UPDATED TO LATEST DESIGN	26.11.20	MG	SB
P3	SW NETWORK 2 AMENDED	31.07.20	MG	SB
P2	COVER LEVELS AMENDED	26.02.20	MG	SB
P1	PRELIMINARY DRAWING	28.01.20	MG	SB

Drawing Status: **WORKING DRAWING**

Client: **LOVELL**

Project: **WHALLEY ROAD LANCASHIRE**

Drawing Title: **PROPOSED DRAINAGE LAYOUT SHEET 3 OF 7**

Date: <b>JAN 2020</b>	Drawn By: <b>MG</b>	Checked By: <b>SB</b>
Scale at A1: <b>1:250</b>	Project Number: <b>30626</b>	Revision: <b>W12</b>
Sheet Number: <b>WHL-SUT-ZZ-00-C-655-0003</b>		

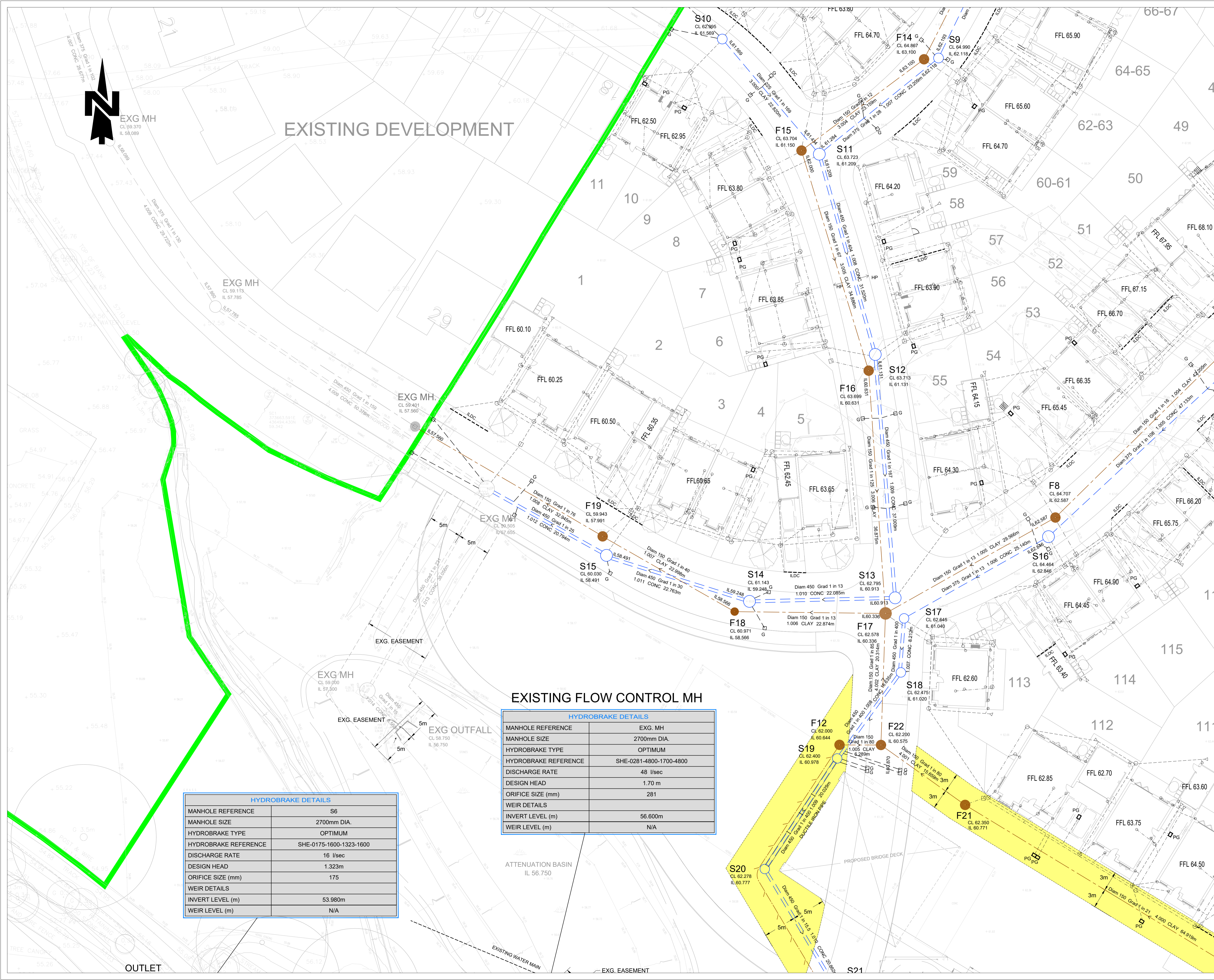

EXISTING DEVELOPMENT

**EXISTING FLOW CONTROL MH**

HYDROBRAKE DETAILS	
MANHOLE REFERENCE	EXG. MH
MANHOLE SIZE	2700mm DIA.
HYDROBRAKE TYPE	OPTIMUM
HYDROBRAKE REFERENCE	SHE-0281-4800-1700-4800
DISCHARGE RATE	48 l/sec
DESIGN HEAD	1.70 m
ORIFICE SIZE (mm)	281
WEIR DETAILS	
INVERT LEVEL (m)	56.600m
WEIR LEVEL (m)	N/A

HYDROBRAKE DETAILS	
MANHOLE REFERENCE	S6
MANHOLE SIZE	2700mm DIA.
HYDROBRAKE TYPE	OPTIMUM
HYDROBRAKE REFERENCE	SHE-0175-1600-1323-1600
DISCHARGE RATE	16 l/sec
DESIGN HEAD	1.323m
ORIFICE SIZE (mm)	175
WEIR DETAILS	
INVERT LEVEL (m)	53.980m
WEIR LEVEL (m)	N/A

ATTENUATION BASIN  
IL 56.750

OUTLET

EXG. EASEMENT