

NOTES

1. See drawing 001 for all general notes.
2. To be read in conjunction with all drawings listed on drawing 001

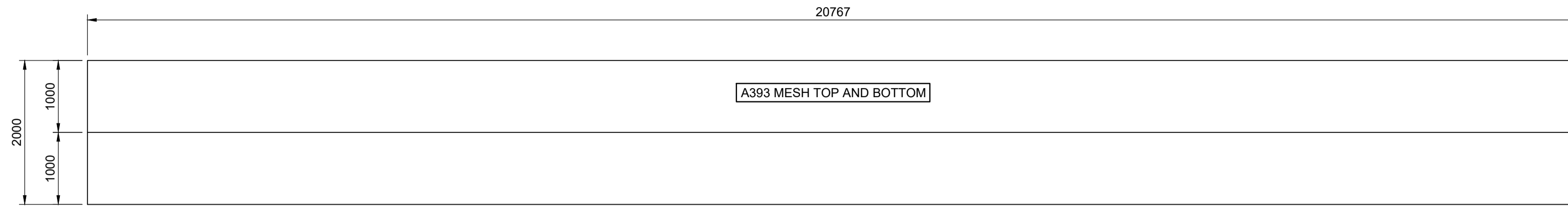

Plan on Rolling Block (2 No Required)
Scale 1:50

VRS FOUNDATION & ROLLING BLOCK:

STRUCTURAL CONCRETE SPECIFICATION FOR DESIGNED CONCRETE:

- A. TO CONFORM WITH BS EN 206-1 AND BS 8500-2
- B. COMPRESSIVE STRENGTH: C32/40
- C. MAXIMUM W/C RATIO: 0.40
- D. MINIMUM CEMENT CONTENT: 380kg/m³
- E. DC-CLASS: N/A
- F. CEMENT OR COMBINATION: IIIB, IVB-P, IVB-Q, IVB-V
- G. TARGET DENSITY CLASS: N/A
- H. MAXIMUM AGGREGATE SIZE: 20mm
- I. CHLORIDE CLASS: CL 0.40
- J. CONSISTENCE CLASS: TO BE SPECIFIED BY THE FABRICATOR
- K. NOMINAL COVER TO BE 60mm
- L. EXPOSURE CLASS: XD3

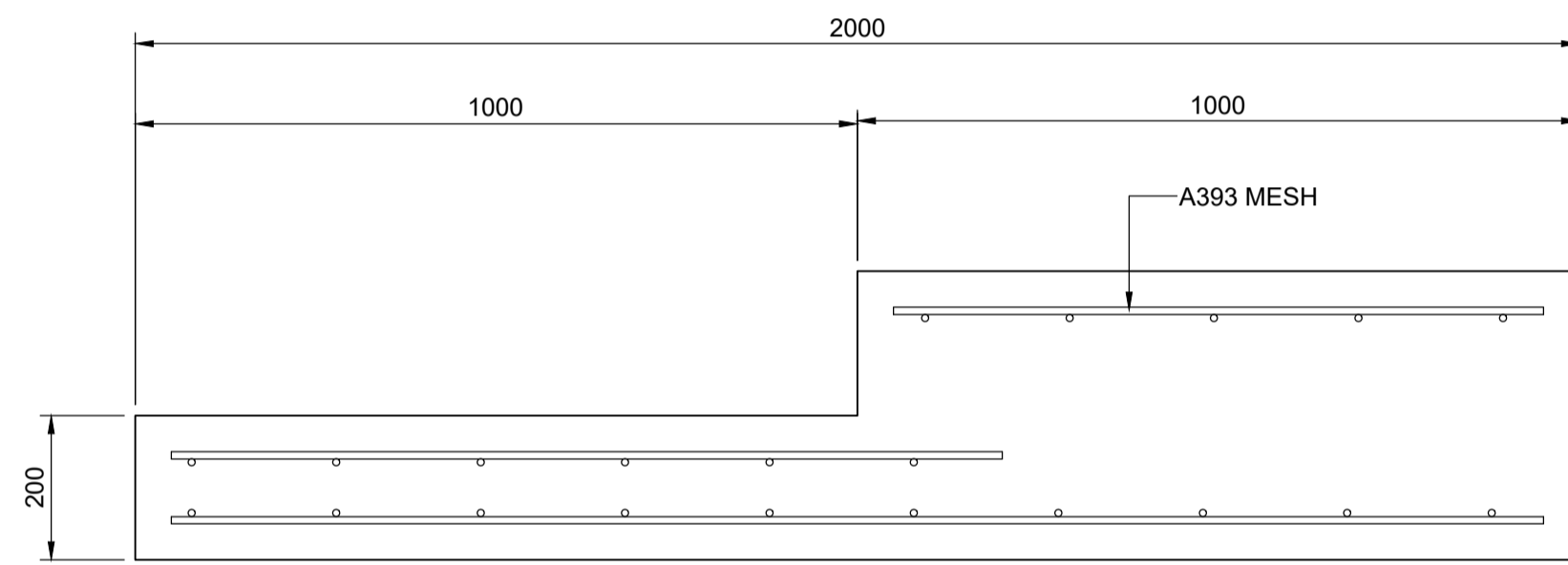

Typical Section Through Rolling Block
Scale 1:10

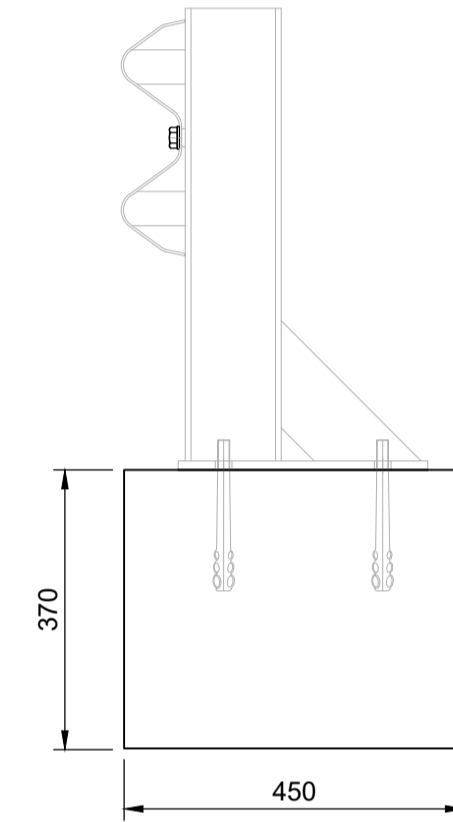

Typical Section VRS Foundation
Scale 1:10

NOTE:
EXACT EXTENTS AND DETAILS OF VRS FOUNDATION TO BE CONFIRMED FOLLOWING SELECTION OF SYSTEM

APPROVAL

REV	DESCRIPTION	BY	CHK	APP	DATE
B01	DETAILED DESIGN	KB	NC	JL	25.06.21

REVISION TABLE

HBPW
CONSULTING ENGINEERS

43 BRIDGEGATE
RETFORD
NOTTINGHAMSHIRE
DN22 7UX
TEL: (01777) 869896
www.hbpw.co.uk

CLIENT:
LOVELLS

CONTRACTOR:
LOVELLS

HBPW PROJECT NUMBER:
SL07119

PROJECT:
Whalley Aquaduct Crossing

DRAWING:
Miscellaneous

PROJECT ENGINEER: J.Livesey	DRAWN: W.Withers
CHECKED: N.Chia	APPROVED: J.Livesey
DATE: 25.06.2021	SCALE: As Shown
SIZE: A1	SUITABILITY: -
REVISION: B01	

DOCUMENT REFERENCE NUMBER:
7119-HBPW-DRG-ECV-0104

