

OUTFALL LOCATION PLAN @ 1:200

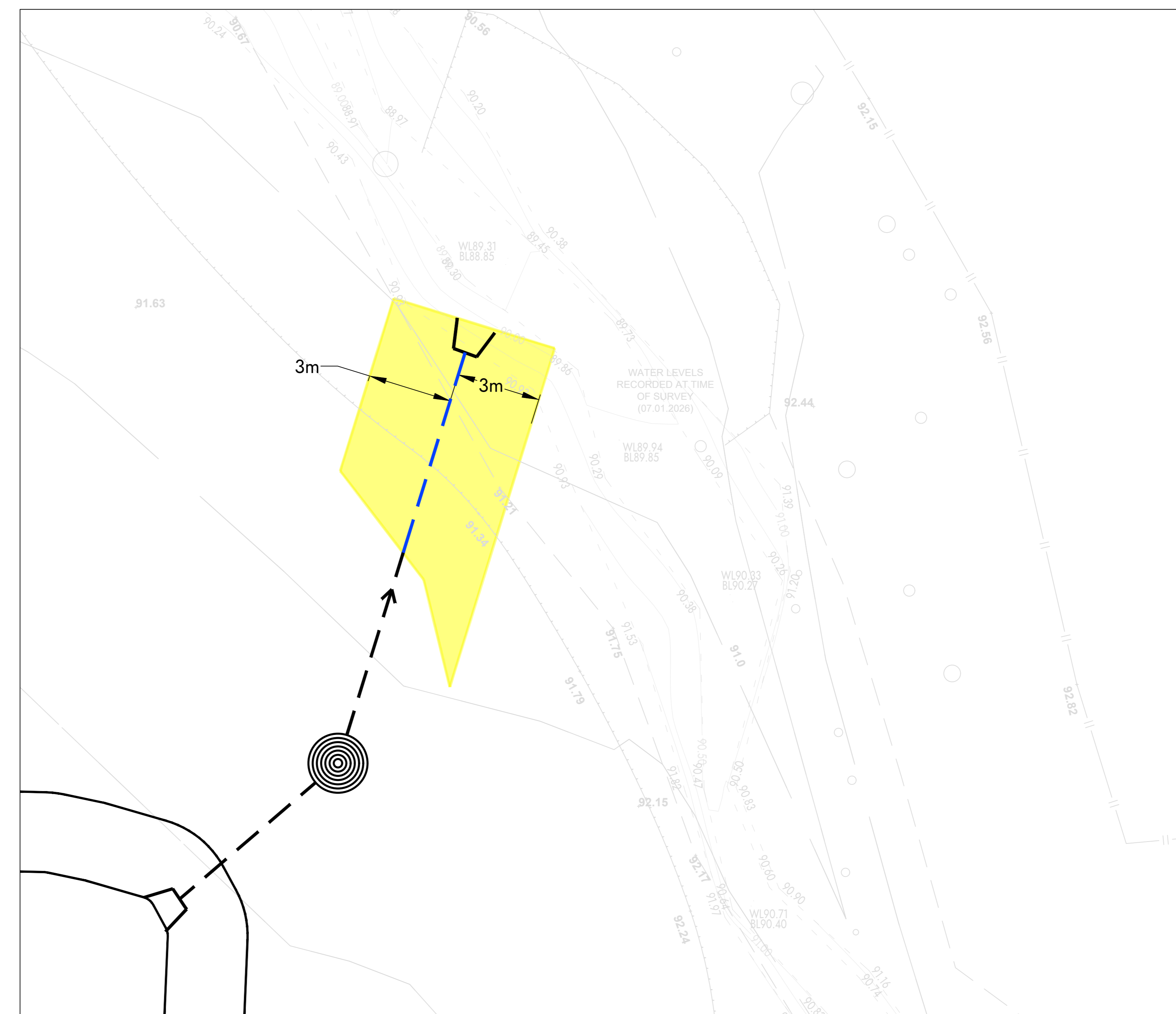

OUTFALL EASEMENT PLAN @ 1:100

NOTES:

- THIS DRAWING IS TO BE READ IN CONJUNCTION WITH ALL OTHER RELEVANT ENGINEERS, ARCHITECTS AND SPECIALIST DESIGN DRAWINGS AND DETAILS.
- ALL DIMENSIONS ARE IN METRES UNLESS NOTED OTHERWISE. ALL LEVELS ARE IN METRES ABOVE ORDNANCE DATUM UNLESS NOTED OTHERWISE.
- ANY DISCREPANCIES NOTED ON SITE ARE TO BE REPORTED TO THE ENGINEER IMMEDIATELY.
- LOCATION AND LEVELS OF EXISTING PUBLIC SEWERS BASED ON WATER AUTHORITY SEWER RECORDS. SEWERS TO BE FULLY SURVEYED, ALL LOCATIONS TO BE CONFIRMED.
- SETTING OUT SHALL BE UNDERTAKEN USING ONLY THE INFORMATION GIVEN.
- ALL SEWERS SHALL BE CONSTRUCTED IN ACCORDANCE WITH THE DESIGN AND CONSTRUCTION GUIDANCE AND WHERE APPLICABLE UNITED UTILITIES DETAILS.
- THE MINIMUM GRAVITY PIPE DIAMETER UNDER ADOPTABLE HIGHWAYS SHALL BE 150mm.
- IT IS THE RESPONSIBILITY OF THE CONTRACTOR TO VERIFY ALL INFORMATION GIVEN WITH REGARDS TO EXISTING SERVICES AND DRAINAGE CONNECTIONS ETC. PRIOR TO COMMENCING THE WORKS. THE CONTRACTOR SHALL ADHERE TO THE CDM REGULATIONS AT ALL TIMES.
- EXISTING FLOWS IN WATERCOURSES, SEWERS AND LAND DRAINS SHALL BE MAINTAINED AT ALL TIMES.
- ALL MATERIALS TO BEAR THE RELEVANT B.S. KITEMARK AND COMPLY FULLY WITH THE SPECIFICATIONS. ALL CONCRETE & CONCRETE PRODUCTS MUST USE SULPHATE RESISTANT CEMENT UNLESS THE SITE INVESTIGATION REPORT PROVES THAT SULPHATE ATTACK FROM SOILS AND GROUNDWATER WILL NOT OCCUR TO WITHSTAND A CLASS.
- ALL OPENING NOTICES ETC. AS REQUIRED UNDER HIGHWAYS ACTS ETC. ARE TO BE OBTAINED PRIOR TO COMMENCEMENT OF WORKS. ALL WORKS ARE TO BE INSPECTED BY L.A., NHBC OR THE NETWORK OPERATOR AS APPLICABLE.
- WHERE "ULTRA RIB" UPVC PIPES (OR SIMILAR APPROVED) ARE USED IN ADOPTABLE DRAINAGE THEY SHALL STILL BE HANDLED AND LAID IN ACCORDANCE WITH THE SPECIFICATION AND GUIDANCE ISSUED BY THE HIGH-PERFORMANCE PIPE ASSOCIATION.
- A CLASS 5 BED AND SURROUND MUST BE USED FOR SUCH PIPES. TRENCH BACKFILL IN HIGHWAYS TO WITHIN 1m OF HIGHWAY SHALL AS DIRECTED BY THE HIGHWAY AUTHORITY BE A SUITABLE GRANULAR MATERIAL ALL IN ACCORDANCE WITH SEWERS FOR ADOPTION CL. 4.3.4.
- DOMESTIC DRAINAGE SHALL BE TO BUILDING REGULATIONS APPROVED DOCUMENT H. 100mm U.P.V.C. PIPES LAID TO THE FOLLOWING MINIMUM FALLS UNLESS OTHERWISE SHOWN.

	FOUL	S.W.
HEAD RUN	1 IN 40	1 IN 60
ELSEWHERE	1 IN 80	1 IN 100

- ALL LATERAL CONNECTIONS FROM THE PRIVATE NETWORK TO BE 150mm U.P.V.C. PIPES UNLESS STATED OTHERWISE.
- ALL GULLY CONNECTIONS TO BE 150mm VITRIFIED UPVC UNLESS NOTED OTHERWISE.
- MINIMUM COVER TO DRAINAGE SOFFIT LEVEL:
LANDSCAPING 0.600m
TRAFFICKED AREAS 0.900m
HIGHWAYS 1.200m
- CLASS 'S' BEDDING AND SURROUND TO BE USED WHERE MINIMUM COVER IS ACHIEVED.
- WHERE MINIMUM COVER IS NOT ACHIEVED CLASS 'Z' BEDDING AND SURROUND (CONCRETE ENCASEMENT) IS TO BE USED.
- ANY DAMAGE TO THE EXISTING SEWER NETWORK BECAUSE OF THE DEVELOPMENT SITES ACTIVITIES WILL NEED TO BE RECTIFIED AT THE DEVELOPERS EXPENSE.

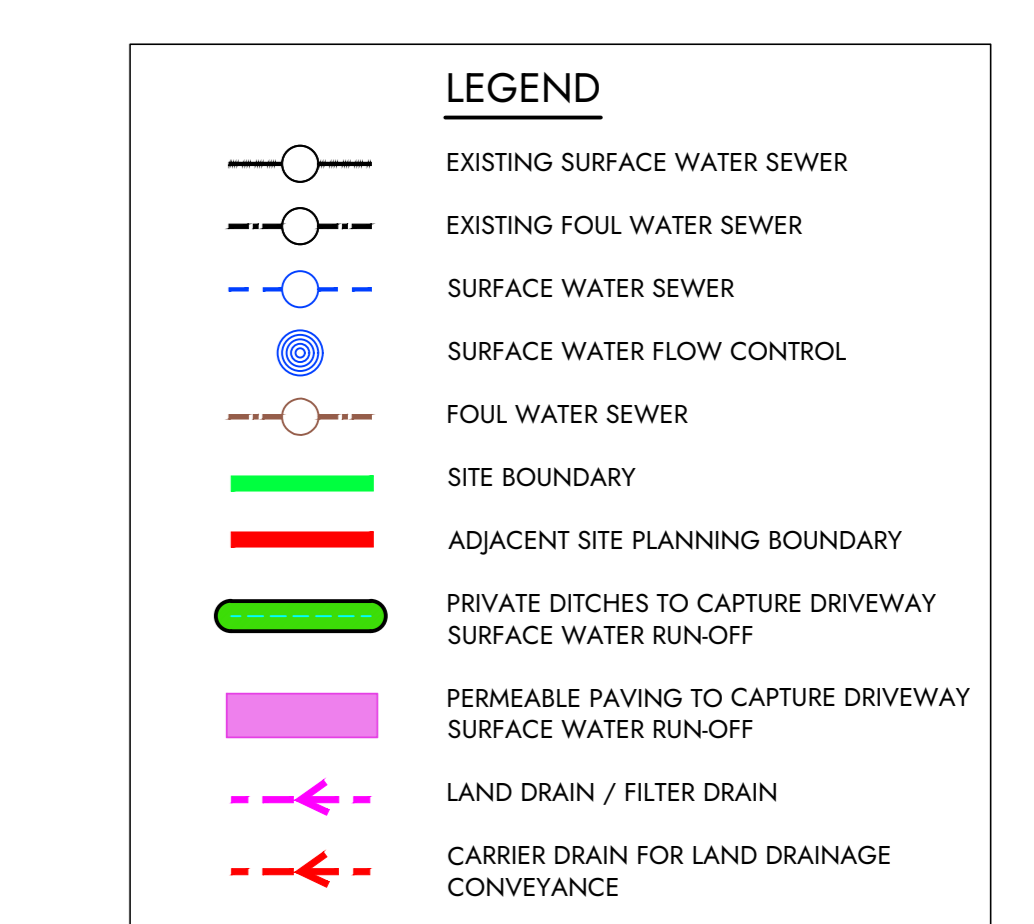

STRATEGY DRAWING TO SHOW PROPOSED OUTFALL LOCATIONS, DISCHARGE RATES AND GENERAL AREAS OF ATTENUATION FOR PLANNING PURPOSES ONLY; ALL DETAILS SUBJECT TO DETAILED DESIGN/ S104 ADOPTION PROCESSES AND THEREFORE SUBJECT TO CHANGE

PO3	07.04.26	KF	OUTFALL LOCATION AMENDED
PO2	02.04.26	NH	PLANNING BOUNDARY INDICATED
PO1	31.03.26	KF	FIRST ISSUE
Rev	Date	By	Description

SHAPE ENGINEERING
 Liverpool Innovation Park | Edge Lane | Liverpool | L17 9YQ
 T: 0151 305 0700 www.shapeengineering.co.uk

Client: MORRIS HOMES
 Project: Highmoor Farm, Clitheroe
 Title: Surface Water Outfall Details

Drawn By	Scale	Project No.
KF	A3 SHOWN	2936
Sheet No.	Revision	PO3
2936-SCE-00-00-DR-C-0080		

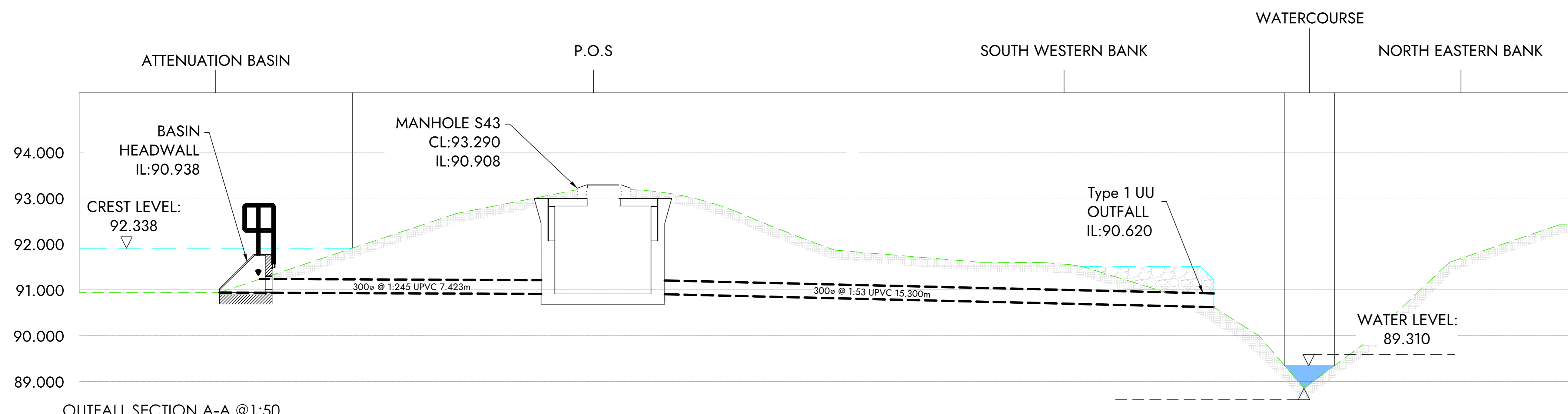

OUTFALL SECTION A-A @ 1:50

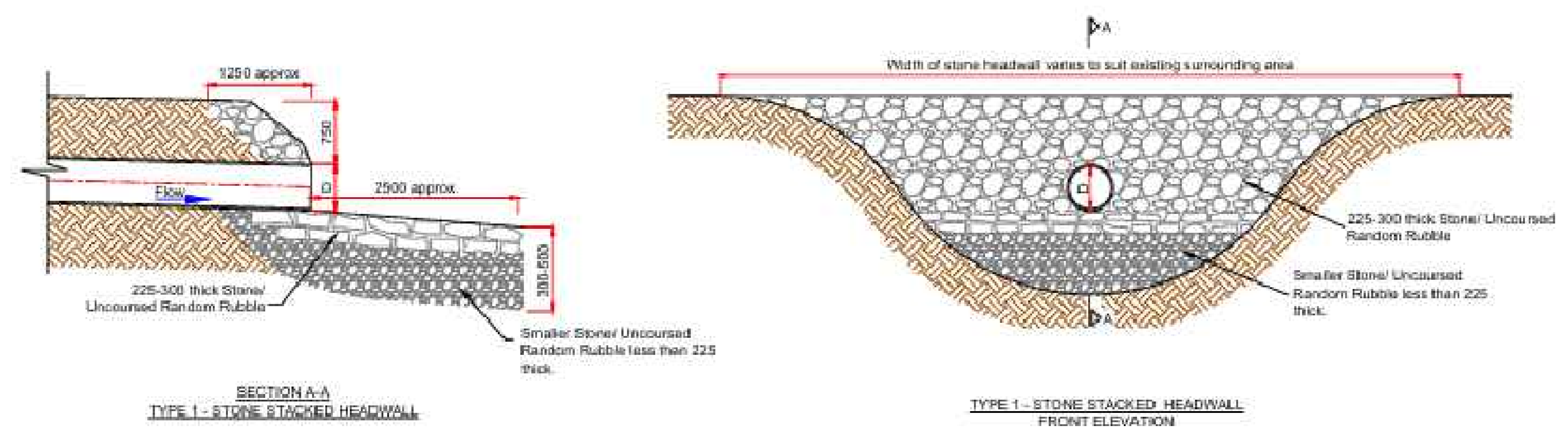

TYPICAL OUTFALL HEADWALL DETAILS (UU TYPICAL TYPE 1 HEADWALL DETAIL)