

GENERAL NOTES

GENERAL
ALL DIMENSIONS ARE TO BE CHECKED ON SITE PRIOR TO THE COMMENCEMENT OF WORKS. ANY MODIFICATIONS CONSIDERED AN IMPROVEMENT BY THE CONTRACTOR ARE TO BE SUBMITTED TO THE LOCAL AUTHORITY AND COMPLY WITH ANY APPROVAL NECESSARY. ALL WORK TO COMPLY WITH CURRENT BUILDING REGULATIONS AND GOOD BUILDING PRACTICE. IF THE CONTRACTOR WISHES TO USE ANY ALTERNATIVE MATERIALS TO THOSE SPECIFIED, THEY MUST BE SUBMITTED TO THE BUILDING CONTROL OFFICER AND PLANNING OFFICER FOR APPROVAL. NO WORK CARRIED OUT UNDER THIS SPECIFICATION WILL BE VALID UNLESS FULL PLANNING / BUILDING REGULATION PERMISSIONS HAVE BEEN APPROVED.

DRAWINGS
THIS BRIEF SPECIFICATION IS TO BE READ IN CONJUNCTION WITH THE RELEVANT DRAWINGS AND HAS BEEN PREPARED TO OBTAIN BUILDING REGULATION PASSING OF PLANS ONLY.

ATTENTION SHOULD BE PAID TO SECTION/PLANS AND ANNOTATION. WHILST GREAT EFFORT HAS BEEN TAKEN TO ENSURE THE DESIGN AND DIMENSIONS GIVEN IN THIS DOCUMENTATION ARE CORRECT, DISCREPANCIES MAY OCCUR. ANY SUCH DISCREPANCIES MUST BE REPORTED TO THE ARCHITECT FOR AMENDMENT. ALL DIMENSIONS TO BE CHECKED ON SITE AND NOT SCALED FROM DRAWINGS.

PRIOR PERMISSION MUST BE SOUGHT BEFORE ANY COPIES OF DOCUMENTATION ARE MADE.

STRUCTURAL NOTES
ALL DRAWINGS AND SPECIFICATION TO BE READ IN CONJUNCTION WITH STRUCTURAL ENGINEERS DESIGN AND DETAILS. CONTRACTOR TO ENSURE THAT NO ELEMENTS OF EXISTING STRUCTURE TO BE REMOVED ARE RELIANT UPON THE SAME FOR LOAD BEARING SUPPORT.

TIMBER TREATMENT
ALL SOFTWOOD TIMBERS TO BE ADEQUATELY TREATED TO PREVENT INFESTATION BY THE HOUSE LONGHORN BEETLE IN ACCORDANCE WITH CURRENT BUILDING REGULATIONS. ALL STRUCTURAL TIMBERS, EXTERNAL FRAMES, WINDOW & SOFTWOOD CLADDING SHALL BE TREATED AGAINST FUNGAL ATTACK. ALL STRUCTURAL TIMBER TO BE MARKED DRY OR KD AND TO HAVE STRESS GRADE MARK.

REGULATIONS
ALL WORK IS TO COMPLY WITH THE RELEVANT BUILDING REGULATIONS AND ALL STATUTORY NOTICES ARE TO BE GIVEN TO THE BUILDING CONTROL DEPARTMENT AT THE LOCAL AUTHORITY AT THE APPROPRIATE STAGES. ALL CONTRACTORS ARE TO VISIT SITE TO ACQUAINT THEMSELVES WITH THE LAYOUT AND ACCESS TO THE SITE PRIOR TO TENDERING. IF AN APPROVED INSPECTOR IS USED THEN THE AI MUST NOTIFY THE LOCAL AUTHORITY THAT THE BUILDING REGULATIONS WILL BE CARRIED OUT UNDER THE INITIAL NOTICE PROCEDURE.

HEALTH AND SAFETY
CONTRACTOR, SUB-CONTRACTORS ETC. TO COMPLY WITH HEALTH AND SAFETY REGULATIONS DURING EXECUTION OF THE WORKS. LOCATE EXISTING SERVICES BEFORE WORKS COMMENCE. THE USE OF CAT IS ADVISABLE. TAKE ALL NECESSARY PRECAUTIONS WHEN CARRYING OUT ANY DEMOLITION WORKS, FORMING NEW OPENINGS, EXCAVATIONS AND WORKING AT ROOF OR HIGH LEVEL. FOR ALTERATION WORK REQUIRING NEW OPENINGS IN WALLS OR THE REMOVAL OF EXISTING WALLS, THE CONTRACTOR IS TO FOLLOW THE GUIDANCE IN THE BUILDING RESEARCH ESTABLISHMENT 'GOOD BUILDING GUIDES' 15 AND 20. PROVIDING TEMPORARY SUPPORT DURING WORK ON OPENINGS IN EXTERNAL WALLS AND REMOVING INTERNAL LOAD-BEARING WALLS IN OLDER DWELLINGS. ANY LIVE MAINS ELECTRICAL CABLES WITHIN WORKING DISTANCE TO BE SHEATHED / PROTECTED. PLEASE NOTE THAT ALL THE MATERIALS SPECIFIED AND THE CONSTRUCTION DETAILS SHOWN ARE NOT TO BE CHANGED WITHOUT THE FULL KNOWLEDGE AND PRIOR APPROVAL OF THE AGENT AS ANY CHANGES MAY HAVE A DETRIMENTAL EFFECT ON THE DESIGNED/REQUIRED CARBON EMISSIONS OF THE STRUCTURE AS DESIGNED.

- DO NOT SCALE OFF THIS DRAWING.
- ANY DISCREPANCIES ARE TO BE REPORTED IMMEDIATELY TO THE CLIENT/ARCHITECT.
- THIS DRAWING IS FOR BUILDING REGULATIONS APPROVAL AND CONSTRUCTION PURPOSES.
- ALL DIMENSIONS MUST BE CHECKED ON SITE PRIOR TO WORKS COMMENCING. VARIATIONS IN SQUARENESS, DEPTH OR PLASTER ETC. MUST BE CHECKED FOR. WHERE NEW WALLS ARE SHOWN AS ALIGNED WITH EXISTING WALLS, THIS MUST BE CHECKED BY THE PHYSICAL REMOVAL OF BRICKWORK AND OR PLASTER TO ESTABLISH THE ACTUAL POSITION OF THE WALL BEING ATTACHED TO.
- ALL PLANS ARE TO BE READ IN CONJUNCTION WITH STRUCTURAL ENGINEERS CALCULATION SHEETS. CONTRACTOR TO ENSURE ALL STRUCTURAL MEMBERS ARE AS SPECIFIED. NO VARIATION ALLOWED UNLESS AGREED BEFOREHAND WITH THE BCO OR STRUCTURAL ENGINEER. CONTRACTOR TO THOROUGHLY READ PLANS & CALCULATIONS BEFORE COMMENCEMENT TO ENSURE THOROUGH UNDERSTANDING OF ALL ASPECTS OF THE PROPOSALS.
- ALL WORK TO COMPLY WITH BS8000. ALL CONSTRUCTION TO COMPLY WITH BUILDING REGULATIONS 2000, SUBSEQUENT AMENDMENTS, AND APPROPRIATE BRITISH STANDARDS.

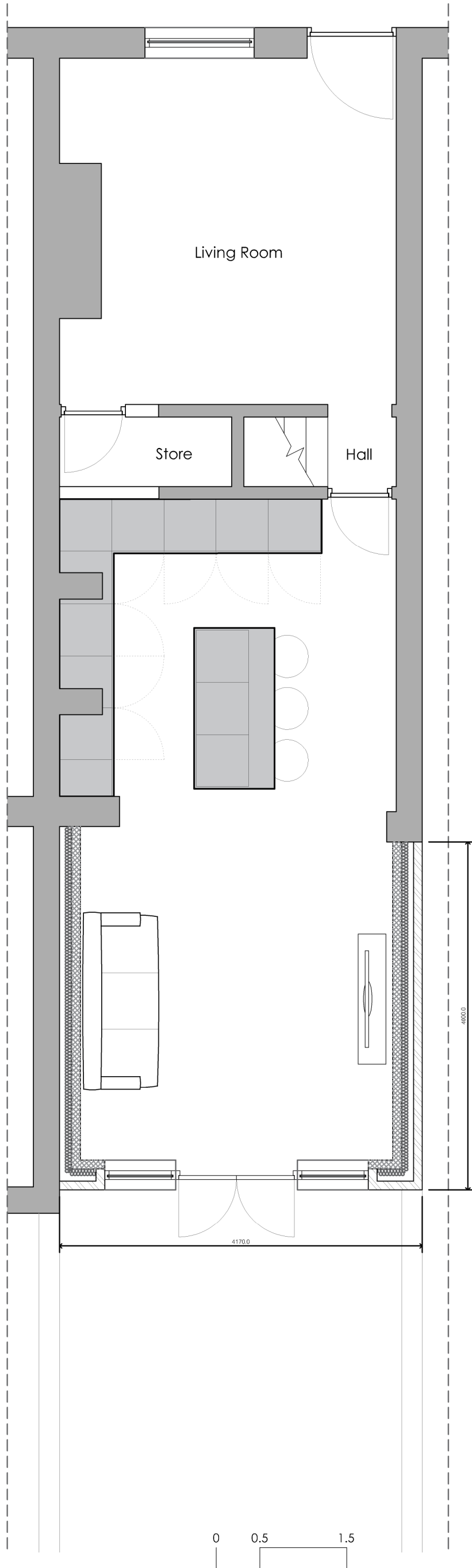

C - Extension line amended.
B - Extension line amended.
A - dimensions added following comments from LA.

rev date/ints

project

23 Jubilee Street

location

Simonstone, BB12 7PR

client

Mr Hunt

drawing title

Proposed Ground Floor Plan

dwg purpose

For Planning Application Purposes

scale 1:50

drawn CB

@ sheet size A3

rev date 10.02.25

1152

(20)001

C

job number

drawing number

revision

