

# Proposed Location Plan

4 Poplar Way, Clitheroe, BB79ZN - Location Plan



0 50  
Metres



# Proposed Site Plan

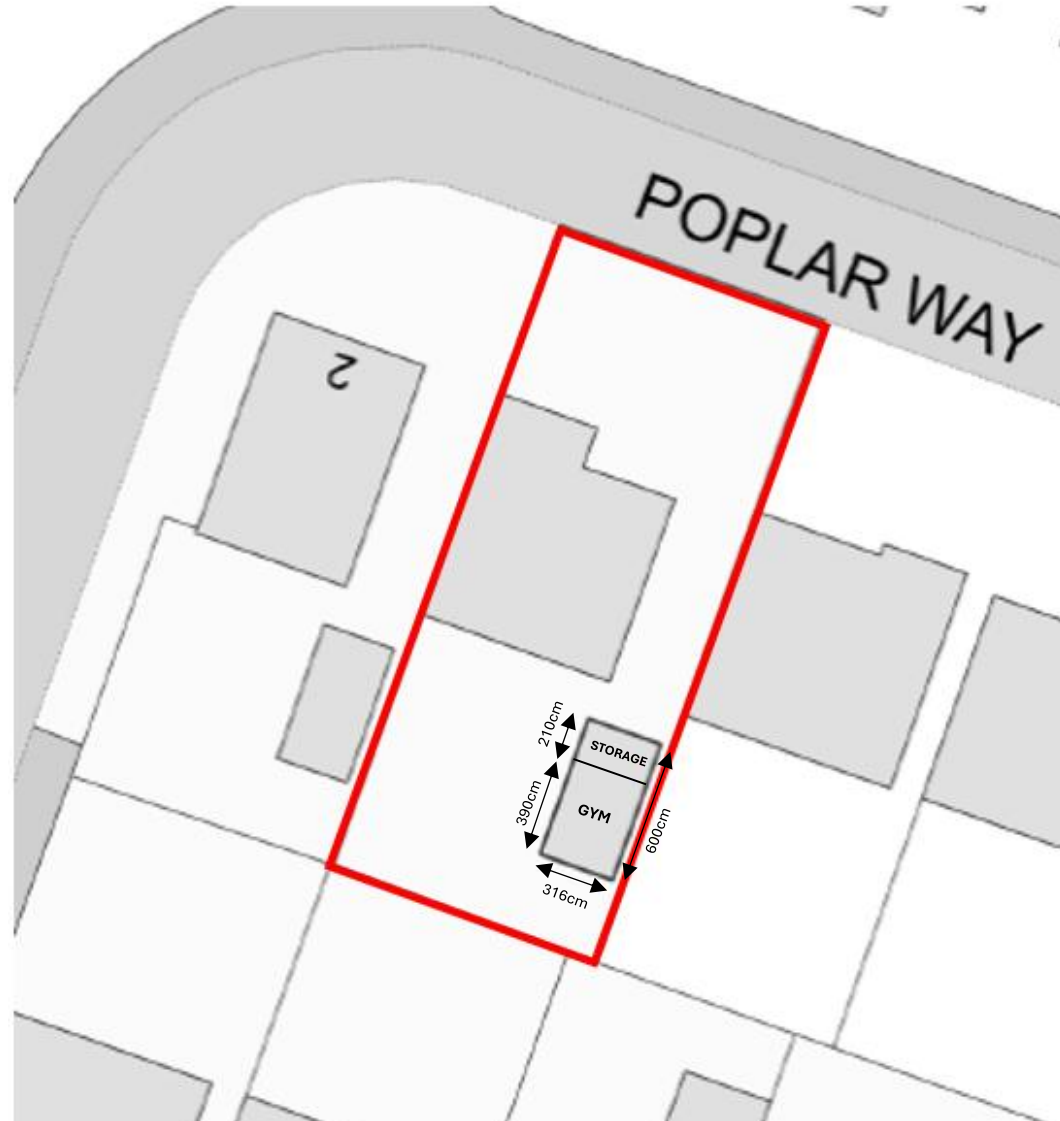

0 20  
Metres

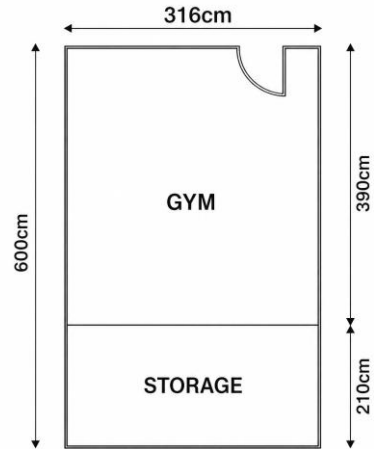

<b>Project</b> Garage conversion to 4 Poplar Way, Barrow, Clitheroe, BB79ZN	<b>Drawing title:</b> Existing and proposed garage conversion plans	<b>Scale:</b> 1:100 @ A4
Thomas Wootton	Drawing number: 1c	Date: 29.04.2026