

This drawing is to be read in conjunction with all relevant Architect, consultants' and specialists' drawings and specifications. The Architect is to be notified of any discrepancies before proceeding. Do not scale from this drawing. All dimensions and levels are to be checked on site. This drawing is subject to copyright. All work carried out before Planning and Building Permission has been granted is at the contractor/clients risk.
 Note: proposed drawing based on OS dwg information. All illustrated dimensions are approximate and all site dimensions are to be checked on site and subject to site survey.

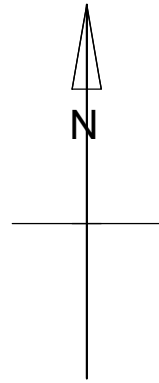

SURVEY STATIONS			
Name	Easting	Northing	Height
T1	373119.938	441201.940	60.999
BS1	373082.439	441235.827	61.307
T1A	373113.321	441196.547	60.829
T2A	373096.822	441183.431	61.579

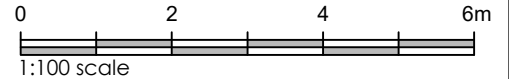
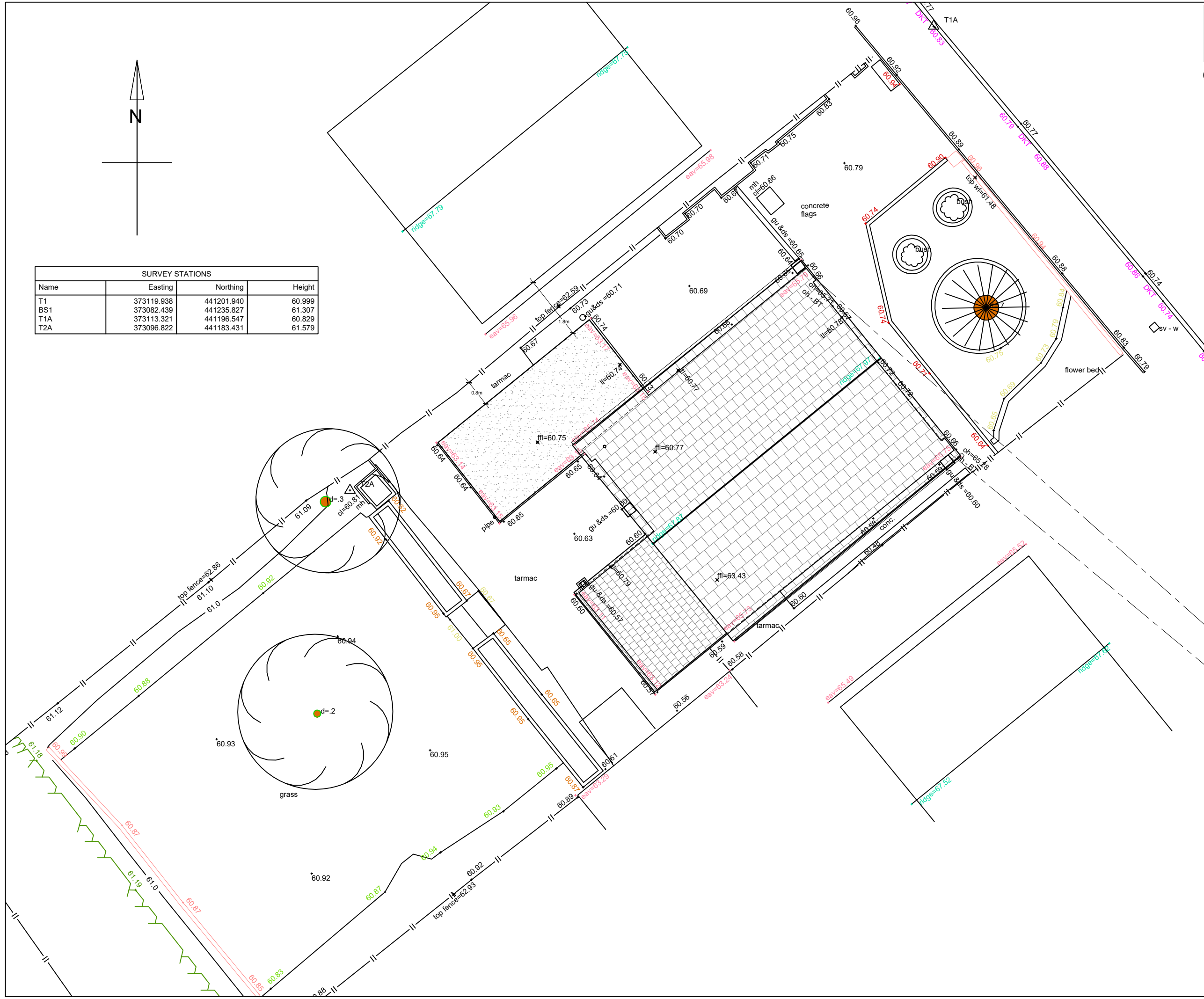

A MG Additional Dimensions Added. 14.05.2026

Client
MR AND MRS ASHTON

Job Title
PROPOSED EXTENSION AND ALTERATIONS AT 62 FAIRFIELD DRIVE CLITHEROE BB7 2PS

Drawing Title
EXISTING ROOF SITE PLAN

Scale 1:100@ A3	Date FEB 26	Drawn JC/FS
--------------------	----------------	----------------

spa
SUNDERLAND PEACOCK ARCHITECTS
 SUNDERLAND PEACOCK & ASSOCIATES LTD.
 HAZELMERE, PIMLICO ROAD, CLITHEROE
 LANCASHIRE, BB7 2AG
 T 01200 423178 F 01200 427328
 E info@sunderlandpeacock.com
 www.sunderlandpeacock.com



7389 - E02 REV **A**