

**EXISTING ELEVATIONS**  
SCALE 1:100 A1

**PROPOSED ELEVATIONS**  
SCALE 1:100 A1

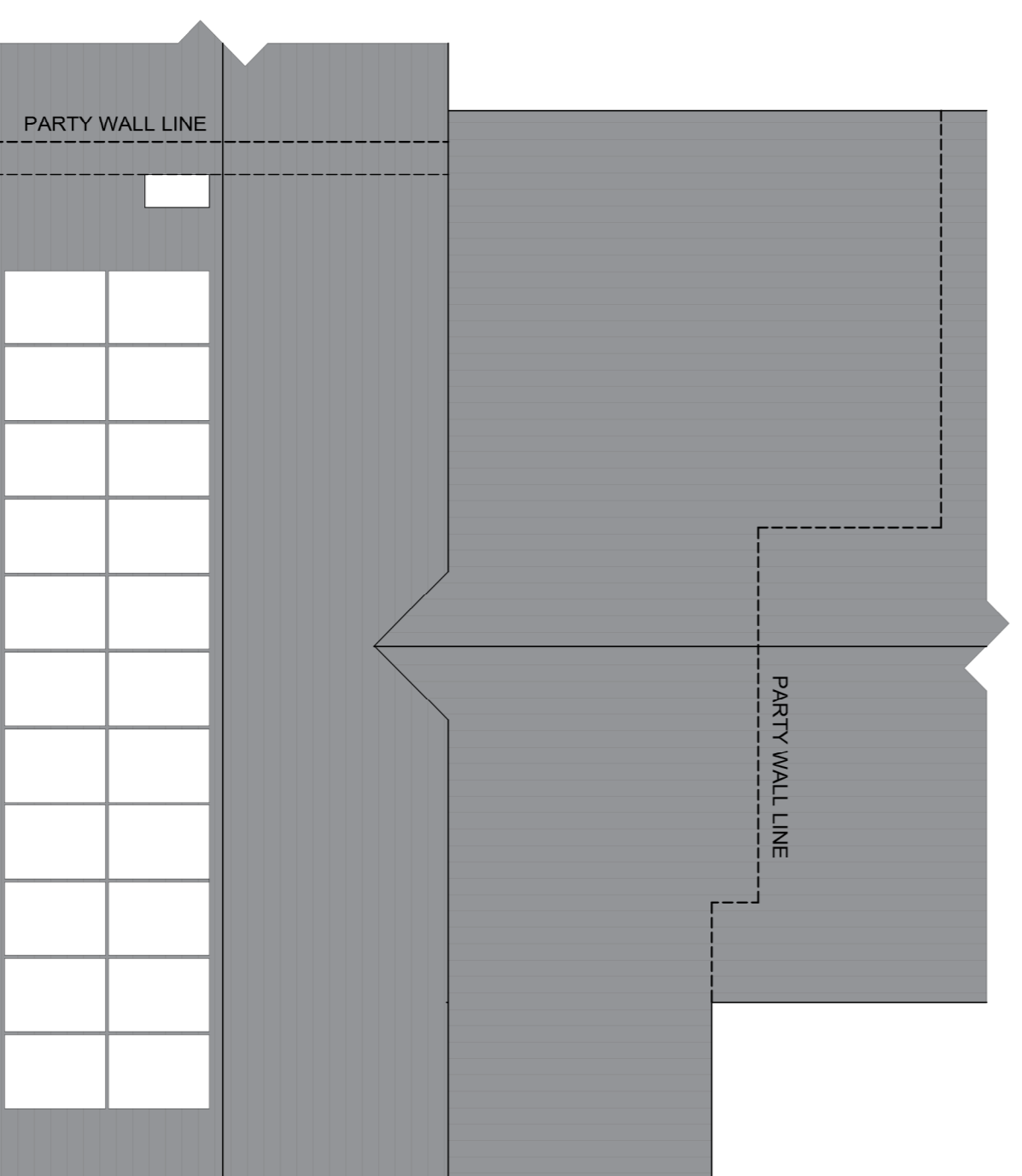
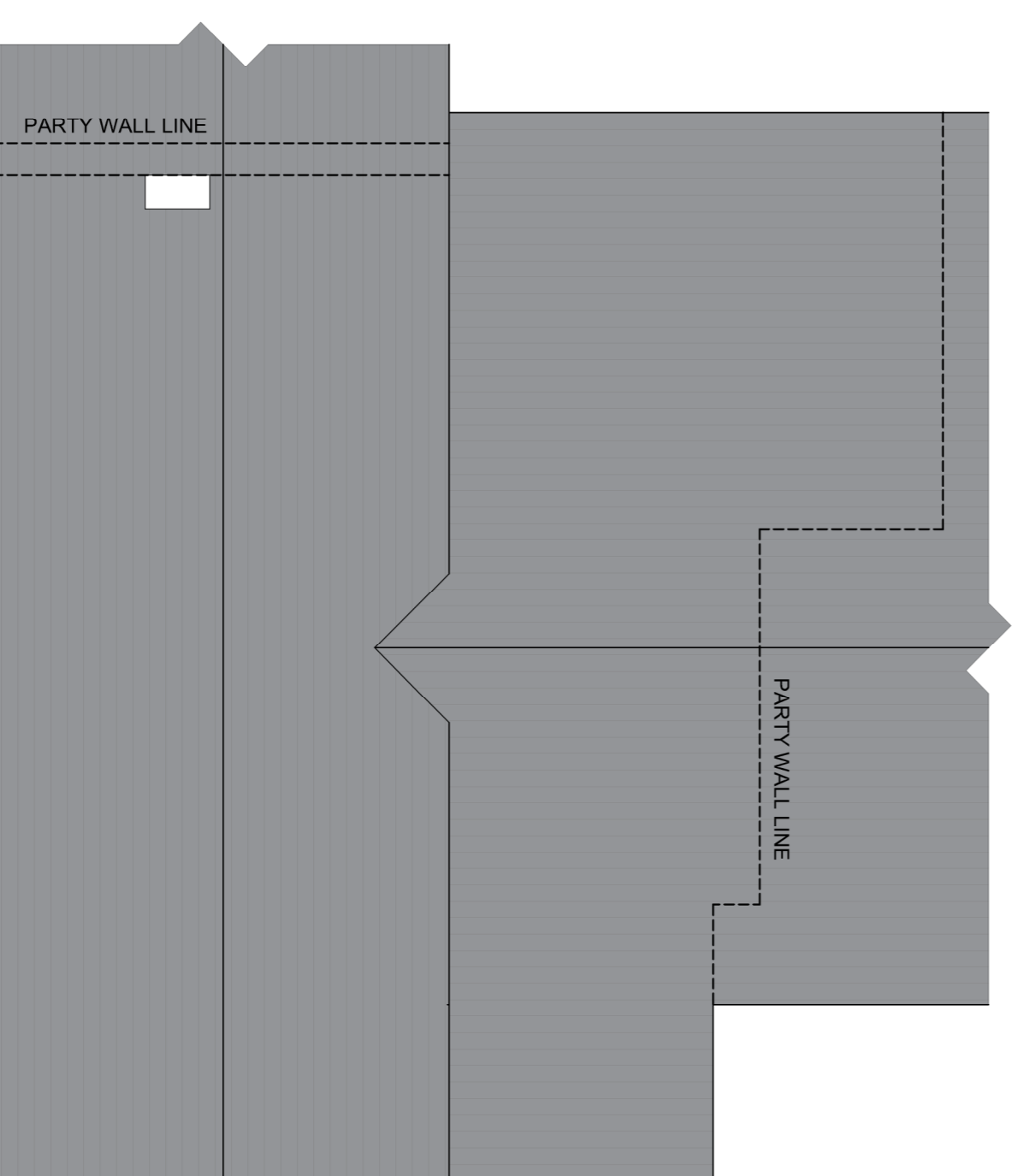

10.12kW - 22 solar panels  
Roof mounted  
JA Solar 460W N Type Double Glass Bifacial  
Tesla Powerwall 3 Battery

**SUBJECT TO CERTIFICATE OF LAWFUL DEVELOPMENT**

**CLIENT**  
Mr & Mrs Rainford

**ADDRESS**  
The Stables, Cow Ark, Clitheroe, BB7 3DG

**PROPOSAL**  
Dwelling: Solar Panels + ASHP

**DATE**  
11.05.2026

**JOB REFERENCE**  
0749

**DRAWING REFERENCE**  
PL000/01 - Dwelling: Proposed plans + elevation