

Copyright of this drawing is vested in 5plus Architect and it must not be copied or reproduced without written consent.
 Figured dimensions only are to be taken from this drawing. DO NOT SCALE OFF THIS DRAWING IF IN DOUBT
 ASK
 5plus architects are to be held responsible for checking and checking all dimensions relative to their work.
 5plus architects are to be held responsible for any variation between drawings and site conditions.
 Electronic data generated based as 'read only' and should not be interpreted for measurement.
 All dimensions and levels should be 'read only' from those values stated in text on the drawings

KEY PLAN:

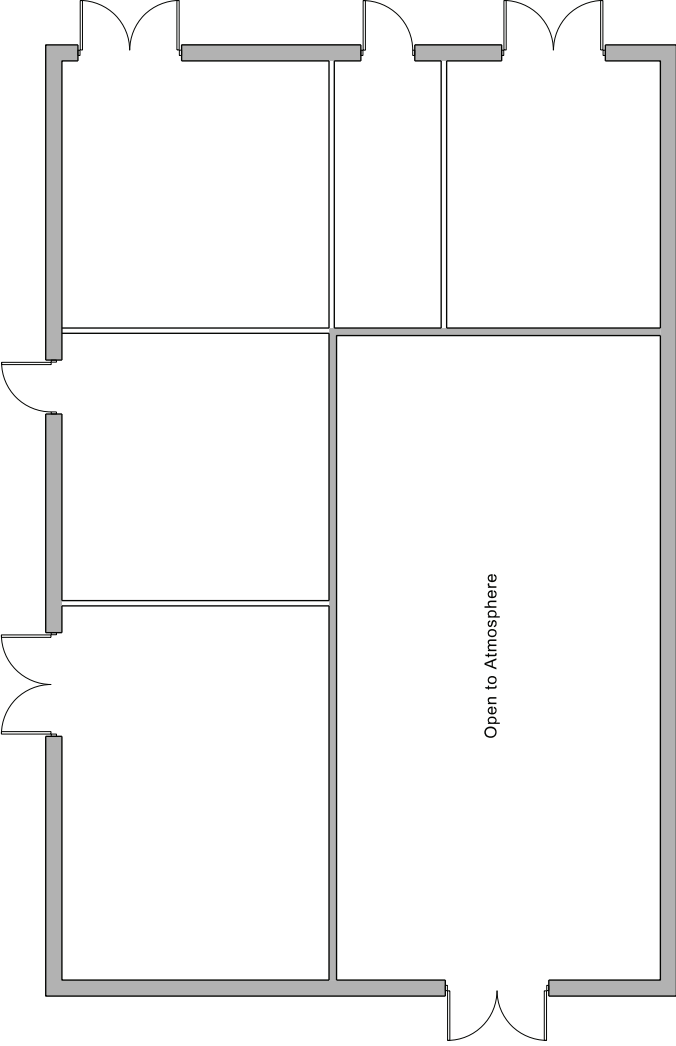

REV: | DATE: | DETAILS:



Ground Floor Plan

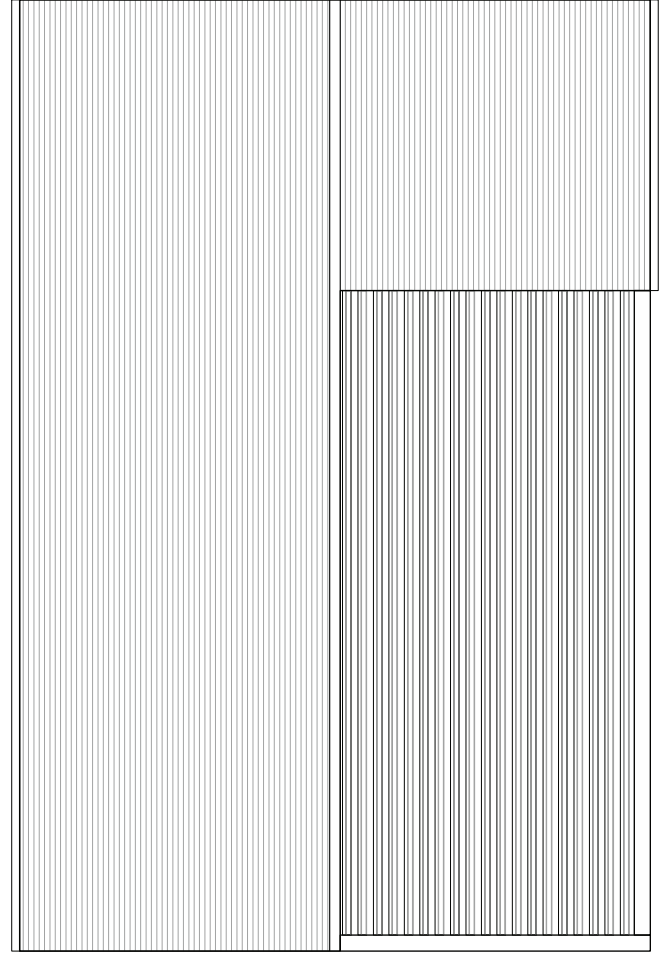

Roof Floor Plan

4th Floor
 The Hive
 47 Lever Street
 Manchester
 M1 1FN
 +44 (0)161 228 0211

5plus architects

www.5plusarchitects.com

PROJECT:
 Chipping
 Masterplan

TITLE:
 Mechanical Plant Building
 Ground Floor and Roof Plans

SCALE: 1:100 A3
 DATE: 19.09.13
 DRAWN: JDH
 CHECKED: JM

STATUS:
 Planning

DRAWING NO:
 05024_B8_02_000

REV: -

Architecture | Masterplanning | Interiors | Graphics | Branding