

32013 0208F



RIBBLE VALLEY BOROUGH COUNCIL

Council Offices, Church Walk, Clitheroe, Lancashire, BB7 2RA Tel: 01200 425111 www.ribblevalley.gov.uk

25 FEB 2013  
FOR THE ATTENTION OF

For office use only  
Application No.  
Date received <sup>fee</sup> 25.2.13  
Fee paid £ 195 Receipt No: 17707

Application for removal or variation of a condition following grant of planning permission.  
Town and Country Planning Act 1990.  
Planning (Listed Buildings and Conservation Areas) Act 1990

You can complete and submit this form electronically via the Planning Portal by visiting [www.planningportal.gov.uk/apply](http://www.planningportal.gov.uk/apply)

Publication of applications on planning authority websites

Please note that the information provided on this application form and in supporting documents may be published on the Authority's website. If you require any further clarification, please contact the Authority's planning department.

Please complete using block capitals and black ink.

It is important that you read the accompanying guidance notes as incorrect completion will delay the processing of your application.

**1. Applicant Name and Address**

Title:  First name:

Last name:

Company (optional):

Unit:  House number:  House suffix:

House name:

Address 1:

Address 2:

Address 3:

Town:

County:

Country:

Postcode:

**2. Agent Name and Address**

Title:  First name:

Last name:

Company (optional):

Unit:  House number:  House suffix:

House name:

Address 1:

Address 2:

Address 3:

Town:

County:

Country:

Postcode:

### 3. Site Address Details

Please provide the full postal address of the application site.

Unit:  House number:  House suffix:

House name:

Address 1:

Address 2:

Address 3:

Town:

County:

Postcode (optional):

Description of location or a grid reference (must be completed if postcode is not known):

Easting:  Northing:

Description:

### 4. Pre-application Advice

Has assistance or prior advice been sought from the local authority about this application?  Yes  No

If Yes, please complete the following information about the advice you were given (This will help the authority to deal with this application more efficiently)

Please tick if the full contact details are not known, and then complete as much as possible:

Officer name:

Reference:

Date (DD/MM/YYYY):  (must be pre-application submission)

Details of pre-application advice received?

### 5. Description Of Your Proposal

Please provide a description of the approved development as shown on the decision letter, including the application reference number and date of decision in the sections below:

Reference number:  Date of decision (DD/MM/YYYY):  (date must be pre-application submission)

Please state the condition number(s) to which this application relates:

1	CONDITION 3	6.	
2.		7	
3.		8.	
4		9.	
5.		10	

Has the development already started?  Yes  No

If Yes, please state when the development started (DD/MM/YYYY):  (date must be pre-application submission)

Has the development been completed?  Yes  No

If Yes, please state when the development was completed (DD/MM/YYYY):  (date must be pre-application submission)

### 6. Condition(s) - Removal

Please state why you wish the condition(s) to be removed or changed:

If you wish the existing condition to be changed, please state how you wish the condition to be varied:

**7. Ownership Certificates**

One Certificate A, B, C, or D, must be completed with this application form

**CERTIFICATE OF OWNERSHIP - CERTIFICATE A**

**Town and Country Planning (Development Management Procedure) (England) Order 2010 Certificate under Article 12**

I certify/ The applicant certifies that on the day 21 days before the date of this application nobody except myself/ the applicant was the owner (owner is a person with a freehold interest or leasehold interest with at least 7 years left to run) of any part of the land or building to which the application relates

Signed - Applicant:

Or signed - Agent:

Date DD/MM/YYYY:

*P. Blackham*

25/2/13

**CERTIFICATE OF OWNERSHIP - CERTIFICATE B**

**Town and Country Planning (Development Management Procedure) (England) Order 2010 Certificate under Article 12**

I certify/ The applicant certifies that I have/ the applicant has given the requisite notice to everyone else (as listed below) who, on the day 21 days before the date of this application, was the owner (owner is a person with a freehold interest or leasehold interest with at least 7 years left to run) of any part of the land or building to which this application relates.

Name of Owner	Address	Date Notice Served

Signed - Applicant:

Or signed - Agent:

Date DD/MM/YYYY:

**CERTIFICATE OF OWNERSHIP - CERTIFICATE C**

**Town and Country Planning (Development Management Procedure) (England) Order 2010 Certificate under Article 12**

I certify/ The applicant certifies that:

- Neither Certificate A or B can be issued for this application
- All reasonable steps have been taken to find out the names and addresses of the other owners (owner is a person with a freehold interest or leasehold interest with at least 7 years left to run) of the land or building, or of a part of it, but I have/ the applicant has been unable to do so

The steps taken were:

Name of Owner	Address	Date Notice Served

Notice of the application has been published in the following newspaper (circulating in the area where the land is situated):

On the following date (which must not be earlier than 21 days before the date of the application):

Signed - Applicant:

Or signed - Agent:

Date DD/MM/YYYY:

**7. Ownership Certificates (continued)**

**CERTIFICATE OF OWNERSHIP - CERTIFICATE D**

**Town and Country Planning (Development Management Procedure) (England) Order 2010 Certificate under Article 12**

I certify/ The applicant certifies that:

- Certificate A cannot be issued for this application
- All reasonable steps have been taken to find out the names and addresses of everyone else who, on the day 21 days before the date of this application, was the owner (*owner is a person with a freehold interest or leasehold interest with at least 7 years left to run*) of any part of the land to which this application relates, but I have/ the applicant has been unable to do so

The steps taken were:

Notice of the application has been published in the following newspaper (circulating in the area where the land is situated):

On the following date (which must not be earlier than 21 days before the date of the application):

Signed - Applicant:

Or signed - Agent:

Date DD/MM/YYYY:

**8. Agricultural Land Declaration**

**AGRICULTURAL LAND DECLARATION**

**Town and Country Planning (Development Management Procedure) (England) Order 2010 Certificate under Article 12**  
**Agricultural Land Declaration - You Must Complete Either A or B**

(A) None of the land to which the application relates is, or is part of, an agricultural holding.

Signed - Applicant:

Or signed - Agent:

Date (DD/MM/YYYY):



25/2/13

(B) I have/ The applicant has given the requisite notice to every person other than myself/ the applicant who, on the day 21 days before the date of this application, was a tenant of an agricultural holding on all or part of the land to which this application relates, as listed below:

Name of Tenant	Address	Date Notice Served

Signed - Applicant:

Or signed - Agent:

Date (DD/MM/YYYY):

**9. Planning Application Requirements - Checklist**

Please read the following checklist to make sure you have sent all the information in support of your proposal. Failure to submit all information required will result in your application being deemed invalid. It will not be considered valid until all information required by the Local Planning Authority has been submitted

- |   |   |
|---|---|
| The original and 3 copies of a completed and dated application form: <input type="checkbox"/>   | The original and 3 copies of the completed, dated Ownership Certificate (A, B, C, or D - as applicable): <input type="checkbox"/> |
| The original and 3 copies of other plans and drawings or information necessary to describe the subject of the application: <input type="checkbox"/> | The original and 3 copies of the completed, dated Article 12 Certificate (Agricultural Holdings): <input type="checkbox"/>        |
| The correct fee: <input type="checkbox"/>   |   |

### 10. Declaration

I/we hereby apply for planning permission/consent as described in this form and the accompanying plans/drawings and additional information.

Signed - Applicant:

Or signed - Agent:

Date (DD/MM/YYYY):

*B. Blackburn*

23/2/13

(date cannot be pre-application)

### 11. Applicant Contact Details

Telephone numbers

Country code: National number: Extension number:

Country code: Mobile number (optional):

Country code: Fax number (optional):

Email address (optional):

### 12. Agent Contact Details

Telephone numbers

Country code: National number: Extension number:

Country code: Mobile number (optional):

Country code: Fax number (optional):

Email address (optional):

### 13. Site Visit

Can the site be seen from a public road, public footpath, bridleway or other public land?  Yes  No

If the planning authority needs to make an appointment to carry out a site visit, whom should they contact? (Please select only one)  Agent  Applicant  Other (if different from the agent/applicant's details)

If Other has been selected, please provide:

Contact name: BEN BLACKBURN

Telephone number: 01200 426276

Email address:

32013 0208 P

Mr B Blackburn  
Higher Mill Farm  
Slaidburn Road  
Waddington  
Clitheroe  
BB7 3JJ

RBVC  
Church Walk  
Clitheroe  
BB7 2RA

25<sup>th</sup> February 2013

Planning Department

Planning no:3/2012/0419

Re: Application for removal of planning permission condition 3

Please find attached application for removal of condition 3 following grant of planning permission for a holiday cottage.

I now find it necessary to be in the immediate area in order to help my father with the family business.

Since his heart attack he is unable to continue to do his work as he did before and I am having to take much more responsibility for the day to day running of the business. Therefore the removal of this clause would allow me and my partner to reside in the cottage where I can fulfil the role now required.

Having lived here all my life, attended Waddington school and Bowland High, I feel it is important for me and my partner to be here to continue the business and raise our family in a place which has been the family home for generations.

I am aware of other properties in the immediate area, where those restrictions have now been removed and hope you will look favourably on this application.

Thanking you in anticipation

Mr B Blackburn



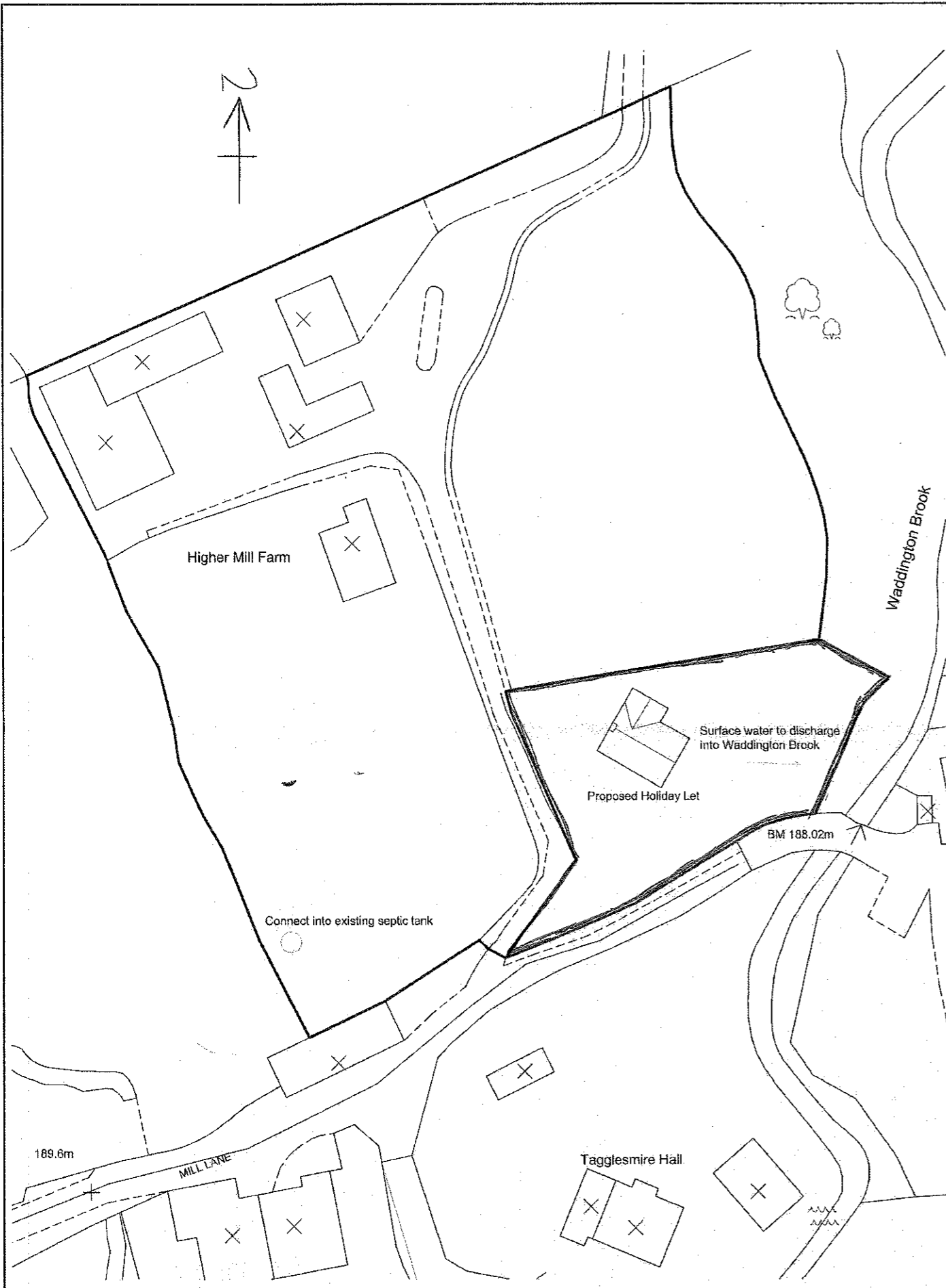

Site Plan 1:500

32013 0208P

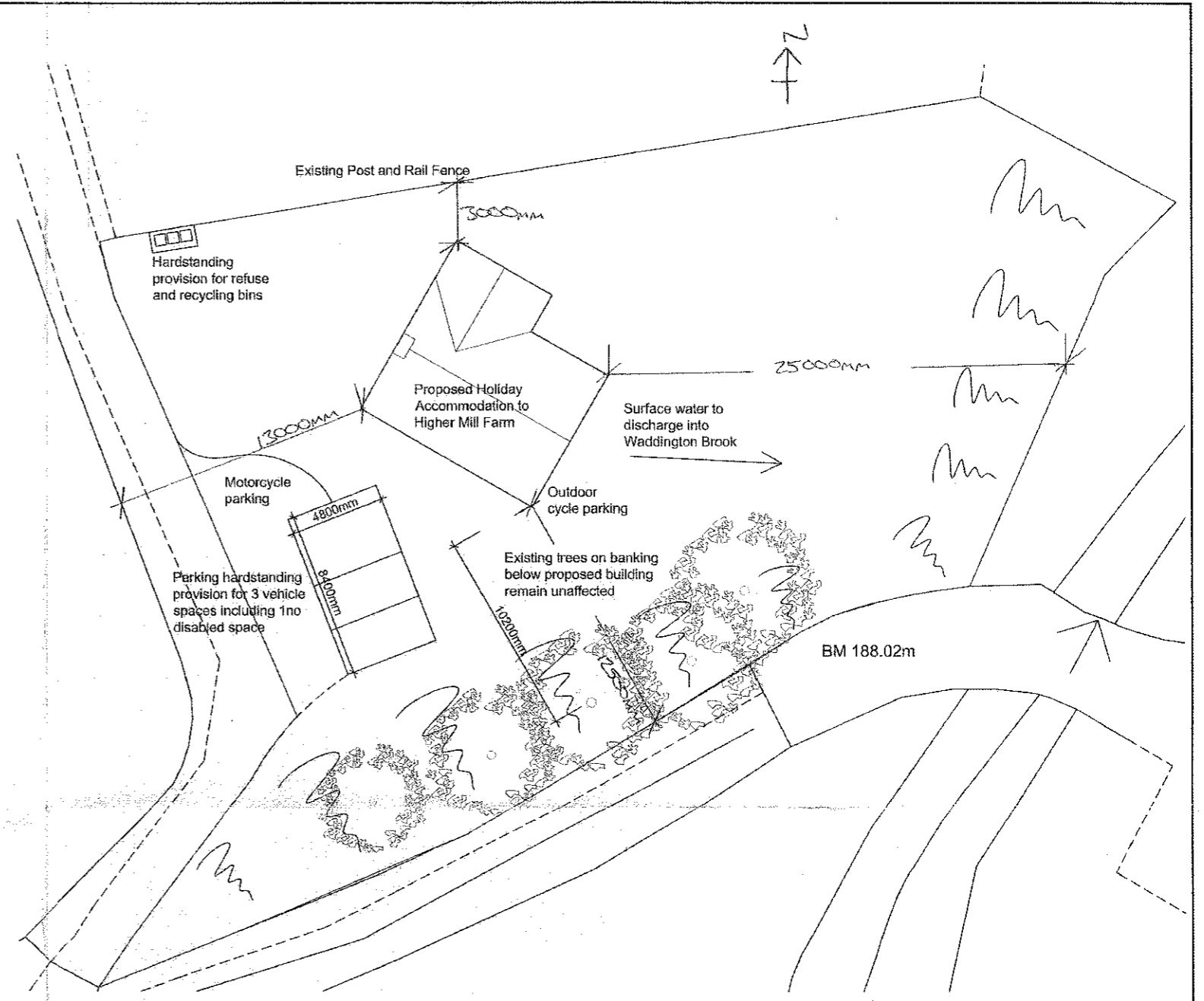

Site Plan 1:200

320101023P

Client Mr B Blackburn and Miss L Alpe		
Job Title Proposed Holiday Cottage at Higher Mill Farm Mill Lane Slaidburn Road Waddington BB7 3JJ		
Drawing Title Proposed Site Plans		
Scale 1:200/500	Date 01/12/10	Drawn AH

DWG -02