

FOR CONTINUATION REFER TO
DRAWING 211/90/19

PERIMETER OF QUARRY TO
INCLUDE LIFE BELT AND DEEP
WATER WARNING SIGNS. ADVISE
ON THE FREQUENCY AND
LOCATION OF SAFETY PROVISIONS
TO BE SOUGHT BY THE CLIENT

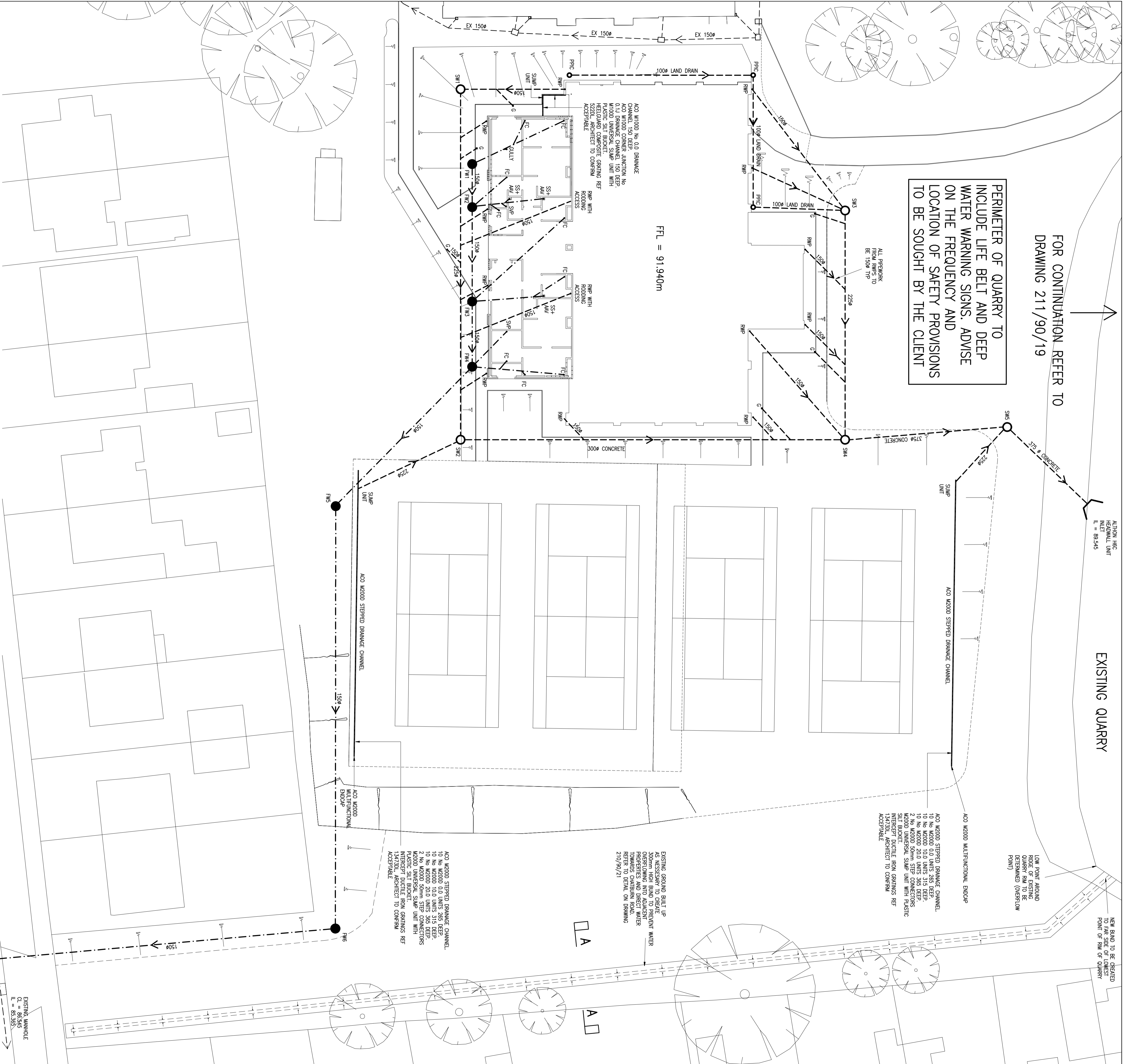

GENERAL NOTES

- THIS DRAWING SHALL BE READ IN CONJUNCTION WITH ALL RELEVANT ARCHITECTURAL, STRUCTURAL, MECHANICAL & ELECTRICAL DRAWINGS TOGETHER WITH THE PROJECT SPECIFICATION.
- ALL LEVELS ARE RELATIVE TO DRAINAGE DATUM.
- DRAINAGE DESIGN AND CONSTRUCTION TO BE IN ACCORDANCE WITH: BS EN 12256 - GRAVITY DRAINAGE SYSTEMS INSIDE BUILDINGS, BS EN 752 - DRAIN AND SEWER SYSTEMS OUTSIDE BUILDINGS, BS EN 1610 - CONSTRUCTION AND TESTING OF DRAWS AND SEWERS.
- ALL EXISTING DRAINAGE DETAILS, CONNECTIONS AND LEVELS ARE TO BE CHECKED ON SITE AND CONFIRMED TO BE ACCURATE BY THE CONTRACTOR PRIOR TO PROCEEDING. THE LOCATION OF ANY BODIES OR DRAINS WITHIN OR ON THE SURFACE OF THE PROJECT'S BUILDING EXTERIOR COURTYARD.
- ALL PROPOSED DRAINAGE DETAILS ARE TO BE CONFORMANT TO THE COMPLETE SATISFACTION OF THE PROJECT'S BUILDING EXTERIOR COURTYARD.
- REFER TO LETTER & WATSON LLP DRAWING NUMBER 211/90/20 & 21 FOR DRAINAGE DETAILS.
- ALL ABOVE GROUND FOUL AND SURFACE WATER DRAINAGE DETAILS, INCLUDING FITTINGS, JOINT CONNECTIONS TO SOIL, PRESSURE & RAIN PIPES SPECIFICATION, FITTINGS, ARE TO BE APPROVED BY THE ARCHITECT'S ARCHITECT TO CONFORM WITH THE PROJECT'S BUILDING EXTERIOR COURTYARD.
- ALL INTERNAL WIRING CAN PENETRATE OR SIMILAR APPROVED TO BS EN 252-1.
- ALL DRAINAGE IS TO BE 150mm DIAMETER UNLESS NOTED OTHERWISE.
- ALL MANHOLES WITHIN CARPARKS ARE TO HAVE HEAVY DUTY CLASS D400 MANHOLE COVERS.
- ALL DRAINAGE UNDER FOOTPRINT OF BUILDING TO BE ENCASED IN 150mm CONCRETE SURROUND.
- ALL DRAINAGE INSTALLATIONS SHALL BE AS TESTED IN ACCORDANCE WITH BS EN 12256 - GRAVITY DRAINAGE SYSTEMS INSIDE BUILDINGS, LETTER & WATSON LLP DRAWING.
- UPON COMPLETION OF THE PROPOSED DRAINAGE WORKS, THE CONTRACTOR IS TO ARRANGE FOR ALL SYSTEMS, INCLUDING INTERFACES WITH EXISTING DRAINAGE PIPES AND MANHOLES, TO BE CITY SURVEYED AND A REPORT PROVIDED TO LETTER & WATSON LLP.
- ALL DRAINAGE WITHIN TRAPPOVED AREAS WITH LESS THAN 1.2 METRES OF COVER TO BE ENCASED IN 150mm CONCRETE SURROUND.
- ALL EXTERNAL DRAINAGE TO BE HERMOTH WIRING.
- ALL DRAINAGE SHALL BE APPROVED BY THE ARCHITECT'S ARCHITECT TO CONFORM WITH THE PROJECT'S BUILDING EXTERIOR COURTYARD.
- ALL PIPES CONNECTED TO LAND DRAINAGE MUST HAVE A SILT RAP DETAIL.

FOUL WATER MANHOLE SCHEDULE

MANHOLE REF	COVER LEVEL	INVERT LEVEL	DEPTH	MANHOLE CONSTRUCTION
FM1	91.780	91.100	0.680	900Øx75 BRICK
FM2	91.780	90.955	0.825	900Øx75 BRICK
FM3	91.780	90.770	0.990	900Ø CONCRETE
FM4	91.780	90.570	1.090	900Ø CONCRETE
FM5	91.100 APP	90.050	1.050 APP	900Ø CONCRETE
FM6	88.850	87.800	1.050	900Ø CONCRETE

SURFACE WATER MANHOLE SCHEDULE

MANHOLE REF	COVER LEVEL	INVERT LEVEL	DEPTH	MANHOLE CONSTRUCTION
SM1	91.720	90.970	0.750	900Ø CONCRETE
SM2	91.570	90.300	1.270	900Ø CONCRETE
SM3	93.120	91.150	1.970	1200Ø CONCRETE
SM4	91.800	90.825	2.270	1200Ø CONCRETE
SM5	92.400	89.975	2.725	1350Ø CONCRETE

DRAINAGE KEY

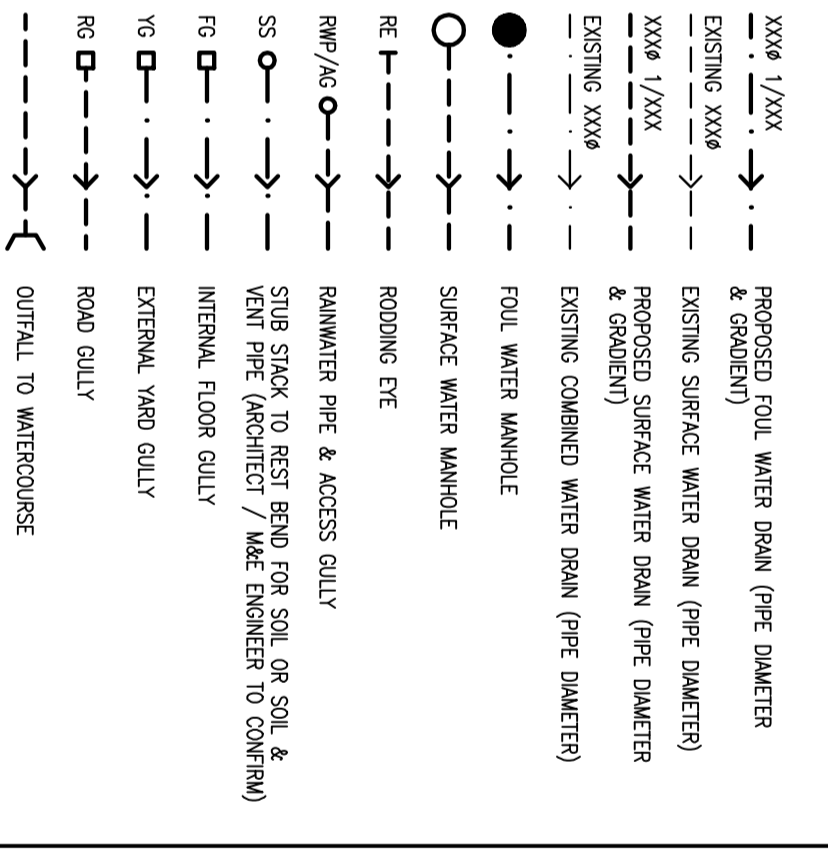

TENDER ISSUE

Rev	Amendments	Date	Ints
A	ISSUED FOR TENDER PROCESS. CHANGES ADDED TO LAND DRAINAGE. BOND AMENDED FROM QUARRY OVERFLOW NOTES ADDED RE LAND DRAINAGE AND QUARRY	10/07/12	MB
B	DRAWING UPLOADED TO SIRT ARCHITECTS LATEST LAYOUT. ACO W2000 DRAINAGE CHANNEL ADDED, TENNIS COURT	05.07.13	HJ

Slater & Watson LLP
CONSULTING CIVIL & STRUCTURAL ENGINEERS
Slater & Watson LLP
28 West Gate, Farnham, Surrey, GU14 7JH
Email: info@slater-watson.co.uk
Website: www.slater-watson.co.uk

Project
**CLITHEROE ROYAL
GRAMMAR SCHOOL,
PROPOSED SPORTS HALL.**

Drawing Title
**PROPOSED FOUL & SURFACE
WATER DRAINAGE LAYOUT**

Drawn	MB	Checked	
Date	MAY 2012	Scaled	1:200
Drawing No.	211/90/18	Rev.	B