

NOTES

Written dimensions only are to be used from this drawing.
If any doubt exists the contractor must ask for clarification.
On no account must the contractor scale off this drawing.

Contractors and sub contractors must check and agree all dimensions before preparing workshop drawings or commencing work on site.

Contractors are responsible for informing maps of any discrepancy discovered on this drawing or between this drawing and any other related documents issued in respect of the work.

This drawing and the copyrights and patents herein are the property of mpas and may be used or reproduced only under contract.

All work must be carried out in accordance with the current Building Regulations, Codes of Practice and British Standards.
If any doubt exists the contractor must ask for clarification.

The Construction Design and Management Regulations 2007:
It is the responsibility of the client to instruct the appointed contractor to identify any special hazards in the carrying out of the construction works and prepare a Health & Safety Plan and submit the relevant information to the Health & Safety Executive if necessary.
Martin Peacock Architectural Services Ltd Copyright © 2021

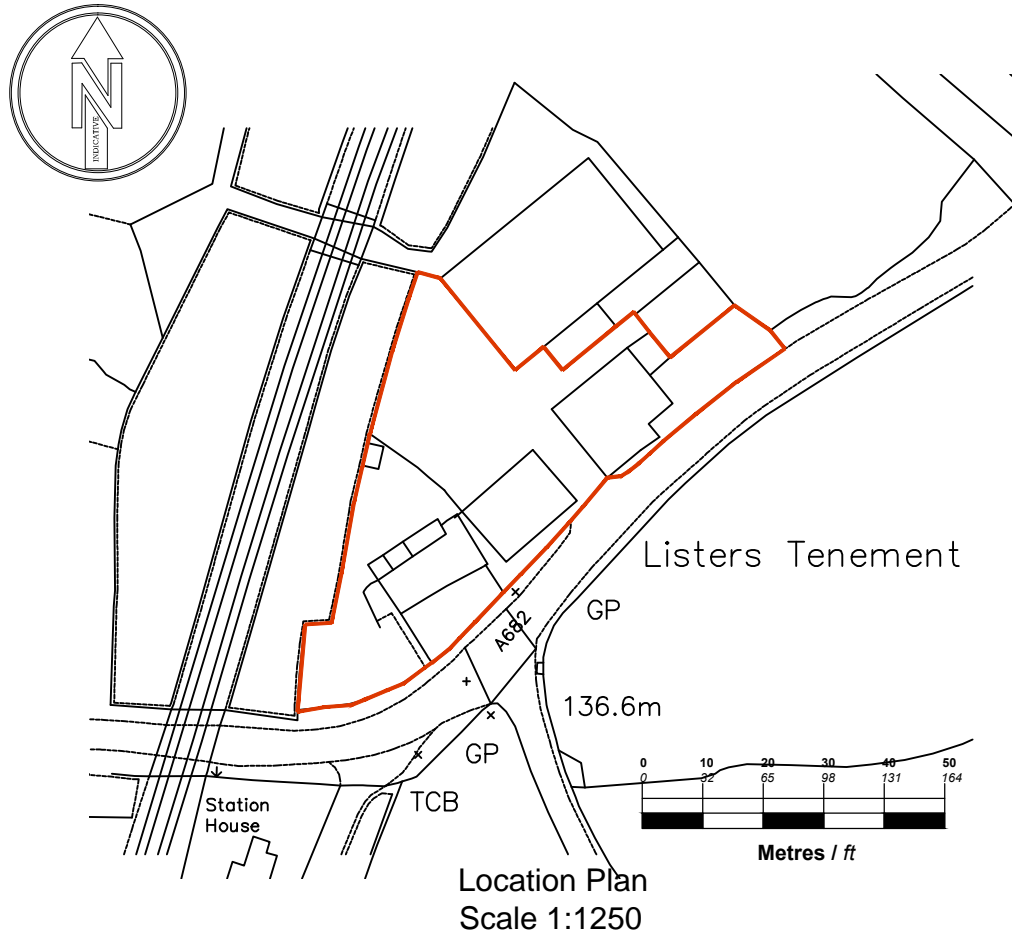

Contract Proposed Extension And Other Associated Alterations To Existing Dwelling At Listers Farm, Newsholme, Clitheroe. BB7 4JF			mpas	
Client Mrs S Wright			Martin Peacock Architectural Services Limited	
Drawing Location Plan			Old Reading Room Main Street, Stainforth, Settle North Yorkshire BD24 9PE. Office: 019 4381 6082 Tel: 07765 224 261	
Drawn	MDP	Job No	Drawing No	Revision
Scale	1:1250 @A4	2021-04	400	-
Date	11-01-2021			