

SITE LOCATION
NTS

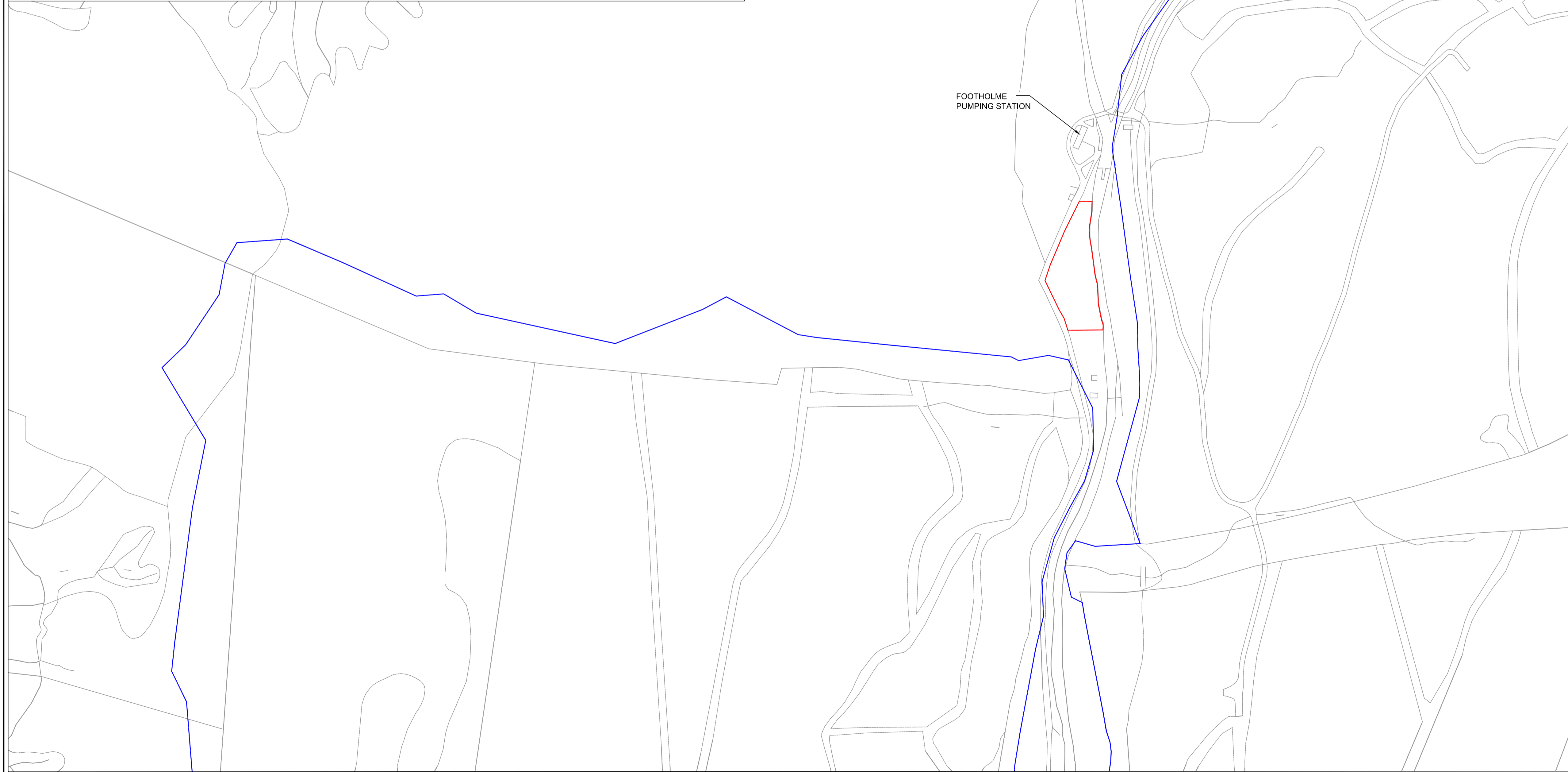

FOOTHOLME PUMPING STATION

NOTES
1. ALL DIMENSIONS IN MILLIMETRES AND ALL LEVELS IN METRES AOD UNLESS NOTED OTHERWISE.

- LEGEND
- UNITED UTILITIES LAND OWNERSHIP BOUNDARY
 - CONTRACTOR'S REMOTE COMPOUND/ WELFARE AREA

- REFERENCES
- MISC/80025030/04/00/D_LIST DRAWING LIST
 - 0578/80025030/04/21/2003 FOOOTHOLME W.P.S. CONTRACTORS REMOTE COMPOUND AND MATERIAL STORAGE AREA SITE LAYOUT PLAN PLANNING APPLICATION
 - 0578/80025030/04/21/2004 FOOOTHOLME W.P.S. CONTRACTORS REMOTE COMPOUND AND MATERIAL STORAGE AREA SITE ELEVATIONS PLANNING APPLICATION
 - 0578/80025030/04/21/2005 FOOOTHOLME W.P.S. CONTRACTORS REMOTE COMPOUND AND MATERIAL STORAGE AREA SITE DIMENSION PLAN PLANNING APPLICATION

TO BE REPRODUCED IN COLOUR ONLY

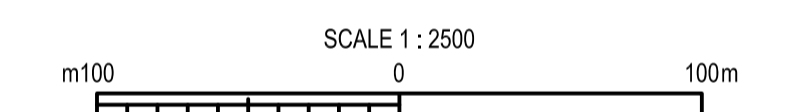

OS MAP REFERENCE
SD6553

CURRENT ISSUE INFORMATION

A	SCL	STB	JEG	CONTRACT	14.06.13
VERSION	DRWN	CHD	REV		DATE



UNITED UTILITIES PLC
WHITENDALE RAW WATER X AMP5
FOOTHOLME W. P.S. - CONTRACTORS
REMOTE COMPOUND AND MATERIALS
STORAGE AREA AND SITE LOCATION PLAN
PLANNING APPLICATION

SCALE	1:2500	SHEET SIZE	A1
DRAWING NUMBER	0578/80025030/04/21/2001	REVISION	A