

PRELIMINARY

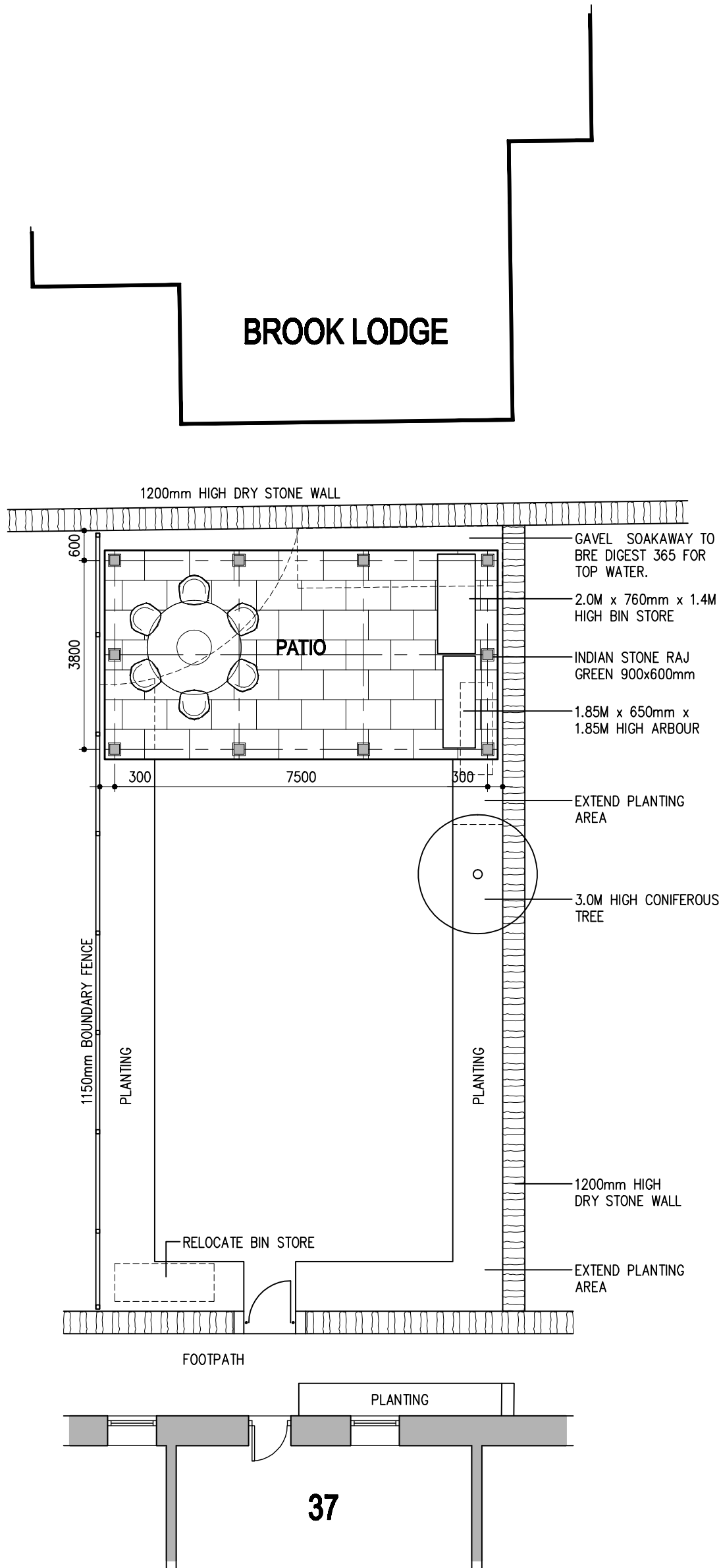

NOTES

This drawing is the property of SKP Architecture. copyright is reserved by them and the drawing is issued on the condition that it is not copied, reproduced, retained, or disclosed to any unauthorised person, either wholly or in part, without the consent in writing of SKP Architecture.

THIS DRAWING HAS BEEN PREPARED FOR OBTAINING LOCAL AUTHORITY DECISIONS ONLY AND IS NOT A CONSTRUCTION DRAWING.

All work to be carried out in strict accordance with the recommendations of the manufacturer / supplier.

This drawing to be read in strict accordance of the approved building regulations.

All dimension are subject to site check before commencement of any work on site and any discrepancies to be notified to SKP Architecture.

DO NOT SCALE FROM THIS DRAWING.

Electrical and heating details are to be determined on site by owner.

Contractor responsible for finding location of all services & gaining all approvals from statutory bodies for redirection.

Conditional approval required for new loading on existing elements, contractor to expose footings, lintels etc. for approval by local authority.

All works to be carried out in accordance with the PARTY WALL Etc ACT 1996.

All electrical work (design, installation & testing,) to comply with part 'p' of approved documents & carried out by competent electrical contractor (NICEIC, ECA OR NAPIT approved) and in accordance with B.S. 7671.

All work to be carried out in accordance with CDM regulations 2015, client responsible for instructing Principal contractor who will then take over the clients duties.

PROPOSED PLAN

PROPOSED COVERED GARDEN PERGOLA & HARD SURFACED PATIO

At
37 RAMSDEN TERRACE,
WADDINGTON,
CLITHEROE, B87 3HN

For
MR J. CHAPMAN

SKP ARCHITECTURE

07851 646 888 30 North Bank Road
 01274 488 888 Bingley
 elmon.pedford@hotmail.co.uk West Yorkshire
 skparchitecture.co.uk BD16 1UH

Date:	AUGUST2016	Drawing No:	16/1035-03
Scale:	1:100@A3	Revision:	-

SITE PLAN. (As Proposed.)