

* Roundabout shown in the existing configuration. The design for the junction is to be verified through vehicle movement analysis & development of an appropriate design

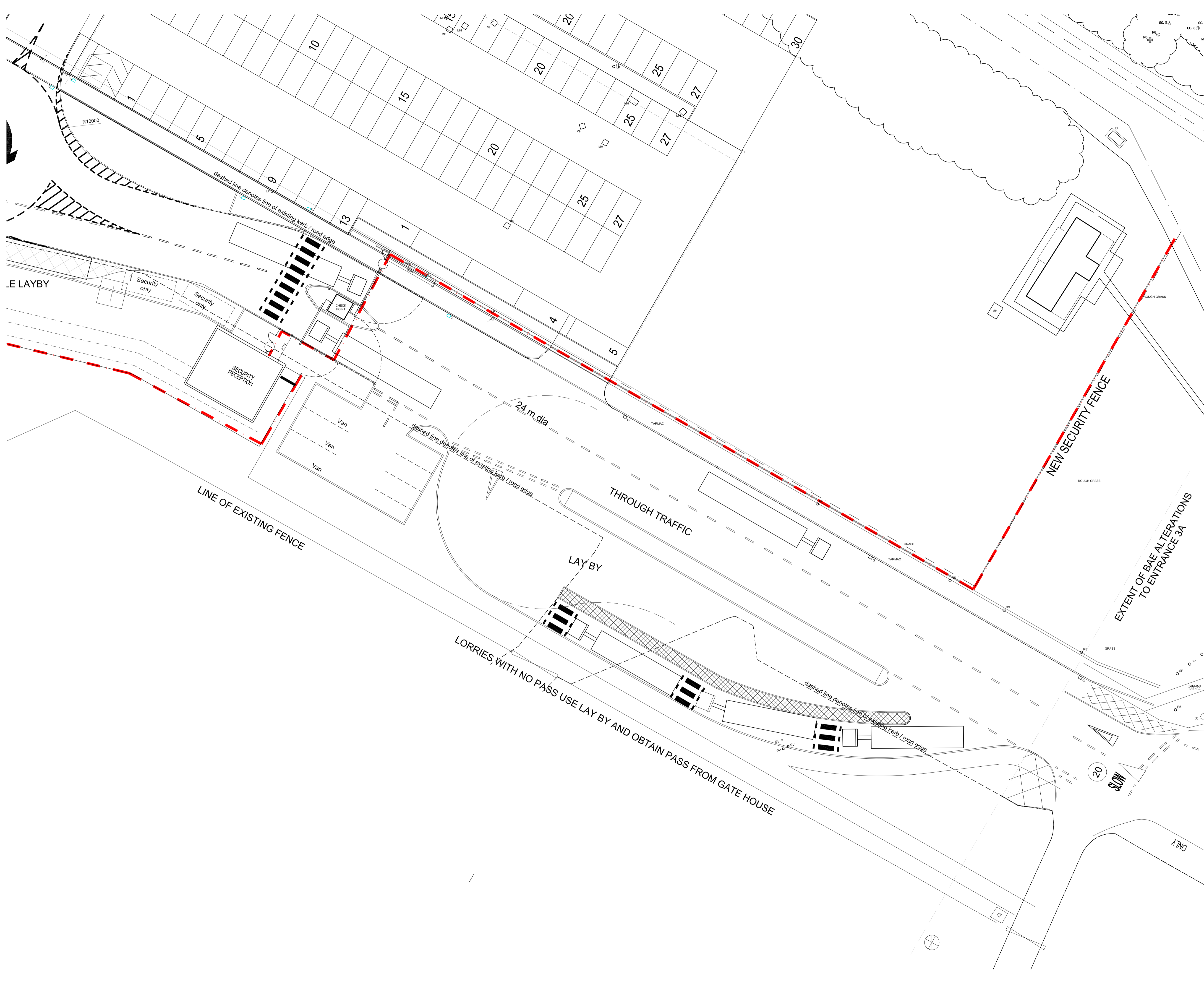

LEGEND

- - - BAE REVISED SECURITY BOUNDARY
- ENTERPRISE ZONE (EZ)
- PROPOSED BAE AREA
- EZ - NEW SPINE ROAD
- BAE REVISED SECURITY
- EDGE OF EXISTING HARD

no.	by	chk.	revision	date
3	ADW		GENERAL UPDATE BACKGROUND CHANGED TO CURRENT	20.10.14
2	ADW		GENERAL UPDATE TO CAR PARK AND ENTRANCE	13.10.14
1	ADW		UPDATED TO SLT SECURITY COMMENTS	04.09.14

project ADVANCED ENGINEERING AND MANUFACTURING ENTERPRISE

by MJG ctk. date 2014 08 27 scale 1:200 sheet size A1

PROPOSED SEGREGATION Proposed 3A Entrance

status P job no. / dsg. no. 6030 L(00)18 revision 3