

**GENERAL NOTES**

1. THIS DRAWING SHALL BE READ IN CONJUNCTION WITH ALL RELEVANT ARCHITECTURAL, STRUCTURAL, MECHANICAL, & ELECTRICAL DRAWINGS TOGETHER WITH THE PROJECT SPECIFICATION.
2. ALL LEVELS ARE RELATIVE TO ORDNANCE DATUM.
3. DRAINAGE DESIGN AND CONSTRUCTION TO BE IN ACCORDANCE WITH: BS EN 12056 - GRAVITY DRAINAGE SYSTEMS INSIDE BUILDINGS, BS EN 12056 - GRAVITY DRAINAGE SYSTEMS OUTSIDE BUILDINGS, BS EN 1610 - CONSTRUCTION AND TESTING OF DRAINS AND SEWERS.
4. ALL EXISTING DRAINAGE DETAILS, CONNECTIONS AND LEVELS ARE TO BE CHECKED ON SITE AND CONFIRMED TO BE ACCURATE BY THE CONTRACTOR PRIOR TO COMMENCEMENT OF ANY WORKS ON DRAINAGE WORKS (SEE THE CONTRACT PROGRAMME).
5. ALL PROPOSED DRAINAGE DETAILS ARE TO BE CONSTRUCTED TO THE COMPLETE SATISFACTION OF THE PROJECT'S BUILDING CONTROL OFFICER.
6. REFER TO SLEATER & WATSON LLP DRAWING NUMBER 211/90/20 & 21 FOR DRAINAGE DETAILS.
7. ALL ABOVE GROUND FOLI AND SURFACE WATER DRAINAGE DETAILS, INCLUDING PERFORATED MANHOLES, SHALL BE TO BE CONSTRUCTED TO THE COMPLETE SATISFACTION OF THE PROJECT'S BUILDING CONTROL OFFICER.
8. ALL INTERNAL BELOW GROUND DRAINAGE AND EXTERNAL DRAINAGE IS TO BE HEAVY DUTY 150mm CONCRETE SURROUND OR SIMILAR APPROVED TO BS EN 252-1.
9. ALL DRAINAGE IS TO BE 150mm DIAMETER UNLESS NOTED OTHERWISE.
10. ALL MANHOLES WITHIN CURBWORKS ARE TO HAVE HEAVY DUTY CLASS 9000 MANHOLE COVERS.
11. ALL DRAINAGE UNDER FOOTPRINT OF BUILDING TO BE ENCASED IN 150mm CONCRETE SURROUND.
12. ALL DRAINAGE INSTALLATIONS SHALL BE AIR TESTED IN ACCORDANCE WITH SLEATER & WATSON LLP DRAWING NUMBER 211/90/20 & 21.
13. UPON COMPLETION OF THE PROPOSED DRAINAGE WORKS, THE CONTRACTOR IS TO ARRANGE FOR ALL SYSTEMS, INCLUDING INTERFACES WITH EXISTING DRAINAGE PIPES AND MANHOLES, TO BE CCTV SURVEYED AND A REPORT PROVIDED TO SLEATER & WATSON LLP.
14. ALL DRAINAGE WITHIN TRAFFICED AREAS WITH LESS THAN 1.2 METRES OF COVER TO BE ENCASED IN 150mm CONCRETE SURROUND.
15. ALL INTERNAL DRAINAGE TO BE HEAVY DUTY WITHEDED CLAY DRAINAGE OR SIMILAR APPROVED.
16. ALL EXTERNAL DRAINAGE TO BE HEAVY DUTY WITHEDED CLAY DRAINAGE OR SIMILAR APPROVED.
17. ALL EXTERNAL DRAINAGE, FROM DOWNER OR ABOVE TO BE ALONG FRESHLY CONCRETE PERIPHERY OR SIMILAR APPROVED.

**PERIMETER OF QUARRY TO INCLUDE LIFE BELT AND DEEP WATER WARNING SIGNS. ADVISE ON THE FREQUENCY AND LOCATION OF SAFETY PROVISIONS TO BE SOUGHT BY THE CLIENT**

**MAIN CONTRACTOR IS TO CARRY OUT A TOPOGRAPHICAL SURVEY OF THE QUARRY TO ESTABLISH THE ACTUAL STORAGE VOLUME**

**ALL WEATHER SPORTS PITCH**

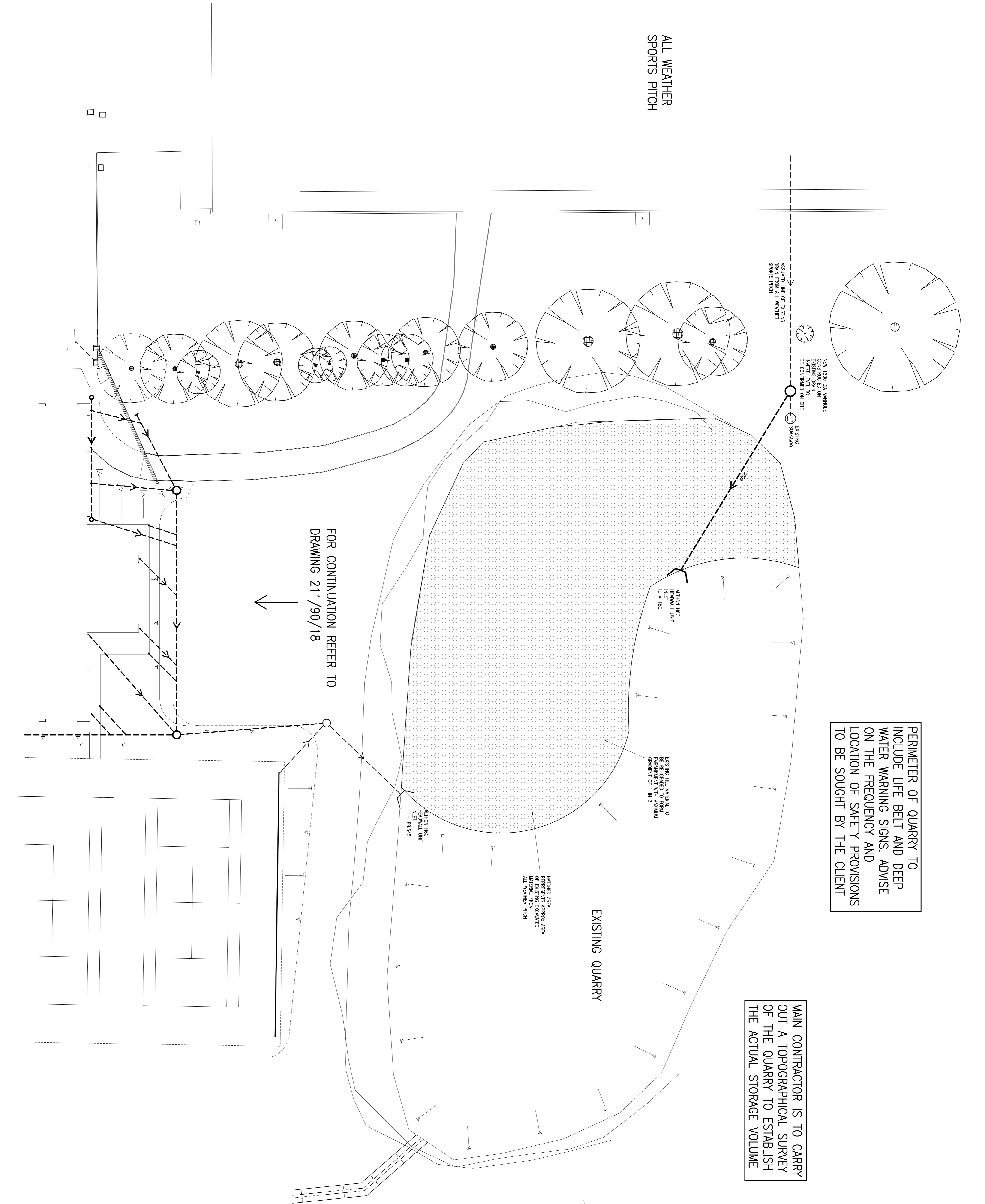

**FOR CONTINUATION REFER TO DRAWING 211/90/18**

**TENDER COPY**

Rev	Amendments	Date	Ints
B	DRAWING UPDATED TO SUIT ARCHITECTS LATEST LAYOUT.	03.06.13	N/A
A	ISSUED FOR TENDER PURPOSES. APPROX EXTENT OF EXCAVATED MATERIAL ADDED TO QUARRY HEADWALL UNIT INTO QUARRY FROM ALL WEATHER SPORTS PITCH REPOSITIONED, 3000 PPE EXTENDED, VARIOUS NOTES ADDED	10.07.12	N/A

**Sleater & Watson LLP**  
 Consulting Civil & Structural Engineers  
 26 West Cliff  
 Preston  
 Lancashire PR1 8HU  
 Tel: 01772 821044  
 Email: admin@sleaterwatson.co.uk  
 Website: www.sleaterwatson.co.uk

<b>Project</b>	
CLITHEROE ROYAL GRAMMAR SCHOOL PROPOSED SPORTS HALL FACILITY	
<b>Drawing Title</b>	
WORKS TO QUARRY & OVERFLOW FROM EXISTING ALL WEATHER PITCH	
<b>Drawn</b>	Checked
MB	
<b>Date</b>	<b>Scale</b>
JULY 2012	A1 1:200
<b>Drawing No.</b>	<b>Rev.</b>
211/90/19	B