

# **Larkhill (Old Langho) Maintenance Limited.**

# Index

	Page(s)
1 Adopted roads plan	1
2 Brockhall farm & original access 1	2
3 Brockhall farm entrance	3
4 Cattle grid	4
5 Dirt track 1	5
6 Dirt track 2	6
7 Dirt track 3	7
8 Distance to adopted road plan	8
9 Distance to Brockhall original access plan	9
10 Farm boundary plan	10
11 Farmers track & public footpath	11
12 Farmers track 2	12
13 Larkhill Ownership Boundary plan	13
14 Larkhill Ownership roads plan	14
15 Larkhill Roads plan 2	15 – 25
16 Parking 1	26
17 Parking 2	27
18 Parking 3	28
19 Parking 4	29
20 Parking 5	30
21 Parking 6	31
22 Parking 7	32
23 Parking 8	33
24 Parking 9	34
25 Parking 10	35
26 Passing Places plan	36
27 Pedestrian 177 m away	37
28 Public footpath map	38
29 Public transport plan 1	39
30 Public transport plan 2	40
31 Track condition 1	41
32 Track condition 2	42

33	Track condition 3	43
34	Track condition 4	44
35	Track flooding 1	45
36	Track flooding 2	46
37	Track flooding 3	47
38	Track width 1	48
39	Track width 2	49
40	Track width 3	50
41	Track width 4	51
42	View from Brockhall farm towards original access & Brockhall Village 1	52
43	Trees 1	53
44	View from Brockhall farm towards original access & Brockhall Village 1iew from cattlegrid showing pedestrian 177m away	54
45	View from Brockhall farm towards original access & Brockhall Village 2	55
46	View from cattle grid down track towards Larkhill	56
47	View from field showing proximity from Brockhall farm to Brockhall Village 1	57
48	View from field showing proximity of Brockhall farm to Brockhall Village 2	58

- Adoptions**
- Adopted
  - Proposed
  - Districts
  - Other
  - Districts
  - Authority
  - Lancashire
  - Districts



# Adoption Plan



Date: 09/04/2020

This map is reproduced from Ordnance Survey material with the Permission of Ordnance Survey on behalf of the Controller of Her Majesty's Stationery Office (C) Crown Copyright. Unauthorised reproduction may lead to prosecution or civil proceedings. Lancashire County Council - OS Licence 100023100 (C) Centre of map: 370446 430302













Dirt track 1





Dirt track 2







# Distance to adopted Road Plan

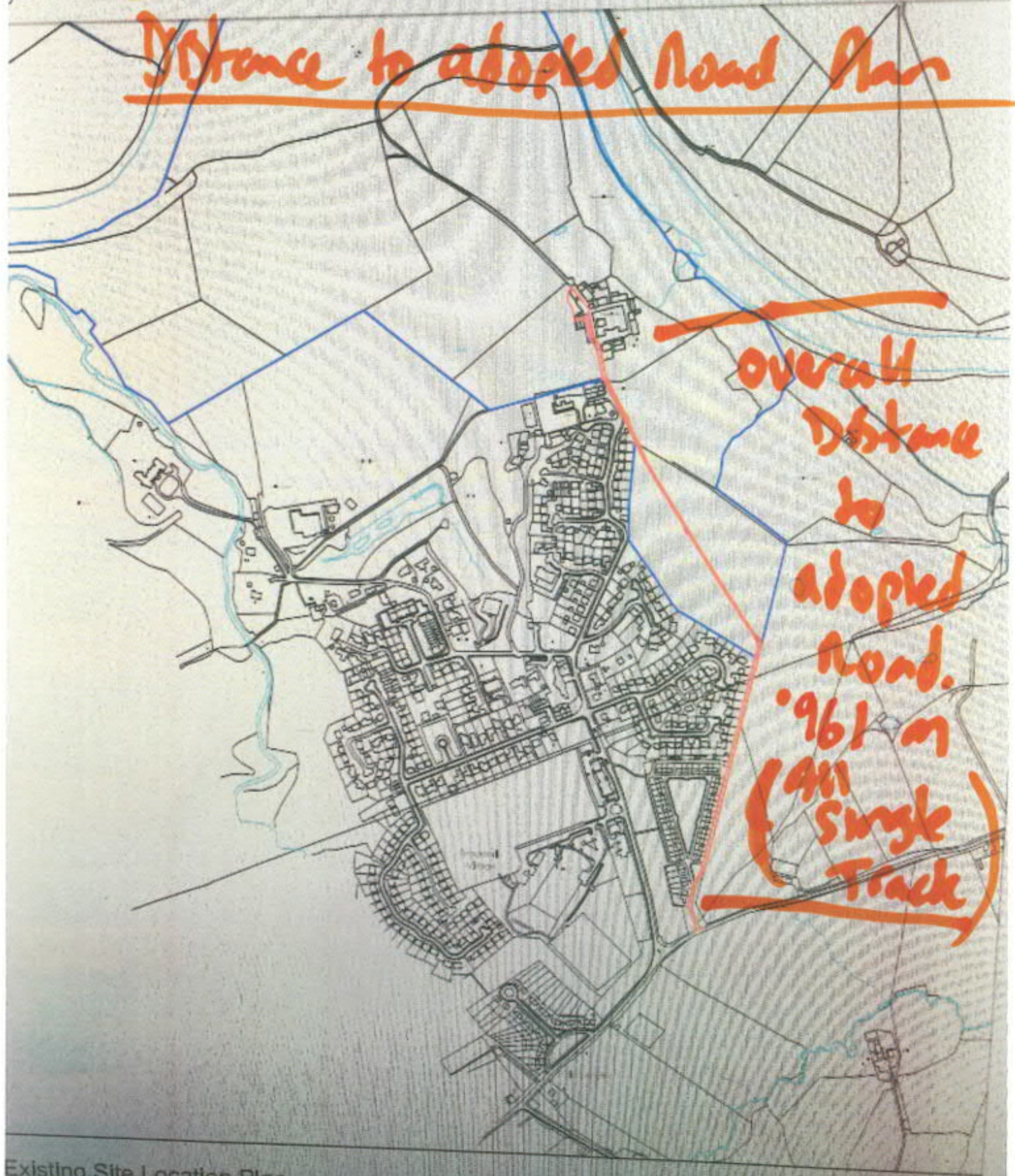

Existing Site Location Plan  
Scale 1:5000



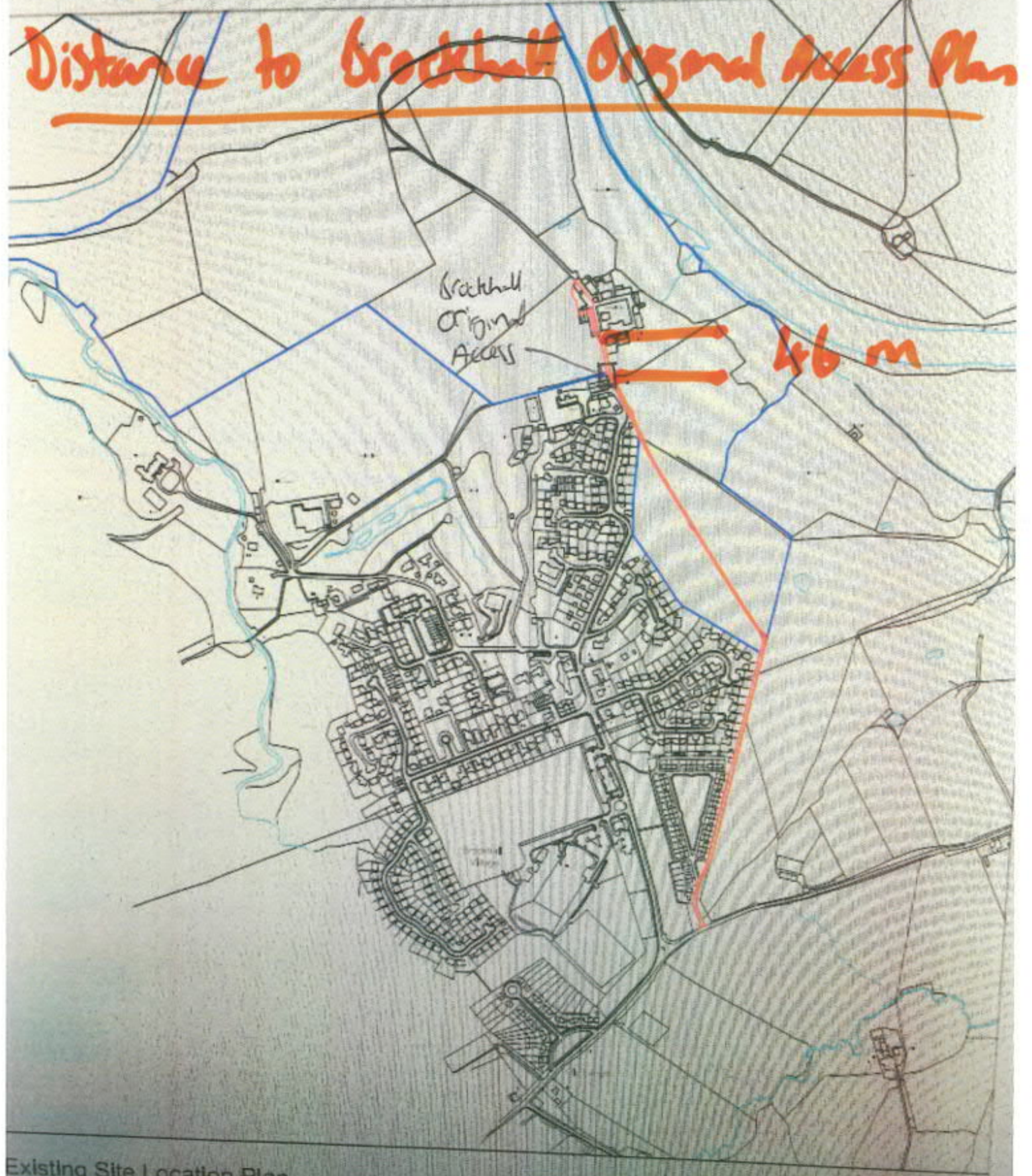

Existing Site Location Plan  
Scale 1:5000











H.M. LAND REGISTRY		TITLE NUMBER	
		LA714580	
ORDNANCE SURVEY PLAN REFERENCE	SD 7036	SECTION B	Scale 1/1250 Enlarged from 1/2500
COUNTY LANCASHIRE	DISTRICT RIBBLE VALLEY	© Crown copyright 1985	

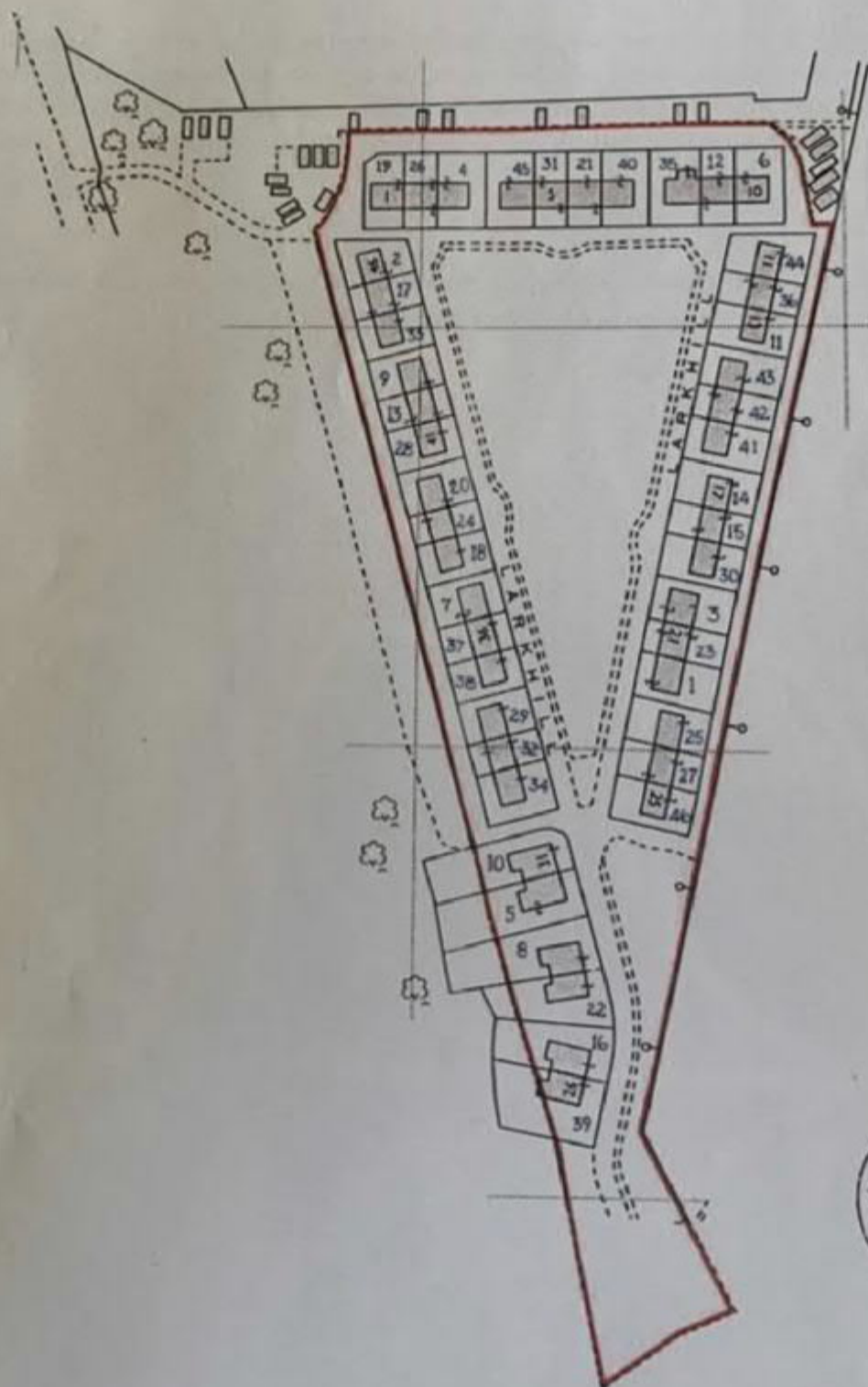







### Adoption Plan

Broken red line showing applicant's right of way

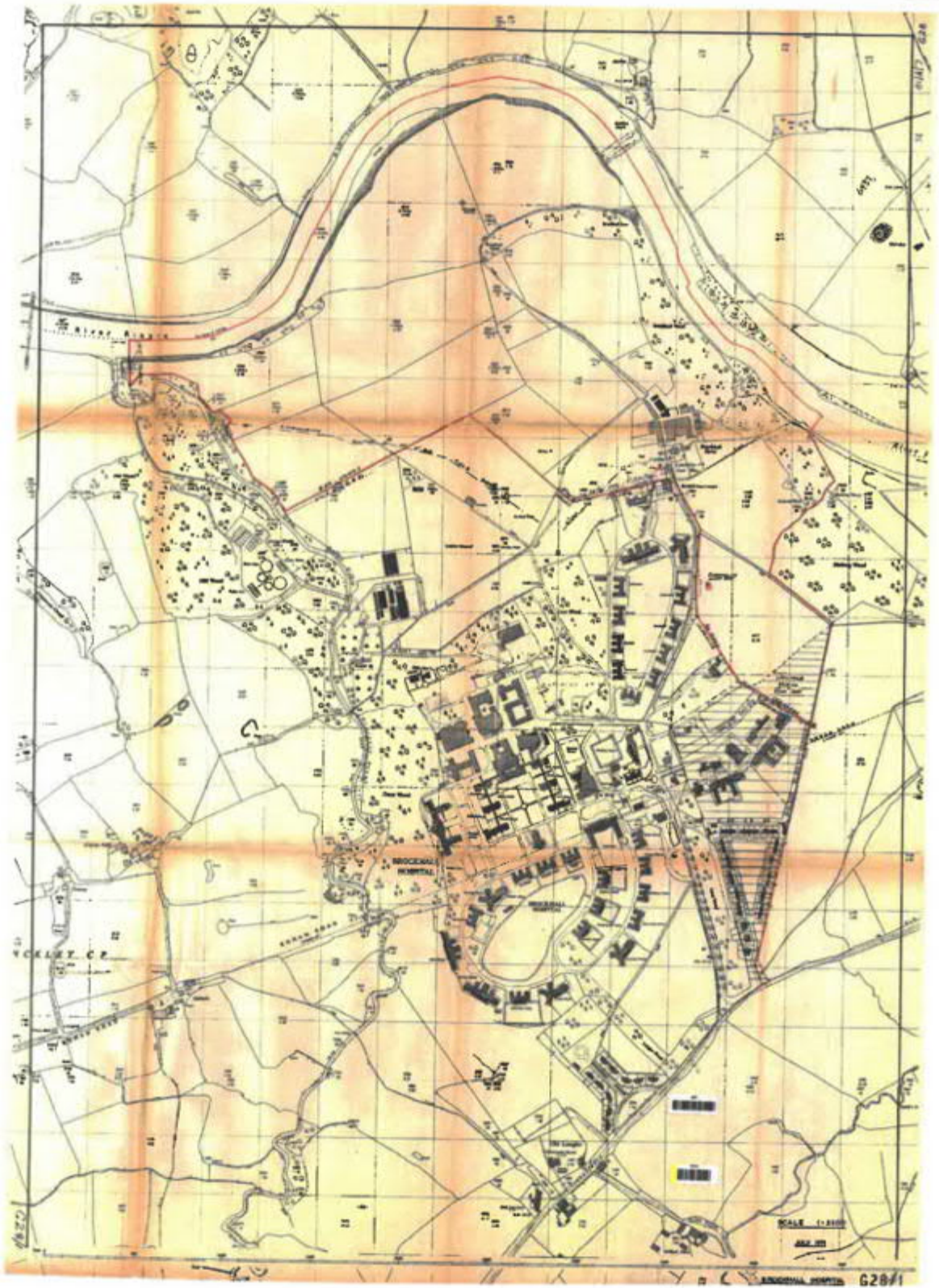



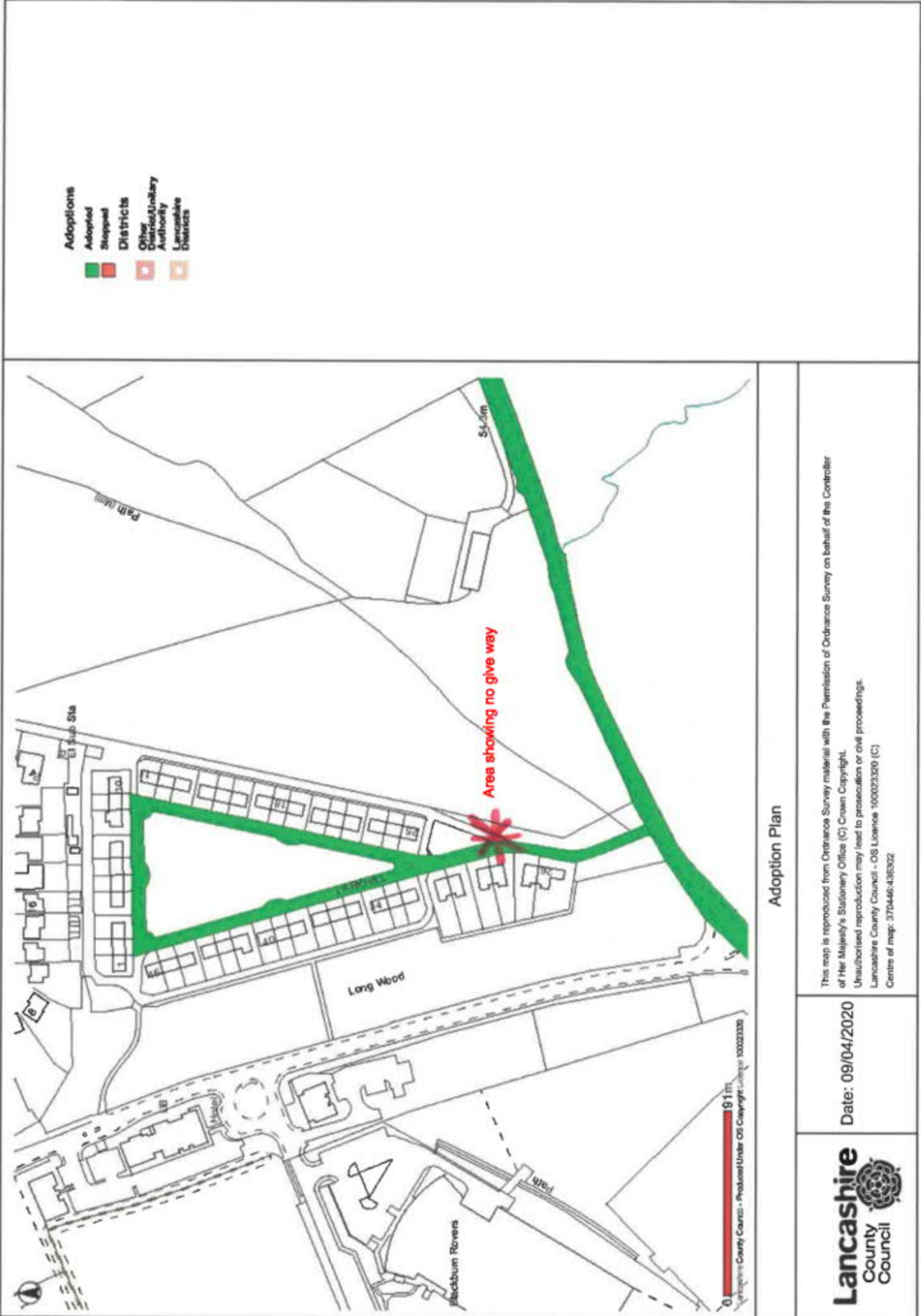

Larkhill Roads plan 2

Adoption Plan

This map is reproduced from Ordnance Survey material with the Permission of Ordnance Survey on behalf of the Controller of Her Majesty's Stationary Office (C) Crown Copyright.  
Unauthorised reproduction may lead to prosecution or civil proceedings.  
Lancashire County Council - OS Licence 100023320 (C)  
Centre of map: 370446/436302

Date: 09/04/2020





The electronic official copy of the register follows this message.

Please note that this is the only official copy we will issue. We will not issue a paper official copy.



# Official copy of register of title

Title number LA714580

Edition date 30.10.1995

- This official copy shows the entries on the register of title on 11 DEC 2017 at 12:33:57.
- This date must be quoted as the "search from date" in any official search application based on this copy.
- The date at the beginning of an entry is the date on which the entry was made in the register.
- Issued on 11 Dec 2017.
- Under s.67 of the Land Registration Act 2002, this copy is admissible in evidence to the same extent as the original.
- This title is dealt with by HM Land Registry, Fylde Office.

## A: Property Register

This register describes the land and estate comprised in the title.

LANCASHIRE : RIBBLE VALLEY

- 1 (10.06.1992) The Freehold land shown edged with red on the plan of the above Title filed at the Registry and being 1-46 Larkhill, Old Langho, Billington.
- 2 (14.05.1993) The mines and minerals are excepted.
- 3 (14.05.1993) The land has the benefit of the rights granted by but is subject to the rights reserved by the Transfer dated 28 April 1993 referred to in the Charges Register.
- 4 (14.05.1993) The Transfer dated 28 April 1993 referred to in the Charges Register contains a provision as to light or air.

## B: Proprietorship Register

This register specifies the class of title and identifies the owner. It contains any entries that affect the right of disposal.

### Title absolute

- 1 (14.05.1993) Proprietor: LARKHILL (OLD LANGHO) MAINTENANCE LIMITED (Co. Regn. No. 2760161) of 41-51 Blandford Square, Newcastle Upon Tyne, Tyne & Wear.

## C: Charges Register

This register contains any charges and other matters that affect the land.

- 1 (14.05.1993) A Transfer of the land in this title dated 28 April 1993 made between (1) London & Auckland Estates Limited and (2) Larkhill (Old Langho) Maintenance Limited contains restrictive covenants.

*NOTE:-Copy in Certificate.*

- 2 (14.05.1993) The parts of the land affected thereby are subject to the leases set out in the schedule of leases hereto.  
The leases grant and reserve easements as therein mentioned.

## Schedule of notices of leases

1	16.12.1992 1 LA708064	22 Larkhill	11.12.1992 999 years  (Less 1 day) from 1.12.1992
2	22.12.1992 2 LA708324	46 Larkhill	11.12.1992 999 years  (Less 1 day) from 1.12.1992
3	22.12.1992 3 LA708329	20 Larkhill	11.12.1992 999 years  (Less 1 day) from 1.12.1992
4	22.12.1992 4 LA708331	3 Larkhill	11.12.1992 999 years  (Less 1 day) from 1.12.1992
5	21.1.1993 5 LA709773	30 Larkhill	18.12.1992 999 years  (Less 1 day) from 1.12.1992
	NOTE :-The lease comprises also other land.		
6	17.2.1993 6 LA710934	10 Larkhill	12.1.1993 999 years  (Less 1 day) from 1.12.1992
7	17.2.1993 7 LA710935	37 Larkhill	11.12.1993 999 years  (Less 1 day) from 1.12.1992
8	8.3.1993 8 LA711601	29 Larkhill	16.12.1992 999 years  (Less 1 day) from 1.12.1992
	NOTE :-The lease comprises also other land.		
9	8.3.1993 9 LA711602	43 Larkhill	23.12.1992 999 years  (Less 1 day) from 1.12.1992
10	8.3.1993 10 LA711603	31 Larkhill	17.12.1992 999 years  (Less 1 day) from 1.12.1992
	NOTE :-The lease comprises also other land.		
11	8.3.1993 11 LA711604	13 Larkhill	11.12.1992 999 years  (Less 1 day) from 1.12.1992
12	8.3.1993 12 LA711606	9 Larkhill	11.12.1993 999 years  (Less 1 day) from 1.12.1992



## Schedule of notices of leases continued

13	8.3.1993 13 LA711608	42 Larkhill	8.1.1993 999 years  (Less 1 day) from 1.12.1992
14	8.3.1993 14 LA711610	17 Larkhill	16.12.1993 999 years  (Less 1 day) from 1.12.1992
15	8.3.1993 15 LA711611	18 Larkhill	8.1.1993 999 years  (Less 1 day) from 1.12.1992
16	8.3.1993 16 LA711613	27 Larkhill	11.12.1992 999 years  (Less 1 day) from 1.12.1992
	NOTE :-The lease comprises also other land.		
17	8.3.1993 17 LA711617	45 Larkhill	21.12.1992 999 years  (Less 1 day) from 1.12.1992
18	8.3.1993 18 LA711619	38 Larkhill	31.12.1992 999 years  (Less 1 day) from 1.12.1992
19	8.3.1993 19 LA711622	1 Larkhill	21.12.1992 999 years  (Less 1 day) from 1.12.1992
20	8.3.1993 20 LA711623	40 Larkhill	11.12.1992 999 years  (Less 1 day) from 1.12.1992
21	10.3.1993 21 LA711735	6 Larkhill	31.12.1992 999 years  (Less 1 day) from 1.12.1992
22	10.3.1993 22 LA711737	28 Larkhill	31.12.1992 999 years  (Less 1 day) from 1.12.1992
	NOTE :-The lease comprises also other land.		
23	10.3.1993 23 LA711747	21 Larkhill	15.1.1993 999 years  (Less 1 day) from 1.12.1992
24	10.3.1993 24 LA711749	39 Larkhill	23.12.1992 999 years  (Less 1 day) from 1.12.1992
25	10.3.1993	23 Larkhill	5.11.1993

## Schedule of notices of leases continued

	25 LA711750		999 years (Less 1 day) from 1.12.1992
26	10.3.1993 26 LA711751	2 Larkhill	31.12.1992 999 years (Less 1 day) from 1.12.1992
27	10.3.1993 27 LA711752	24 Larkhill	8.1.1993 999 years (Less 1 day) from 1.12.1992
28	10.3.1993 28 LA711754	41 Larkhill	21.12.1992 999 years (Less 1 day) from 1.12.1992
29	10.3.1993 29 LA711755	34 Larkhill	11.12.1993 999 years (Less 1 day) from 1.12.1992
30	10.3.1993 30 LA711774	19 Larkhill	11.12.1993 999 years (Less 1 day) from 1.12.1992
31	10.3.1993 31 LA711775	5 Larkhill	17.12.1992 999 years (Less 1 day) from 1.12.1992
32	29.3.1993 32 LA712674	33 Larkhill	8.1.1993 999 years (Less 1 day) from 1.12.1992
33	6.4.1993 33 LA712984	44 Larkhill	13.2.1993 999 years (Less 1 day) from 1.12.1992
34	6.4.1993 34 LA712990	32 Larkhill	29.1.1993 999 years (Less 1 day) from 1.12.1992
35	6.4.1993 35 LA712991	8 Larkhill	12.1.1993 999 years (Less 1 day) from 1.12.1992
36	6.4.1993 36 LA712992	12 Larkhill	1.2.1993 999 years (Less 1 day) from 1.12.1992
37	6.4.1993 37 LA712997	36 Larkhill	12.1.1993 999 years (Less 1 day)

# Schedule of notices of leases continued

			from 1.2.1992
38	7.4.1993 38 LA713053	35 Larkhill	5.2.1993 999 years  (Less 1 day) from 1.12.1992
39	26.5.1993 39 LA715122	26 Larkhill	29.4.1993 999 years  (Less 1 day) from 1.12.1992
40	26.5.1993 40 LA715124	7 Larkhill	29.4.1993 999 years  (Less 1 day) from 1.12.1992
41	29.7.1993 41 LA718637	16 Larkhill	27.4.1993 999 years  (Less 1 day) from 1.12.1992
42	29.7.1993 42 LA718638	15 Larkhill	27.4.1993 999 years  (Less 1 day) from 1.12.1992
43	29.7.1993 43 LA718639	14 Larkhill	27.4.1993 999 years  (Less 1 day) from 1.12.1992
44	29.7.1993 44 LA718640	11 Larkhill	27.4.1993 999 years  (Less 1 day) from 1.12.1992
45	29.7.1993 45 LA718641	4 Larkhill	27.4.1993 999 years  (Less 1 day) from 1.12.1992
46	29.7.1993 46 LA718642	25 Larkhill	27.4.1993 999 years  (Less 1 day) from 1.12.1992

End of register



**These are the notes referred to on the following official copy**

The electronic official copy of the title plan follows this message.

Please note that this is the only official copy we will issue. We will not issue a paper official copy.

This official copy was delivered electronically and when printed will not be to scale. You can obtain a paper official copy by ordering one from HM Land Registry.

This official copy is issued on 11 December 2017 shows the state of this title plan on 11 December 2017 at 12:34:05. It is admissible in evidence to the same extent as the original (s.67 Land Registration Act 2002). This title plan shows the general position, not the exact line, of the boundaries. It may be subject to distortions in scale. Measurements scaled from this plan may not match measurements between the same points on the ground.

This title is dealt with by the HM Land Registry, Fylde Office .

© Crown copyright. Produced by HM Land Registry. Reproduction in whole or in part is prohibited without the prior written permission of Ordnance Survey. Licence Number 100026316.

H.M. LAND REGISTRY		TITLE NUMBER	
		LA714580	
ORDNANCE SURVEY PLAN REFERENCE	SD 7036	SECTION B	Scale 1/1250 Enlarged from 1/2500
COUNTY LANCASHIRE	DISTRICT RIBBLE VALLEY		© Crown copyright 1985

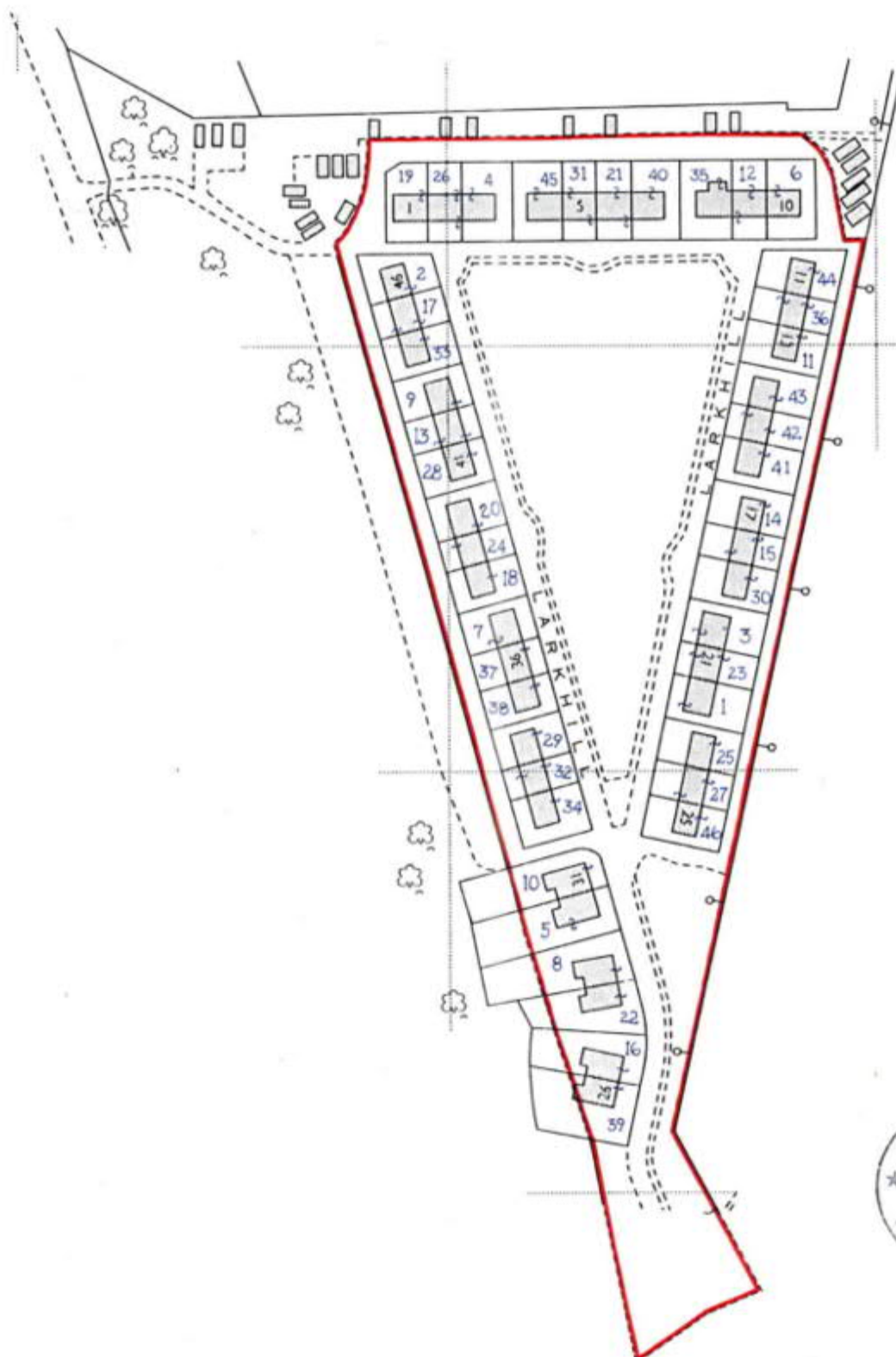











































# Passing Places Plan

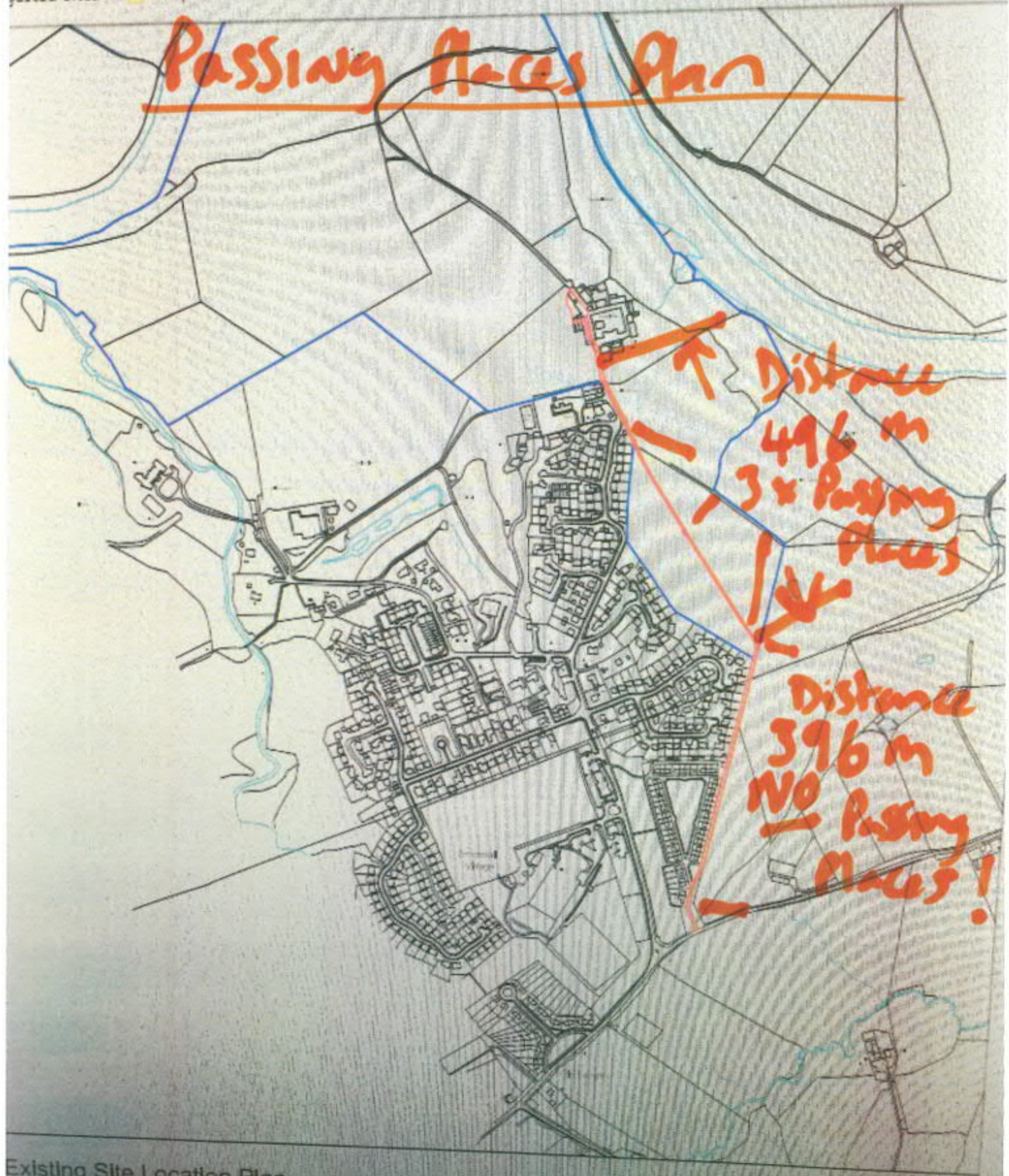

Existing Site Location Plan  
Scale 1:5000















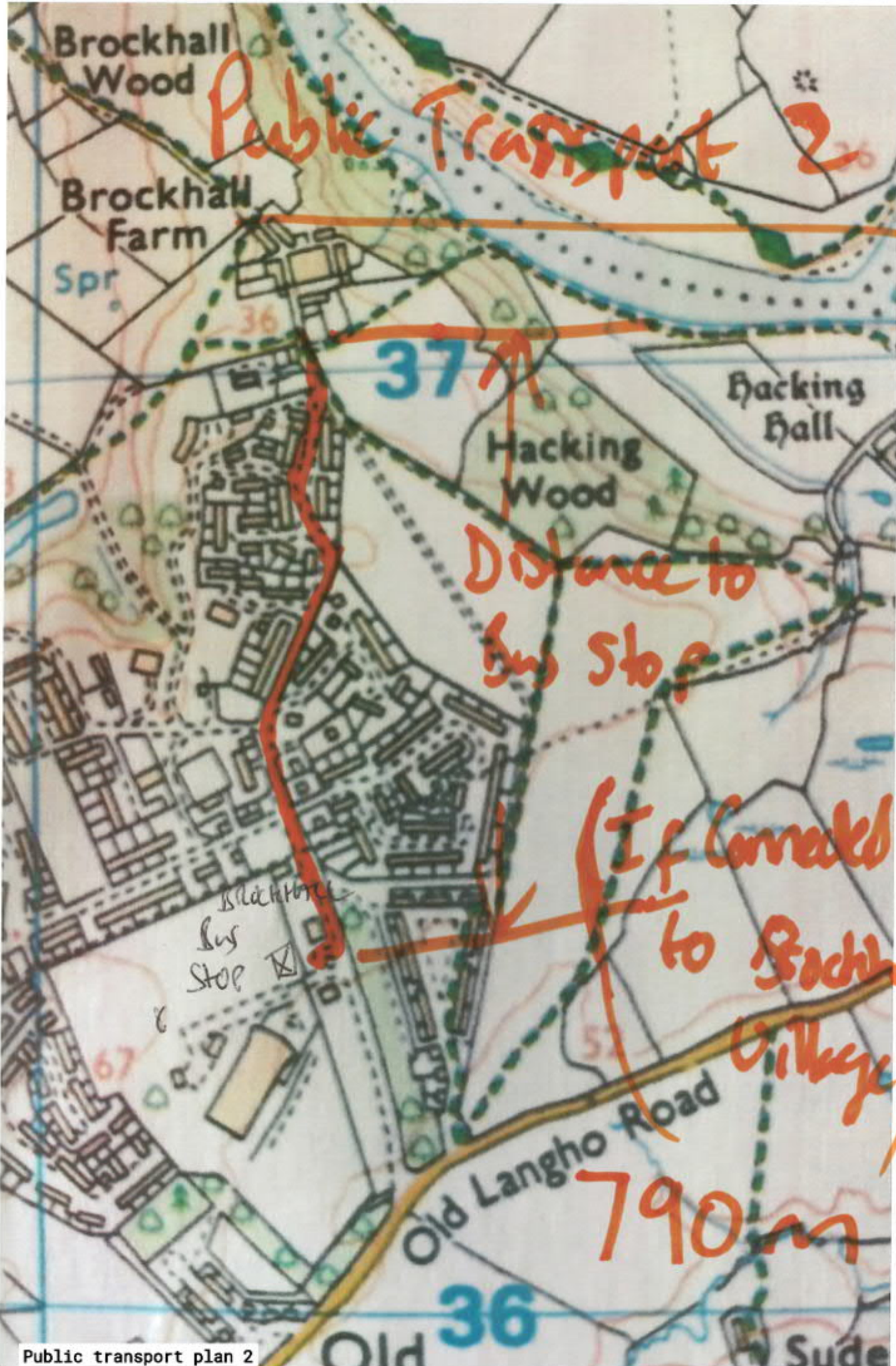

Public Transport 2

Distance to  
Bus Stop

(If Connected  
to Brockhall  
Village)

790m





















Track flooding 1

















Track width 2



Track width 3



50































