

1. This drawing and the copyrights and patents therein are the designers property and may be used or reproduced only under contract.
2. Contractors and sub contractors must check and agree all dimensions before preparing shop drawings or commencing work on site.
3. Contractors are responsible for informing the designer of any discrepancy discovered on this drawing or between this drawing and any other related documents issued in respect of the work.
4. Written dimensions only are to be used from this drawing. If any doubt exists the contractor must ask for clarification.
5. On no account must the contractor scale off this drawing.
6. All work must be carried out in accordance with the current Building Regulations, Codes of Practice and British Standards. If any doubt exists the contractor must ask for clarification.

**The Construction Design and Management Regulations 2015:-**

Under CDM2015 the domestic client has a duty and also the responsibility of appointing a Principle Designer (PD) which can be the appointed contractor or a suitably qualified person, who's role is to manage the health and safety of the project and the construction works and prepare a Health & Safety Plan if necessary. This should be a formal agreement and could involve the services of a specialist Principle Designer. Should you require any further assistance please contact this office.

This drawing has been prepared for Mr & Mrs P Marsden for the proposed rear extension and is submitted as part of the planning application to Ribbles Valley Borough Council and it is not intended for use by any other person or for any other purpose.

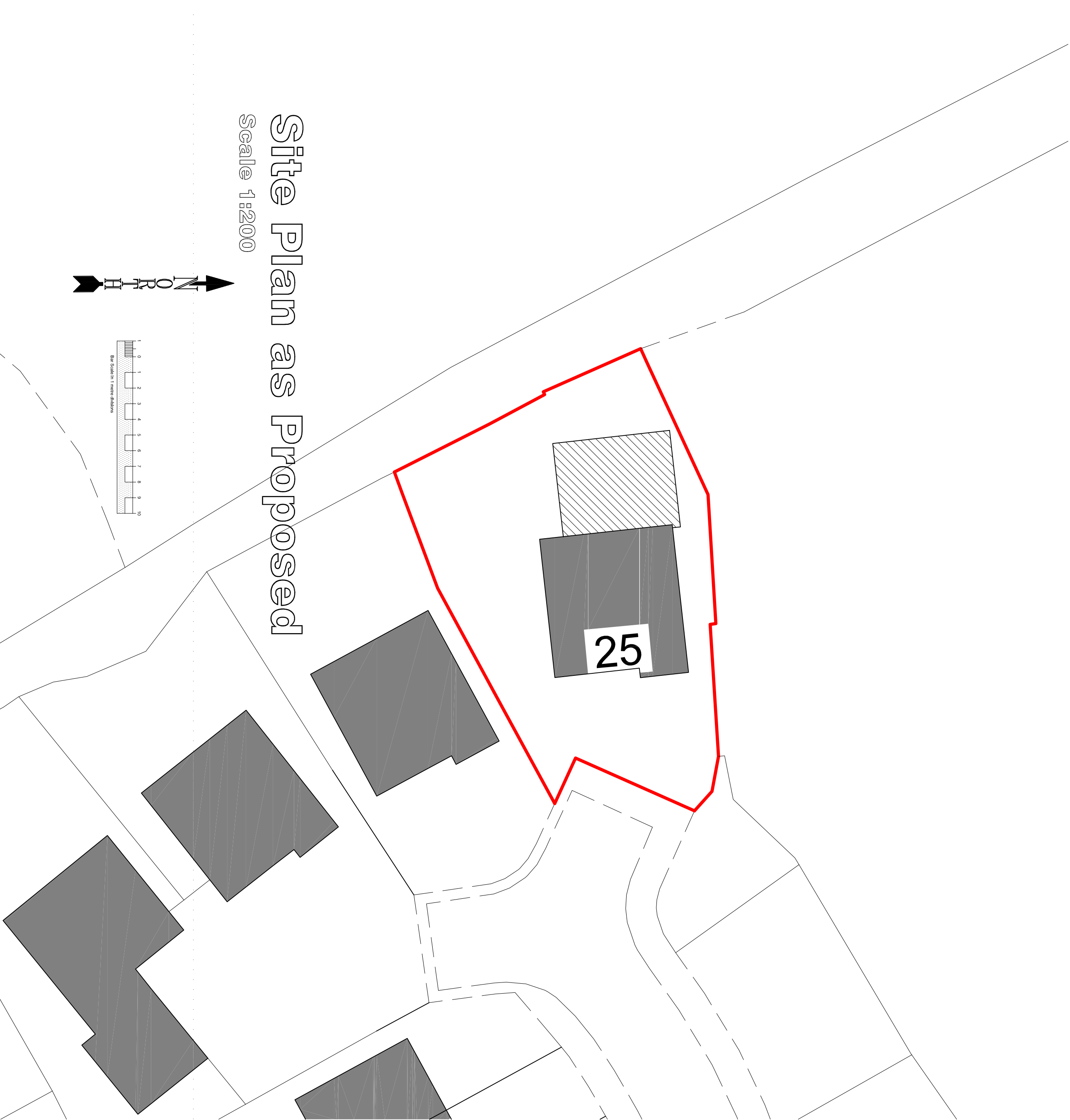

**Site Plan as Proposed**

Scale 1:200

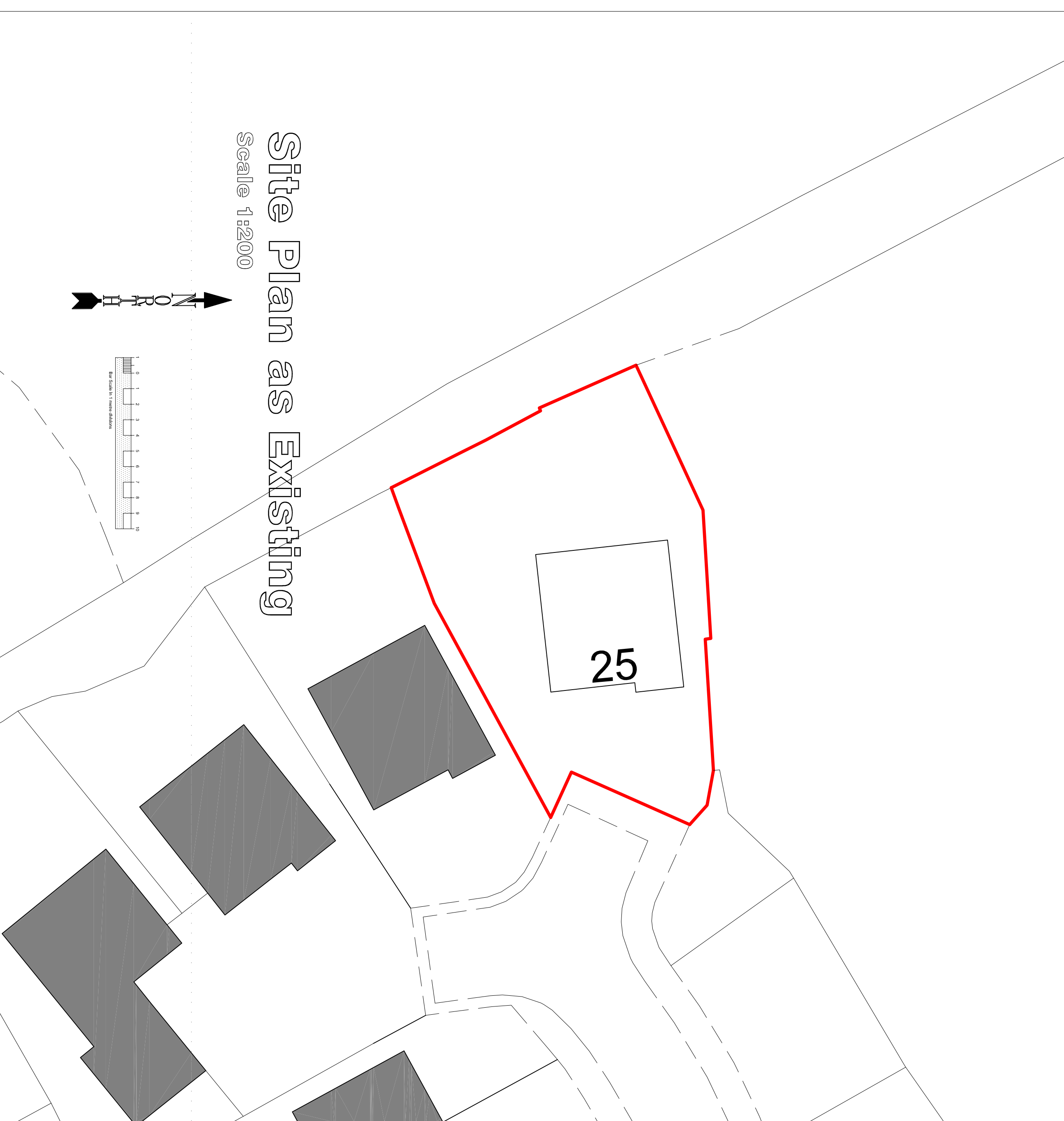
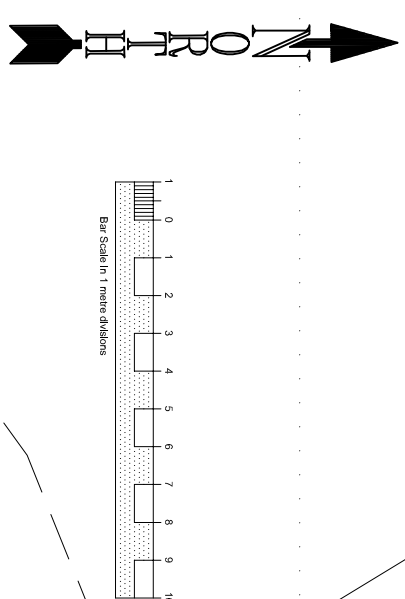

**Site Plan as Existing**

Scale 1:200

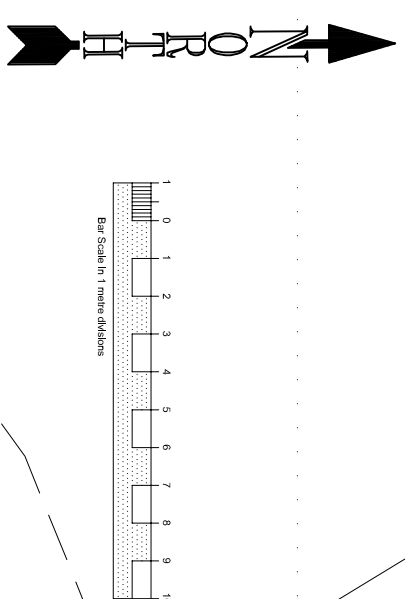

Rev: Arrangements

original by: Alastair Wedderburn

Name: Date:

**grapolitics**  
architectural services ltd

5 Hawshaw Lodge Barm  
Skipton Old Road  
Lothersdale, Kelghley  
West Yorkshire, BD20 8HP

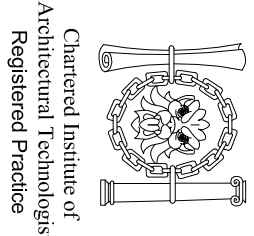

Telephone : 01535 630596  
E-mail : gary@g-a-services.com

client  
Mr & Mrs P Marsden

project  
Proposed rear extension at  
25 Strawberry Fields  
Gisburn  
Lancashire  
BB7 4DQ

drawing title Scheme A - Existing and Proposed Site Plans		scale 1:200 @ A1	date April 2018	drawing No SKA02	rev
---	--	------------------------	-----------------------	---------------------	-----