

GENERAL SPECIFICATIONS
 POSTS - 60x60x2mm SHS
 PANELS - 1800 HIGH X 3005 LONG
 6mm HORIZONTAL WIRES, SPACINGS 200mm CTR MAX
 5mm VERTICAL WIRES, SPACINGS 50mm CTR MAX
 POST TOPS - PLASTIC CAPS
 FITTINGS - MB C/W PERMACONES
 GALVANISED FINISH

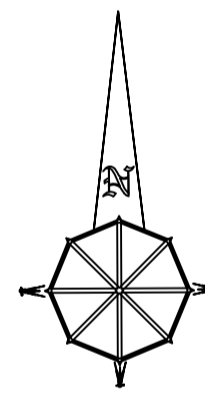
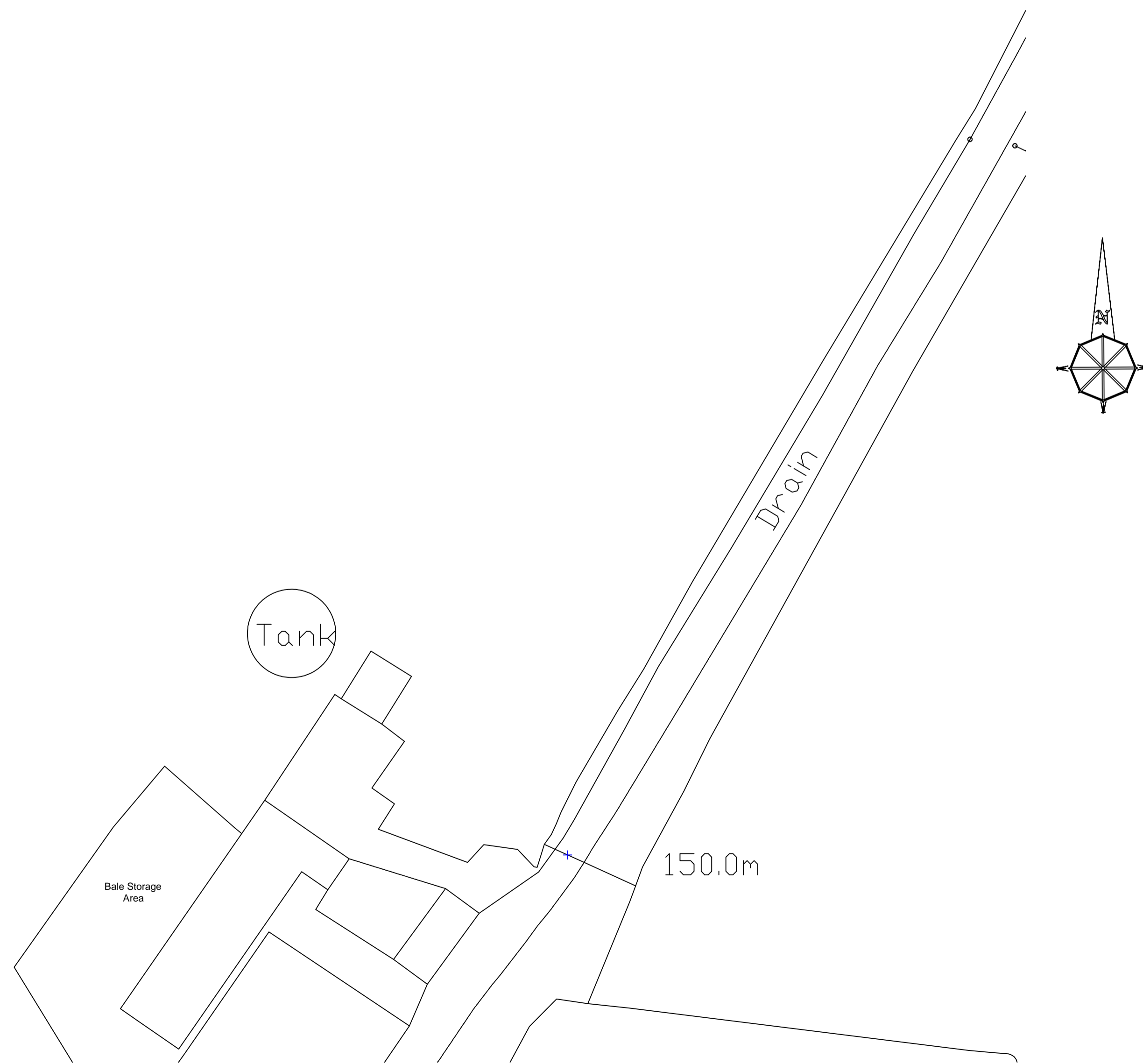

Notes:
 All work is to be carried out to the latest current British standards Codes of Practice and recognised working practices.
 All work and materials should comply with Health and Safety legislation.
 All dimensions are in millimetres where explicitly shown otherwise.
 The contractor should check and certify all dimensions as work proceeds and notify the architect of any discrepancies.
 Do not scale off the drawings, if in doubt ask.

 Gary Hearty Associates Gary Hearty Associates Chartered Surveyors Suite 9 - Grindleton Business Centre The Spinney Grindleton Clitheroe Lancashire BB7 4DH T: 01200 449700 Email: info@ghaonline.co.uk	
Project: (No: Whi.772.2359) Planning Application for a Slurry Lagoon at Pendleton Hall Farm Pendleton Clitheroe BB7 1PT	
Title: Proposed Sections, Existing and Proposed Site Plans, Proposed Fence Detail.	
Drawing No: Whi/772/2359/01	Drawn: PF/RCB
Client: Messrs R & J Whitwell	
Date: 12.09.2017	Scale: 1: 50, 1:200 & 1:500 @ A1
Amendments:	